

QUAD CITY INTERNATIONAL AIRPORT
TAXIWAY P, PHASE I - EARTHWORK
ILL. MLI-3790, QU006
SHEET 17 OF 94

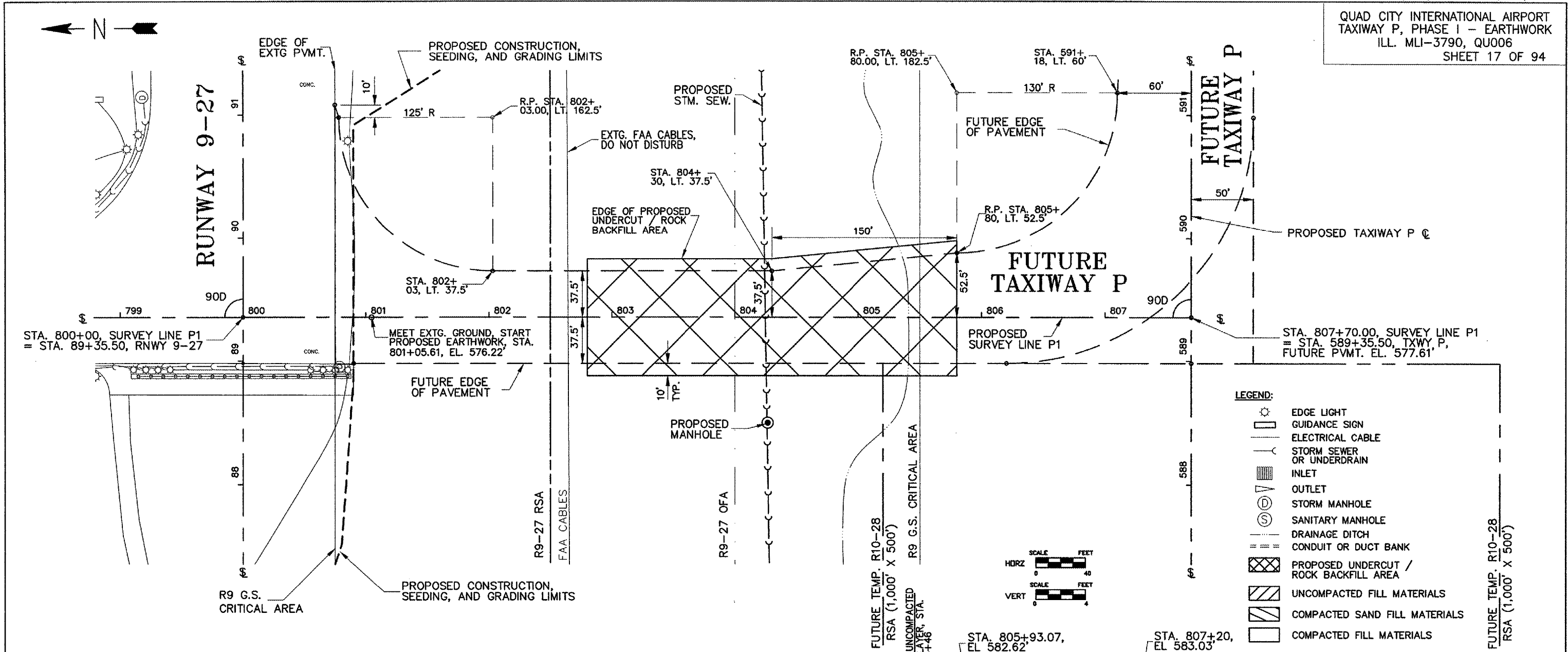

- LEGEND:**
- EDGE LIGHT
 - GUIDANCE SIGN
 - ELECTRICAL CABLE
 - STORM SEWER OR UNDERDRAIN
 - INLET
 - OUTLET
 - STORM MANHOLE
 - SANITARY MANHOLE
 - DRAINAGE DITCH
 - CONDUIT OR DUCT BANK
 - PROPOSED UNDERCUT / ROCK BACKFILL AREA
 - UNCOMPACTED FILL MATERIALS
 - COMPACTED SAND FILL MATERIALS
 - COMPACTED FILL MATERIALS

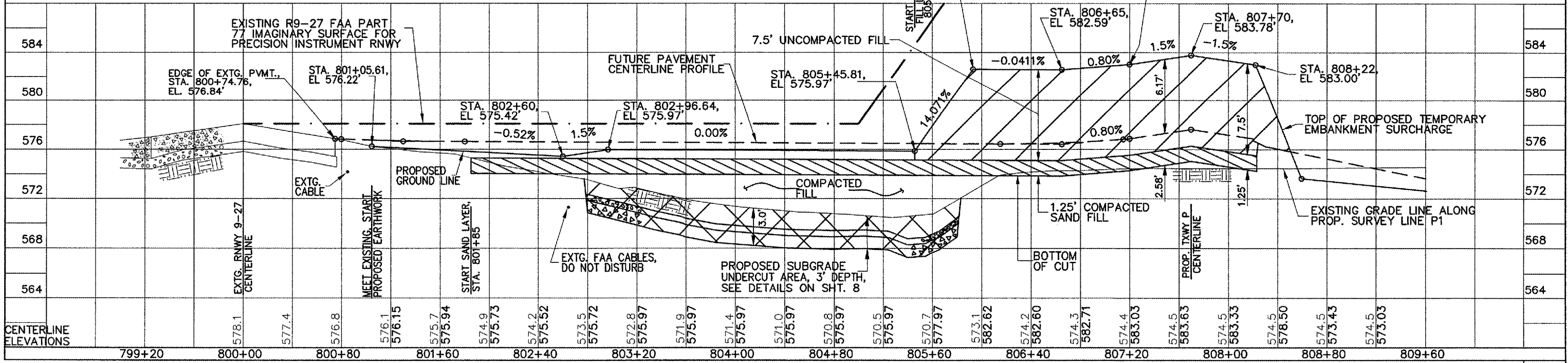
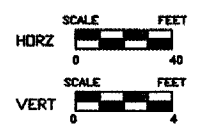

SURVEY LINE P1 PLAN & PROFILE. STA 799+20 TO STA 809+60 17/94

G:\AIRPORT\A077030 TP EARTHWORK\PP2.DWG, 4/21/2008 11:39:30 AM, jefim