

ALIGNMENT DATA

100	N 855395.72 E 19057.63
101	N 856737.73 E 19065.83
102	N 857063.70 E 19072.82
103	N 857323.60 E 19074.41
104	N 857937.62 E 19090.16

BM #200 3900+14, 79 RT
SQUARE "□" CUT IN WEST FACE OF HIGH TENSION TOWER BASE, EAST SIDE OF IL ROUTE 59 (#664 S IL RTE 59) ELEV. 698.76

BM #202 3915+54, 81 RT
SQUARE "□" CUT IN WEST FACE OF HIGH TENSION TOWER BASE, EAST SIDE OF IL ROUTE 59 AT SOUTH ENTRANCE TO CARSON FURNITURE GALLERY / DSW SHOES ELEV. 701.90

BM #204 3927+28, 83 RT
SQUARE "□" CUT IN WEST FACE OF LIGHT POLE BASE, IN PARKING LOT, 50' NORTH OF NORTHWEST CORNER OF CHILI'S RESTAURANT ELEV. 707.09

BM #201 3905+18, 79 RT
SQUARE "□" CUT IN WEST FACE OF HIGH TENSION TOWER BASE, EAST SIDE OF IL ROUTE 59 (#604 IL RTE 59) ELEV. 696.82

BM #203 3923+70, 50.6 LT
SQUARE "□" CUT IN EAST FACE OF HIGH TENSION TOWER BASE, WEST SIDE OF IL ROUTE 59, 150'± SOUTH OF ENTRANCE TO MEIJER FOODS ELEV. 711.96

BM #206 3942+03, 51.8 LT
SQUARE "□" CUT IN SOUTHEAST CORNER OF HIGH TENSION TOWER BASE, WEST SIDE OF IL ROUTE 59, IN FRONT OF SWEET TOMATOES RESTAURANT ELEV. 713.74

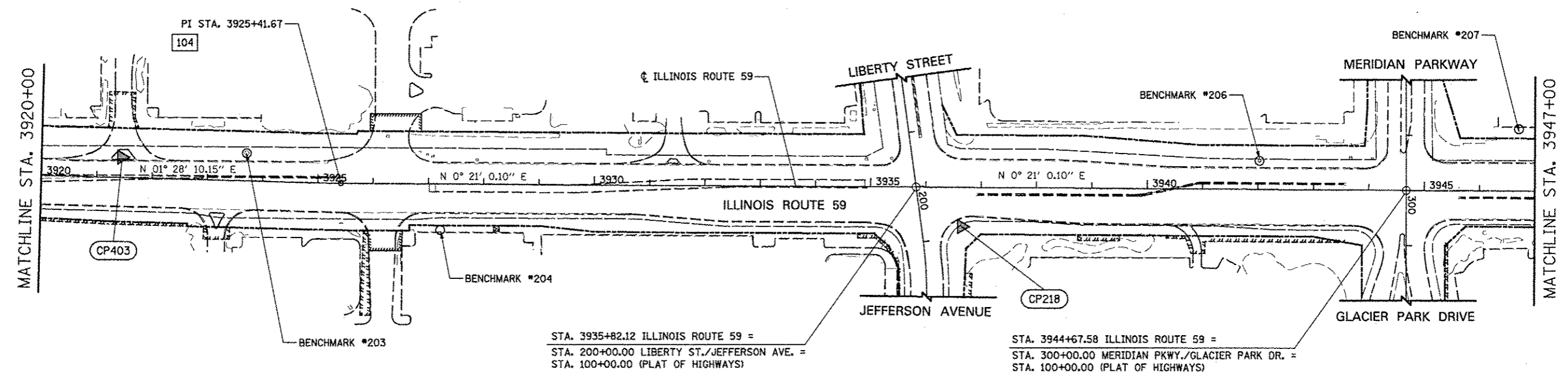
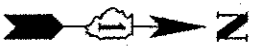

FILE NAME	USER NAME	DESIGNED	REVISED
FILE#	*USER#	NAV	
		DRAWN	REVISED
		KES	
		CHECKED	REVISED
		PJO	
		DATE	REVISED
		05-11-12	

**STATE OF ILLINOIS
DEPARTMENT OF TRANSPORTATION**

ALIGNMENT, BENCHMARKS, AND TIES

SCALE: AS SHOWN | SHEET NO. 1 OF 6 SHEETS | STA. 3893+00 TO STA. 3947+00

F.A.P. RTE.	SECTION	COUNTY	TOTAL SHEETS	SHEET NO.
338	2011-036-1	DUPAGE	234	17
				CONTRACT NO. 60P42
ILLINOIS FED. AID PROJECT				