

STA. 3935+82.12 ILLINOIS ROUTE 59 =
 STA. 200+00.00 LIBERTY ST./JEFFERSON AVE. =
 STA. 100+00.00 (PLAT OF HIGHWAYS)

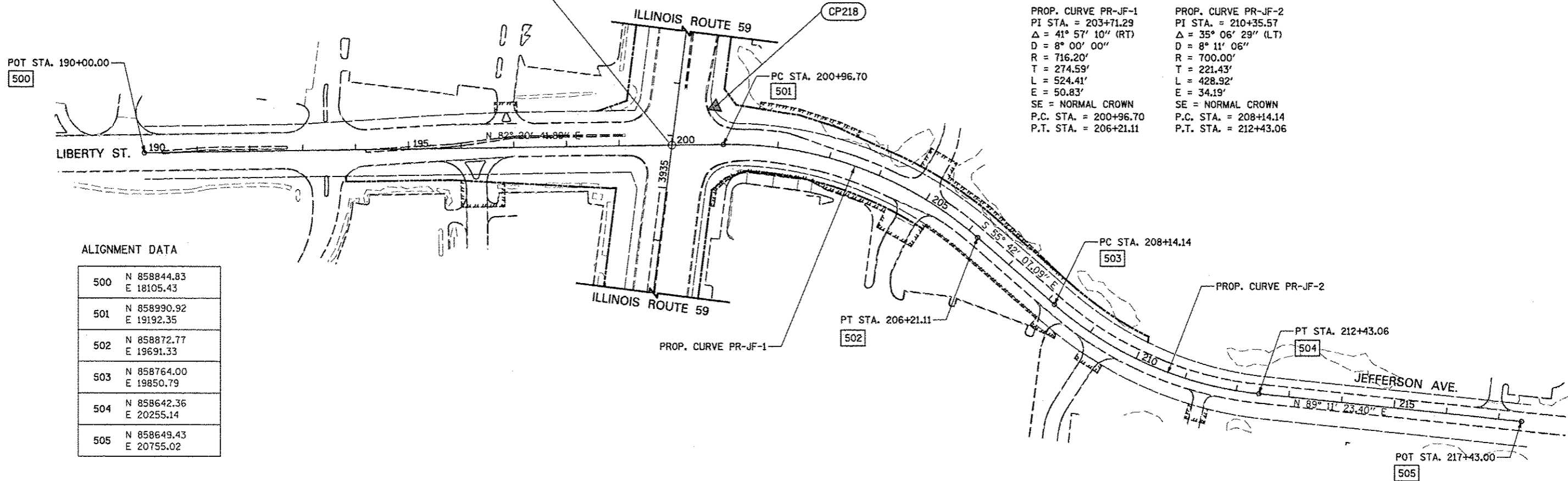

PROP. CURVE PR-JF-1
 PI STA. = 203+71.29
 $\Delta = 41^\circ 57' 10''$ (RT)
 $D = 8^\circ 00' 00''$
 $R = 716.20'$
 $T = 274.59'$
 $L = 524.41'$
 $E = 50.83'$
 SE = NORMAL CROWN
 P.C. STA. = 200+96.70
 P.T. STA. = 206+21.11

PROP. CURVE PR-JF-2
 PI STA. = 210+35.57
 $\Delta = 35^\circ 06' 29''$ (LT)
 $D = 8^\circ 11' 06''$
 $R = 700.00'$
 $T = 221.43'$
 $L = 428.92'$
 $E = 34.19'$
 SE = NORMAL CROWN
 P.C. STA. = 208+14.14
 P.T. STA. = 212+43.06

ALIGNMENT DATA

500	N 858844.83 E 18105.43
501	N 858990.92 E 19192.35
502	N 858872.77 E 19691.33
503	N 858764.00 E 19850.79
504	N 858642.36 E 20255.14
505	N 858649.43 E 20755.02

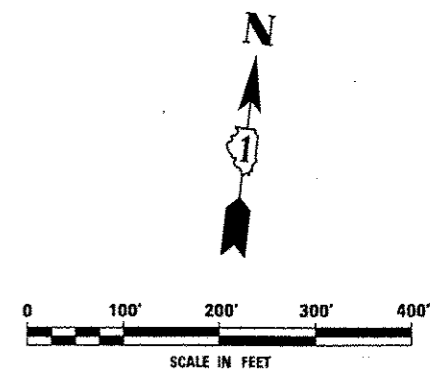

FILE NAME :	USER NAME : AUGER*	DESIGNED NAV	REVISED	STATE OF ILLINOIS DEPARTMENT OF TRANSPORTATION	ALIGNMENT, BENCHMARKS, AND TIES	F.A.P. RTE.	SECTION	COUNTY	TOTAL SHEETS	SHEET NO.
#FILE#	DRAWN KES	CHECKED PJO	REVISED			338	2011-036-1	DUPAGE	234	20
PLBT SCALE = #SCALE#	DATE 05-11-12	REVISED	REVISED			SCALE: AS SHOWN SHEET NO. 4 OF 6 SHEETS STA. 190+00 TO STA. 217+43		CONTRACT NO. 60P42 ILLINOIS FED. AID PROJECT		