

CONTROL POINT 401

REBAR W/CAP 4' EAST OF MID-POINT OF BACK OF CURB IN THE SOUTH EAST QUADRANT OF IL RTE 59 AND AURORA AVE., 0.5' SOUTH OF EXISTING HANDHOLE.

N 856050.06
E 19141.30
ELEV. = 693.09

NAIL IN NORTH FACE OF POWER POLE, 1' ABOVE GROUND

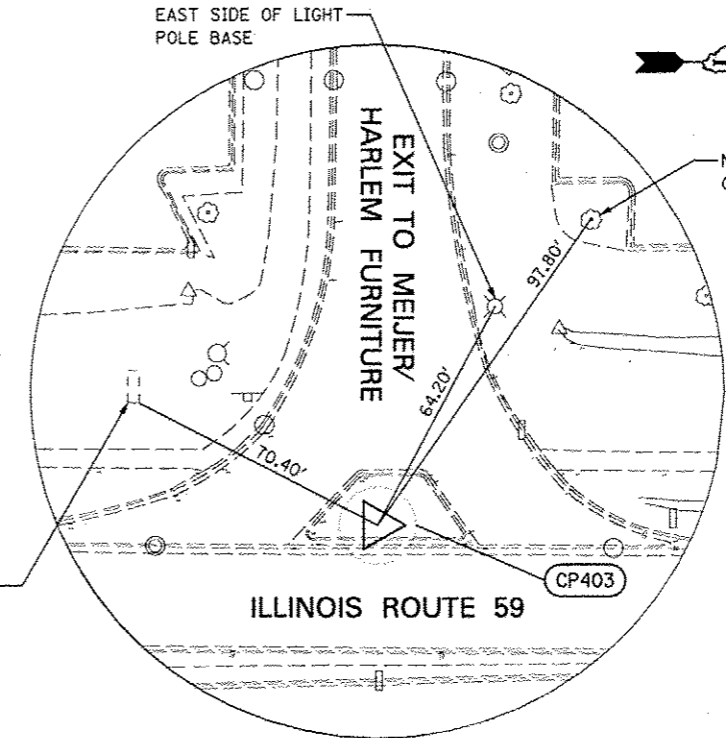

CONTROL POINT 403

CROSS (+) 3' WEST OF WEST BACK OF CURB OF PORK CHOP ISLAND AT SOUTH EASTERN EXIT OF MEIJER FOODS/HARLEM FURNITURE TO RTE 59.

N 857541.5
E 19043.14
ELEV. = 705.51

NORTH EAST CORNER OF CONCRETE BASE OF BRICK SIGN

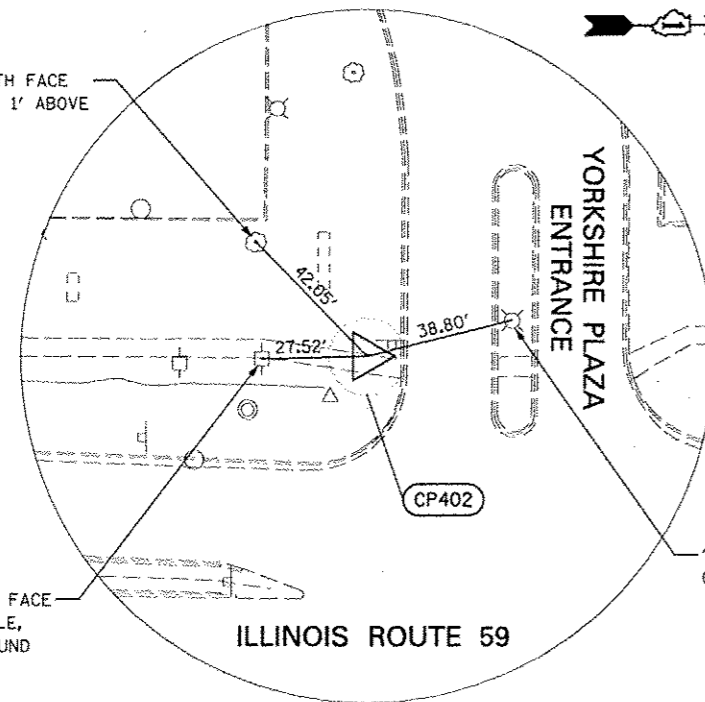

CONTROL POINT 402

CROSS (+) CUT 0.5' EAST OF WEST BACK OF SIDEWALL EDGE, 9' SOUTH OF BACK OF CURB, AT SOUTH ENTRANCE TO YORKSHIRE PLAZA AT RTE 59.

N 856950.33
E 19009.40
ELEV. = 701.37

"4" ON SOUTH SIDE OF LIGHT POLE BASE

NAIL IN EAST FACE OF POWER POLE, 1' ABOVE GROUND

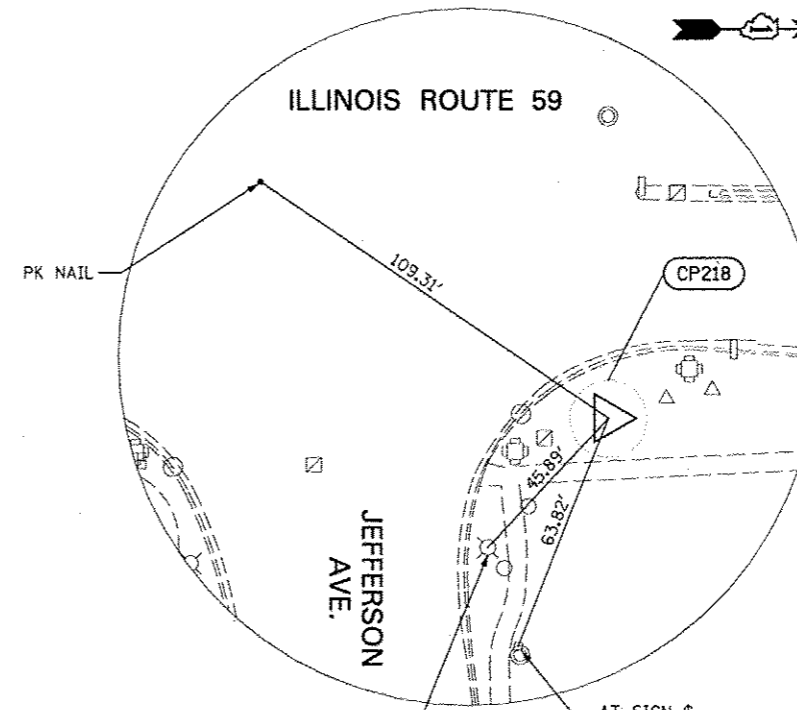

CONTROL POINT 218

NAPERVILLE GPS MONUMENT AT NORTHEAST CORNER OF IL RTE 59 AND JEFFERSON AVE., 8' WEST OF EDGE OF SIDEWALK, 10' EAST OF MID-POINT OF BACK OF CURB.

N 859060.22
E 19168.45
ELEV. = 710.10

NORTH FACE OF LIGHT POLE

FILE NAME : #FILE#	USER NAME : #USER#	DESIGNED NAV	REVISED	STATE OF ILLINOIS DEPARTMENT OF TRANSPORTATION	ALIGNMENT, BENCHMARKS, AND TIES	F.A.P. RTE.	SECTION	COUNTY	TOTAL SHEETS	SHEET NO.	
		DRAWN KES	REVISED			338	2011-036-1	DUPAGE	234	21	
		CHECKED PJO	REVISED			SCALE: AS SHOWN SHEET NO. 5 OF 6 SHEETS STA. TO STA.		CONTRACT NO. 60P42		ILLINOIS FED. AID PROJECT	
		DATE 05-11-12	REVISED								