

ELEVATION

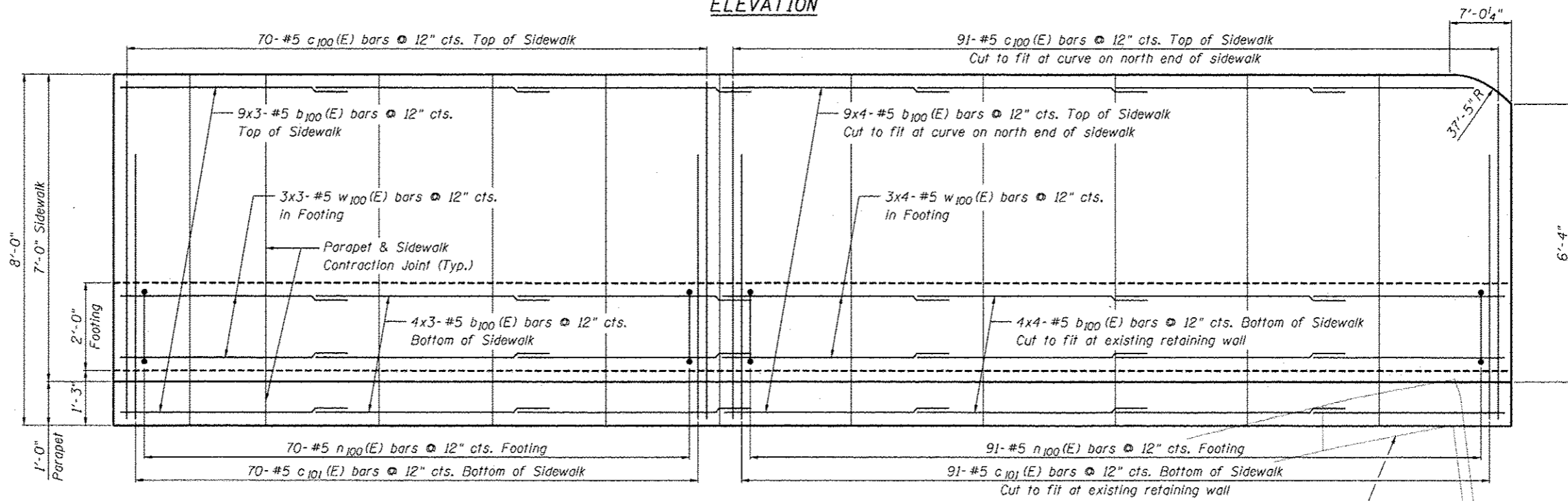

PLAN

Existing Retaining Wall  
See Sheet SA-4

Notes:  
 Min. lap for #4 bar is 2'-11". #5 bar is 3'-8".  
 See Sheet SA-3 for Details and Bill of Material.  
 Bars indicated thus: 4x3-#5 etc. indicates 4 lines of bars with 3 lengths per line.  
 Vertical scale exaggerated for clarity.  
 Parapet Contraction joint shall consist of 3/4" chamfers on front, back, and top side of parapet.  
 Optional full depth construction joint with 1/2" chamfers may be provided in sidewalk placed at a contraction joint location.

WALL PLAN AND ELEVATION  
SN 022-W043

FILE NAME: ... \6822-W043-022-W043-Plan-Elev.dgn



USER NAME: SAW	DESIGNED: PMM	REVISIONS:
PLOT SCALE: 1/8" = 1'-0"	CHECKED: DAZ	REVISIONS:
PLOT DATE: 5/4/2012	DRAWN: SAW	REVISIONS:
	CHECKED: PMM	REVISIONS:

STATE OF ILLINOIS  
DEPARTMENT OF TRANSPORTATION

WALL PLAN & ELEVATION  
STA. 3913+83.48 TO STA. 3915+42.32 SN 022-W043

F.A.P. RTE. 338	SECTION 2011-036-1	COUNTY	TOTAL SHEETS 234	SHEET NO. 33
CONTRACT NO. 60P42			ILLINOIS FED. AID PROJECT	

SHEET NO. SA-2 OF SA-6 SHEETS