

ELEVATION - FORM LINER

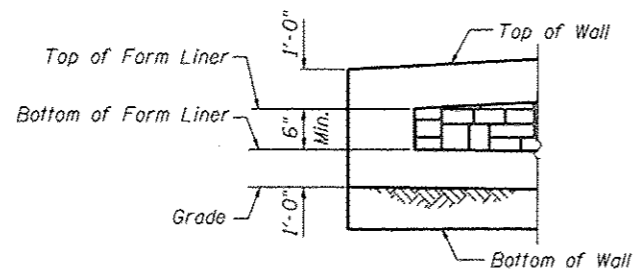

END FORM LINER FINISH

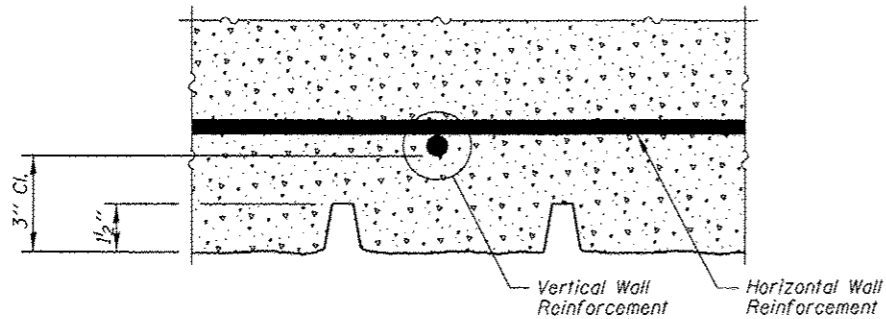

PLAN - FORM LINER

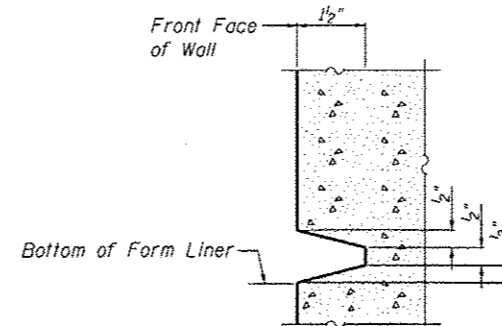
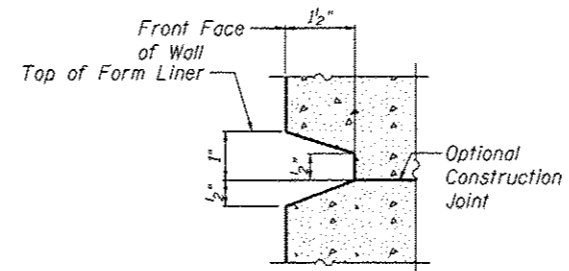

SECTION A-A

FORM LINER ELEVATION TABLE

Station	Form Liner Top Elevation	Form Liner Bottom Elevation
3920+19.79	None	None
3920+22.33	704.40	703.90
3920+25.30	704.45	702.59
3920+44.75	704.77	702.53
3920+50.00	704.86	702.53
3920+69.70	704.91	702.53
3920+94.66	704.97	702.55
3921+18.61	705.03	702.57
3921+28.26	705.05	702.57
3921+45.60	705.10	702.58
3921+70.60	705.17	702.67
3921+95.60	705.25	702.79
3922+00.00	705.26	702.82
3922+20.60	705.33	702.97
3922+45.60	705.42	703.09
3922+62.78	705.48	703.53
3922+67.12	705.50	705.00
3922+70.60	None	None

**ARCHITECTURAL FINISH DETAILS
SN 022-W044**



Zroka Engineering, P.C.
4216 North Hermitage
Chicago, IL 60613

USER NAME - SAW
DESIGNED - LAS
CHECKED - DAZ
DRAWN - SAW
CHECKED - LAS
PLOT SCALE = 0.1667 "/>

DESIGNED - LAS
CHECKED - DAZ
DRAWN - SAW
CHECKED - LAS
REVISED -
REVISED -
REVISED -
REVISED -

**STATE OF ILLINOIS
DEPARTMENT OF TRANSPORTATION**

**ARCHITECTURAL FINISH DETAILS
STA. 3920 + 19.79 TO STA. 3922 + 70.60 SN 022-W044**

SHEET NO. SB-6 OF SB-7 SHEETS

F.A.P. RTE.	SECTION	COUNTY	TOTAL SHEETS	SHEET NO.
338	2011-036-1	DUPAGE	234	48

CONTRACT NO. 60P42
ILLINOIS FED. AID PROJECT