

REMOVING MANHOLES

4020+63.2, 55.0 RT
4021+37.0, 55.0 RT

MANHOLES TO BE RECONSTRUCTED

4019+54, 41.9 RT
4019+68, 49.7 RT
4021+09, 41.4 RT
4021+62, 46.8 RT

STORM SEWER REMOVAL - 72"

STA 4020+52.0 TO 4020+62.0 - 16'
STA 4020+65.7 TO 4021+34.5 - 69'
STA 4021+36.0 TO 4021+36.0 - 19'

REMOVING CATCH BASIN TO MAINTAIN FLOW

4019+99, 57.0 RT

DATE: _____
BY: _____
PLAN: _____
SHEET NO.: _____
TOTAL SHEETS: _____
NOTE: _____
REVISIONS: _____

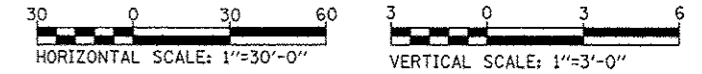
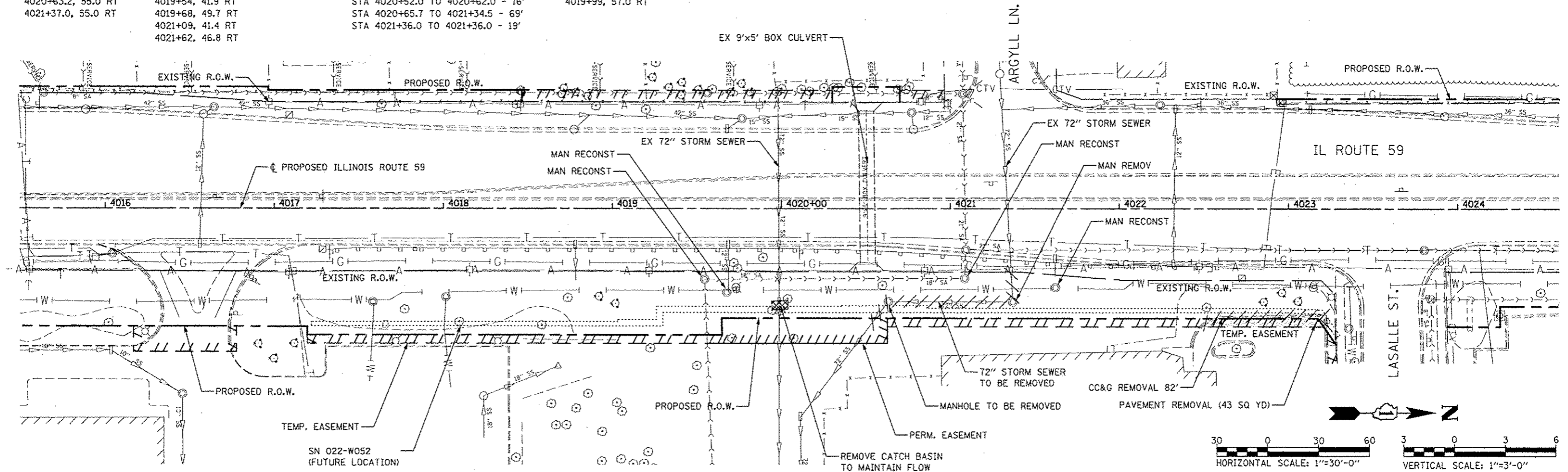

DATE: _____
BY: _____
PROFILE: _____
SHEET NO.: _____
TOTAL SHEETS: _____
NOTE: _____
REVISIONS: _____

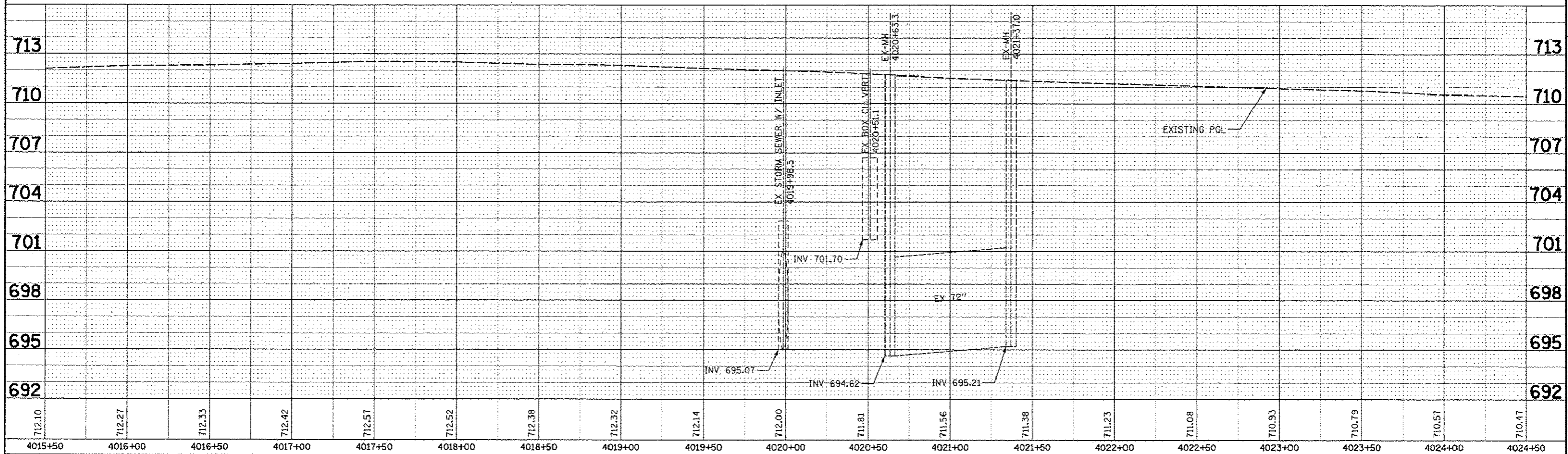

4015+50	4016+00	4016+50	4017+00	4017+50	4018+00	4018+50	4019+00	4019+50	4020+00	4020+50	4021+00	4021+50	4022+00	4022+50	4023+00	4023+50	4024+00	4024+50
712.10	712.27	712.33	712.42	712.57	712.52	712.38	712.32	712.14	712.00	711.81	711.56	711.38	711.23	711.08	710.93	710.79	710.57	710.47

**STATE OF ILLINOIS
DEPARTMENT OF TRANSPORTATION**

DRAINAGE REMOVAL PLAN / PROFILE - SN 022-W052

F.A.P. RTE.	SECTION	COUNTY	TOTAL SHEETS	SHEET NO.
338	2011-036-I	DUPAGE	234	125
CONTRACT NO. 60P42				

SCALE: AS SHOWN | SHEET NO. 1 OF 1 SHEETS | STA. 4015+50 TO STA. 4024+50 | FED. ROAD DIST. NO. | ILLINOIS FED. AID PROJECT