

F.A. RTE. 338/IL 59	SECTION 2011-036	COUNTY DUPAGE	TOTAL SHEETS 0	SHEET NO. 3
STA.		TO STA.		
FED. ROAD DIST. NO.		ILLINOIS CONTRACT 60P42		

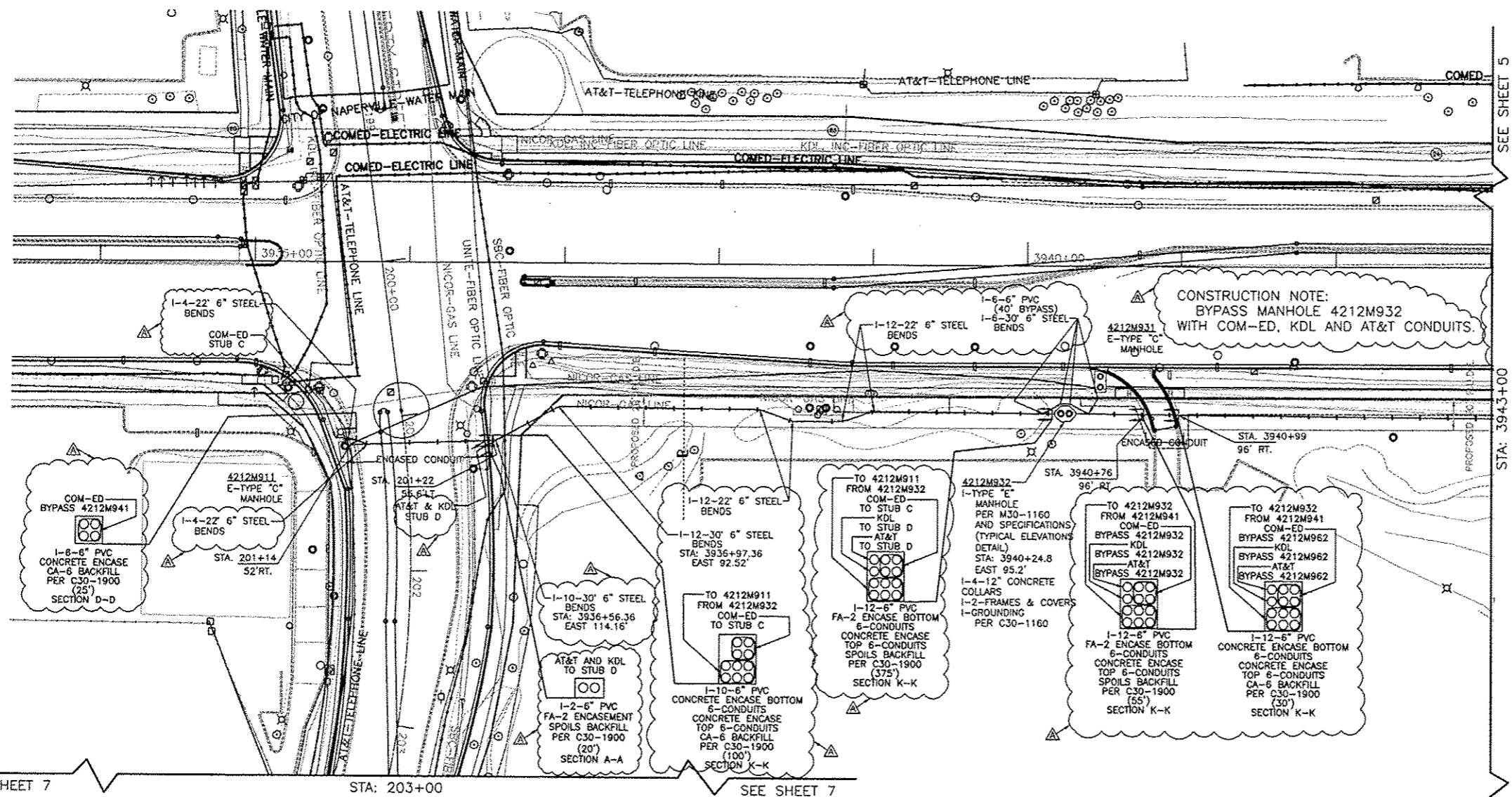

LEGEND

- EXISTING UNDERGROUND**
- E-SW. VAULT
 - E-SW. MOD.
 - E-TRANSFORMER
 - E-TYPE "A" MANHOLE
 - E-TYPE "C" MANHOLE
 - E-TYPE "C" DOUBLE OPENING MANHOLE
 - E-TYPE "D" MANHOLE
 - E-TYPE "E" MANHOLE
 - E-CONDUIT
- OVERHEAD**
- E-DISTRIBUTION/TRANSMISSION POLE
- INSTALL UNDERGROUND**
- I-SW. VAULT
 - I-TRANSFORMER VAULT
 - I-TYPE "A" MANHOLE
 - I-TYPE "E" DOUBLE OPENING MANHOLE
 - I-TYPE "C" DOUBLE OPENING MANHOLE
 - I-TYPE "C" SINGLE OPENING MANHOLE
 - I-CONDUIT
- ABANDON UNDERGROUND**
- A-CONDUIT

CONSTRUCTION NOTE:
BYPASS MANHOLE 4212M932
WITH COM-ED, KDL AND AT&T CONDUITS.

CALL JULIE 48 HRS. PRIOR TO CONSTRUCTION
1 - 800 - 892 - 0123 OR CALL 811

- NOTES:**
1. THE PROJECT ENGINEER FOR THIS JOB IS BRIAN CHAMBERLAIN AT (630)420-8853.
 2. THE PROJECT COORDINATOR FOR THIS PROJECT IS PAUL MICHALOWSKI AT (630)305-8227.
 3. CONTRACTOR IS RESPONSIBLE FOR MANHOLE PHOTOS TAKEN OF ALL CLEARLY MARKED CABLE AND ALL WALLS OF MANHOLES. PHOTOS WILL BE GIVEN TO THE GIS GROUP WITH THE AS-BUILTS.

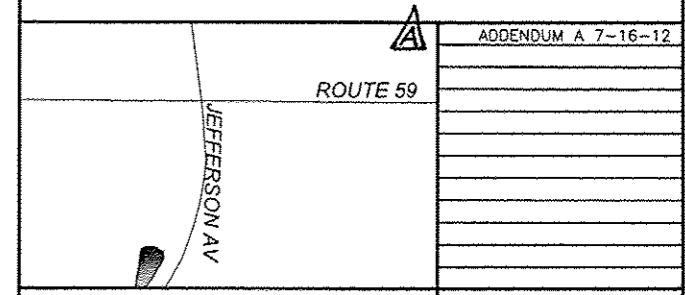

PROJECT TITLE ROUTE 59 ROAD IMPROVEMENTS			
PROJECT DESCRIPTION TO RELOCATE AND INSTALL NEW DUCTBANK AND 34KV FEEDERS	DRAWING DATE 5-11-12	DATE # 4211,4212,4223	SCALE 1 = 40
DESIGNED BY DL	DESIGNED BY PSM	DATE # N/A	PROJECT # EU-12
CHECKED BY	APPROVED BY	DWG FILE 0060648001C6.DWG	SHEET # 6 OF 63
Naperville Department of Public Utilities Electric Division			WORK REQUEST # 60468