

F.A. RTE. 338/IL 59	SECTION -2011-036-	COUNTY DUPAGE	TOTAL SHEETS -0-	SHEET NO. -3-
STA.		TO STA.		
FED. ROAD DIST. NO.	ILLINOIS	CONTRACT 60P42		

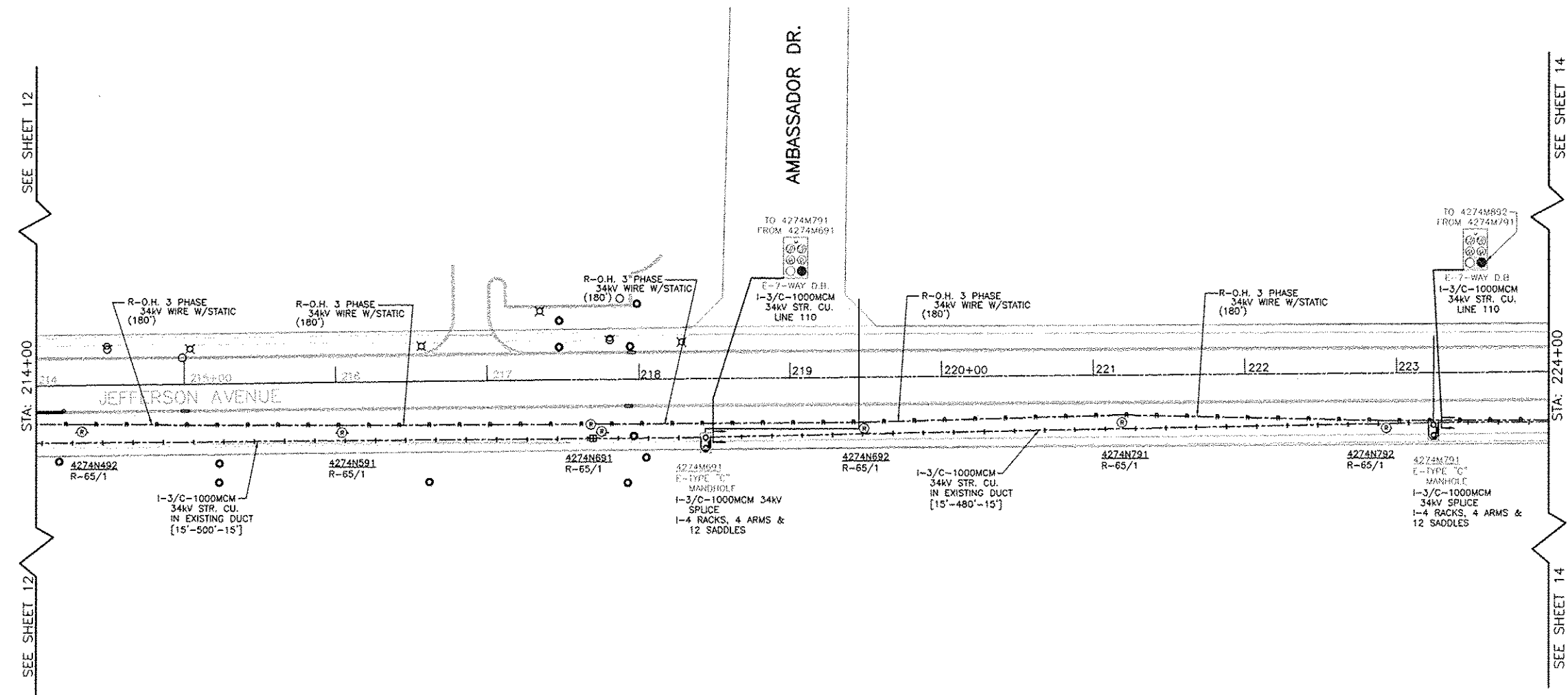

**LEGEND**

**EXISTING UNDERGROUND**

- E-SW. VAULT
  - E-SW. MOD.
  - E-TRANSFORMER
  - E-TYPE "A" MANHOLE
  - E-TYPE "C" MANHOLE
  - E-TYPE "C" DOUBLE OPENING MANHOLE
  - E-TYPE "D" MANHOLE
  - E-TYPE "E" MANHOLE
  - E-CONDUIT
  - E-TYPE "E" DOUBLE OPENING MANHOLE
  - E-TYPE "G" DOUBLE OPENING MANHOLE
  - E-DISTRIBUTION/TRANSMISSION POLE
  - E-3/C-1000MCM 34KV STR. CU. W/JKT.
- INSTALL UNDERGROUND**
- I-3/C-1000MCM 34KV STR. CU. W/JKT.
  - I-SPLICE PER MFR. OR SPECS. PER C30-0460
- REMOVE UNDERGROUND**
- R-DISTRIBUTION/TRANSMISSION POLE 65/1 THRU 65/3 POLES
  - R-3/C-1000MCM 34KV STR. CU. W/JKT.
  - R-O.H. 3 PHASE 34KV WIRE W/STATIC

CALL **JULIE** 48 HRS. PRIOR TO CONSTRUCTION  
1-800-892-0123 OR CALL 811

- NOTES:
1. THE PROJECT ENGINEER FOR THIS JOB IS BRIAN CHAMBERLAIN AT (630)420-6863.
  2. THE PROJECT COORDINATOR FOR THIS PROJECT IS PAUL MICHALOWSKI AT (630)305-2227.
  3. CONTRACTOR IS RESPONSIBLE FOR MANHOLE PHOTOS TAKEN OF ALL CLEARLY MARKED CABLE AND ALL WALLS OF MANHOLES. PHOTOS WILL BE GIVEN TO THE GIS GROUP WITH THE AS-BUILTS.

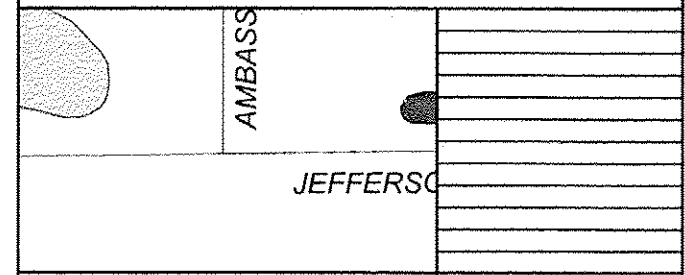

PROJECT TITLE <b>ROUTE 59 ROAD IMPROVEMENTS</b>		DESIGN REVISION DATES	
PROJECT DESCRIPTION <b>TO RELOCATE AND INSTALL NEW DUCTBANK AND 34KV FEEDERS</b>			
ENGINEER BCC	DRAWING DATE 5-11-12	APP. # 4211,4212,4223	SCALE 1 = 40
DESIGN BY / CHECKED BY DL / PSM	REVISION DATE	DATE JOB AGREEMENT # N/A	PROJECT # EU-12
CHECKED BY	APPROVED BY	CAD FILE 0080640001C13.DWG	SHEET # 13 OF 63
Naperville Department of Public Utilities Electric Division			WORK REQUEST # 60468