

NOTE:  
SEE NEW YORK ST. / AURORA AVE. SHEET  
FOR ALIGNMENT & TIE DATA

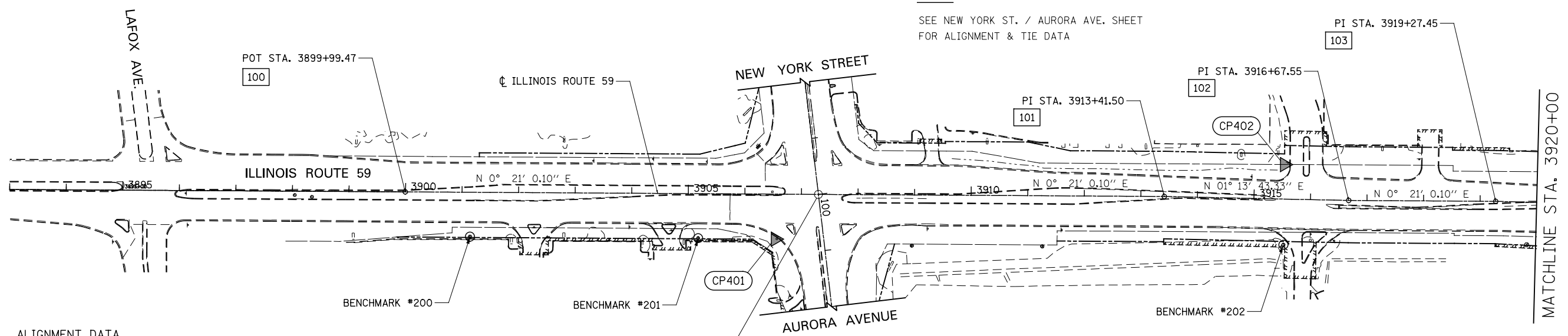

ALIGNMENT DATA

100	N 855395.72 E 19057.63
101	N 856737.73 E 19065.83
102	N 857063.70 E 19072.82
103	N 857323.60 E 19074.41
104	N 857937.62 E 19090.16

STA. 3907+29.90 ILLINOIS ROUTE 59 =  
STA. 100+00.00 NEW YORK ST./AURORA AVE. =  
STA. 100+00.00 (PLAT OF HIGHWAYS)

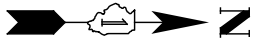

NOTE:  
SEE LIBERTY ST. / JEFFERSON AVE. AND  
MERIDIAN PKWY. / GLACIER PARK DR.  
SHEETS FOR ALIGNMENT & TIE DATA

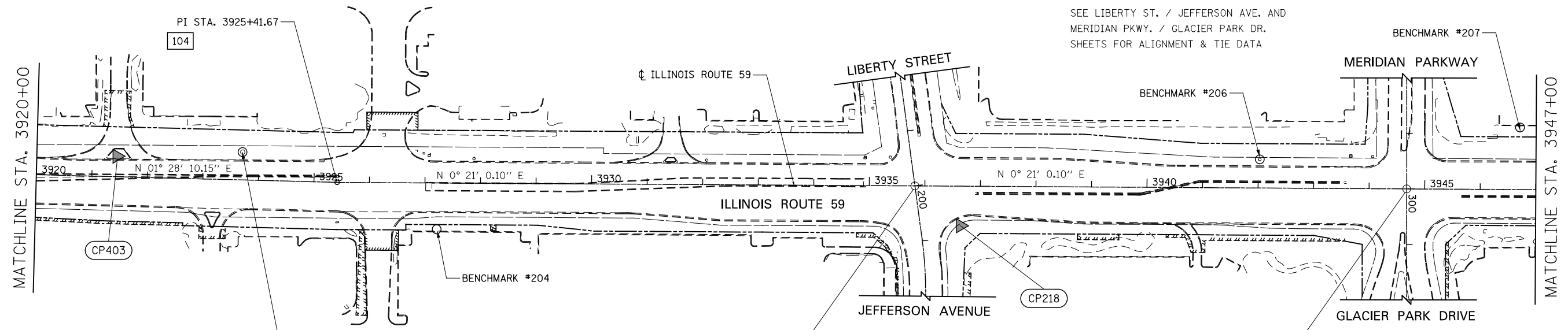

STA. 3935+82.12 ILLINOIS ROUTE 59 =  
STA. 200+00.00 LIBERTY ST./JEFFERSON AVE. =  
STA. 100+00.00 (PLAT OF HIGHWAYS)

STA. 3944+67.58 ILLINOIS ROUTE 59 =  
STA. 300+00.00 MERIDIAN PKWY./GLACIER PARK DR. =  
STA. 100+00.00 (PLAT OF HIGHWAYS)

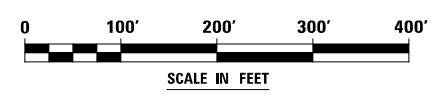

DESIGNED	PJO	REVISED	-
DRAWN	KES	REVISED	-
CHECKED	JCM	REVISED	-
DATE	12/14/2012	REVISED	-

STATE OF ILLINOIS  
DEPARTMENT OF TRANSPORTATION

ALIGNMENT, BENCHMARKS, AND TIES

SCALE: AS SHOWN SHEET NO. 1 OF 8 SHEETS STA. 3893+00 TO STA. 3947+00

F.A.P. RTE.	SECTION	COUNTY	TOTAL SHEETS	SHEET NO.
338	(112 & 113) WRS-7	DUPAGE	1156	87
CONTRACT NO. 60R30				

ILLINOIS FED. AID PROJECT