

PROP. CURVE PR-NA-1  
 PI STA. = 400+63.49  
 $\Delta$  = 10° 53' 54" (RT)  
 D = 2° 29' 59"  
 R = 2,292.00'  
 T = 218.64'  
 L = 435.96'  
 E = 10.40'  
 SE = NORMAL CROWN  
 P.C. STA. = 398+44.84  
 P.T. STA. = 402+80.81

CP105  
 STA. 3976+49.56 ILLINOIS ROUTE 59 =  
 STA. 400+00.00 NORTH AURORA RD. =  
 STA. 100+00.00 (PLAT OF HIGHWAYS)

ALIGNMENT DATA

600	N 863059.19 E 17516.23
601	N 863050.51 E 18961.05
602	N 863006.58 E 19394.14
603	N 862671.41 E 21080.34

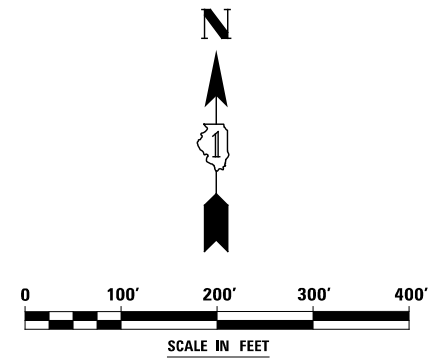
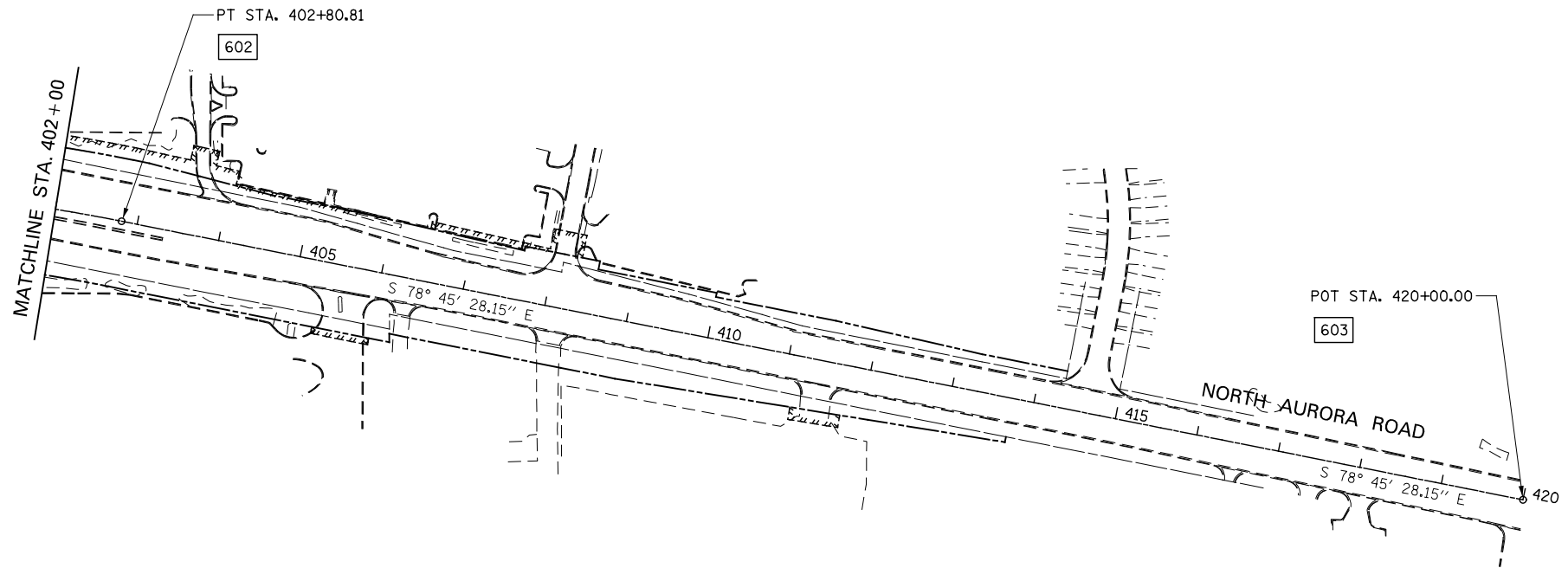

DESIGNED	PJO	REVISED	-
DRAWN	KES	REVISED	-
CHECKED	JCM	REVISED	-
DATE	12/14/2012	REVISED	-

STATE OF ILLINOIS  
 DEPARTMENT OF TRANSPORTATION

ALIGNMENT, BENCHMARKS, AND TIES

SCALE: AS SHOWN SHEET NO. 5 OF 8 SHEETS STA. 384+00 TO STA. 420+00

F.A.P. RTE.	SECTION	COUNTY	TOTAL SHEETS	SHEET NO.
338	(112 & 113) WRS-7	DUPAGE	1156	91
CONTRACT NO. 60R30				
ILLINOIS FED. AID PROJECT				