

ADVANCE SIGNING FOR WESTBOUND NORTH AURORA ROAD

(SPACING MAY VARY DUE TO FIELD CONDITIONS)

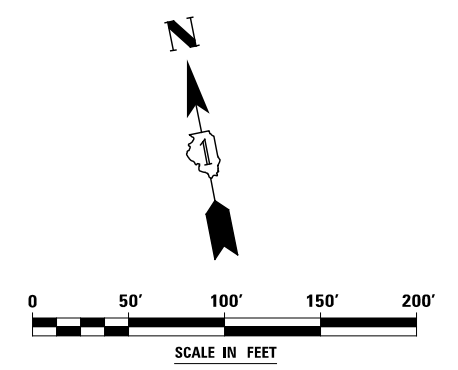
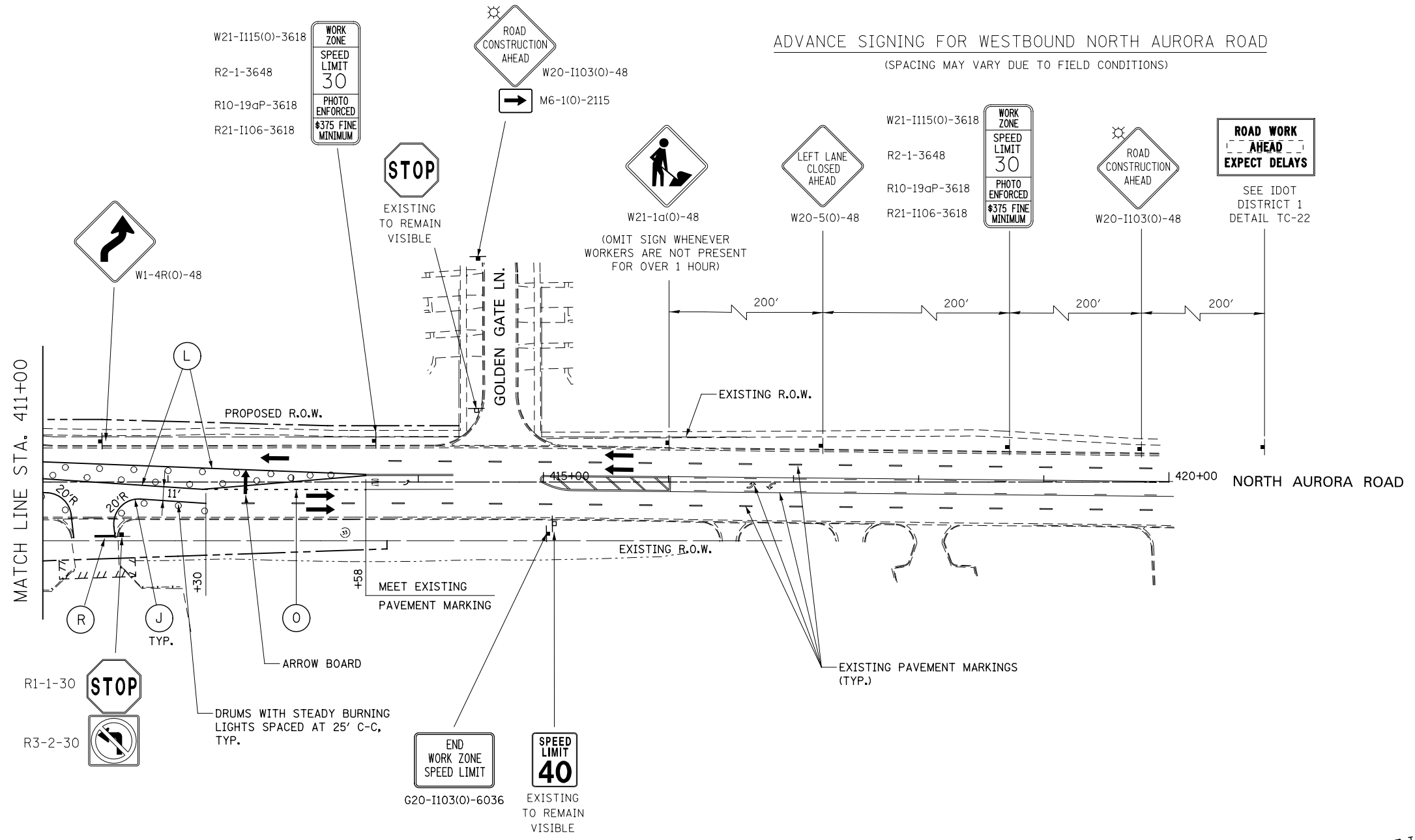

DESIGNED	PJO	REVISED	-
DRAWN	KES	REVISED	-
CHECKED	JCM	REVISED	-
DATE	12/14/2012	REVISED	-

STATE OF ILLINOIS
DEPARTMENT OF TRANSPORTATION

MAINTENANCE OF TRAFFIC - STAGE 1A			
NORTH AURORA ROAD			
SCALE: AS SHOWN	SHEET NO. 69 OF 195 SHEETS	STA. 411+00	TO STA. 420+00

F.A.P. RTE.	SECTION	COUNTY	TOTAL SHEETS	SHEET NO.
338	(112 & 113) WRS-7	DUPAGE	1156	163
CONTRACT NO. 60R30				
ILLINOIS FED. AID PROJECT				