

ADVANCE SIGNING FOR WESTBOUND NORTH AURORA ROAD

(SPACING MAY VARY DUE TO FIELD CONDITIONS)

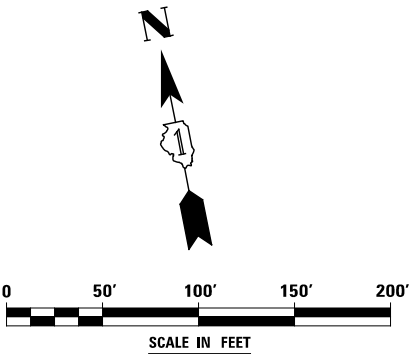
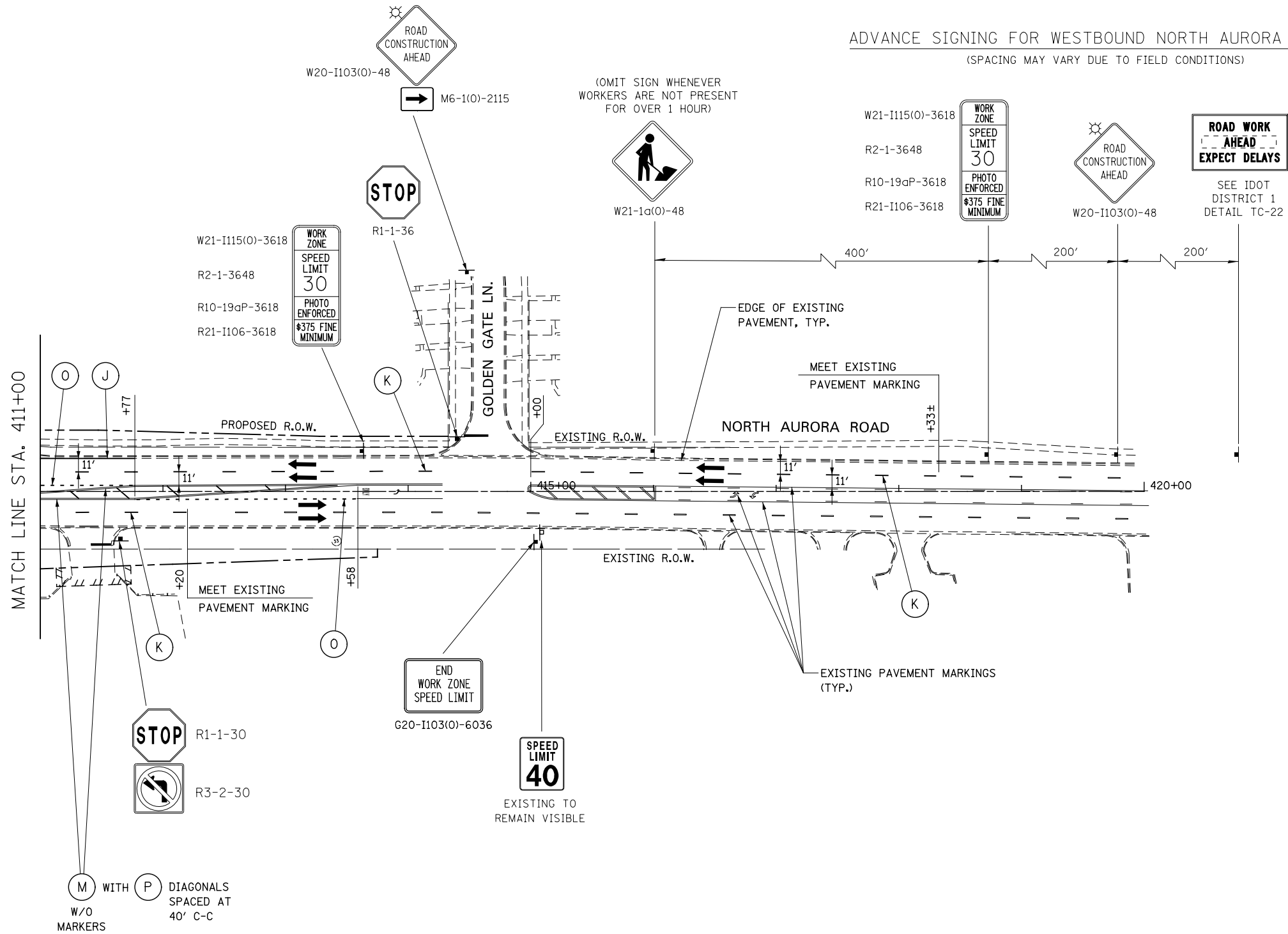

DESIGNED	PJO	REVISED	-
DRAWN	KES	REVISED	-
CHECKED	JCM	REVISED	-
DATE	12/14/2012	REVISED	-

STATE OF ILLINOIS
DEPARTMENT OF TRANSPORTATION

MAINTENANCE OF TRAFFIC - STAGE 1D
NORTH AURORA ROAD
SCALE: AS SHOWN SHEET NO. 89 OF 195 SHEETS STA. 411+00 TO STA. 420+00

F.A.P. RTE.	SECTION	COUNTY	TOTAL SHEETS	SHEET NO.
338	(112 & 113) WRS-7	DUPAGE	1156	183
CONTRACT NO. 60R30				
ILLINOIS FED. AID PROJECT				