

ADVANCE SIGNING FOR GLACIER PARK AVENUE / HIGH GROVE LANE
(SPACING MAY VARY DUE TO FIELD CONDITIONS)

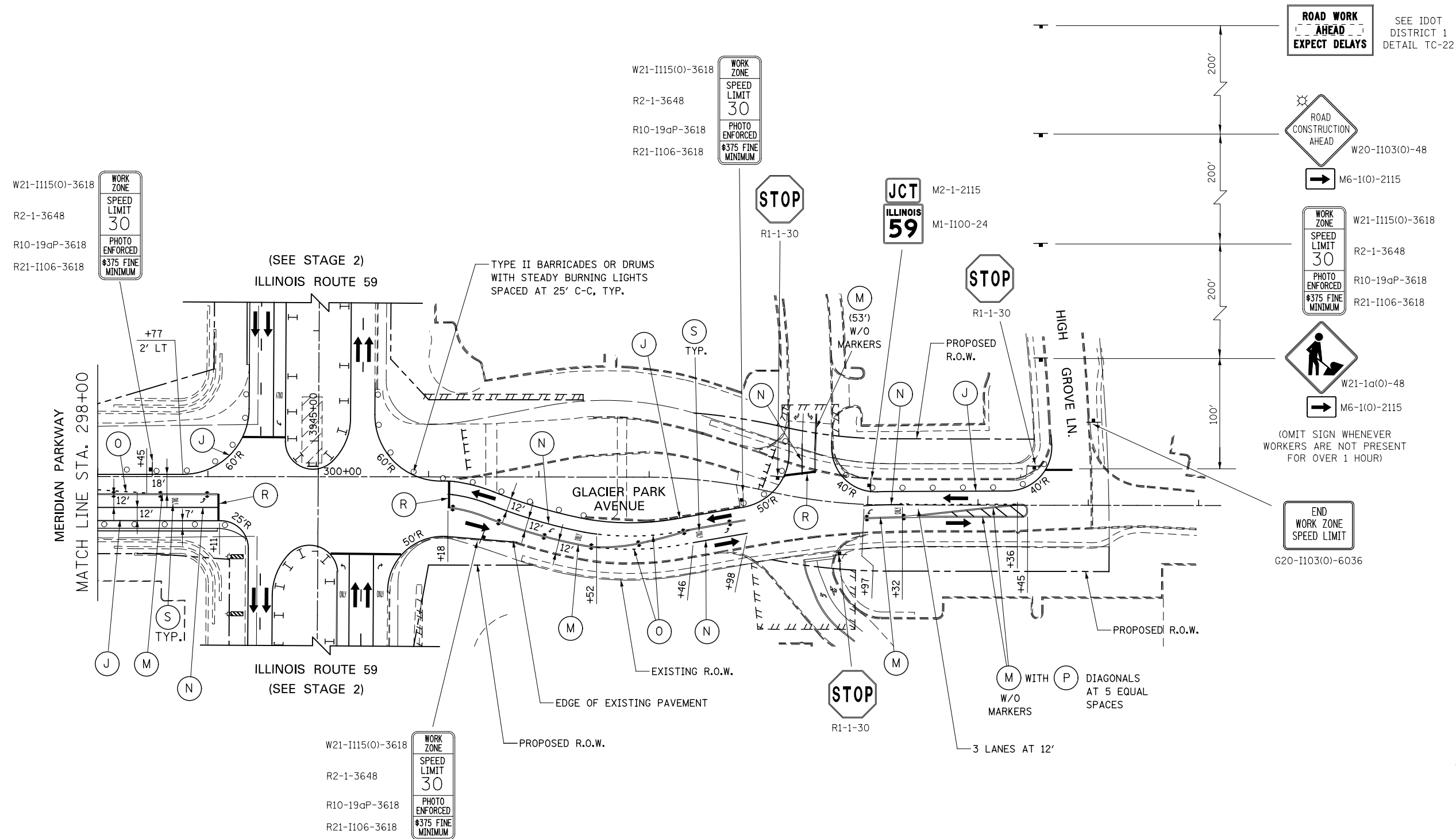

- ROAD WORK AHEAD EXPECT DELAYS SEE IDOT DISTRICT 1 DETAIL TC-22
- ROAD CONSTRUCTION AHEAD W20-I103(O)-48
- M6-1(O)-2115
- WORK ZONE SPEED LIMIT 30 PHOTO ENFORCED \$375 FINE MINIMUM W21-I115(O)-3618 R2-1-3648 R10-19aP-3618 R21-I106-3618
- W21-1a(O)-48
- M6-1(O)-2115
- (OMIT SIGN WHENEVER WORKERS ARE NOT PRESENT FOR OVER 1 HOUR)
- END WORK ZONE SPEED LIMIT G20-I103(O)-6036

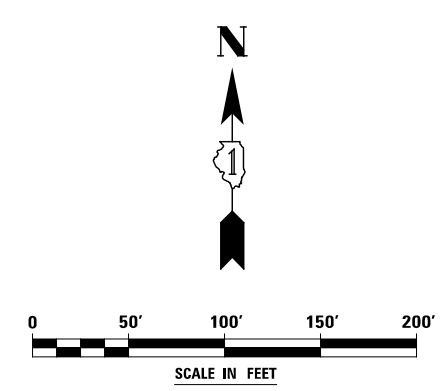

W21-I115(O)-3618
R2-1-3648
R10-19aP-3618
R21-I106-3618

W21-I115(O)-3618
R2-1-3648
R10-19aP-3618
R21-I106-3618

W21-I115(O)-3618
R2-1-3648
R10-19aP-3618
R21-I106-3618

MERIDIAN PARKWAY
MATCH LINE STA. 298+00

(SEE STAGE 2)
ILLINOIS ROUTE 59

ILLINOIS ROUTE 59
(SEE STAGE 2)

GLACIER PARK AVENUE

HIGH GROVE LN.

STATE OF ILLINOIS
DEPARTMENT OF TRANSPORTATION

MAINTENANCE OF TRAFFIC - STAGE 2B
GLACIER PARK AVENUE

F.A.P. RTE.	SECTION	COUNTY	TOTAL SHEETS	SHEET NO.
338	(112 & 113) WRS-7	DUPAGE	1156	217
CONTRACT NO. 60R30				

SCALE: AS SHOWN SHEET NO. 123 OF 195 SHEETS STA. 298+00 TO STA. 308+00

DESIGNED	PJO	REVISED	-
DRAWN	KES	REVISED	-
CHECKED	JCM	REVISED	-
DATE	12/14/2012	REVISED	-