

PLAN	SURVEYED	BY	DATE
NOTE BOOK	PLOTTED		
	CHECKED		
	ALIGNED		
	FILED		
	NO.		

PROFILE	SURVEYED	BY	DATE
NOTE BOOK	GRADES CHECKED		
	STRUCTURE		
	NOTATIONS		
	CHKD		
	NO.		

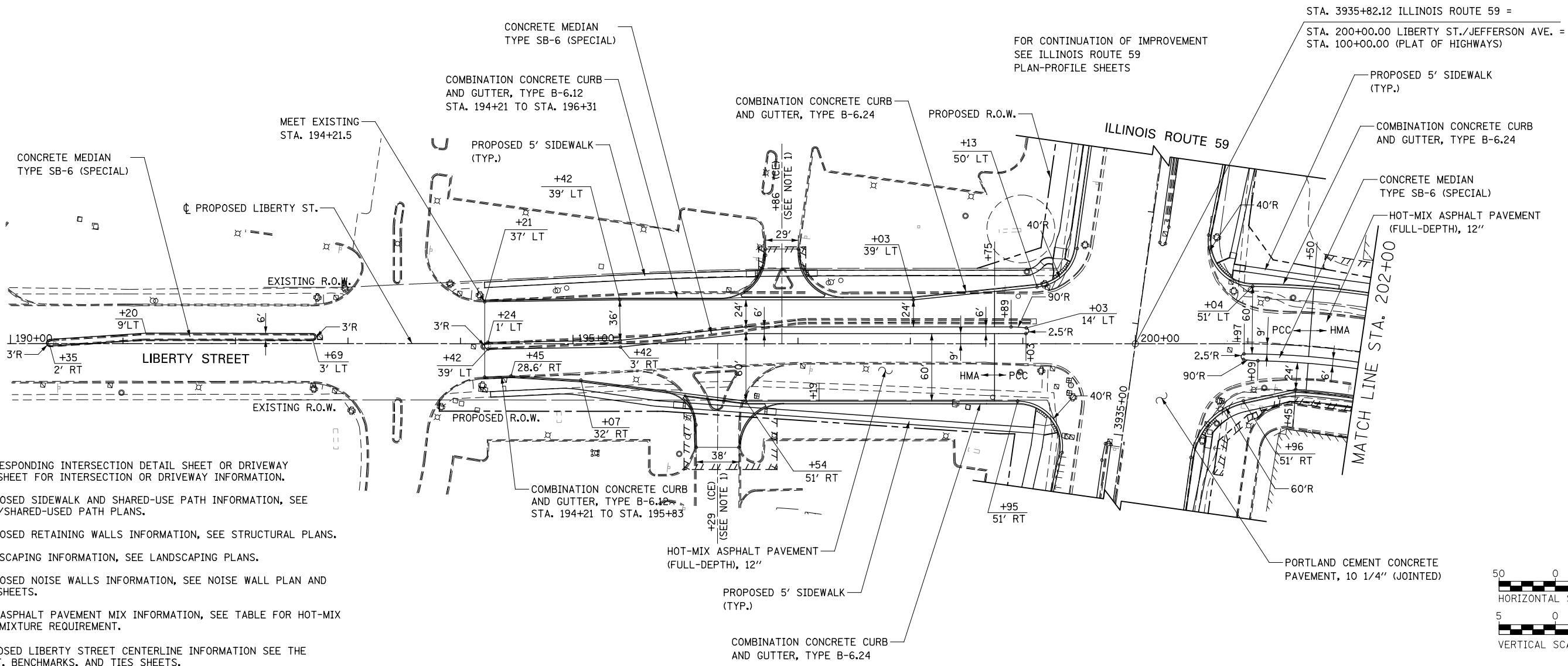

NOTES:

1. SEE CORRESPONDING INTERSECTION DETAIL SHEET OR DRIVEWAY DETAILS SHEET FOR INTERSECTION OR DRIVEWAY INFORMATION.
2. FOR PROPOSED SIDEWALK AND SHARED-USE PATH INFORMATION, SEE SIDEWALK/SHARED-USED PATH PLANS.
3. FOR PROPOSED RETAINING WALLS INFORMATION, SEE STRUCTURAL PLANS.
4. FOR LANDSCAPING INFORMATION, SEE LANDSCAPING PLANS.
5. FOR PROPOSED NOISE WALLS INFORMATION, SEE NOISE WALL PLAN AND PROFILE SHEETS.
6. FOR HMA ASPHALT PAVEMENT MIX INFORMATION, SEE TABLE FOR HOT-MIX ASPHALT MIXTURE REQUIREMENT.
7. FOR PROPOSED LIBERTY STREET CENTERLINE INFORMATION SEE THE ALIGNMENT, BENCHMARKS, AND TIES SHEETS.

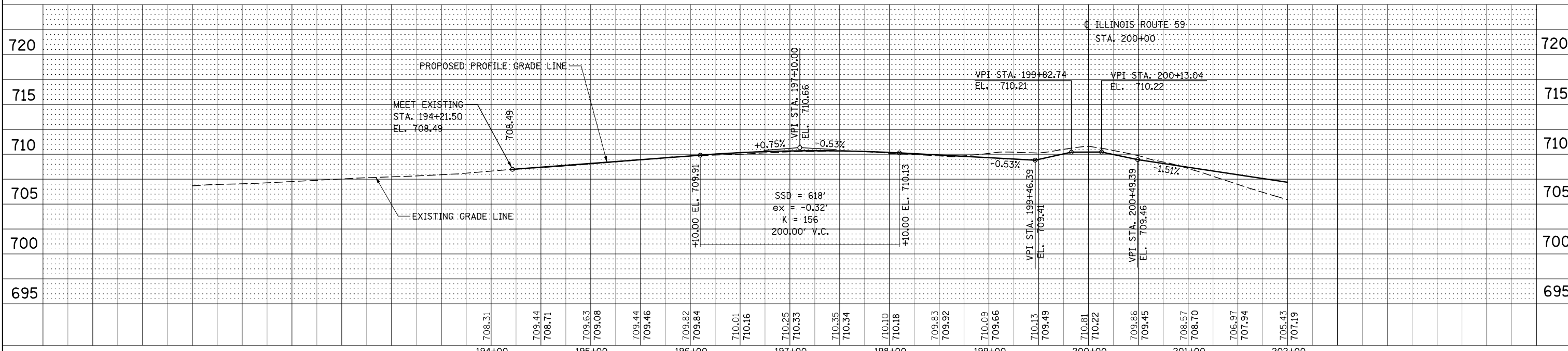
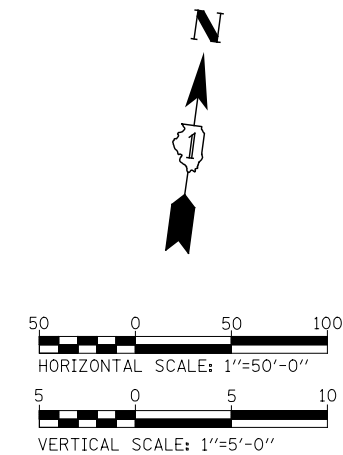

DESIGNED	PJO	REVISED	-
DRAWN	KES	REVISED	-
CHECKED	JCM	REVISED	-
DATE	12/14/2012	REVISED	-

**STATE OF ILLINOIS
DEPARTMENT OF TRANSPORTATION**

PLAN AND PROFILE - LIBERTY STREET

SCALE: AS SHOWN SHEET NO. 10 OF 16 SHEETS STA. 194+21 TO STA. 202+00

F.A.P. RTE.	SECTION	COUNTY	TOTAL SHEETS	SHEET NO.
338	(112 & 113) WRS-7	DUPAGE	1156	310
CONTRACT NO. 60R30				
ILLINOIS FED. AID PROJECT				