

**NOTES**

1. FOR PROPOSED ILLINOIS ROUTE 59 CENTERLINE INFORMATION SEE THE ALIGNMENT, BENCHMARKS, AND TIES SHEETS.

PROPOSED CURVE PRIL59-5  
 PI STA. = 3966+91.94, 39.91' LT  
 $\Delta = 3^\circ 32' 54.95''$  (LT)  
 $D = 1^\circ 48' 37.50''$   
 $R = 3,164.79'$   
 $T = 98.04'$   
 $L = 196.01'$   
 $E = 1.52'$   
 P.C. STA. = 3965+92.68, 38.50' LT  
 P.T. STA. = 3967+91.21, 44.31' LT  
 SE = NORMAL CROWN

PROPOSED CURVE PRIL59-6  
 PI STA. = 3966+93.22, 6.25' LT  
 $\Delta = 3^\circ 32' 09.72''$  (LT)  
 $D = 1^\circ 49' 24.20''$   
 $R = 3,142.27'$   
 $T = 96.95'$   
 $L = 197.90'$   
 $E = 1.50'$   
 P.C. STA. = 3965+92.00, 5.50' LT  
 P.T. STA. = 3967+90.36, 9.91' LT  
 SE = NORMAL CROWN

PROPOSED CURVE PRIL59-7  
 PI STA. = 3966+92.80, 9.36' RT  
 $\Delta = 3^\circ 40' 09.45''$  (LT)  
 $D = 1^\circ 48' 55.11''$   
 $R = 3,156.25'$   
 $T = 101.10'$   
 $L = 202.13'$   
 $E = 1.62'$   
 P.C. STA. = 3965+92.00, 5.50' RT  
 P.T. STA. = 3967+93.59, 9.98' RT  
 SE = NORMAL CROWN

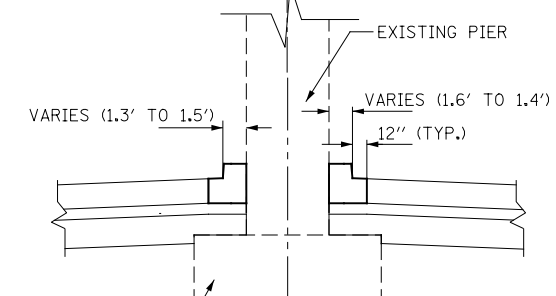
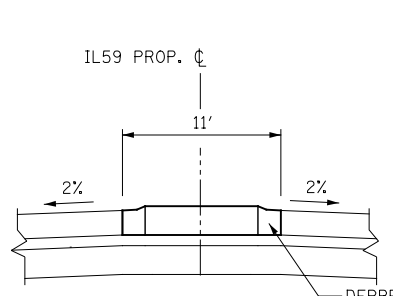
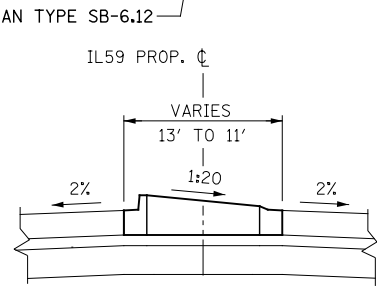
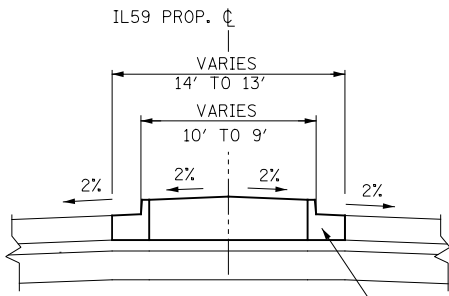
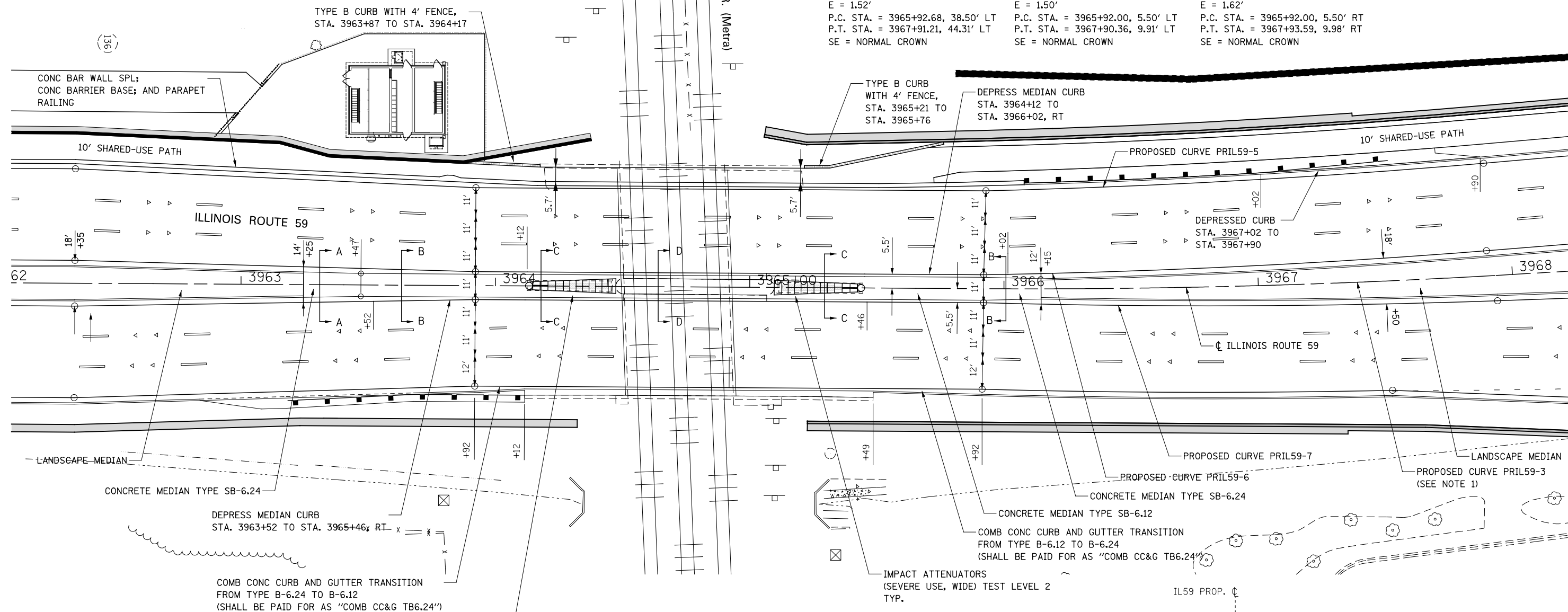

(CONCRETE MEDIAN TRANSITION, FROM TYPE SB-6.24 TO TYPE SB-6.12, SHALL BE PAID FOR AS "CONCRETE MEDIAN, TYPE SB-6.24")

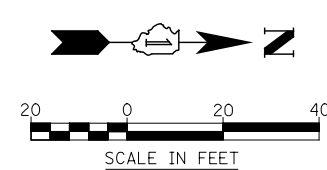

DESIGNED	PJO	REVISED	-	<b>STATE OF ILLINOIS DEPARTMENT OF TRANSPORTATION</b>	<b>ROADWAY DETAILS ENLARGED ROADWAY PLAN AT B.N.S.F. RAILROAD</b>			F.A.P. RTE.	SECTION	COUNTY	TOTAL SHEETS	SHEET NO.
DRAWN	KES	REVISED	-					338	(112 & 113) WRS-7	DUPAGE	1156	320
CHECKED	JCM	REVISED	-		CONTRACT NO. 60R30							
DATE	12/14/2012	REVISED	-		ILLINOIS FED. AID PROJECT							