

DATE	
BY	
DESIGNED	
DRAWN	
CHECKED	
DATE	
NO. 1	
NO. 2	
NO. 3	
NO. 4	
NO. 5	
NO. 6	
NO. 7	
NO. 8	
NO. 9	
NO. 10	

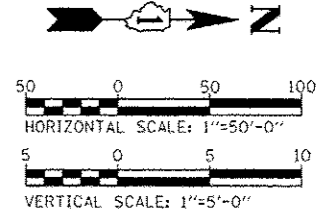

DATE	
BY	
DESIGNED	
DRAWN	
CHECKED	
DATE	
NO. 1	
NO. 2	
NO. 3	
NO. 4	
NO. 5	
NO. 6	
NO. 7	
NO. 8	
NO. 9	
NO. 10	

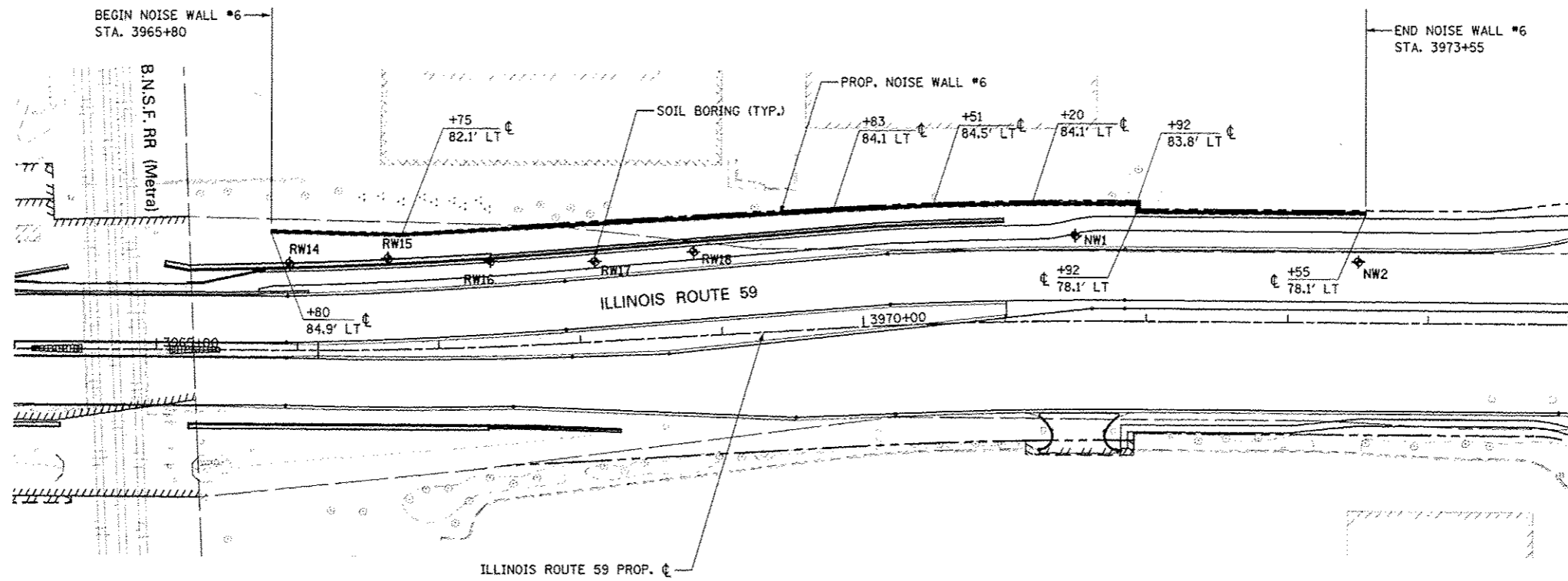
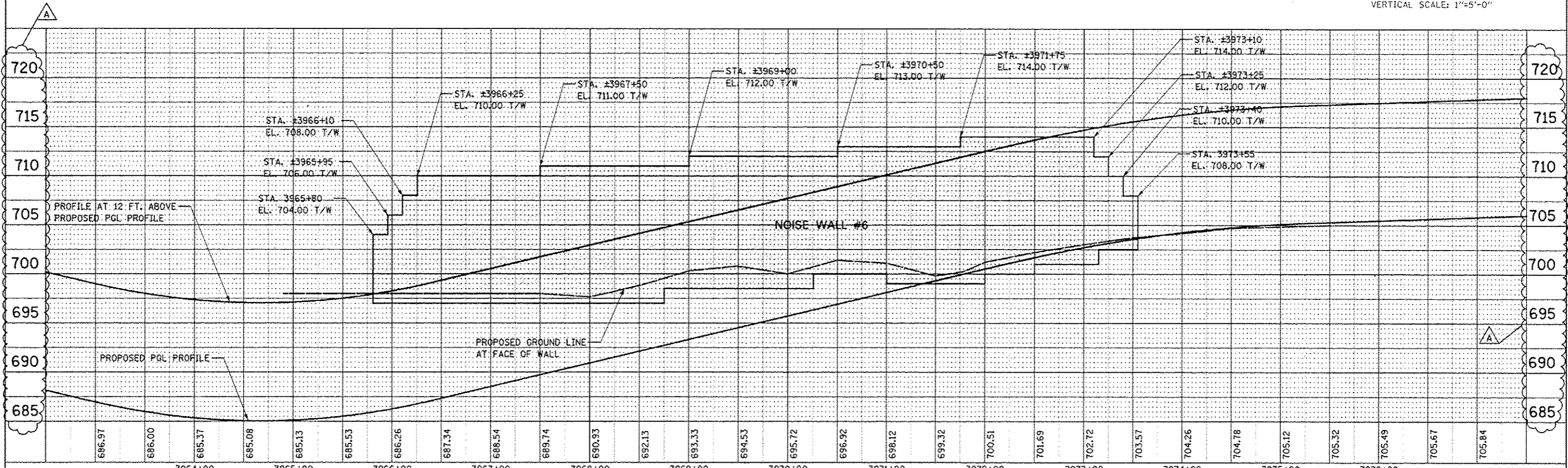

3964+00	3965+00	3966+00	3967+00	3968+00	3969+00	3970+00	3971+00	3972+00	3973+00	3974+00	3975+00	3976+00																
686.97	686.00	685.37	685.08	685.13	685.53	686.26	687.34	688.54	689.74	690.93	692.13	693.33	694.53	695.72	696.92	698.12	699.32	700.51	701.69	702.72	703.57	704.26	704.78	705.12	705.32	705.49	705.67	705.84

DESIGNED	PJO	REVISED - ADDENDUM A 02/20/2013
DRAWN	KES	REVISED -
CHECKED	JCM	REVISED -
DATE	12/14/2012	REVISED -

STATE OF ILLINOIS
DEPARTMENT OF TRANSPORTATION

NOISE WALL #6 - PLAN AND PROFILE
SCALE: AS SHOWN SHEET NO. 1 OF 2 SHEETS STA. 3965+80 TO STA. 3973+55

F.A.P. RTE.	SECTION	COUNTY	TOTAL SHEETS	SHEET NO.
338	(112 & 113) WRS-7	DUPAGE	1156	323
CONTRACT NO. GOR30				
FED. ROAD DIST. NO. ILLINOIS/FED. AID PROJECT				