

**LEGEND:**

-  HOT-MIX ASPHALT DRIVEWAY PAVEMENT, 10" (SEE NOTE 1)
-  SUBBASE GRANULAR MATERIAL, TYPE B 4"

**NOTES:**

1. FOR HMA MATERIAL REQUIREMENTS SEE HMA MIXTURE CHART ON THE GENERAL NOTE SHEET.

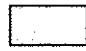
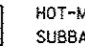
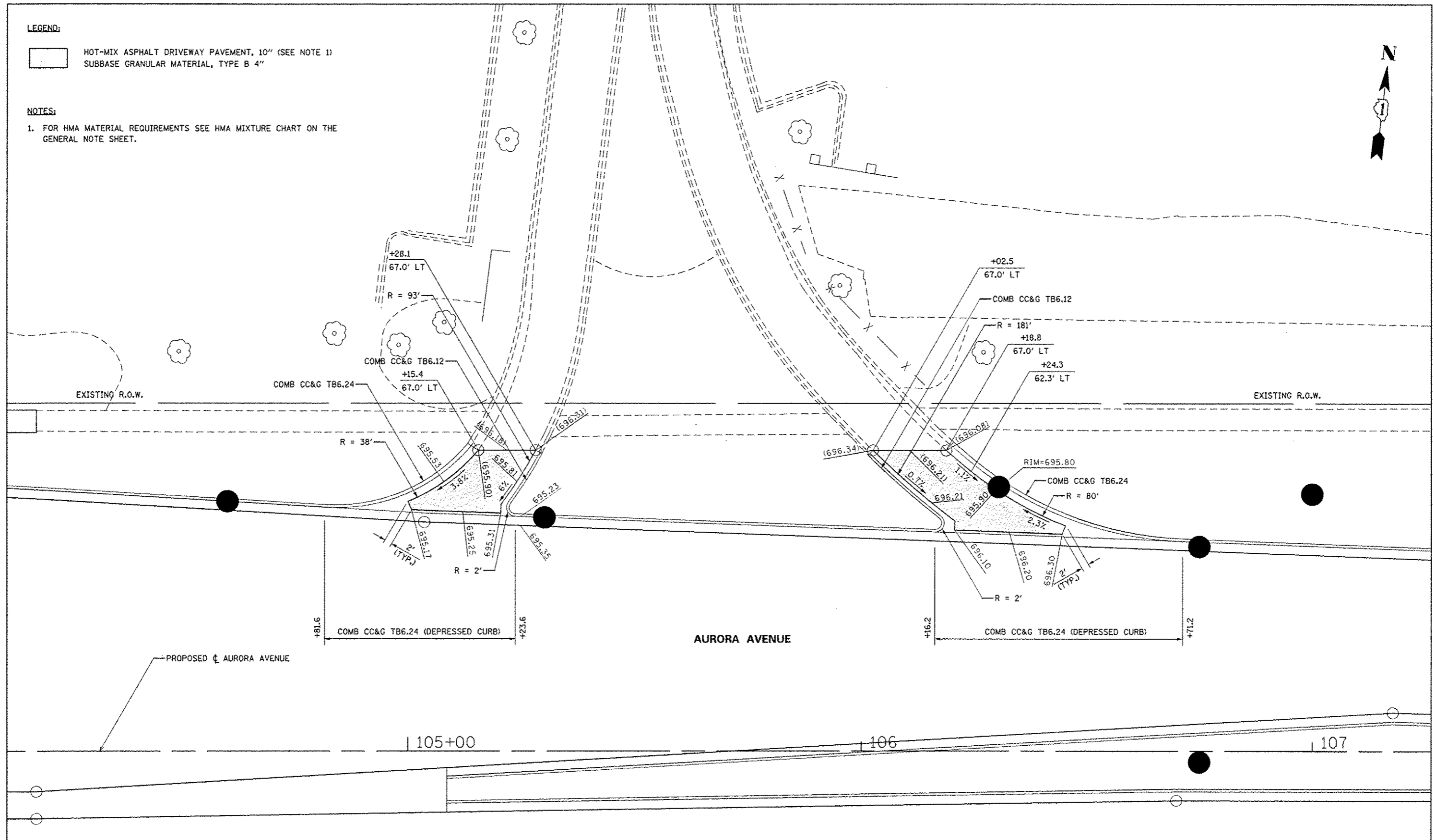

	DESIGNED <i>PJO</i> DRAWN <i>KES</i> CHECKED <i>JCM</i> DATE <i>12/14/2012</i>	REVISED - ADDENDUM A 02/20/2013 REVISED - REVISED - REVISED -	<b>STATE OF ILLINOIS</b> <b>DEPARTMENT OF TRANSPORTATION</b>	<b>DRIVEWAY DETAILS</b> <b>AURORA AVENUE - STA. 105+12 &amp; STA. 106+33</b>	F.A.P. RTE. 338 SECTION (112 & 113) WRS-7 COUNTY DUPAGE TOTAL SHEETS 1156 SHEET NO. 392 CONTRACT NO. 60R30 (ILLINOIS) FED. AID PROJECT
				SCALE: AS SHOWN SHEET NO. 20 OF 37 SHEETS STA. TO STA.	