

MATCH LINE STA. 3928+00
SEE DRAWING DE-02

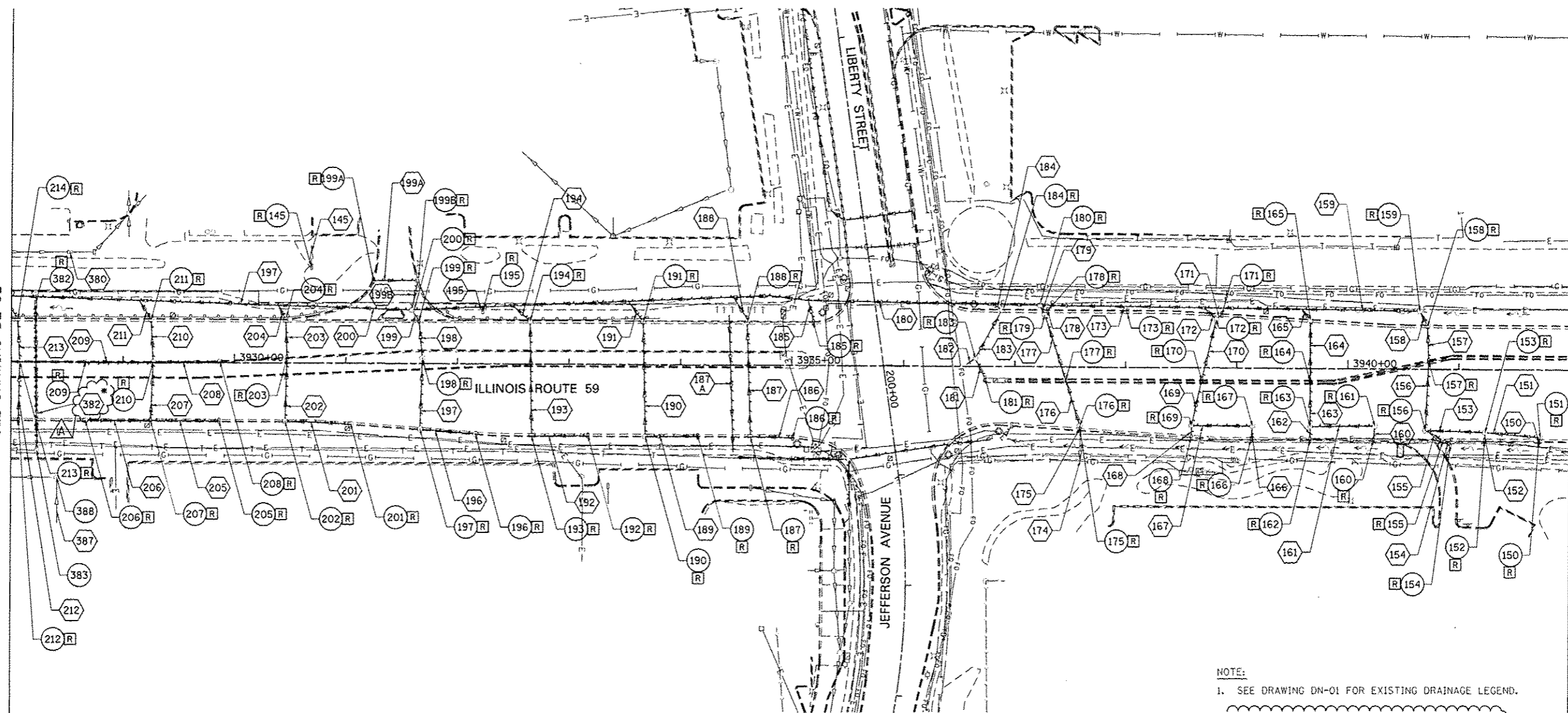

MATCH LINE STA. 3942+00
SEE DRAWING DE-04

NOTE:
1. SEE DRAWING DN-01 FOR EXISTING DRAINAGE LEGEND.

* REMOVAL OF EXISTING STRUCTURES NO. 4

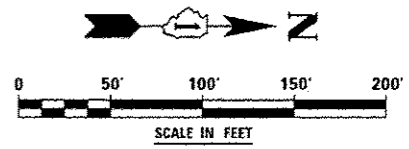

DESIGNED <i>PJO</i>	REVISED - ADDENDUM A 02/20/2013	STATE OF ILLINOIS DEPARTMENT OF TRANSPORTATION	EXISTING DRAINAGE PLAN - ILLINOIS ROUTE 59		F.A.P. RTE.	SECTION	COUNTY	TOTAL SHEETS	SHEET NO.	
DRAWN <i>KES</i>	REVISED -		SCALE: AS SHOWN	SHEET NO. 3 OF 15 SHEETS	STA. 3928+00 TO STA. 3942+00	338	(112 & 113) WRS-7	DUPAGE	1156	454
CHECKED <i>JCM</i>	REVISED -					DE-03		CONTRACT NO. 60R30		
DATE <i>12/14/2012</i>	REVISED -					ILLINOIS FED. AID PROJECT				