

PLAN	SURVEYED	BY	DATE
	PLOTTED		
	CHECKED		
	ALIGNED		
	FILED		
	NO. _____		
	FILE NAME _____		

MATCH LINE STA. 406+00
SEE DRAWING DP-14

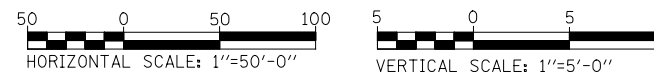
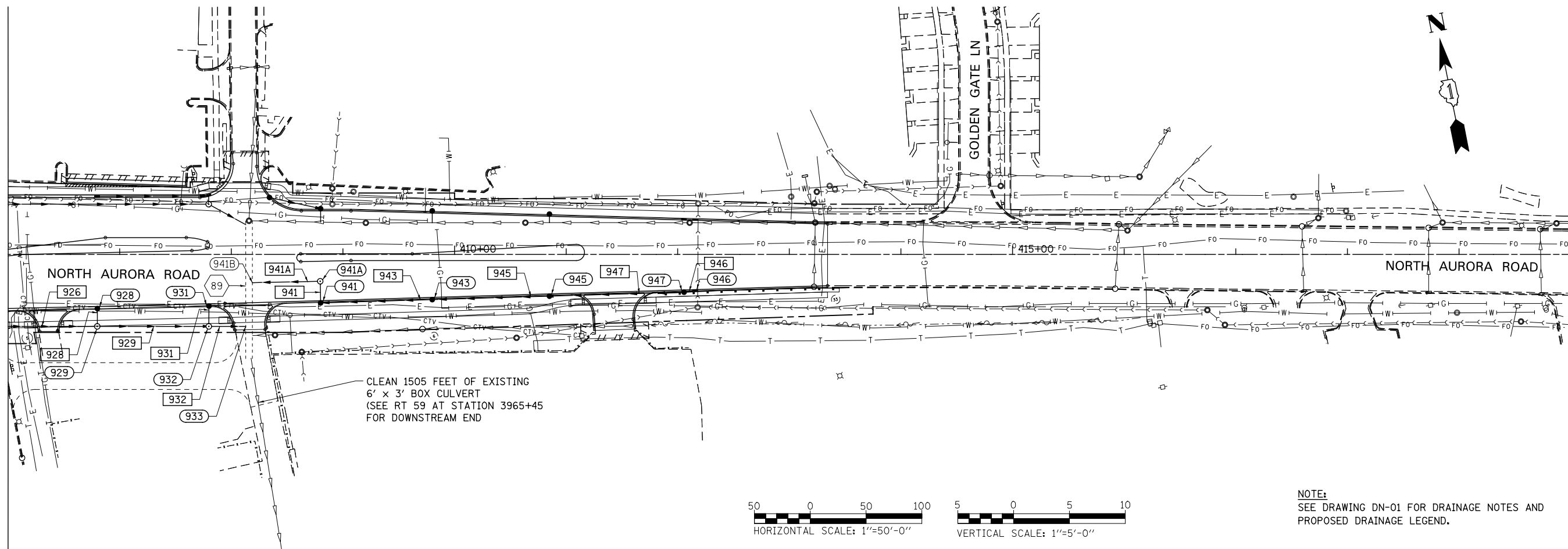

NOTE:
SEE DRAWING DN-01 FOR DRAINAGE NOTES AND PROPOSED DRAINAGE LEGEND.

PROFILE	SURVEYED	BY	DATE
	PLOTTED		
	GRADES CHECKED		
	STRUCTURE NOTATIONS CHECKED		
	NO. _____		

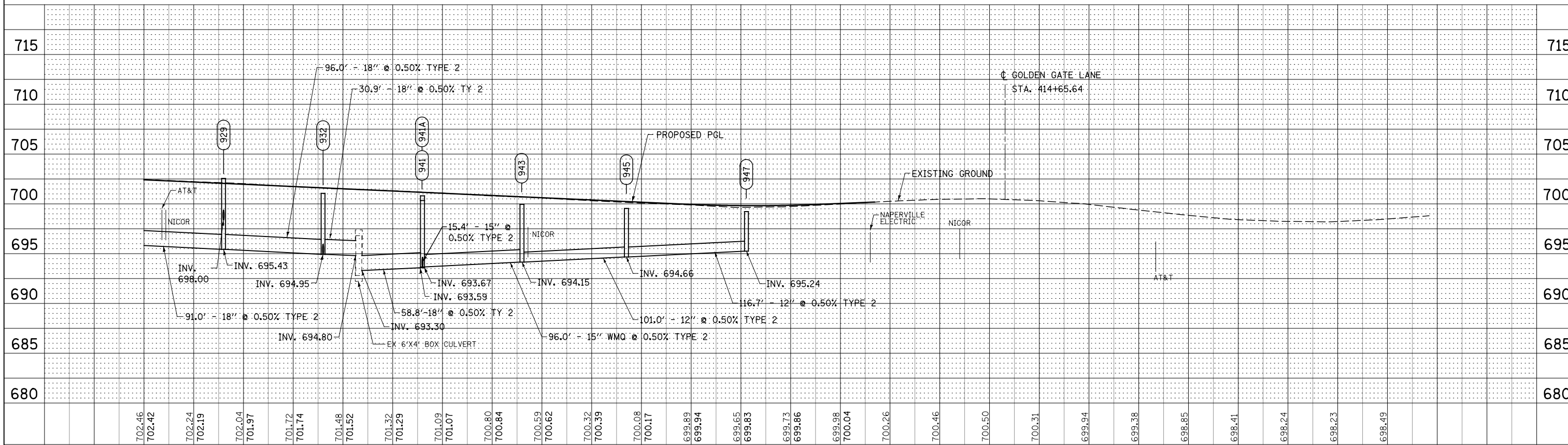

702.46	702.42	702.24	702.19	702.04	701.97	701.72	701.74	701.48	701.52	701.32	701.29	701.09	701.07	700.80	700.84	700.59	700.62	700.32	700.39	700.08	700.17	699.89	699.94	699.65	699.83	699.73	699.86	699.98	700.04	700.26	700.46	700.50	700.31	699.94	699.38	698.65	698.41	698.24	698.23	698.49
406+00		407+00		408+00		409+00		410+00		411+00		412+00		413+00		414+00		415+00		416+00		417+00		418+00		419+00														
DESIGNED <i>JWM</i>		REVISOR -		DRAWN <i>KES</i>		REVISOR -		CHECKED <i>JRS</i>		REVISOR -		DATE <i>12/14/2012</i>		REVISOR -																										

STATE OF ILLINOIS
DEPARTMENT OF TRANSPORTATION

PROPOSED DRAINAGE PLAN & PROFILE - NORTH AURORA ROAD

SCALE: 1"=50' SHEET NO. 23 OF 25 SHEETS STA. 406+00 TO STA. END

F.A.P. RTE.	SECTION	COUNTY	TOTAL SHEETS	SHEET NO.
338	(112 & 113) WRS-7	DUPAGE	1156	489
DP-15A			CONTRACT NO. 60R30	
FED. ROAD DIST. NO.		ILLINOIS FED. AID PROJECT		