

PLAN	DATE
BY	
CHECKED	
DESIGNED	
DRAWN	
DATE	

PROFILE	DATE
BY	
CHECKED	
DESIGNED	
DRAWN	
DATE	

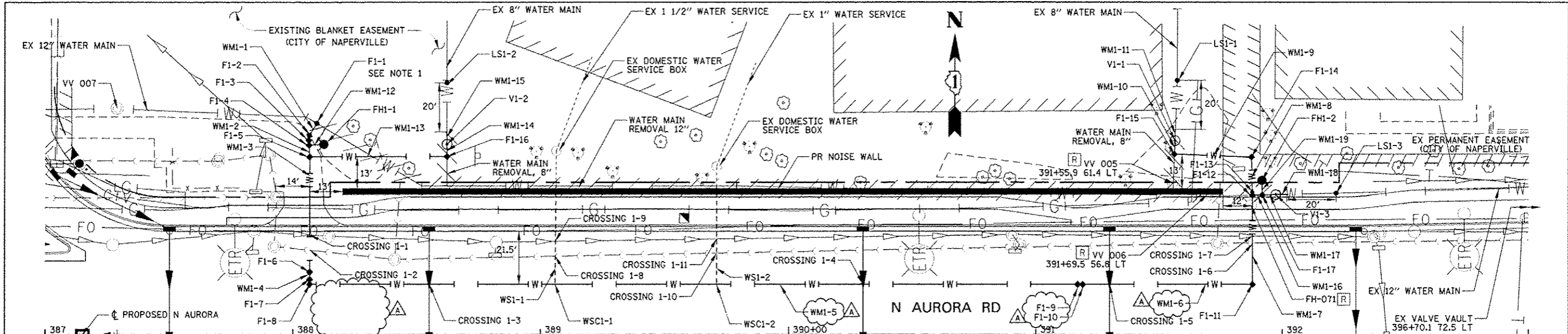

WATER MAIN PIPE		WATER MAIN FITTINGS		WATER MAIN CROSSINGS	
WMI-1 4' D I WATER MAIN 12 TRENCH BACKFILL 3.1 CU YD	WMI-10 4' D I WATER MAIN 8 TRENCH BACKFILL 1.6 CU YD	F1-2 DI WT MNF 12 45.0 DB 388+06.5 81.1 LT, R 709.2, C 703.0	F1-10 DI WT MNF 12 22.50 DB WM 391+19.0 20.5 LT, R 710.1, C 703.4	CROSSING 1-1: 388+06.8 40.5 LT R 709.8 I 705.0 EX STM C 703.0 PR WAT	CROSSING 1-4: 390+30.0 20.4 LT R 710.2 I 705.7 PR STM C 704.2 PR WAT
WMI-2 3' D I WATER MAIN 12 TRENCH BACKFILL 2.3 CU YD	WMI-11 4' D I WATER MAIN 8 TRENCH BACKFILL 1.9 CU YD	F1-3 DI WT MNF 12 22.50 DB 388+06.2 79.1 LT, R 709.2, C 703.0	F1-11 DI WT MNF 12 90.0 DB 391+87.9 20.5 LT, R 708.6, C 703.4	CROSSING 1-2: 388+06.7 34.5 LT R 709.8 I 702.0 PR WAT C 692.5 EX SAN	CROSSING 1-5: 391+30.2 20.4 LT R 710.2 I 704.9 PR STM C 703.4 PR WAT
WMI-3 4.5' D I WATER MAIN 12 DEFLECT PIPE ±3° TRENCH BACKFILL 35.1 CU YD	WMI-12 3' D I WATER MAIN 6 TRENCH BACKFILL 1.9 CU YD	F1-4 DI WAT MN TEE, 12X6 388+06.3 77.1 LT, R 709.2, C 703.0	F1-12 DI WAT MN TEE, 12X12 391+87.9 56.8 LT, R 708.8, C 703.8	CROSSING 1-3: 388+55.0 20.3 LT R 710.3 I 706.0 PR STM C 704.2 PR WAT	CROSSING 1-6: 391+87.9 37.4 LT R 708.0 I 702.6 PR WAT C 694.0 EX SAN
WMI-4 1' D I WATER MAIN 12 TRENCH BACKFILL 0.8 CU YD	WMI-13 5.4' D I WATER MAIN 8 DEFLECT PIPE ±3° TRENCH BACKFILL 3.3 CU YD	F1-5 DI WAT MN TEE, 12X8 388+06.6 72.4 LT, R 709.1, C 703.0	F1-13 DI WAT MN RED, 12X8 397+87.9 58.3 LT, R 708.8, C 703.8	CROSSING 1-7: 391+87.9 40.1 LT R 708.0 I 705.1 EX STM C 703.5 PR WAT	CROSSING 1-8: 389+06.0 31.9 LT R 710.3 I 706.9 EX STM C 705.2 PR WAT SERV
WMI-5 309' D I WATER MAIN 12 TRENCH BACKFILL 208.6 CU YD	WMI-14 3' D I WATER MAIN 8 TRENCH BACKFILL 1.4 CU YD	F1-6 DI WT MNF 12 22.50 DB WM 388+06.7 25.5 LT, R 710.1, C 703.0	F1-14 DI WT MNF 8 90.0 DB 391+87.6 72.3 LT, R 708.6, C 703.6	CROSSING 1-9: 391+87.9 37.4 LT R 710.2 I 706.3 EX STM C 704.8 PR WAT SERV	CROSSING 1-10: 389+71.0 33.2 LT R 710.3 I 692.1 EX SAN
WMI-6 67' D I WATER MAIN 12 TRENCH BACKFILL 45.7 CU YD	WMI-15 4' D I WATER MAIN 8 TRENCH BACKFILL 1.5 CU YD	F1-7 DI WT MNF 12 22.50 DB WM 388+06.7 22.5 LT, R 710.1, C 704.2	F1-15 DI WT MNF 8 90.0 DB 391+56.3 74.3 LT, R 710.8, C 705.8		
WMI-7 35' D I WATER MAIN 12 DEFLECT PIPE ±2° TRENCH BACKFILL 20.5 CU YD	WMI-16 2' D I WATER MAIN 12 TRENCH BACKFILL 1.4 CU YD	F1-8 DI WT MNF 12 90.0 DB 388+06.7 20.5 LT, R 710.1, C 704.2	F1-16 DI WT MNF 8 90.0 DB 388+62.1 72.5 LT, R 709.6, C 704.0		
WMI-8 13' D I WATER MAIN 8 DEFLECT PIPE ±4°	WMI-17 4' D I WATER MAIN 12 TRENCH BACKFILL 2.8 CU YD	F1-9 DI WT MNF 12 22.50 DB WM 391+17.0 20.5 LT, R 710.1, C 704.2	F1-17 DI WAT MN TEE, 12X6 391+91.9 56.9 LT, R 708.8, C 703.8		
WMI-9 30' D I WATER MAIN 8	WMI-18 4' D I WATER MAIN 12 TRENCH BACKFILL 2.8 CU YD				
	WMI-19 4' D I WATER MAIN 6 TRENCH BACKFILL 2.3 CU YD				

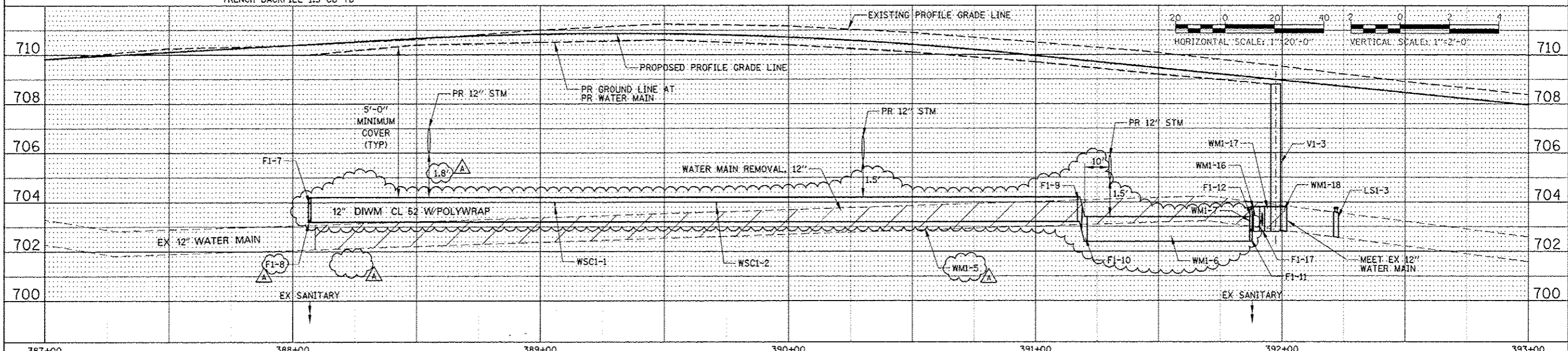

DESIGNED	CEO	REVISED - ADDENDUM A 02/20/2013	STATE OF ILLINOIS DEPARTMENT OF TRANSPORTATION	WATER MAIN PLAN AND PROFILE NORTH AURORA ROAD	F.A.P. RTE.	SECTION	COUNTY	TOTAL SHEETS	
DRAWN	CMW	REVISED -			338	(112 & 113) WRS-7	DUPAGE	115G	509
CHECKED	JCM	REVISED -			CONTRACT NO. 60R30				
DATE	12/14/2012	REVISED -			FED. ROAD DIST. NO. ILLINOIS FED. AID PROJECT				