

SYMBOL LEGEND

- INDICATES SIGN IS MOUNTED TO SIGNAL MAST ARM, SEE SIGNAL PLANS (TYP.)
- INDICATES SIGN IS MOUNTED TO A TRAFFIC SIGNAL POLE (TYP.)
- 1 REGULATORY SIGN (R SERIES)
- 1 WARNING SIGN (W SERIES)
- 1 GUIDE SIGN (D/M SERIES)
- 1 SPECIAL/OTHER SIGNS

PAVEMENT MARKING LEGEND (SEE NOTE 6)

- A PAVEMENT MARKING - LINE 4", SOLID WHITE
- B PAVEMENT MARKING - LINE 4", WHITE SKIP-DASH (10' LINE - 30' SPACE) WITH RAISED REFLECTIVE PAVEMENT MARKERS, ONE-WAY CRYSTAL (SPACED AT 80' C-C)
- C PAVEMENT MARKING - LINE 4", DOUBLE YELLOW WITH RAISED REFLECTIVE PAVEMENT MARKERS, ONE-WAY AMBER (SPACED AT 40' C-C)
- D PAVEMENT MARKING - LINE 4", DOUBLE YELLOW WITH RAISED REFLECTIVE PAVEMENT MARKERS, TWO-WAY AMBER (SPACED AT 40' C-C)
- E PAVEMENT MARKING - LINE 6", SOLID WHITE WITH RAISED REFLECTIVE PAVEMENT MARKERS, ONE-WAY CRYSTAL (SPACED AT 40' C-C)
- F PAVEMENT MARKING - LINE 6", WHITE DOTTED (2' LINE - 6' SPACE, UNLESS OTHERWISE NOTED)
- G PAVEMENT MARKING - LINE 6", SOLID WHITE
- H PAVEMENT MARKING - LINE 6", SOLID WHITE WITH 12" SOLID WHITE DIAGONALS AT 45°, SPACED AT 2'
- I PAVEMENT MARKING - LINE 8", SOLID WHITE
- J PAVEMENT MARKING - LINE 12", SOLID WHITE
- K PAVEMENT MARKING - LINE 12", SOLID YELLOW
- L PAVEMENT MARKING - LINE 24", SOLID WHITE
- M PAVEMENT MARKING - LETTERS & SYMBOLS

NOTES

1. SIGNAL POLES REQUIRE PEDESTRIAN PUSH BUTTON(S). EACH PUSH BUTTON SHALL HAVE REGULATORY SIGN R10-3e-915 (LEGEND 10R/10L) INSTALLED ABOVE THE PUSH BUTTON. SEE PEDESTRIAN BUTTON SIGN MOUNT DETAIL ON SPECIAL USE SIGNS LEGEND SHEET.
2. PAVEMENT MARKINGS AND RAISED REFLECTIVE PAVEMENT MARKERS SHALL BE PLACED IN ACCORDANCE WITH IDOT DISTRICT 1 DETAILS TC-11 AND TC-13.
3. SIGN LOCATIONS MAY VARY BASED ON FIELD CONDITIONS.
4. ALL POST-MOUNTED SIGNS SHALL BE MOUNTED ON TELESCOPING POLES IN ACCORDANCE WITH HIGHWAY STANDARD 728001 UNLESS OTHERWISE NOTED.
5. MAST ARM MOUNTED STREET NAME SIGNS ARE INTERNALLY ILLUMINATED STREET NAME SIGNS, SEE TRAFFIC SIGNAL PLANS.
6. ALL PERMANENT PAVEMENT MARKING ON PCC PAVEMENT SHALL BE POLYUREA PAVEMENT MARKING, TYPE I AND ON HMA PAVEMENT SHALL BE THERMOPLASTIC PAVEMENT MARKING OF THE TYPE SPECIFIED IN THE PAVEMENT MARKING LEGEND.

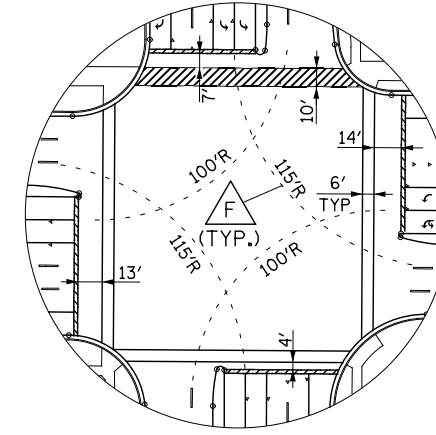

DETAIL

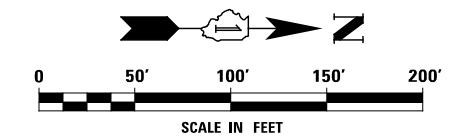
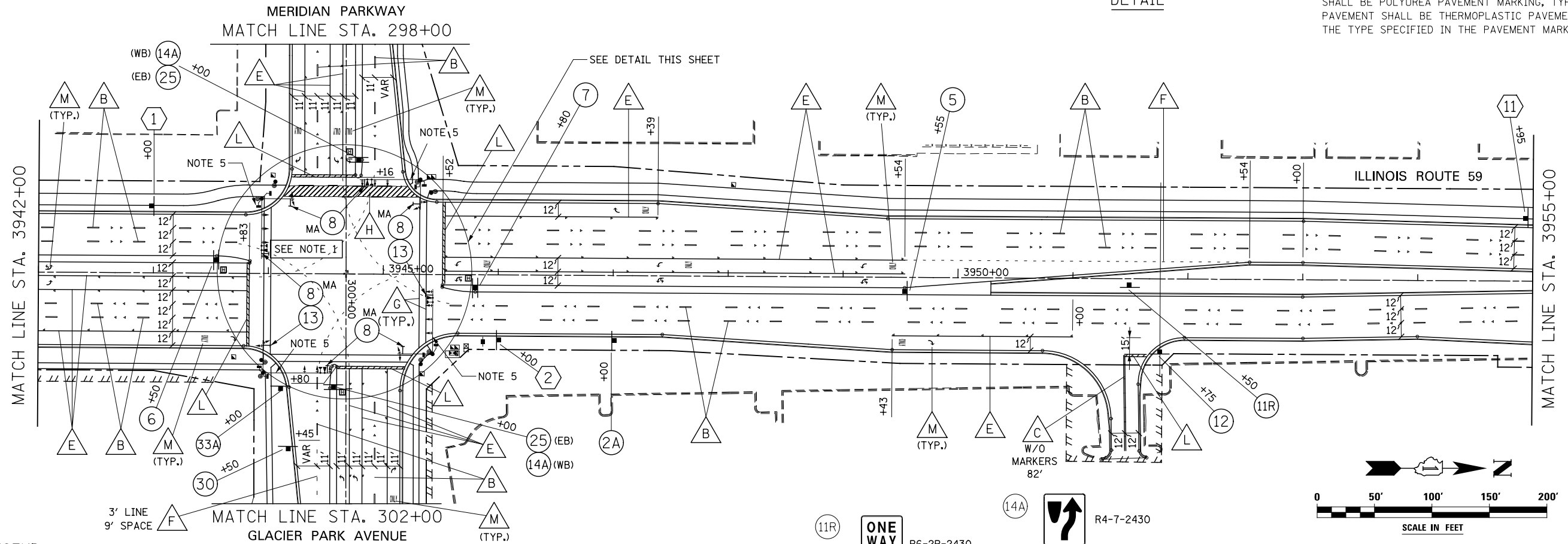

SIGN LEGEND

- 2A R2-1-3036 (40 MPH) SPEED LIMIT 40
- 5 R3-8(SPECIAL)-3630 ON GREEN ARROW ONLY
- 5 R-SPECIAL-2430 NO U-TURN VEHICLES OVER 22 FEET
- 6 R3-8(SPECIAL)-3630 (NB) ON GREEN ARROW ONLY
- 6 R4-7-2430 (SB) ON GREEN ARROW ONLY
- 6 R-SPECIAL-2430 (NB) NO U-TURN VEHICLES OVER 22 FEET
- 7 R3-8(SPECIAL)-3630 (SB) ON GREEN ARROW ONLY
- 7 R4-7-2430 (NB) ON GREEN ARROW ONLY
- 7 R-SPECIAL-2430 (SB) NO U-TURN VEHICLES OVER 22 FEET
- 8 R10-5-3036 LEFT ON GREEN ARROW ONLY
- 10R R10-3R-915 START CROSSING Wait For Vehicle, DON'T START Finish Crossing If Stopped, TIME REMAINING To Finish Crossing, DON'T CROSS TO CROSS PUSH BUTTON
- 10L R10-3L-915 START CROSSING Wait For Vehicle, DON'T START Finish Crossing If Stopped, TIME REMAINING To Finish Crossing, DON'T CROSS TO CROSS PUSH BUTTON
- 11R R6-2R-2430 ONE WAY
- 12 R1-1-30 R3-5R-3036 MOUNT ON SEPARATE POSTS STOP ONLY
- 13 R10-16-3036 U-TURN YIELD TO RIGHT TURN
- 25 R3-8-3630 ONLY ONLY
- 30 R3-7-36 RIGHT LANE MUST TURN RIGHT
- 33A R3-9oP-3012 BEGIN CLASS III TRUCK ROUTE R5-I102a-36
- 1 SOUTH ILLINOIS 59 M3-1-2412 M1-I100-24
- 2 NORTH ILLINOIS 59 M3-1-2412 M1-I100-24
- 11 ← Glacier Park Av Meridian Pkwy → D2-1-9630

DESIGNED	PJO	REVISED	-
DRAWN	KES	REVISED	-
CHECKED	JCM	REVISED	-
DATE	12/14/2012	REVISED	-

**STATE OF ILLINOIS
DEPARTMENT OF TRANSPORTATION**

PAVEMENT MARKING AND SIGNING - ILLINOIS ROUTE 59

SCALE: AS SHOWN SHEET NO. 5 OF 21 SHEETS STA. 3942+00 TO STA. 3955+00

F.A.P. RTE.	SECTION	COUNTY	TOTAL SHEETS	SHEET NO.
338	(112 & 113) WRS-7	DUPAGE	1156	581
CONTRACT NO. 60R30				
ILLINOIS FED. AID PROJECT				