

TEMPORARY VIDEO DETECTION MOUNTING DETAIL
 (NOT TO SCALE)

- ALL EXISTING SIGNAL HEADS SHALL BE BAGGED WHILE THE TEMPORARY TRAFFIC SIGNAL IS IN OPERATION
- THE CONTRACTOR SHALL INSTALL A WOOD SUPPORT PLATFORM AS SHOWN ON THE DISTRICT 1 SIGNAL DETAIL SHEETS FOR BOTH THE CONTROLLER CABINET AND UPS.
- THE TEMPORARY TRAFFIC SIGNAL CONTROL EQUIPMENT FOR THIS PROJECT SHALL BE "ECONOLITE" TO MATCH THE EXISTING ADJACENT SYSTEM

GENERAL NOTES

1. IT SHALL BE THE CONTRACTOR'S RESPONSIBILITY TO VERIFY ALL DIMENSIONS AND CONDITIONS EXISTING IN THE FIELD PRIOR TO ORDERING MATERIALS AND BEGINNING CONSTRUCTION. THIS SHALL INCLUDE LOCATING THE MAST ARM FOUNDATIONS AND VERIFYING THE MAST ARM LENGTHS.
2. THE EXACT LOCATION OF ALL UTILITIES SHALL BE FIELD VERIFIED BY THE CONTRACTOR BEFORE ORDERING ANY MATERIALS AND STARTING ANY WORK. FOR LOCATIONS OF UTILITIES, LOCALLY OWNED EQUIPMENT, LEASED ENFORCEMENT CAMERA SYSTEM FACILITIES AND IDOT UNDERGROUND FACILITIES, CONTACT THE LOCAL COUNTIES, MUNICIPALITIES AND IDOT FOR LOCATES. THE CONTRACTOR SHALL CALL "JULIE" AT (800) 892-0123 OR 811, IN THE CITY OF CHICAGO CONTACT DIGGER AT (312) 744-7000 FOR FIELD LOCATIONS OF BURIED UTILITIES (48 HOURS NOTIFICATION REQUIRED).
3. THE CONTRACTOR SHALL CHECK THE PROPOSED TRAFFIC SIGNAL EQUIPMENT LOCATIONS FOR OVERHEAD UTILITY CONFLICTS. THE CONTRACTOR SHALL COORDINATE ANY CONFLICTS WITH THE UTILITY COMPANIES AND THE RESIDENT ENGINEER BEFORE ORDERING MATERIALS.
4. THE CONTRACTOR SHALL COORDINATE CONSTRUCTION ACTIVITIES WITH UTILITY COMPANIES, LOCAL GOVERNMENT AGENCIES AND IDOT.

THIS INTERSECTION IS MAINTAINED BY THE CITY OF NAPERVILLE. CONTRACTOR SHALL CONTACT ANDY HYNES AT 630-548-2958 PRIOR TO START OF CONSTRUCTION.

RESTORATION OF WORK AREA. RESTORATION OF THE TRAFFIC SIGNAL WORK AREA SHALL BE INCLUDED IN THE RELATED PAY ITEM SUCH AS FOUNDATION, CONDUIT, HANDHOLE, TRENCH AND BACKFILL, ETC., AND NO EXTRA COMPENSATION SHALL BE ALLOWED. ALL ROADWAY SURFACES SUCH AS SHOULDERS, MEDIAN, SIDEWALKS, PAVEMENT ETC. SHALL BE REPLACED IN KIND. ALL DAMAGE TO MOWED LAWNS SHALL BE REPLACED WITH AN APPROVED SOD, AND ALL DAMAGE TO UNMOWED FIELDS SHALL BE SEEDED IN ACCORDANCE WITH STANDARD SPECIFICATIONS 252 AND 250 RESPECTIVELY.

MATCHLINE AURORA AVE. STA. 111 + 25

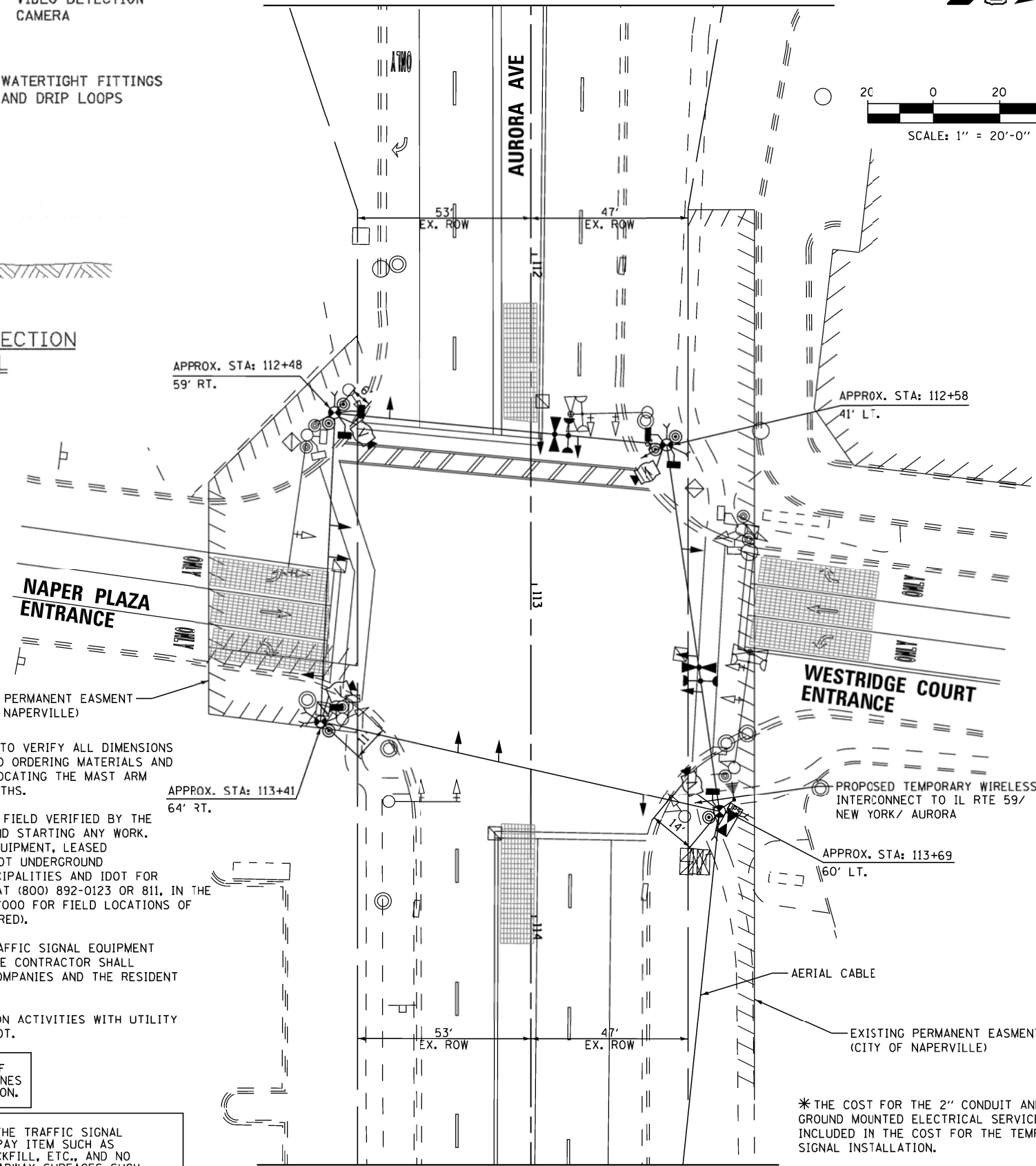

MATCHLINE AURORA AVE. STA. 114 + 75

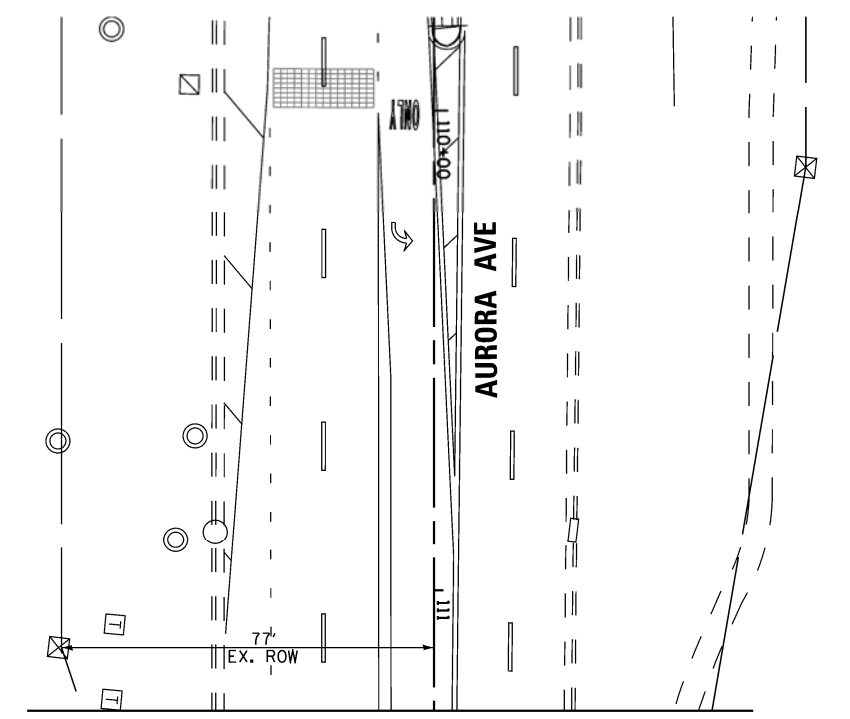
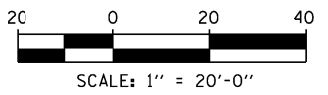

MATCHLINE AURORA AVE. STA. 111 + 25

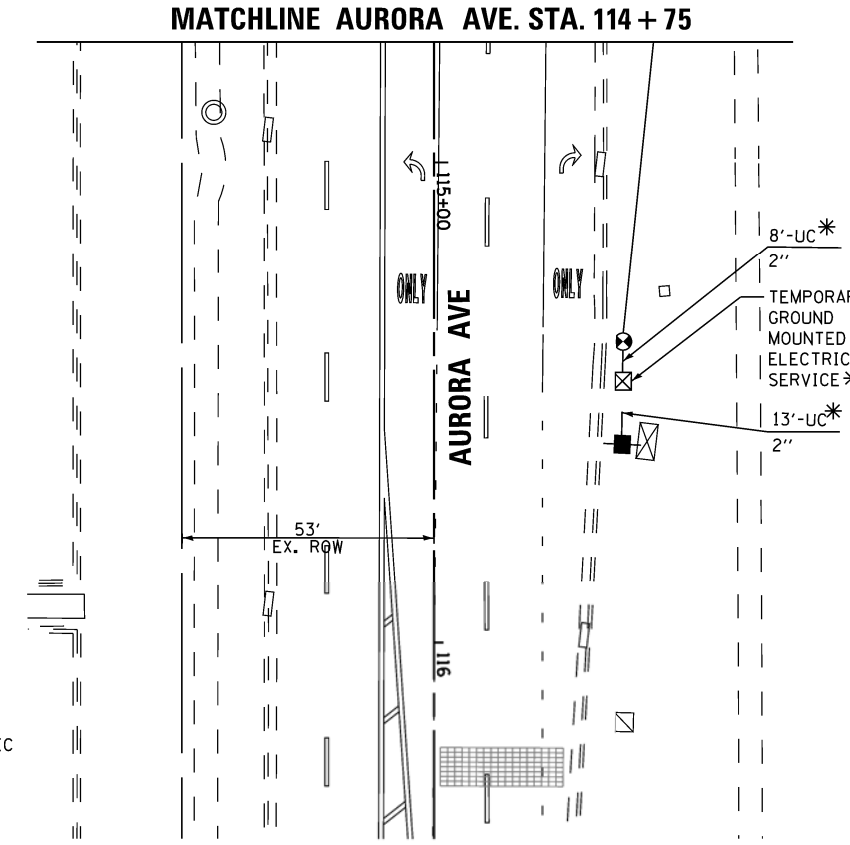

MATCHLINE AURORA AVE. STA. 114 + 75

* THE COST FOR THE 2" CONDUIT AND TEMPORARY GROUND MOUNTED ELECTRICAL SERVICE SHALL BE INCLUDED IN THE COST FOR THE TEMPORARY TRAFFIC SIGNAL INSTALLATION.

FILE NAME =	USER NAME = #USER#	DESIGNED - DW	REVISED -	STATE OF ILLINOIS	TEMPORARY TRAFFIC SIGNAL INSTALLATION	F.A. RTE.	SECTION	COUNTY	TOTAL SHEETS	SHEET NO.
K:\Projects\090059\Design\Sheet Files\1679rwa59tempACL.dgn		DRAWN - JDH	REVISED -	DEPARTMENT OF TRANSPORTATION	AURORA AVE AT NAPER PLAZA/WESTRIDGE COURT ENTRANCE	338	(112 & 113) WRS-7	DUPAGE	1156	611
	PLOT SCALE = #SCALE#	CHECKED - KMM	REVISED -		SCALE: 1"=20'	SHEET NO. 1 OF 2 SHEETS		STA.	TO STA.	
	PLOT DATE = 12/6/2012	DATE -	REVISED -				TS-19	CONTRACT NO. 60R30		ILLINOIS FED. AID PROJECT