

TEMPORARY TRAFFIC SIGNAL STAGE 1

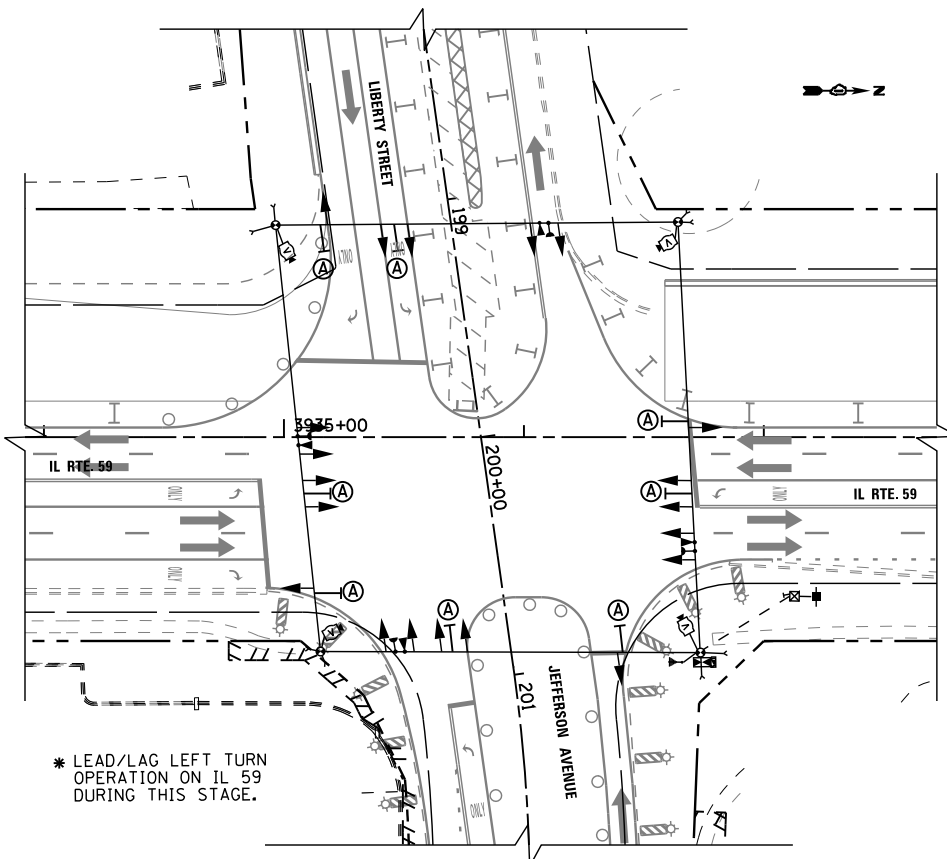

TEMPORARY TRAFFIC SIGNAL STAGE 1A

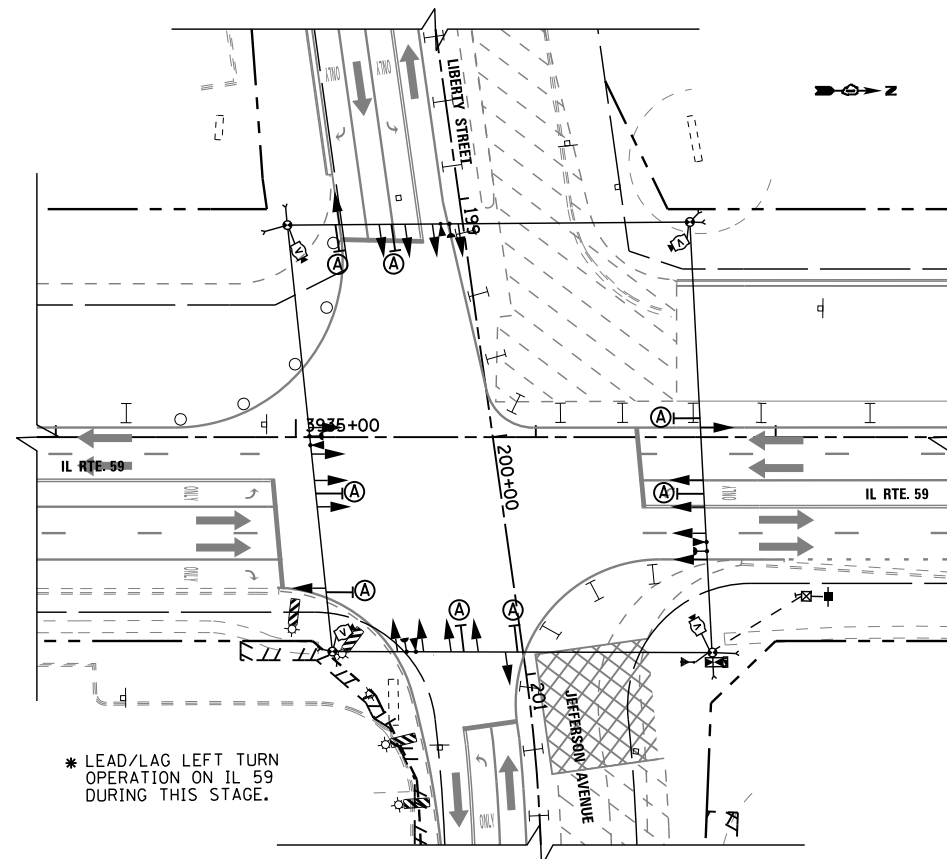

TEMPORARY TRAFFIC SIGNAL STAGE 1B

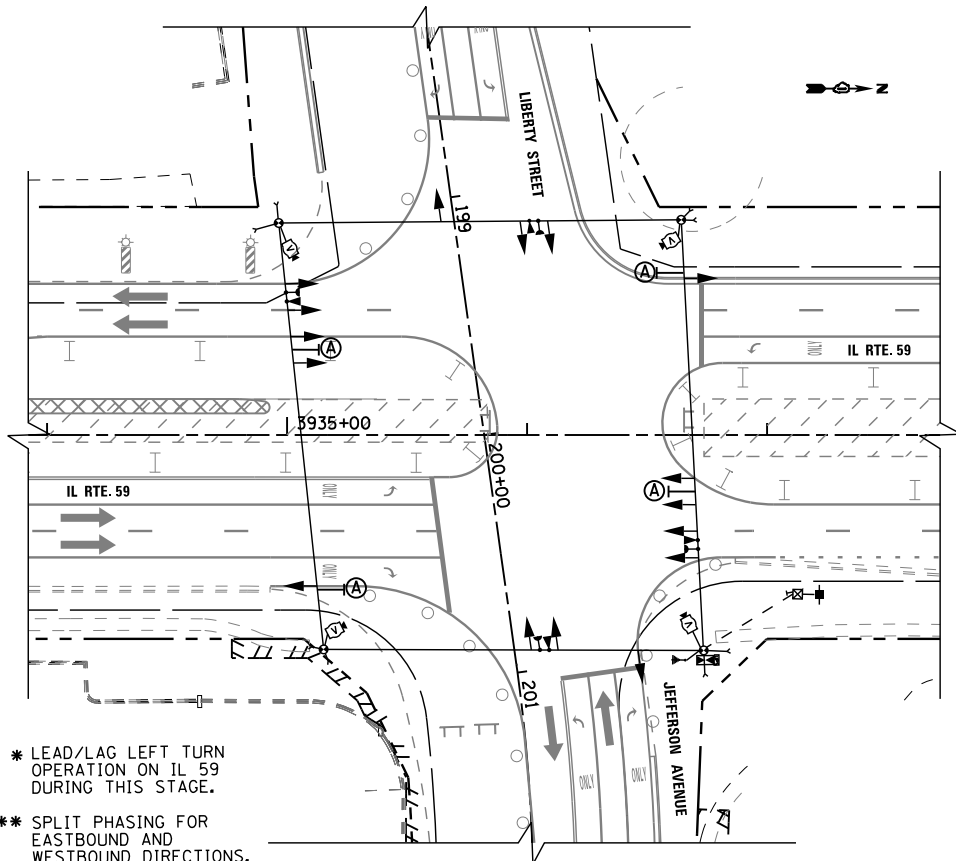

TEMPORARY TRAFFIC SIGNAL STAGE 2

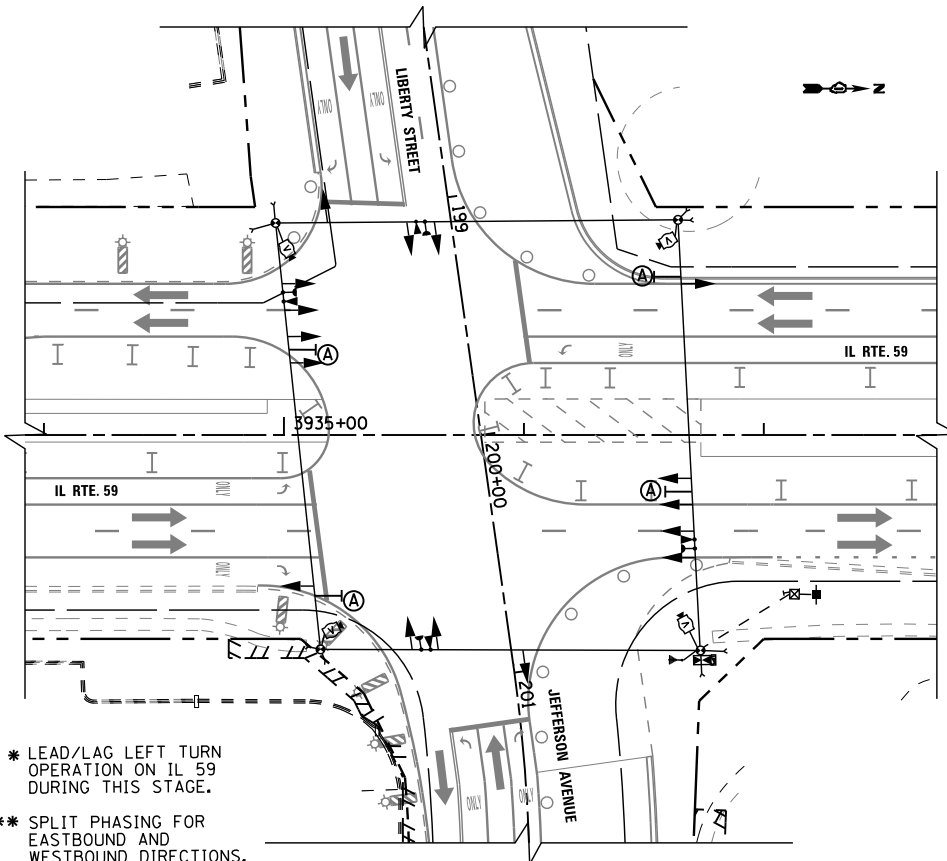

TEMPORARY TRAFFIC SIGNAL STAGE 2A

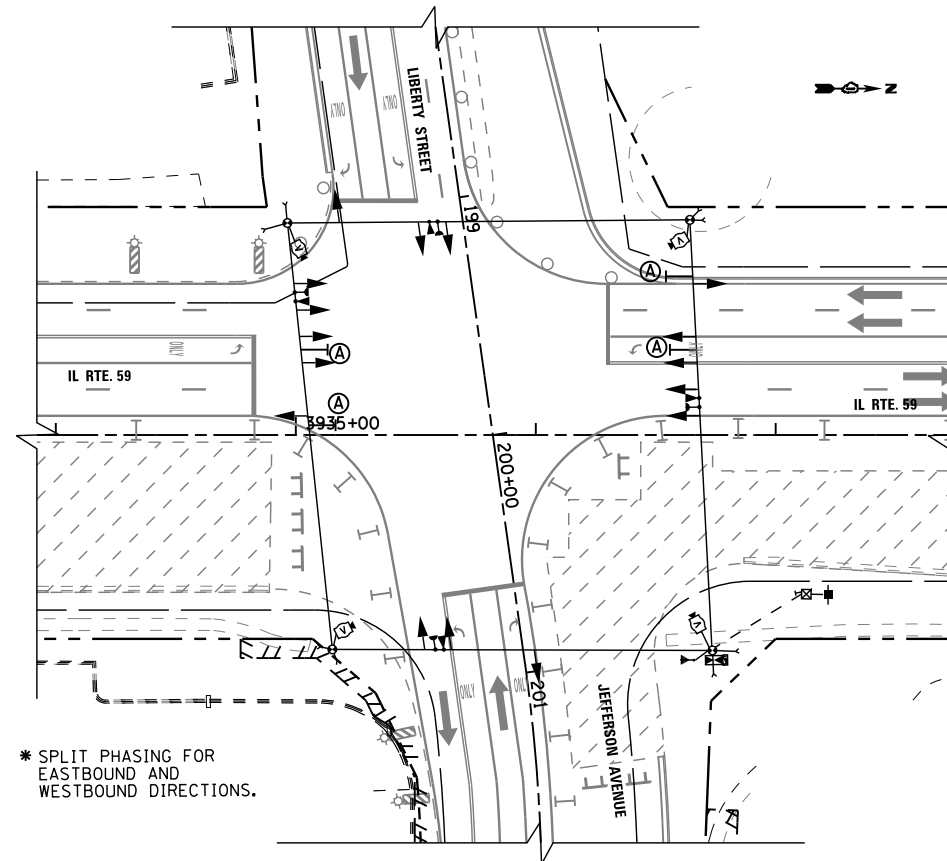

TEMPORARY TRAFFIC SIGNAL STAGE 3

* LEAD/LAG LEFT TURN OPERATION ON IL 59 DURING THIS STAGE.
 ** SPLIT PHASING FOR EASTBOUND AND WESTBOUND DIRECTIONS.

* LEAD/LAG LEFT TURN OPERATION ON IL 59 DURING THIS STAGE.
 ** SPLIT PHASING FOR EASTBOUND AND WESTBOUND DIRECTIONS.

* SPLIT PHASING FOR EASTBOUND AND WESTBOUND DIRECTIONS.

FILE NAME =	USER NAME = \$USER\$	DESIGNED - DW	REVISED -
K:\Projects\090059\Design\Sheet Files\679rwa59templJ2.dgn		DRAWN - JDH	REVISED -
	PLOT SCALE = \$SCALE\$	CHECKED - KMM	REVISED -
	PLOT DATE = 12/6/2012	DATE -	REVISED -

**STATE OF ILLINOIS
 DEPARTMENT OF TRANSPORTATION**

**TEMPORARY TRAFFIC SIGNAL INSTALLATION
 MOT STAGING PLAN (1 OF 2)
 IL RTE 59 AT LIBERTY ST / JEFFERSON AVE**

SCALE: NTS

SHEET NO. 2 OF 3 SHEETS STA. TO STA.

F.A. RTE.	SECTION	COUNTY	TOTAL SHEETS	SHEET NO.
338	(112 & 113) WRS-7	DUPAGE	1156	623
TS- 31		CONTRACT NO. 60R30		
ILLINOIS FED. AID PROJECT				