

MATCHLINE IL RTE. 59 STA. 3973 + 00

MATCHLINE NORTH AURORA RD STA. 398 + 10

MATCHLINE IL RTE. 59 STA. 3979 + 00

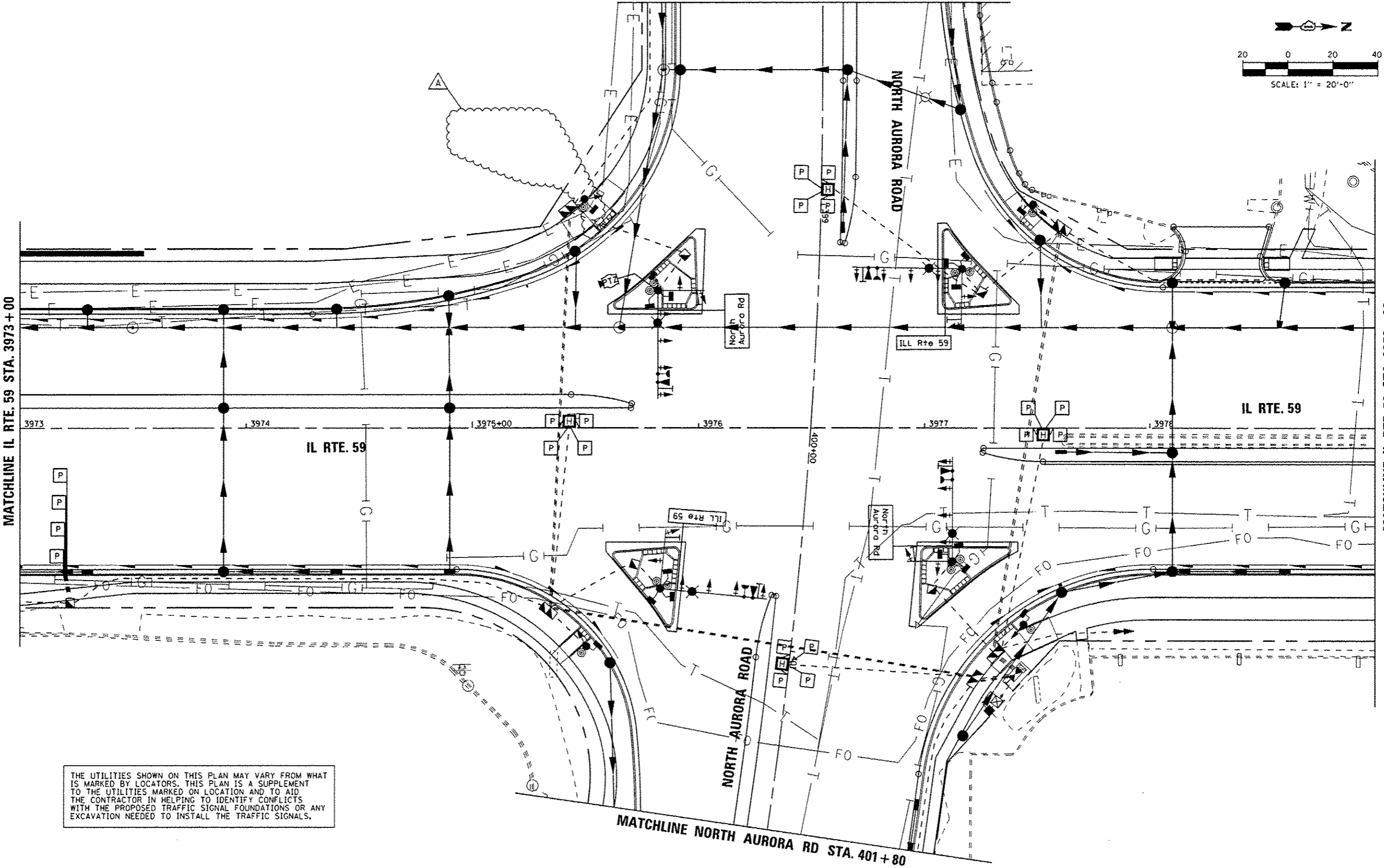
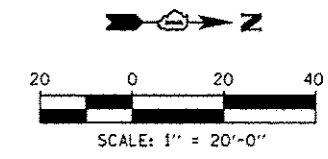

THE UTILITIES SHOWN ON THIS PLAN MAY VARY FROM WHAT IS MARKED BY LOCATORS. THIS PLAN IS A SUPPLEMENT TO THE UTILITIES MARKED ON LOCATION AND TO AID THE CONTRACTOR IN HELPING TO IDENTIFY CONFLICTS WITH THE PROPOSED TRAFFIC SIGNAL FOUNDATIONS OR ANY EXCAVATION NEEDED TO INSTALL THE TRAFFIC SIGNALS.

MATCHLINE NORTH AURORA RD STA. 401 + 80

FILE NAME *	USER NAME * #USER#	DESIGNED - DW	REVISED - Addendum A 02/20/2013
K:\Projects\0902059\Design\Sheet Files\EXHIBIT\6799_wa59\prn\AI-EXHIBIT.dgn		DRAWN - JDH	REVISED -
		CHECKED - KMM	REVISED -
		DATE -	REVISED -

STATE OF ILLINOIS  
 DEPARTMENT OF TRANSPORTATION

UTILITY REFERENCE PLAN		F.A. RTE.	SECTION	COUNTY	TOTAL SHEETS	SHEET NO.
IL RTE 59 AT NORTH AURORA ROAD		338	(112 & 113) WRS-7	DUPAGE	1156	652
SCALE: 1"=20'		SHEET NO. 1 OF 1 SHEETS		STA.	TO STA.	

TS-60		ILLINOIS FED. AID PROJECT	
CONTRACT NO. 60R30			