

ELEVATION - FORM LINER

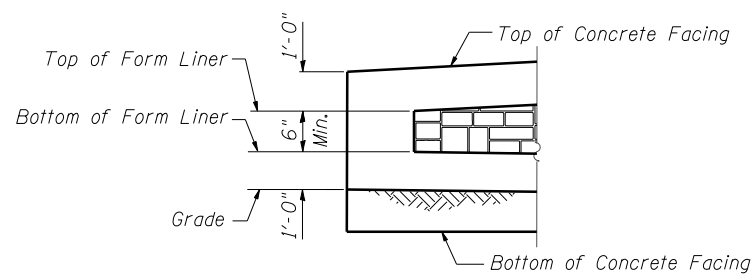

END FORM LINER FINISH

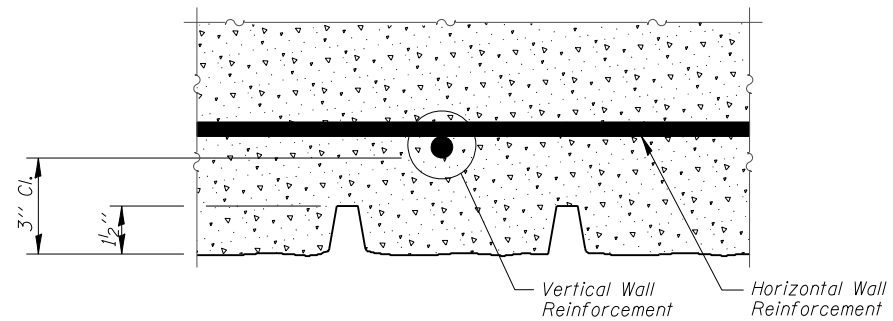

PLAN - FORM LINER

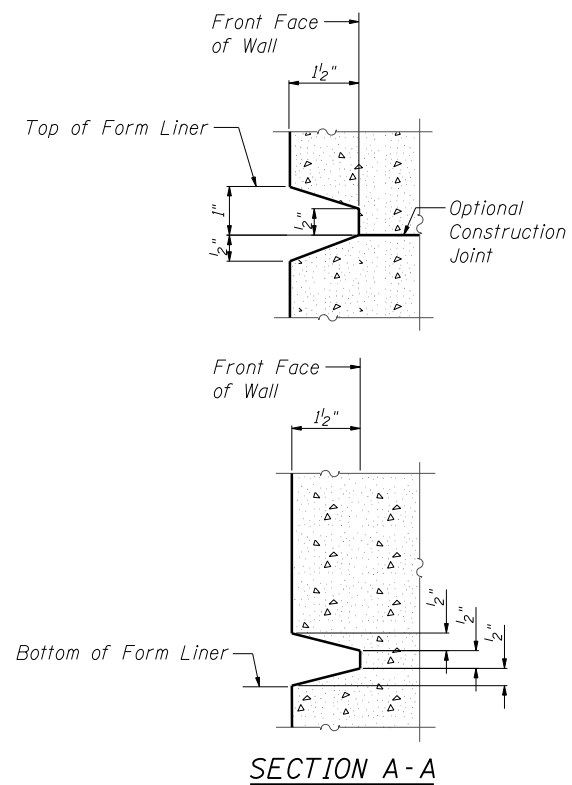

FORM LINER ELEVATION TABLE

Station	Form Liner Top Elevation	Form Liner Bottom Elevation
3968+25.00	None	None
3968+21.96	692.69	692.19
3968+11.07	698.00	692.06
3967+95.15	698.00	691.55
3967+65.79	698.00	690.87
3967+36.36	698.00	690.20
3967+06.90	698.00	689.47
3966+77.42	698.00	688.73
3966+47.93	698.00	688.00
3966+18.43	698.00	687.46
3965+88.87	698.00	686.92
3965+58.87	698.00	686.38
3965+48.32	698.00	686.20
3965+40.93	698.00	689.93
3965+25.96	698.00	697.50
3965+23.00	None	None

FILE NAME = ...60R30-W047-010-ArchFinish.dgn



DESIGNED - LAS	REVISED -
CHECKED - DAZ	REVISED -
DRAWN - SAW	REVISED -
CHECKED - LAS	REVISED -
SCALE - NONE	
DATE - 12/14/2012	

STATE OF ILLINOIS
DEPARTMENT OF TRANSPORTATION

ARCHITECTURAL FINISH DETAILS
STA. 3965 + 23.00 TO STA. 3968 + 25.00 SN 022-W047

SHEET NO. SA-10 OF SA-13 SHEETS

F.A.P. RTE.	SECTION	COUNTY	TOTAL SHEETS	SHEET NO.
338	(112 & 113) WRS-7	DUPAGE	1156	856
			CONTRACT NO. 60R30	
ILLINOIS FED. AID PROJECT				