

SECTION THRU CONCRETE FACING

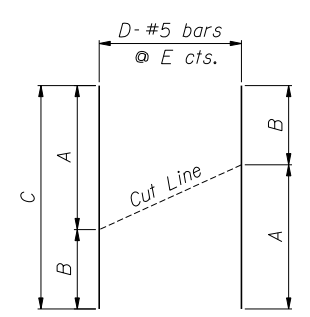

CUTTING DIAGRAM

Bar	A	B	C	D	E
h401(E)	33'-8"	13'-0"	46'-8"	14	10"
v400(E)	2'-9"	14'-8"	17'-5"	22	12"
v404(E)	13'-9"	13'-2"	26'-11"	31	12"
v405(E)	13'-2"	12'-6"	25'-8"	31	12"
v406(E)	12'-6"	11'-9"	24'-3"	31	12"
v407(E)	11'-9"	10'-10"	22'-7"	31	12"
v408(E)	10'-10"	10'-0"	20'-10"	31	12"
v409(E)	10'-0"	9'-5"	19'-5"	31	12"
v410(E)	9'-5"	8'-7"	18'-0"	31	12"
v411(E)	8'-7"	7'-8"	16'-3"	31	12"
v412(E)	7'-8"	6'-8"	14'-4"	31	12"
v413(E)	6'-8"	5'-8"	12'-4"	31	12"
v414(E)	5'-8"	4'-8"	10'-4"	31	12"
v415(E)	4'-8"	3'-5"	8'-1"	30	12"
v416(E)	3'-5"	2'-4"	5'-9"	30	12"

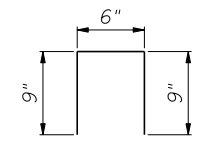

BAR d400(E)

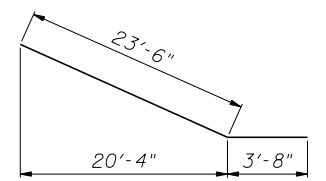

BAR h403(E)

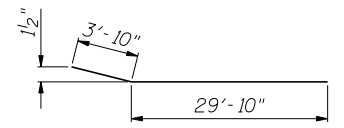

BAR h404(E)

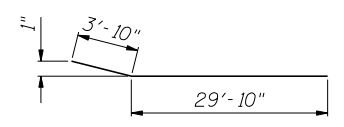

BAR h405(E)

BILL OF MATERIAL

Bar	No.	Size	Length	Shape
d400(E)	132	#4	2'-0"	□
h400(E)	170	#5	33'-8"	—
h401(E)	14	#5	46'-8"	—
h402(E)	152	#5	29'-8"	—
h403(E)	2	#5	27'-2"	—
h404(E)	36	#5	33'-8"	—
h405(E)	32	#5	33'-8"	—
h406(E)	24	#5	32'-2"	—
h407(E)	12	#5	28'-2"	—
v400(E)	22	#5	17'-5"	—
v401(E)	18	#5	14'-7"	—
v402(E)	62	#5	14'-3"	—
v403(E)	62	#5	13'-10"	—
v404(E)	31	#5	26'-11"	—
v405(E)	31	#5	25'-8"	—
v406(E)	31	#5	24'-3"	—
v407(E)	31	#5	22'-7"	—
v408(E)	31	#5	20'-10"	—
v409(E)	31	#5	19'-5"	—
v410(E)	31	#5	18'-0"	—
v411(E)	31	#5	16'-3"	—
v412(E)	31	#5	14'-4"	—
v413(E)	31	#5	12'-4"	—
v414(E)	31	#5	10'-4"	—
v415(E)	30	#5	8'-1"	—
v416(E)	30	#5	5'-9"	—
v417(E)	60	#5	2'-2"	—
Item		Unit	Quantity	
Concrete Structures		Cu. Yd.	198.5	
Reinforcement Bars, Epoxy Coated		Pound	25,010	
Pipe Underdrains for Structures, 4"		Foot	526	
Geocomposite Wall Drain		Sq. Yd.	312	

FILE NAME = ...60R30-W061-011-ConcreteFacing.dgn



DESIGNED - LAS	REVISED -
CHECKED - DAZ	REVISED -
DRAWN - SAW	REVISED -
CHECKED - LAS	REVISED -

SCALE - NONE	DATE - 12/14/2012
--------------	-------------------

STATE OF ILLINOIS
DEPARTMENT OF TRANSPORTATION

CONCRETE FACING & DETAILS
STA. 3959+30.00 TO STA. 3964+32.50 S.N. 022-W061

SHEET NO. SB-11 OF SB-17 SHEETS

F.A.P. RTE.	SECTION	COUNTY	TOTAL SHEETS	SHEET NO.
338	(112 & 113) WRS-7	DUPAGE	1156	870
			CONTRACT NO. 60R30	
ILLINOIS FED. AID PROJECT				