

FINAL SURVEY	SURVEYED	BY	DATE
NOTE BOOK	PLOTTED		
NO.	TEMPLATE		
	AREAS CHECKED		

ORIGINAL SURVEY	SURVEYED	BY	DATE
NOTE BOOK	PLOTTED		
NO.	TEMPLATE		
	AREAS CHECKED		

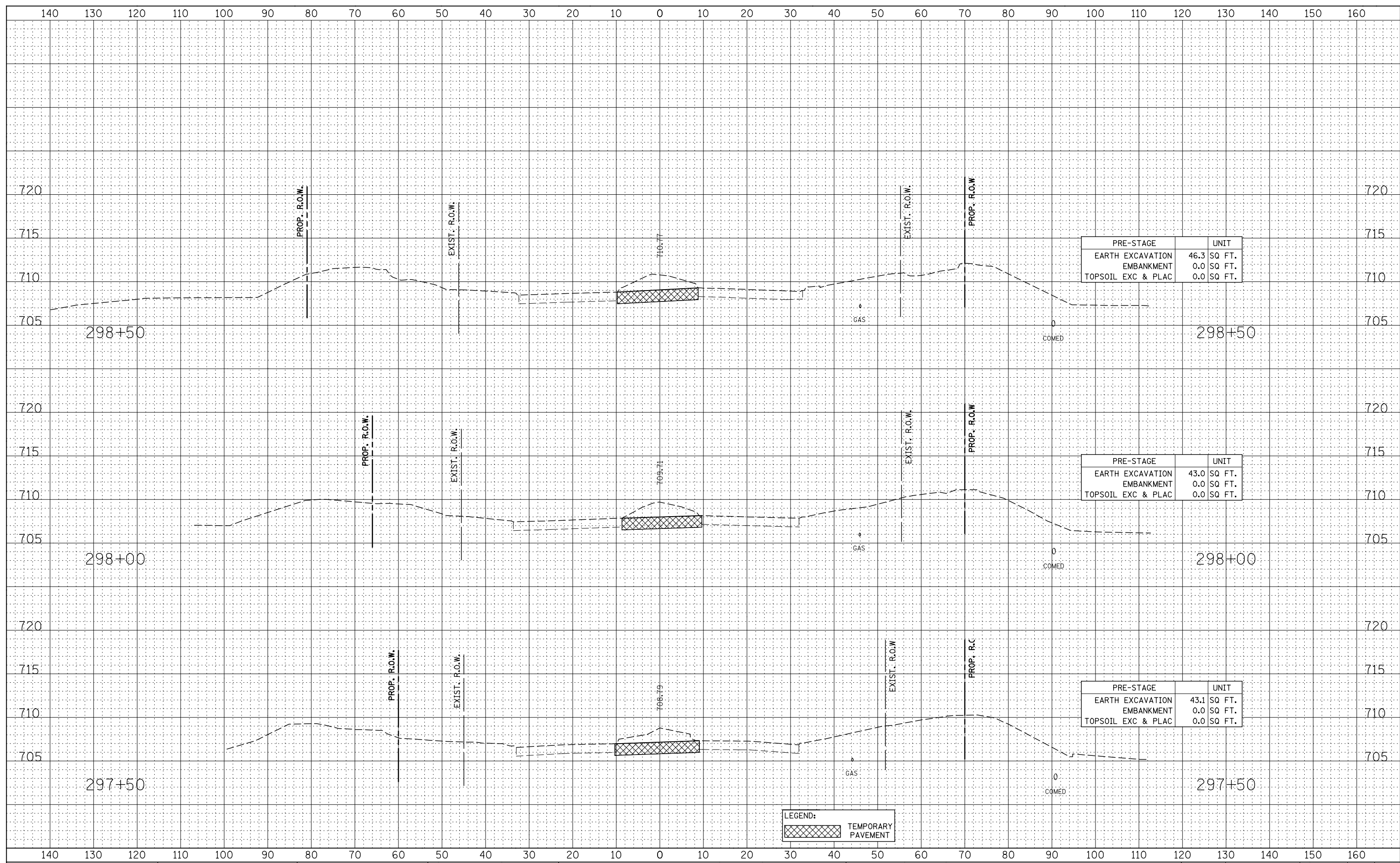

LEGEND:  
 TEMPORARY PAVEMENT

STATE OF ILLINOIS  
 DEPARTMENT OF TRANSPORTATION

MERIDIAN PKWY. / GLACIER PARK AVE.  
 PRE-STAGE CROSS-SECTIONS

DESIGNED	- RTA	REVISED	-
DRAWN	- KES	REVISED	-
CHECKED	- PJO	REVISED	-
DATE	- 12/14/2012	REVISED	-

SCALE: SHEET NO. 6 OF 9 SHEETS STA. 297+50 TO STA. 298+50

F.A.P. RTE.	SECTION	COUNTY	TOTAL SHEETS	SHEET NO.
338	(112 & 113) WRS-7	DUPAGE	1156	1105
CONTRACT NO. 60R30				
FED. ROAD DIST. NO. ILLINOIS FED. AID PROJECT				