

PERMANENT PAVEMENT MARKING
WEST OF STA. 583+61
(SEE PAVEMENT MARKING PLANS)

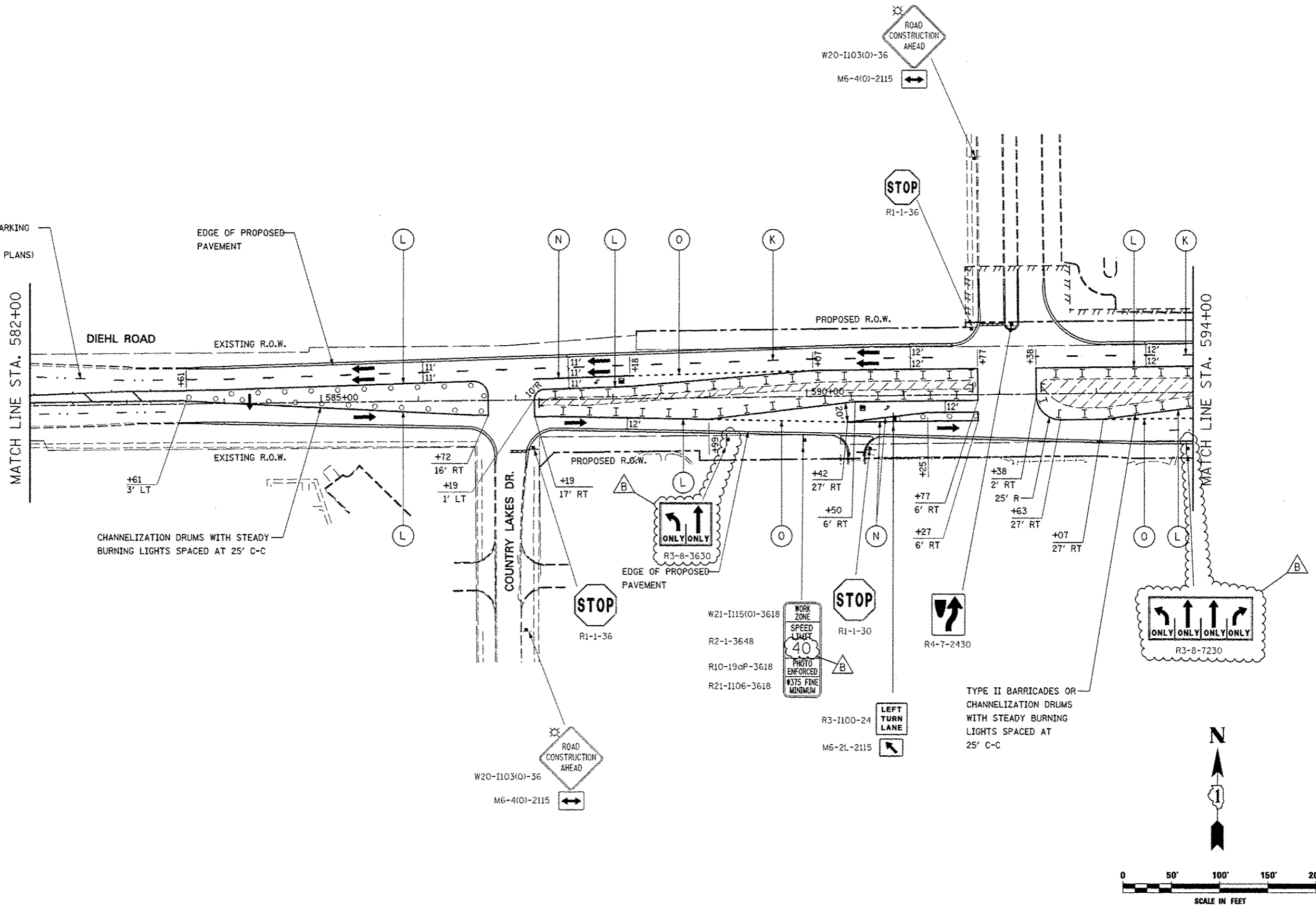

DESIGNED <i>PJO</i>	REVISED - ADDENDUM B 05/01/2013
DRAWN <i>KES</i>	REVISED -
CHECKED <i>JCM</i>	REVISED -
DATE <i>12/14/2012</i>	REVISED -

STATE OF ILLINOIS
DEPARTMENT OF TRANSPORTATION

MAINTENANCE OF TRAFFIC - STAGE 4
DIEHL ROAD

SCALE: AS SHOWN SHEET NO. 109 OF 117 SHEETS STA. 582+00 TO STA. 594+00

F.A.P. RTE.	SECTION	COUNTY	TOTAL SHEETS	SHEET NO.
338	(112 & 113) WRS-6	DUPAGE	734	178
CONTRACT NO. 60R31				
ILLINOIS FED. AID PROJECT				