

TEMPORARY TRAFFIC SIGNAL STAGE 3

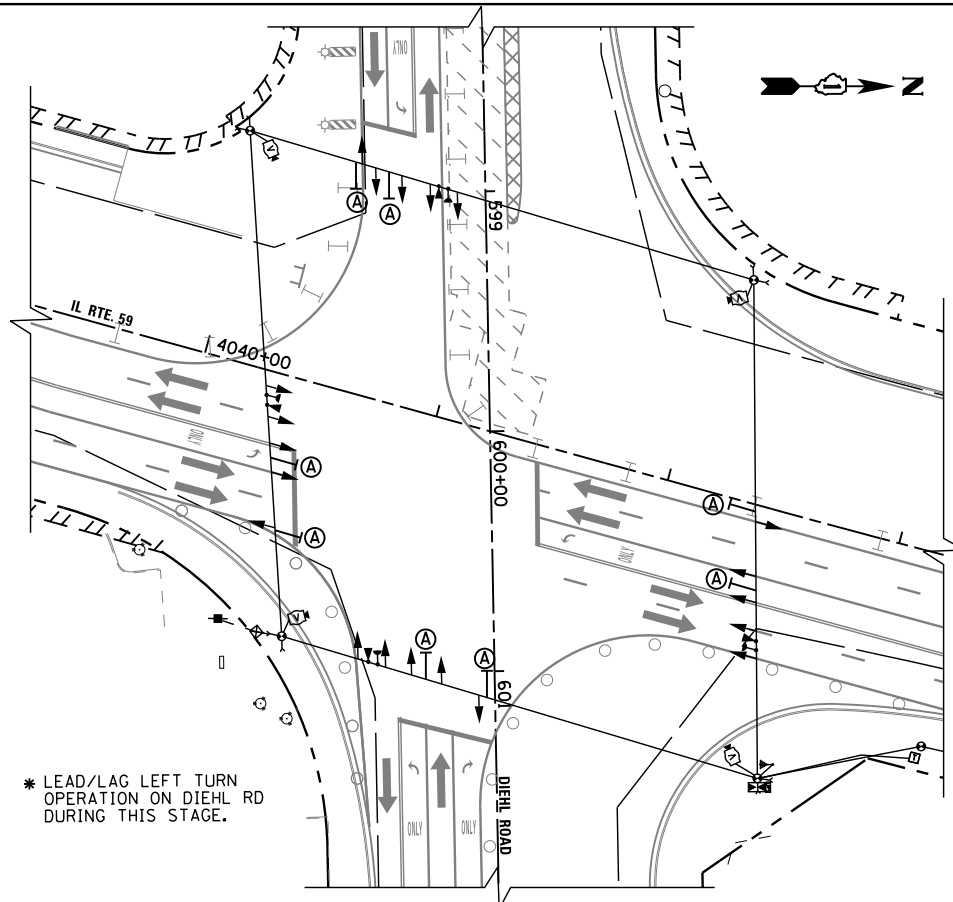

TEMPORARY TRAFFIC SIGNAL STAGE 3A

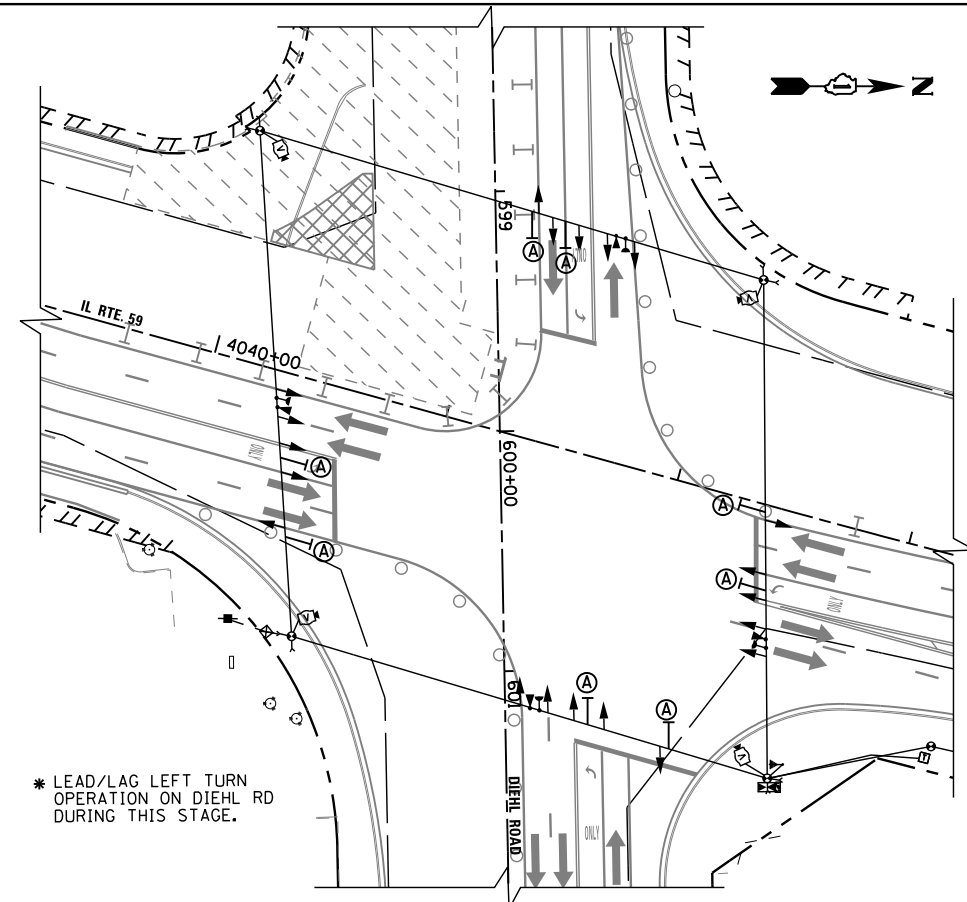

TEMPORARY TRAFFIC SIGNAL STAGE 3B-3C

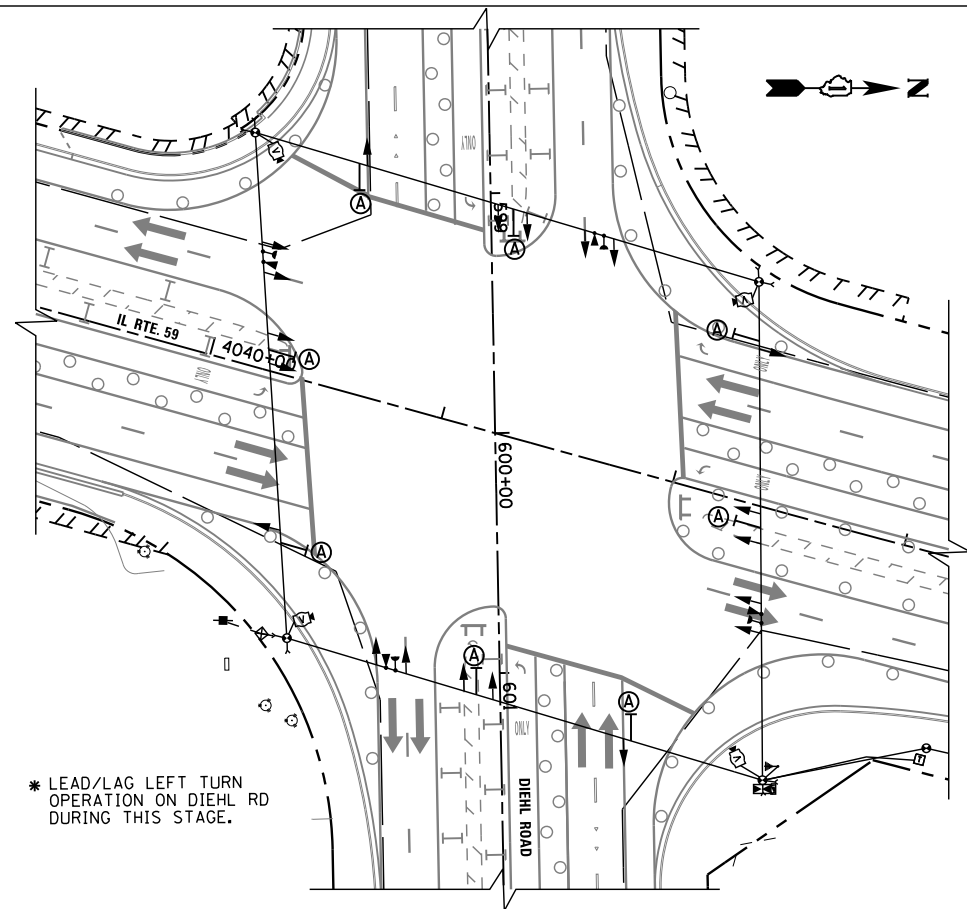

TEMPORARY TRAFFIC SIGNAL STAGE 4

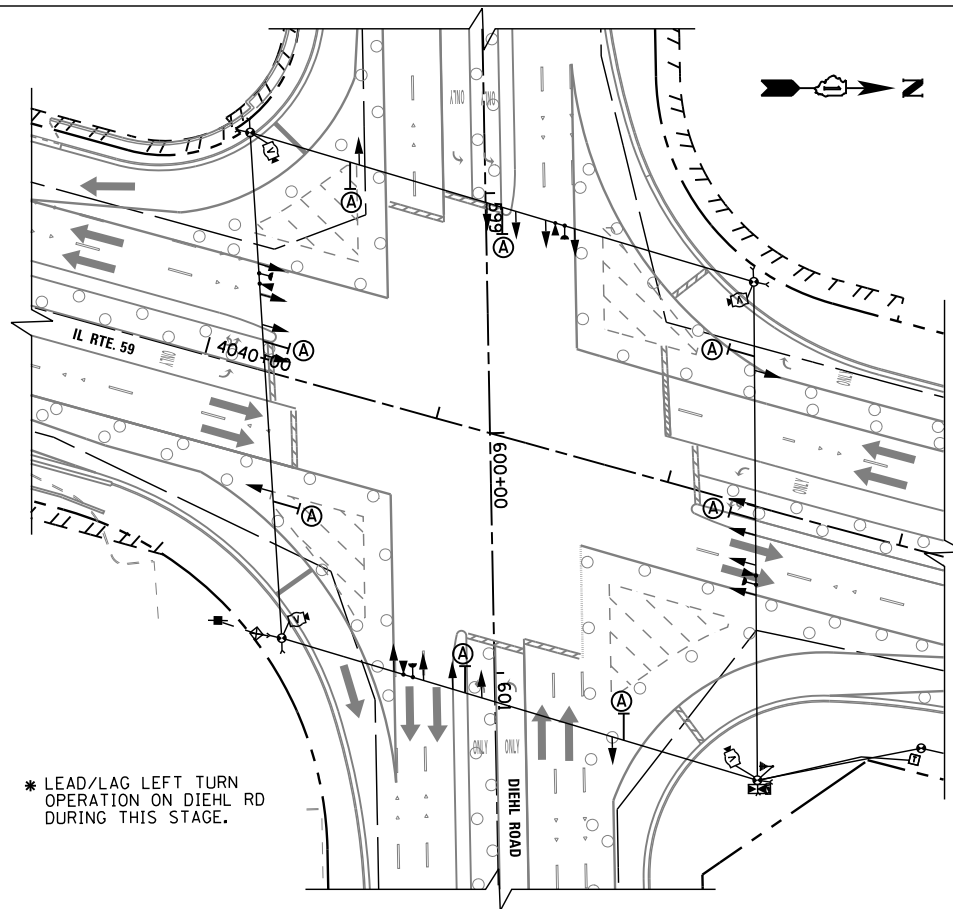

TEMPORARY TRAFFIC SIGNAL STAGE 4A

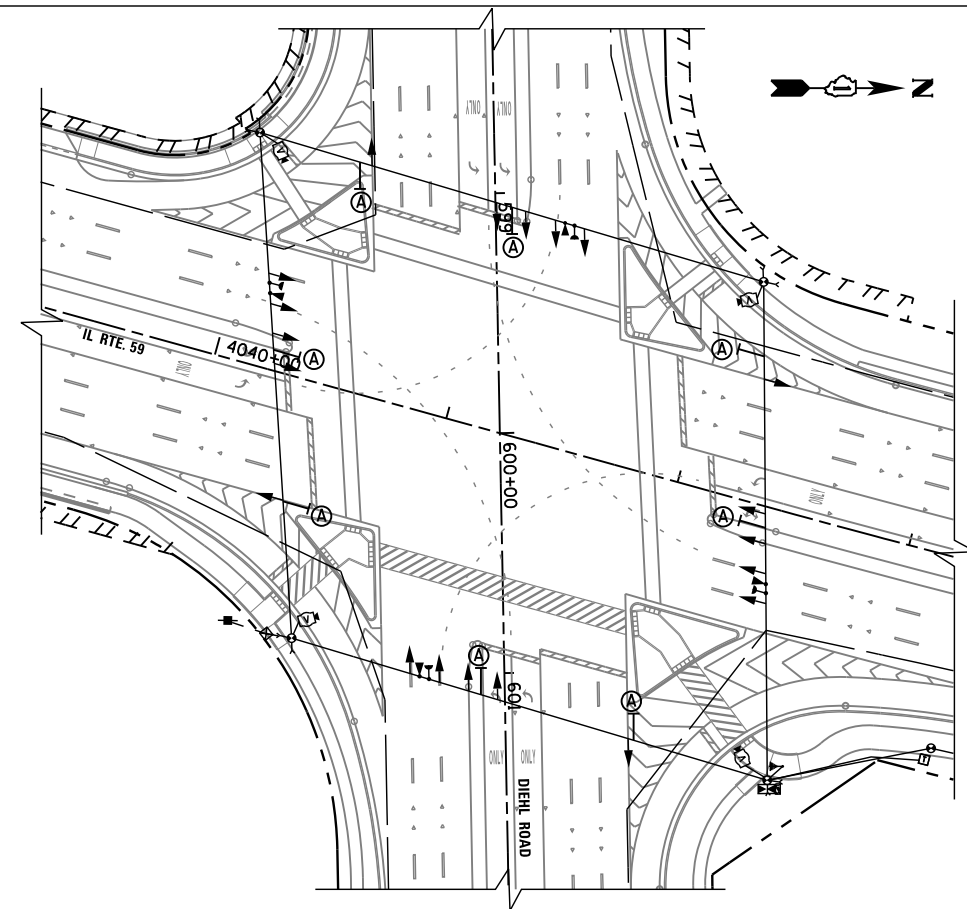

TEMPORARY TRAFFIC SIGNAL FINAL CONDITION

FILE NAME = K:\Projects\090059\Design\Sheet Files\679rwa59tempDL4.dgn	USER NAME = *USER*	DESIGNED - DW	REVISED -
		DRAWN - JDH	REVISED -
	PLOT SCALE = *SCALE*	CHECKED - KMM	REVISED -
	PLOT DATE = 12/6/2012	DATE -	REVISED -

**STATE OF ILLINOIS
 DEPARTMENT OF TRANSPORTATION**

**TEMPORARY TRAFFIC SIGNAL INSTALLATION
 M.O.T. STAGING PLAN (2 OF 2)
 IL RTE 59 AT DIEHL ROAD**

SCALE: N.T.S. SHEET NO. 4 OF 4 SHEETS STA. TO STA.

F.A. RTE.	SECTION	COUNTY	TOTAL SHEETS	SHEET NO.
338	(112 & 113) WRS-6	DUPAGE	734	401
TS-21			CONTRACT NO. 60R31	
ILLINOIS FED. AID PROJECT				