

LEGEND

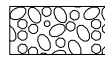

PERMANENT IMPACTS TO THE WATERS OF THE U.S. = 0.009 ACRES
STONE RIPRAP, CLASS A4 (1' THICK) - 11 TONS

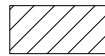

TEMPORARY IMPACTS TO THE WATERS OF THE U.S. = 0.034 ACRES

CP 1 - SET "X" IN THE CONCRETE WALK ON THE SOUTH SIDE OF IL 83 WEST OF THE BRIDGE
ELEV. = 596.10

CP 2 - SET "X" IN THE CONCRETE WALK ON THE SOUTH SIDE OF IL 83 EAST OF THE BRIDGE
ELEV. = 596.19

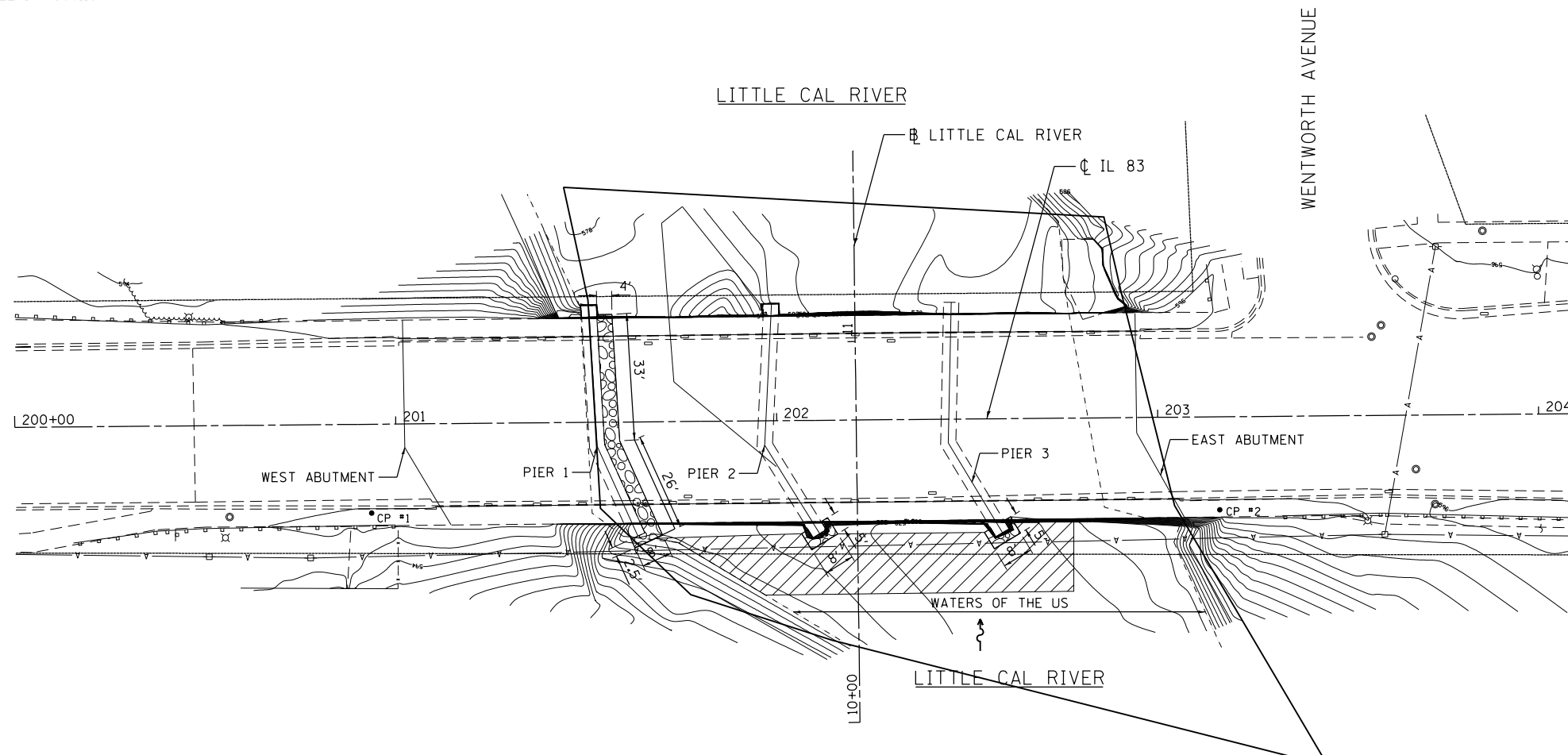

3/12/2013 11:24:32 AM



USER NAME = 1485	DESIGNED -	REVISED -
PLOT SCALE = 40.0000' / in.	DRAWN -	REVISED -
PLOT DATE = 3/12/2013	CHECKED -	REVISED -
	DATE - 03/20/2013	REVISED -

**STATE OF ILLINOIS
DEPARTMENT OF TRANSPORTATION**

**COOK & WILL COUNTY RIP RAP IMPROVEMENTS
SN 016-0954 IL 83 AT LITTLE CAL RIVER - EROSION PLAN**

SCALE: 1"=20' SHEET 2 OF 2 SHEETS STA. TO STA.

F.A. RTE.	SECTION	COUNTY	TOTAL SHEETS	SHEET NO.
*	2012-007 I	COOK/WILL	38	12
• VARIOIUS ROUTES			CONTRACT NO. 60T53	
ILLINOIS FED. AID PROJECT				