

B.M. No 23, El. 581.723  
RR Spike in NW Face of Tree  
722' Rt. @ Sta. 538+00

ROUTE NO.	SECTION	COUNTY	TOTAL SHEETS	SHEET NO.
F.A.I.-64	82-5HB-3	ST. CLAIR	126	32
FED. ROAD DIV. NO. 4		ILLINOIS	PROJECT I-64-1(30)8	

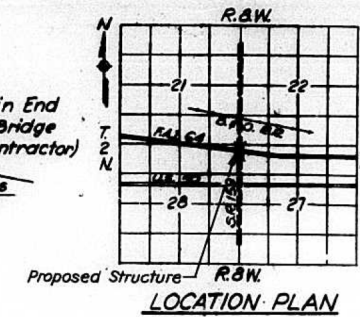
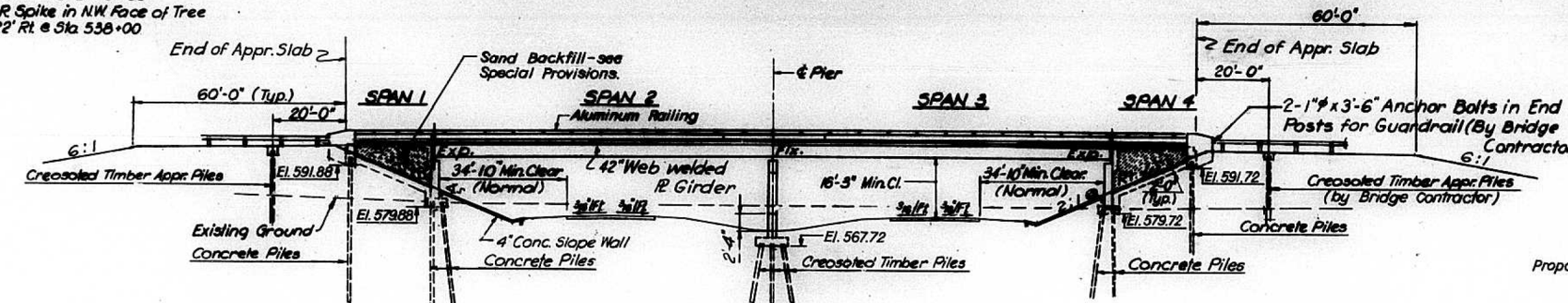

ELEVATION  
Scale: 1"=20'

APPROACH PILE DATA  
Type: Creosoted Piles  
Req'd length: 22 ft.  
No Required: 26

STATION 537+26.79  
BUILT 197 BY  
STATE OF ILLINOIS  
F.A.I. RT. 64 SEC. 82-5HB-3  
F.A.I. PROJ. I-64-1(30)  
LOADING HS20

NAME PLATE  
See Sld. 2113

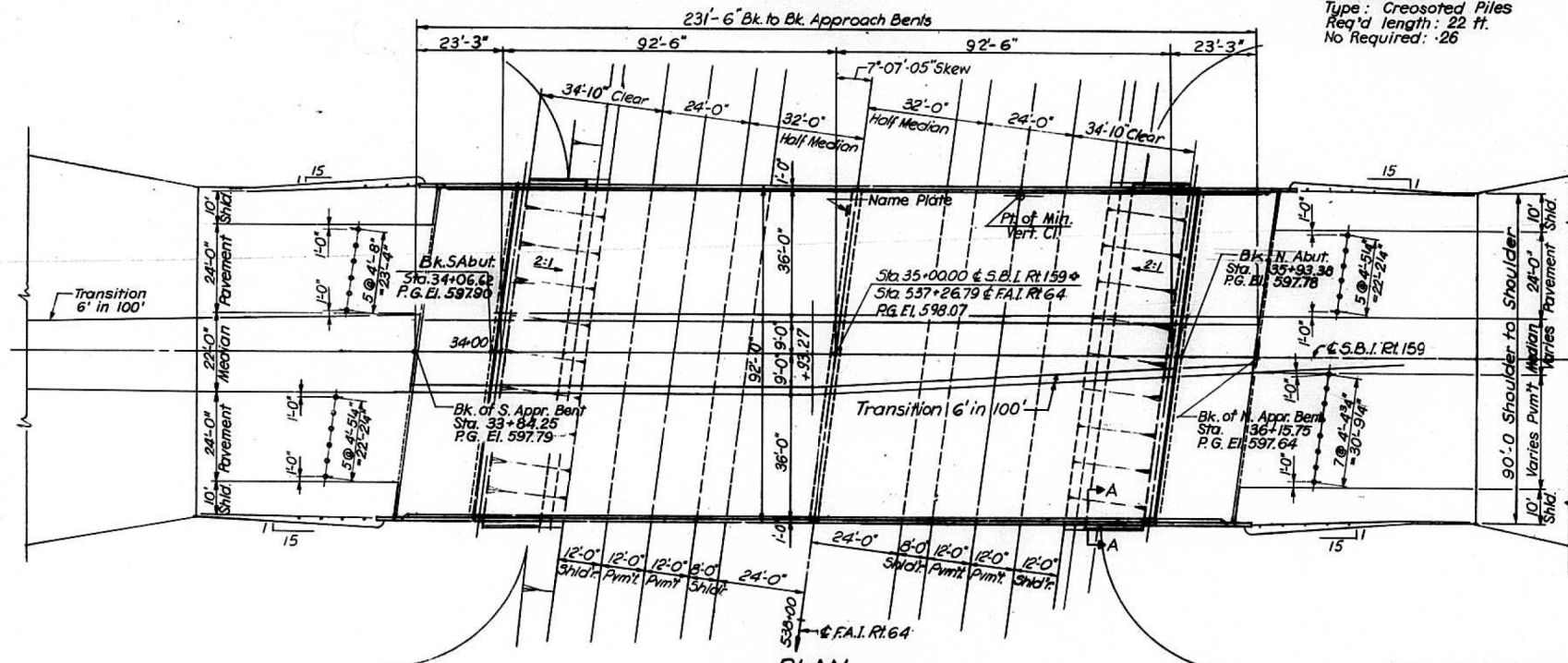

PLAN  
Scale: 1"=20'

NOTE: All sheet No. references are made to lower right hand corner sheet numbers.

**TOTAL BILL OF MATERIAL**

Item	Unit	Super	Sub	Total
Structure Excavation	Cu Yds	—	231.0	231.0
Class X Concrete	Cu Yds	609.5	491.9	1,101.4
Protective Coat	Sq Yds	2,486	—	2,486
Furnishing and Erecting Structural Steel	Lump Sum	0.5	—	0.5
Reinforcement Bars	Lbs	174,200	47,220	221,420
Furnishing Creosoted Piles (over 38')	Lin. Ft.	—	2,760	2,760
Driving Timber Piles	Lin. Ft.	—	3,332	3,332
Test Pile Timber	Ea.	—	1	1
Furnishing Concrete Piles	Lin. Ft.	—	5,100	5,100
Driving Concrete Piles	Lin. Ft.	—	5,100	5,100
Test Pile Concrete	Ea.	—	1	1
Name Plates	Ea.	—	1	1
Slope Wall 4'	Sq Yds	—	661	661
Aluminum Railing	Lin. Ft.	453	—	453
Preformed Joint Sealer	Lin. Ft.	184	—	184
Stud Shear Connectors	Each	5,720	—	5,720
Sand Backfill	Cu Yds.	—	845	845
Furnishing Creosoted Piles (20.1 to 38')	Lin. Ft.	—	572	572

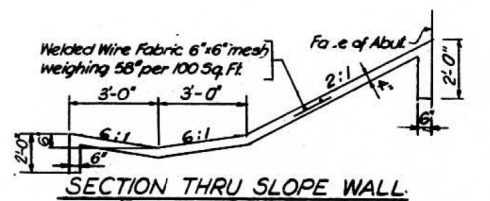

SECTION THRU SLOPE WALL

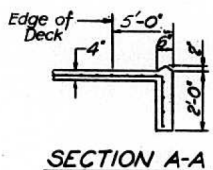

SECTION A-A

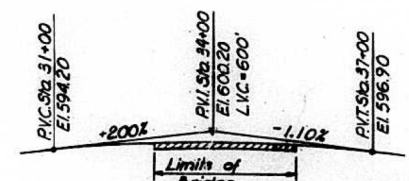

PROFILE GRADE OF S.B.I. RT. 159



PROFILE GRADE OF F.A.I. RT. 64

**DESIGN STRESSES AND LOADS**

Allowable F.W.S. = 25 psf.  
 $f_c = 1200$  psi Deck Slab Spans 2 & 3  
 $f_c = 1400$  psi Deck Slab Spans 1 & 4  
 4' Curb, parapet and Substructure  
 $f_s = 20,000$  psi Structural Steel (A-36)  
 $f_s = 20,000$  psi Reinforcement  
 $v = 75$  psi Footings  
 LIVE LOAD DEFLECTION:  $\frac{1}{200}$  (Composite)

LOADING: HS20-44

STATE OF ILLINOIS

GENERAL PLAN

S.B.I. ROUTE 159 OVER F.A.I. ROUTE 64

STATION 537 + 26.79

F.A.I. RT. 64 ST. CLAIR COUNTY SECTION 82-5HB-3

H. W. LOCHNER, INC.  
ENGINEERS  
CHICAGO, ILLINOIS

SHEET NO. 12 OF 14

DESIGNED BY: H.N.  
DRAWN BY: E.F. & B.B.  
CHECKED BY: V.B.

Rev. Slope Wall 4" from 608 Sq. Yds. to 661 Sq. Yds. 11-5-71 J.M.J.

NOT TO SCALE

FOR INFORMATION ONLY  
1970 ORIGINAL CONSTRUCTION

STATE OF ILLINOIS  
DEPARTMENT OF TRANSPORTATION

EXISTING STRUCTURE DETAILS

FILE NAME =	USER NAME = harbaughrd	DESIGNED -	REVISED -	F.A.I. RTE.	SECTION	COUNTY	TOTAL SHEETS	SHEET NO.
et:\pwork\pwork\harbaughrd\0336836\876g33-shr-plan.dgn		DRAWN -	REVISED -	64	82-5HB-3-P	ST. CLAIR	12	5
PLOT SCALE = 100.0000' / in.		CHECKED -	REVISED -	CONTRACT NO. 76G33				
PLOT DATE = 3/29/2013		DATE -	REVISED -	FED. ROAD DIST. NO.	ILLINOIS	FED. AID PROJECT		
				SCALE: N/A	SHEET NO. 1 OF 7 SHEETS	STA.	TO STA.	