

|                  |                    |           |
|------------------|--------------------|-----------|
| FED. AID PROJECT | SECTION            | COUNTY    |
|                  | 1E-0000(466)       | ST. CLAIR |
|                  | CONTRACT NO. 97500 | ILLINOIS  |

**THOUVENOT, WADE & MOERCHEN, INC.**  
ENGINEERS • SURVEYORS • PLANNERS



- CORPORATE OFFICE**  
4940 OLD COLLINSVILLE RD.  
SWANSEA, ILLINOIS 62226  
TEL (618) 624-4488  
FAX (618) 624-6688  
corp@twm-inc.com
- WATERLOO OFFICE**  
118 EAST THIRD STREET  
WATERLOO, ILLINOIS 62298  
TEL (618) 939-5050  
FAX (618) 939-3938  
waterloo@twm-inc.com
- ST. LOUIS OFFICE**  
1001 CRAIG ROAD, SUITE 260  
ST. LOUIS, MISSOURI 63146  
TEL (314) 236-5052  
FAX (314) 872-2194  
stlouis@twm-inc.com

|                                     |             |
|-------------------------------------|-------------|
| PROFESSIONAL REGISTRATIONS          | LICENSE NO. |
| ILLINOIS PROFESSIONAL DESIGN FIRM   | 184-001220  |
| PROFESSIONAL ENGINEERING CORP.      | 62-033370   |
| PROFESSIONAL STRUCTURAL ENGR. CORP. | 81-005202   |
| ILLINOIS PROF. LAND SURVEYING CORP. | 048-000029  |
| MISSOURI PROFESSIONAL ENGR. CORP.   | HC 001528   |
| MISSOURI LAND SURVEYING CORP.       | HC 000346   |

SEAL

Signature: \_\_\_\_\_  
Signature Date: \_\_\_\_\_  
Expiration Date: \_\_\_\_\_

**STATEMENT OF RESPONSIBILITY**  
I hereby confirm that the document herein to be authorized by my seal is restricted to this sheet, and I hereby disclaim any responsibility for all other drawings, specifications, estimates, reports or other documents or instruments relating to or intended to be utilized for any other part of the architectural, engineering or survey project.

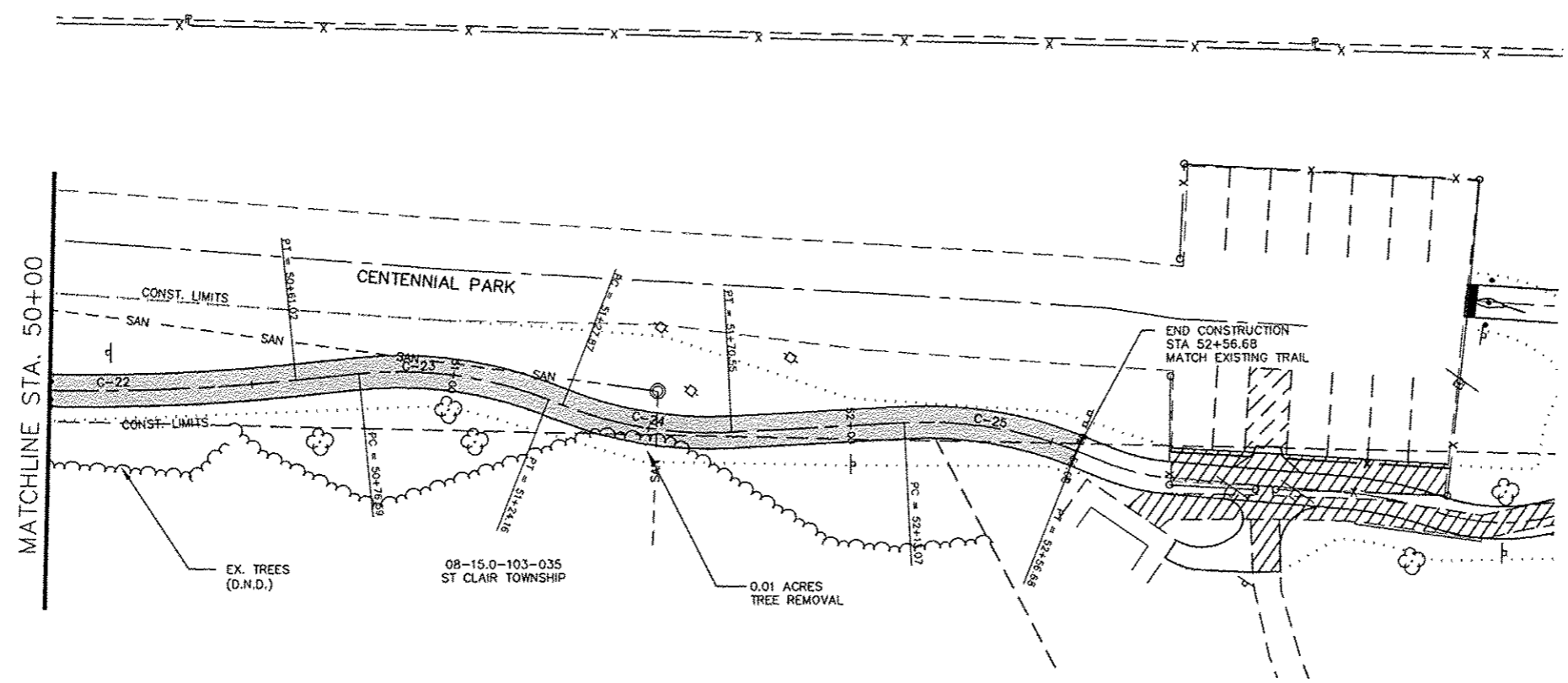

|   |   |   |   |
|---|---|---|---|
| <p><b>CURVE C-22</b><br/>PI STA. = 50+15.20<br/>Δ = 10° 31' 51" (LT)<br/>D = 11° 27' 33"<br/>R = 500.00'<br/>T = 46.08'<br/>L = 91.90'<br/>E = 2.12'<br/>S.E. RUN = _____<br/>P.C. STA. = 49+69.12<br/>P.T. STA. = 50+61.02</p> | <p><b>CURVE C-23</b><br/>PI STA. = 51+00.83<br/>Δ = 27° 15' 26" (RT)<br/>D = 57° 17' 45"<br/>R = 100.00'<br/>T = 24.25'<br/>L = 47.57'<br/>E = 2.90'<br/>S.E. RUN = _____<br/>P.C. STA. = 50+76.59<br/>P.T. STA. = 51+24.16</p> | <p><b>CURVE C-24</b><br/>PI STA. = 51+49.54<br/>Δ = 24° 27' 11" (LT)<br/>D = 57° 17' 45"<br/>R = 100.00'<br/>T = 21.67'<br/>L = 42.68'<br/>E = 2.32'<br/>S.E. RUN = _____<br/>P.C. STA. = 51+27.87<br/>P.T. STA. = 51+70.55</p> | <p><b>CURVE C-25</b><br/>PI STA. = 52+35.23<br/>Δ = 24° 59' 14" (RT)<br/>D = 57° 17' 45"<br/>R = 100.00'<br/>T = 22.16'<br/>L = 43.61'<br/>E = 2.43'<br/>S.E. RUN = _____<br/>P.C. STA. = 52+13.07<br/>P.T. STA. = 52+56.68</p> |
|---|---|---|---|

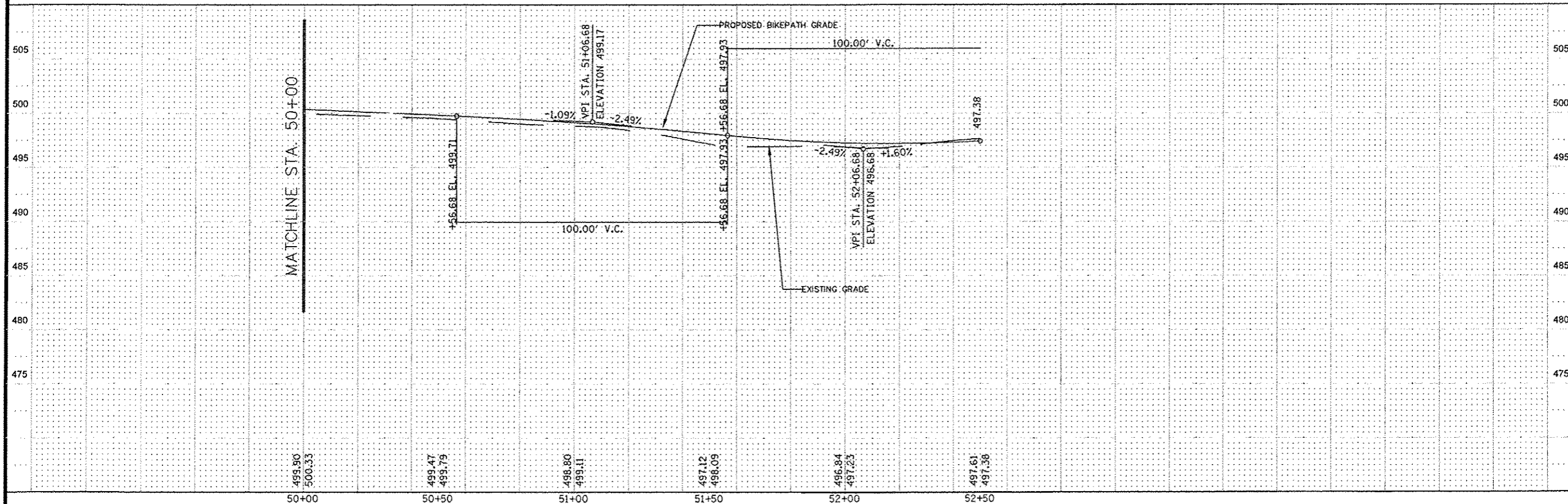

**TITLE:**  
PLAN AND PROFILE  
STA. 50+00 - STA. 52+56.68  
SECTION 10-00032-00-BT

**PROJECT:**  
RICHLAND CREEK BIKE TRAIL  
PHASE 2B  
VILLAGE OF SWANSEA  
ST. CLAIR COUNTY, IL

| REV | DATE | DESCRIPTION |
|-----|------|-------------|
| △   |      |             |
| △   |      |             |
| △   |      |             |

|   |  |
|---|--|
| DRAWN BY: JUV   | SHEET  |
| DESIGNED BY: JUV                                      | 11   |
| CHECKED BY: MJK                                       |  |
| APPROVED BY: JUV                                      |  |
| PROJECT NUMBER: 19100072A                             | OF 46 SHEETS   |
| <input checked="" type="checkbox"/> ISSUED FOR REVIEW | <input checked="" type="checkbox"/> ISSUED FOR BIDDING |
| <input type="checkbox"/> ISSUED FOR CONSTR.           | <input type="checkbox"/> RECORD DRAWING                |