

DETAIL A

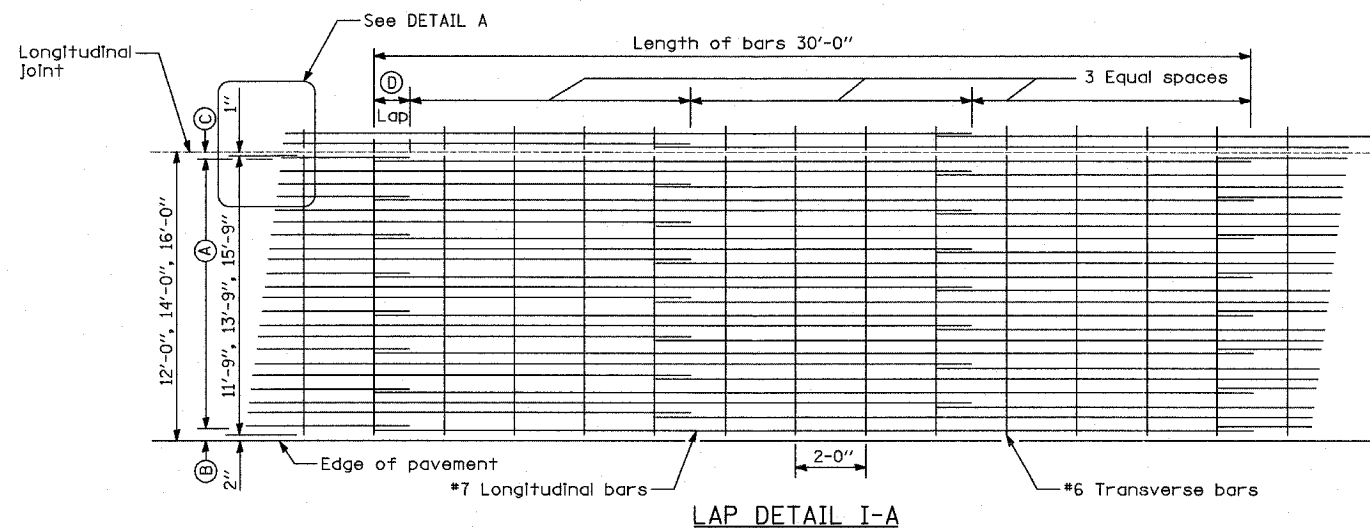

ADDITIONAL REINFORCEMENT IN GORE AREAS - SEE PAVEMENT JOINTING AND ELEVATION PLANS FOR LOCATIONS

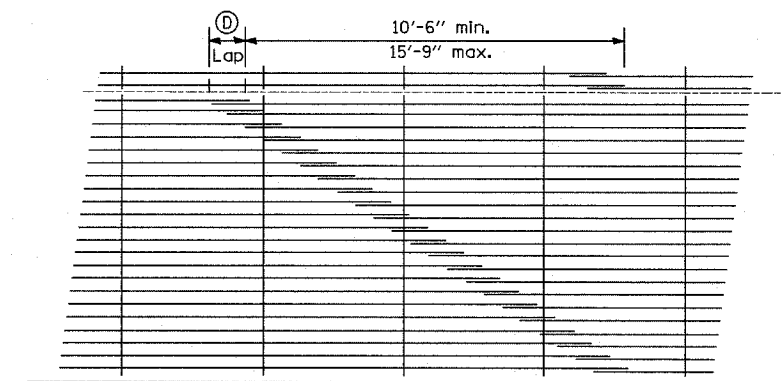
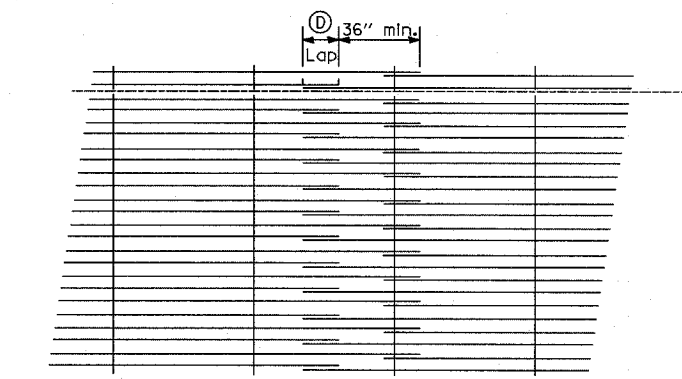

GENERAL NOTES

1. THE PAVEMENT REINFORCEMENT SHALL BE 4.5" FROM THE TOP OF PAVEMENT.
2. EXCEPT AS NOTED OR SHOWN, THE DIMENSIONS AND NOTES SPECIFIED FOR LAP DETAIL I ARE TYPICAL FOR LAP DETAIL II AND III.
3. THE (B) DIMENSION AND THE DISTANCE FROM THE END OF THE TRANSVERSE BAR TO THE EDGE OF PAVEMENT MAY BE INCREASED BY 1" FOR SLIP FORM PAVING.

Pavement Width	Bar Size	Pavement Thickness	(A) (Approx. Spacing)	(B)	(C)	(D)
12 feet	#7	14"	23 spaces (24 bars) @ 6"	3 1/2"	3"	26"
14 feet	#7	14"	27 spaces (28 bars) @ 6"	3 1/2"	3"	26"
16 feet	#7	14"	31 spaces (32 bars) @ 6"	3 1/2"	3"	26"

REVISIONS	
NAME	DATE

ILLINOIS DEPARTMENT OF TRANSPORTATION
F.A.I. 94 (DAN RYAN EXPRESSWAY)

MISCELLANEOUS DETAILS
EXTENDED LANE REINFORCEMENT FOR
CONTINUOUSLY REINFORCED PCC PAVEMENT

SCALE: NONE
DATE: MARCH 1, 2006

DRAWN BY: CTE, MPG
CHECKED BY: TGB