

PROFILE SUBMITTED  
 PLOTTED, CHECKED  
 DATE NOTED  
 STRUCTURE NOTATIONS CHKD  
 NO.

F.A.I. RTE.	SECTION	COUNTY	TOTAL SHEETS	SHEET NO.
94	1818 R-6	COOK	290	231
STA. 1313+00		TO STA. 1367+00		
FED. ROAD DIST. NO.	ILLINOIS	FED. AID PROJECT		60B18

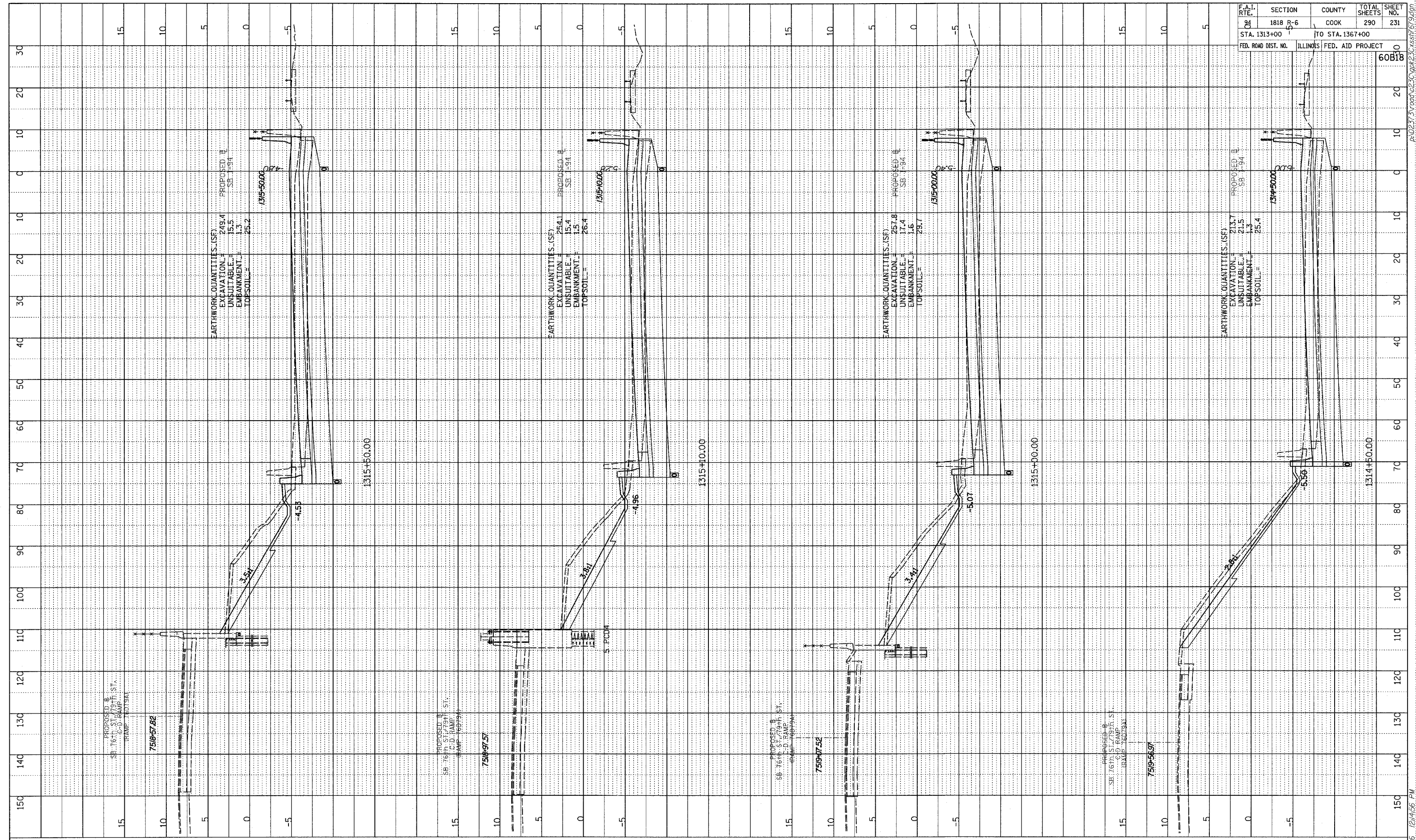

TYLIN INTERNATIONAL

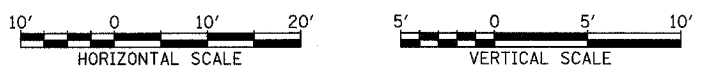

I-94 SOUTHBOUND (DAN RYAN EXPWY)  
 STA. 1314+50 TO STA. 1315+50

02/27/2006 12:45:56 PM P:\0227\3\road\6250\pk2\3\sssb1679.dgn