

PROFILE SURVEYED  
 PLOTTED, CHECKED  
 DATE NOTED  
 NO. STRUCTURE NOTATIONS CIPED

F.A.I. RTE.	SECTION	COUNTY	TOTAL SHEETS	SHEET NO.
94	1818 R-6	COOK	290	235
STA. 1313+00	TO STA. 1367+00			
FED. ROAD DIST. NO.	ILLINOIS	FED. AID PROJECT		
				60818

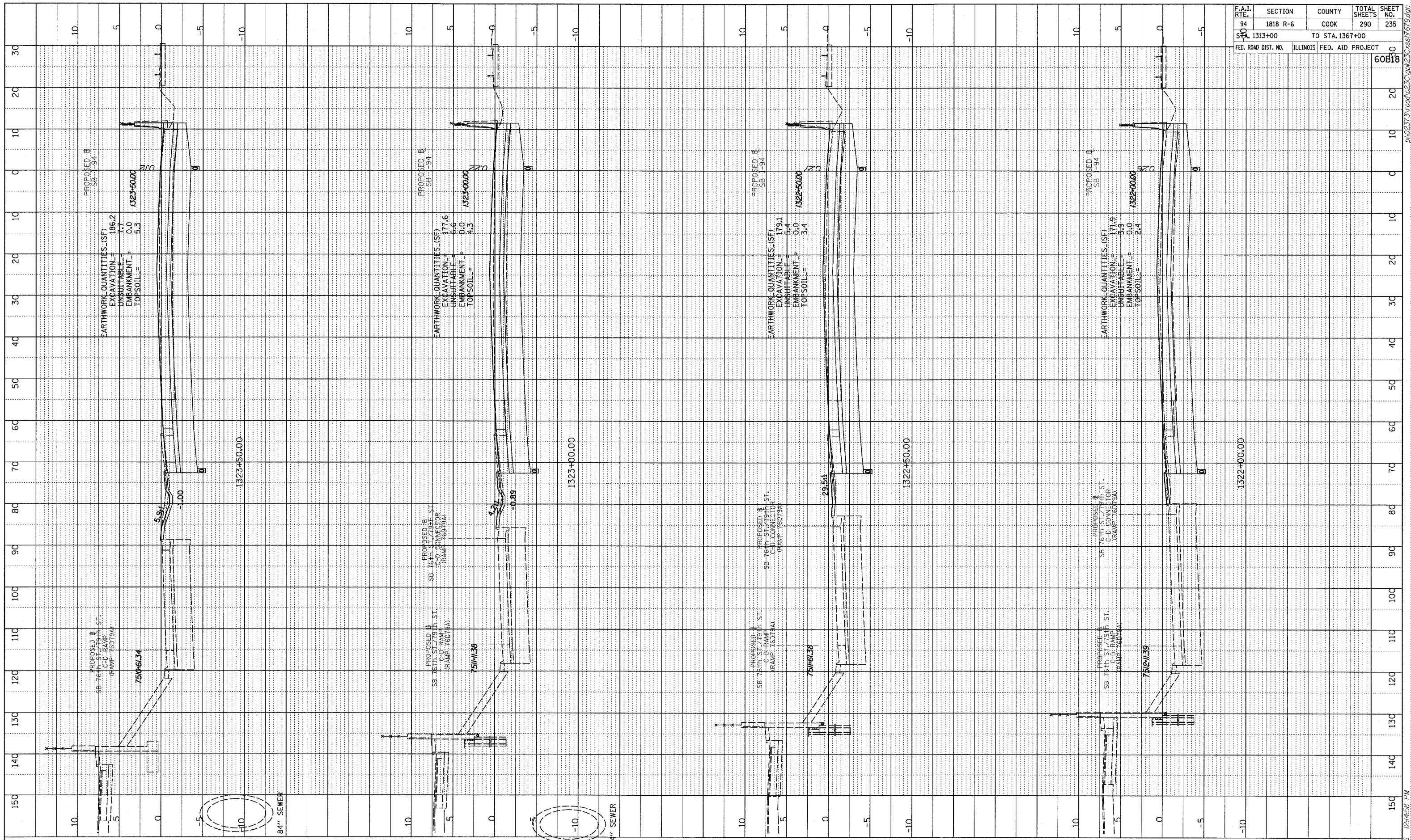

TYLIN INTERNATIONAL

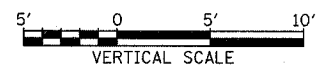
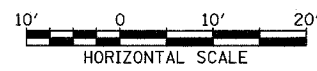

I-94 SOUTHBOUND (DAN RYAN EXPWY)  
 STA. 1322+00 TO STA. 1323+50

02/27/2006 12:45:58 PM P:\02273V\0001\230\gpk230\ssn1679.dgn