

PROFILE SURVEYED  
 B.M. AND I.D. CHECKED  
 GRADES CHECKED  
 STRUCTURE NOTATIONS CHKD  
 NO.

F.A.I. RTE.	SECTION	COUNTY	TOTAL SHEETS	SHEET NO.
94	1818 R-6	COOK	290	238
STA. 1313+00		TO STA. 1367+00		
FED. ROAD DIST. NO.	ILLINOIS FED. AID PROJECT	60B18		

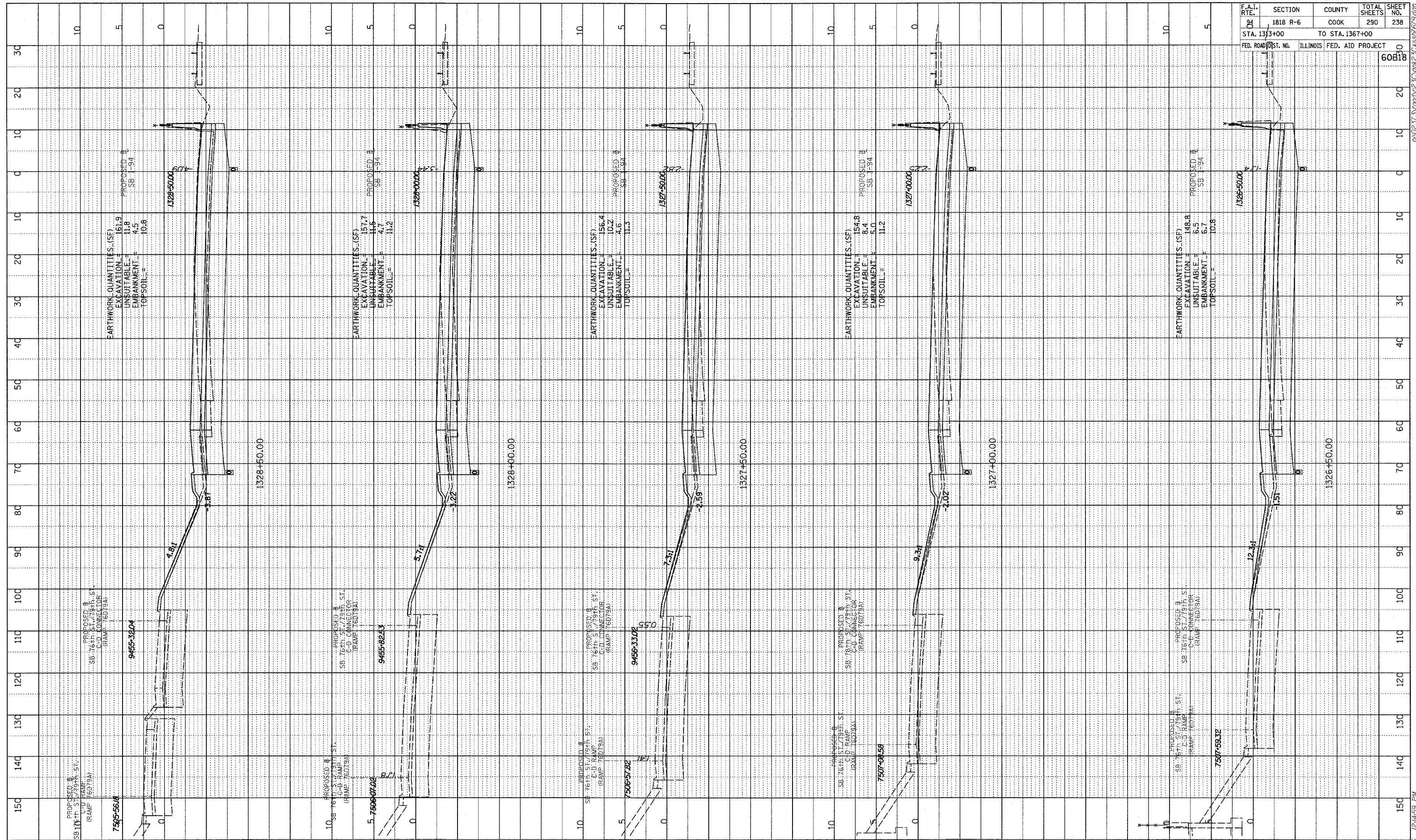

TYLIN INTERNATIONAL

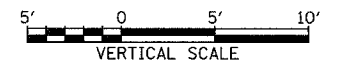
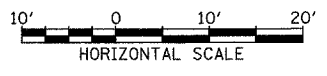

I-94 SOUTHBOUND (DAN RYAN EXPWY)  
 STA. 1326+50 TO STA. 1328+50

02/27/2006 12:44:59 PM