

DATE: _____
 BY: _____
 CHECKED: _____
 IN CHARGE: _____
 NO. _____
 STRUCTURE: _____
 STATUS: _____
 CDWD

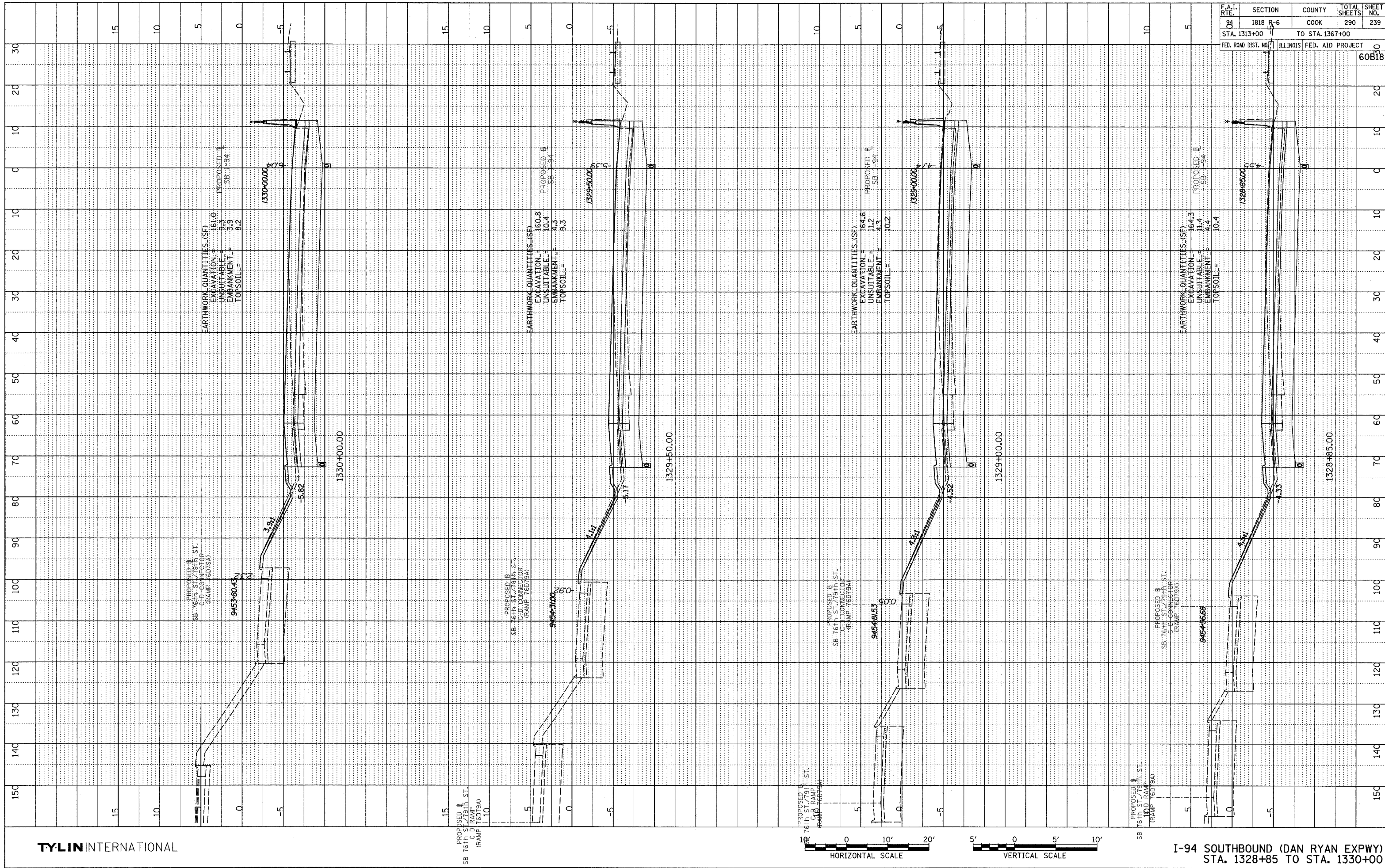

F.A.I. RTE.	SECTION	COUNTY	TOTAL SHEETS	SHEET NO.
94	1818 R-6	COOK	290	239

STA. 1313+00 TO STA. 1367+00
 ILLINOIS FED. AID PROJECT
 60818

TYLIN INTERNATIONAL

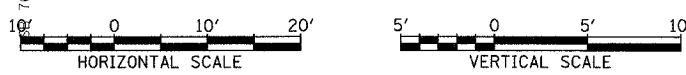

I-94 SOUTHBOUND (DAN RYAN EXPWY)
 STA. 1328+85 TO STA. 1330+00

02/27/2006 12:50:00 PM P:\022731\road\23\gpk23\ssht1619.dgn