

PROFILE  
 DRAWN BY: [ ]  
 CHECKED BY: [ ]  
 DATE: [ ]  
 NO. [ ]

F.A.I. RTE.	SECTION	COUNTY	TOTAL SHEETS	SHEET NO.
94	1818 R-6	COOK	290	240
STA. 1313+00		TO STA. 1367+00		
FED. ROAD DIST. NO.		ILLINOIS	FED. AID PROJECT	60B18

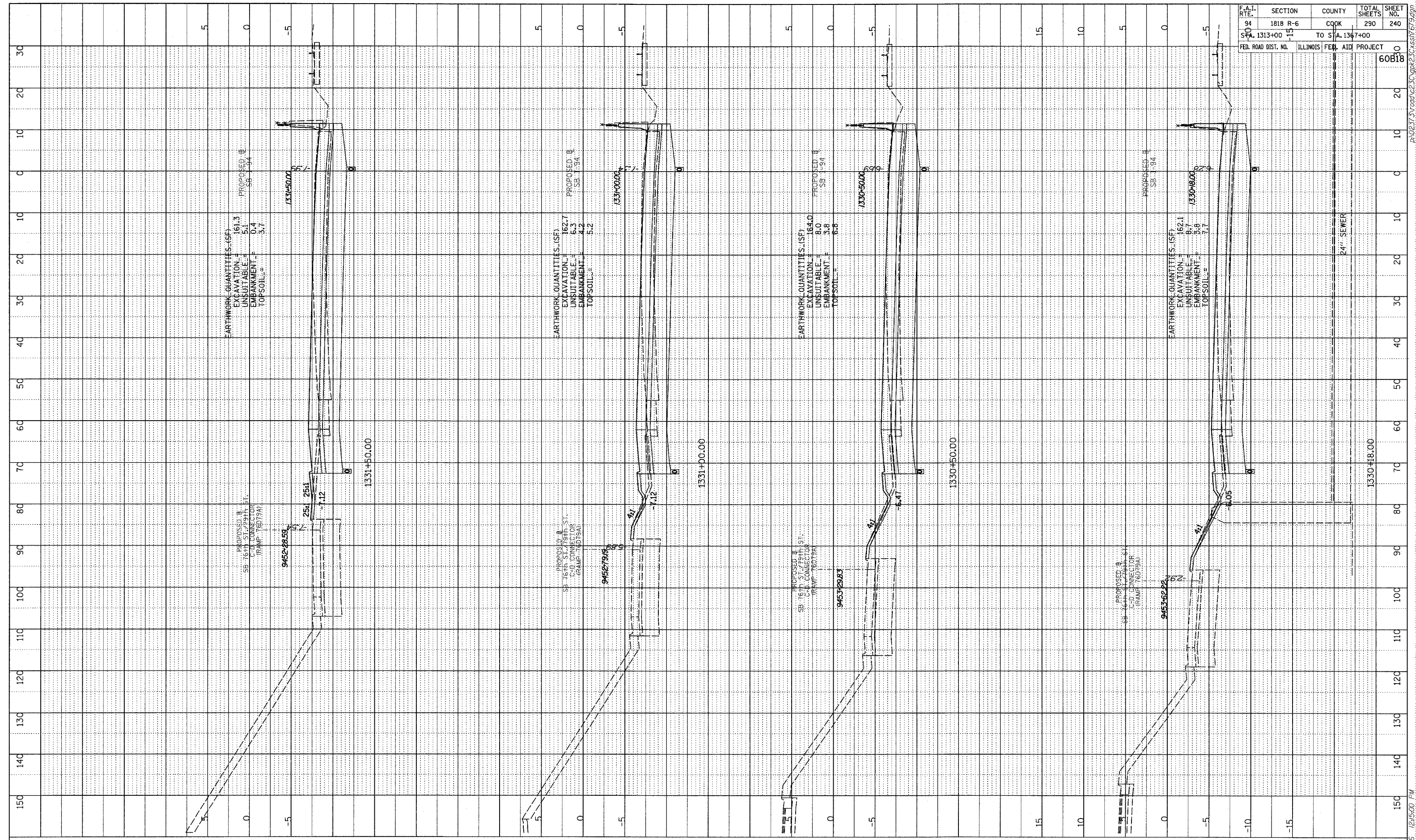

TYLIN INTERNATIONAL

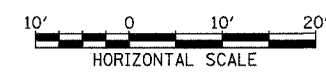

I-94 SOUTHBOUND (DAN RYAN EXPWY)  
 STA. 1330+18 TO STA. 1331+50

02/27/2006 12:50:00 PM P:\0227\3\road\23\gpk23\asht\679.dgn