

DATE: _____
 PROFILE: _____
 REVIEWED: _____
 PLOTTED: _____
 NOTE BOOK: _____
 NO. _____
 STRUCTURE: _____
 STATUS: _____
 CHRD: _____

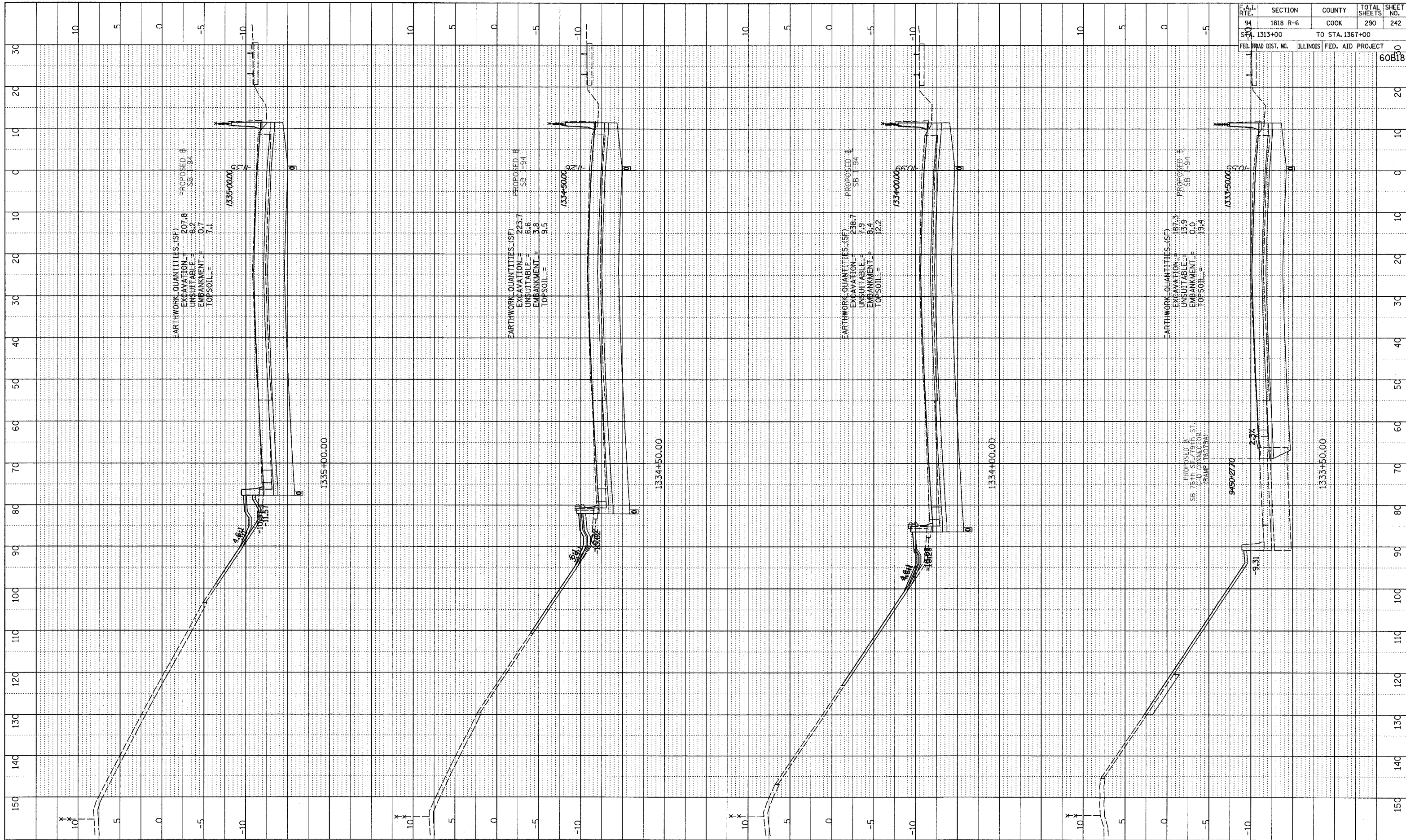

F.A.I. RTE.	SECTION	COUNTY	TOTAL SHEETS	SHEET NO.
94	1818 R-6	COOK	290	242
STA. 1313+00		TO STA. 1367+00		
FED. ROAD DIST. NO.	ILLINOIS	FED. AID PROJECT		60818

TYLIN INTERNATIONAL

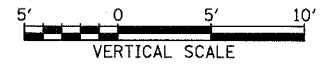

I-94 SOUTHBOUND (DAN RYAN EXPWY)
 STA. 1333+50 TO STA. 1335+00

02/27/2005 12:50:01 PM p:\02272005\230\pk230\pk230\sshl619.dgn