

PROFILE SURVEYED  
 PLOTTED  
 CHECKED  
 NOTE BOOK  
 B.M. NOTED  
 NO. \_\_\_\_\_  
 STRUCTURE NOTATIONS CHRD

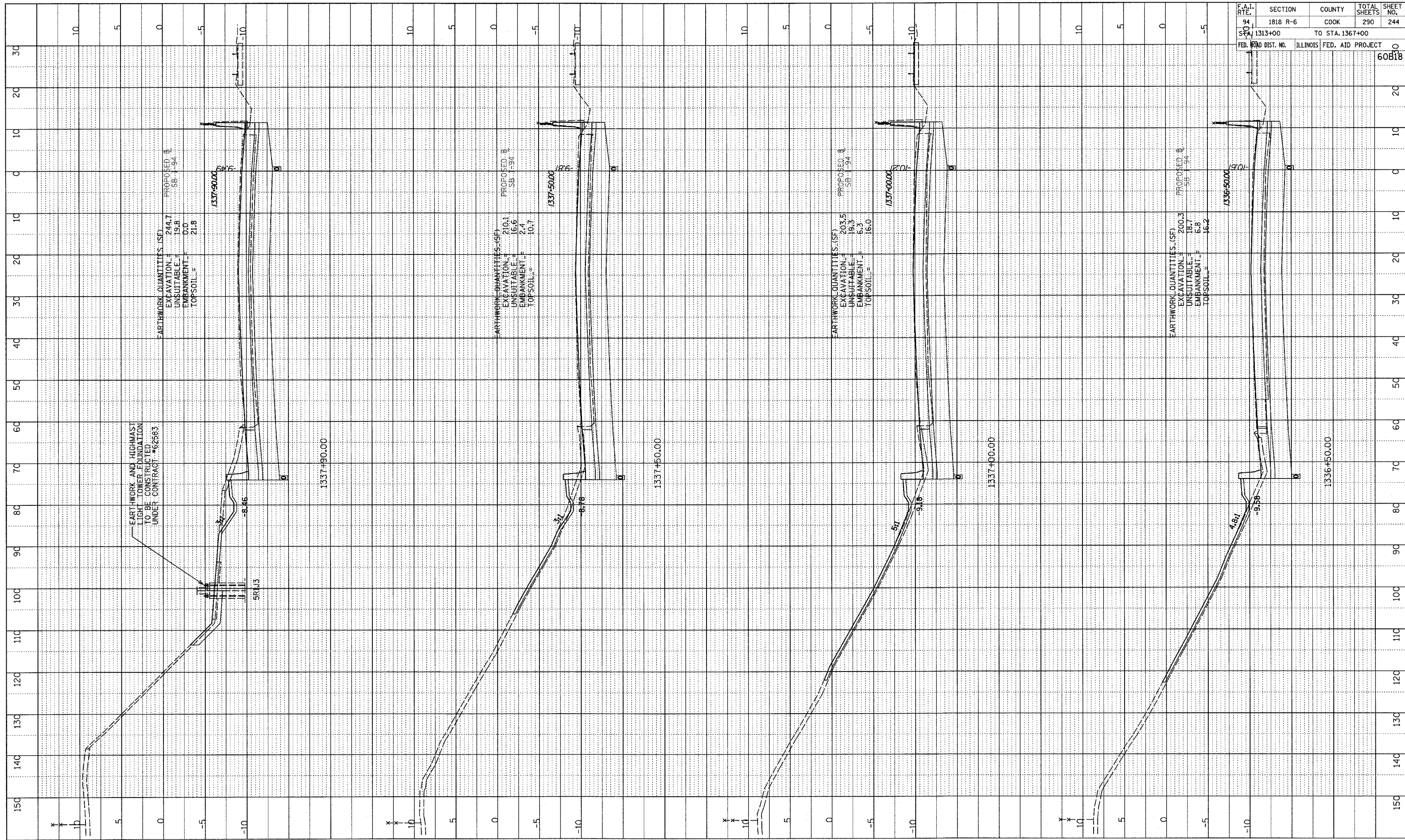

F.A.I. RTE.	SECTION	COUNTY	TOTAL SHEETS	SHEET NO.
94	1818 R-6	COOK	290	244
STA. 1313+00	TO STA. 1367+00			
FED. AID DIST. NO.	ILLINOIS	FED. AID PROJECT		
				60B18

TYLIN INTERNATIONAL

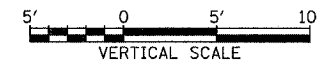
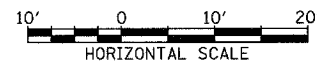

I-94 SOUTHBOUND (DAN RYAN EXPWY)  
 STA. 1336+50 TO STA. 1337+90

02/27/2006 12:50:2 PM R:\02\3\road\23\gpk23\kash1679.dgn