

PROFILE SURVEYED
 PLOTTED
 CHECKED
 NOTE BOOK
 BAL. NOTED
 NO. _____
 STRUCTURE NOTATIONS CHRD

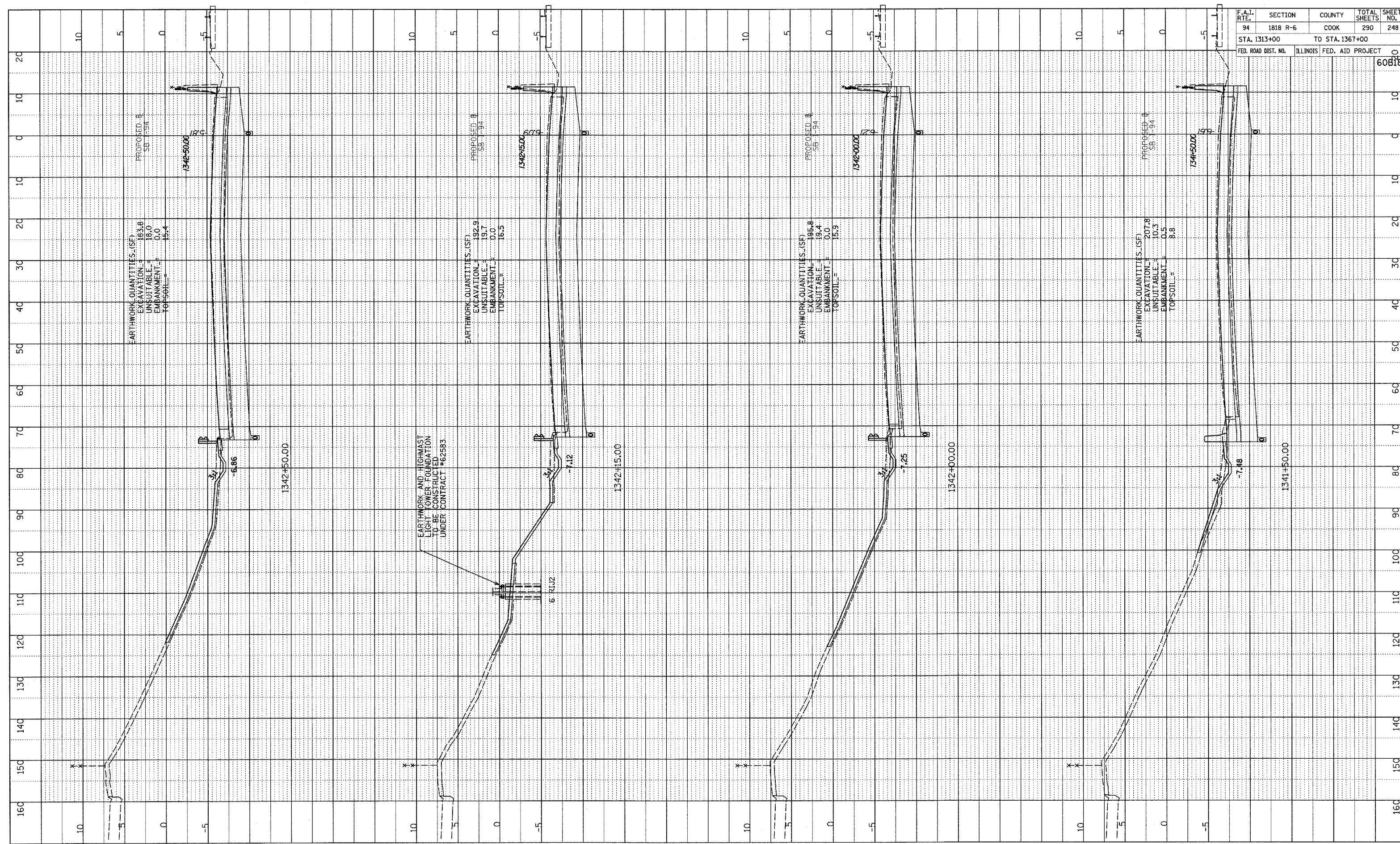

F.A.I. RTE.	SECTION	COUNTY	TOTAL SHEETS	SHEET NO.
94	1818 R-6	COOK	290	248
STA. 1313+00 TO STA. 1367+00				
FED. ROAD DIST. NO.		ILLINOIS FED. AID PROJECT		
				60818

TYLIN INTERNATIONAL

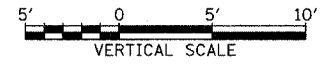

I-94 SOUTHBOUND (DAN RYAN EXPWY)
 STA. 1341+50 TO STA. 1342+50

02/27/2006 12:506 PM P:\0231\3\road\230\p230\p230\ss1715.dgn