

PROFILE SUBMITTED
 PLOTTED, CHECKED
 NOTE BOOK
 NO. _____
 STRUCTURE NOTATIONS CHFD

F.A.L. RTE.	SECTION	COUNTY	TOTAL SHEETS	SHEET NO.
94	1818 R-6	COOK	290	252
STA. 1343+00		TO STA. 1367+00		
FED. ROAD DIST. NO.		ILLINOIS FED. AID PROJECT		

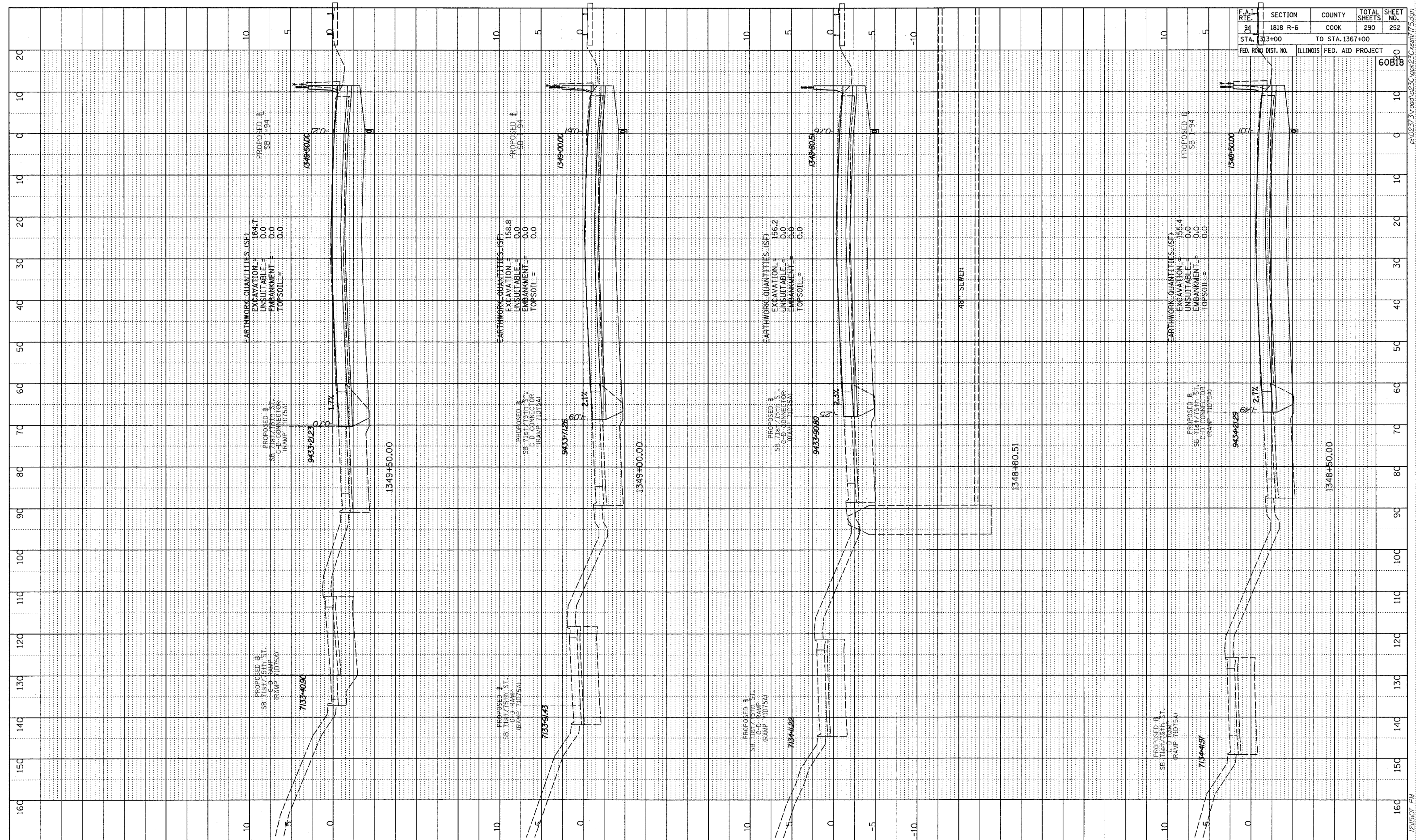

TYLIN INTERNATIONAL

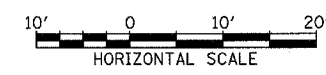

I-94 SOUTHBOUND (DAN RYAN EXPWY)
 STA. 1348+50 TO STA. 1349+50

02/27/2006 12:50:07 PM P:\02\27\2006\23\Drawings\230\exp230.dwg