

PROFILE SURVEYED
 PLOTTED / CHECKED
 NOTE BOOK
 NO. _____
 STRUCTURE NOTATIONS CHRD

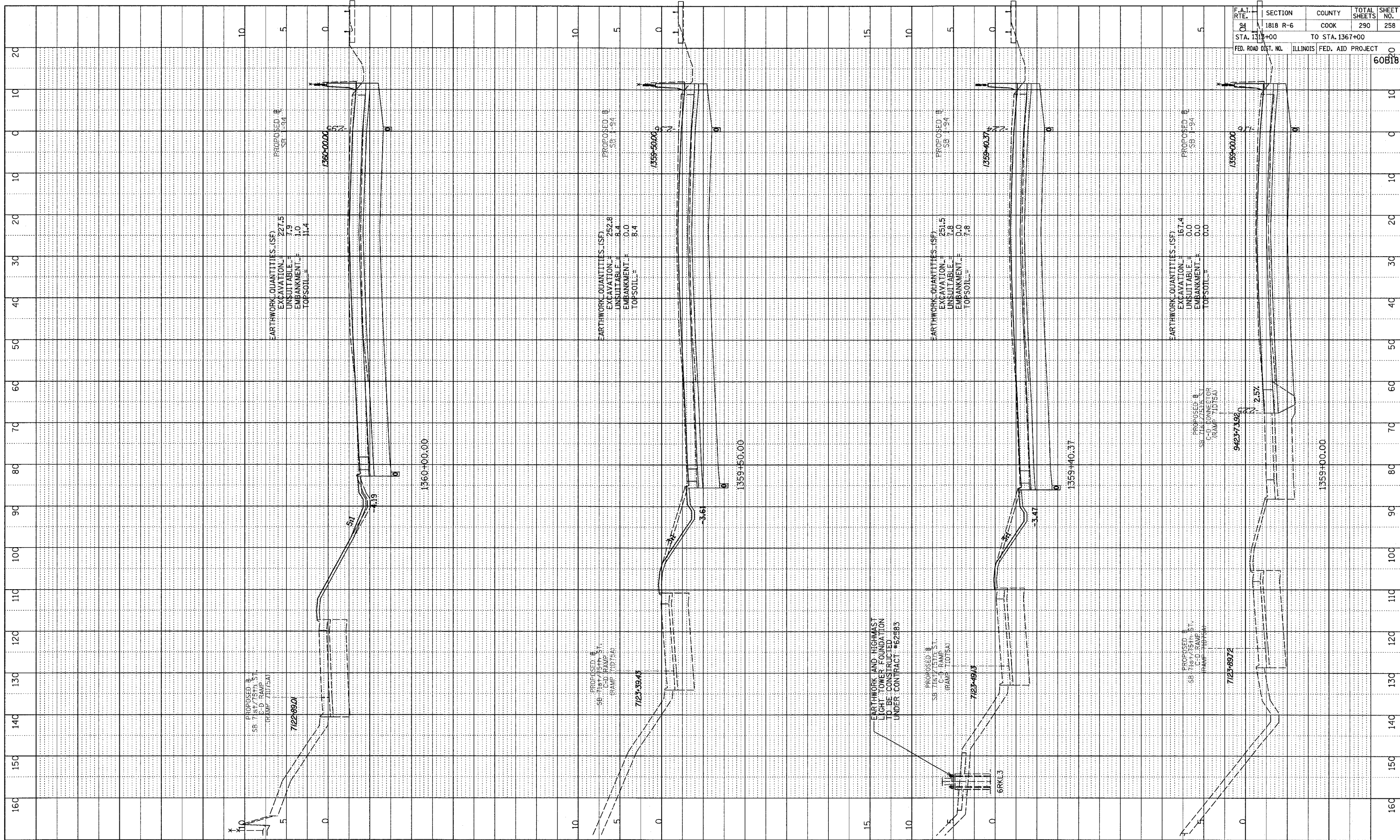

F.A.I. RTE.	SECTION	COUNTY	TOTAL SHEETS	SHEET NO.
94	1818 R-6	COOK	290	258
STA. 1318+00	TO STA. 1367+00			
FED. ROAD DIST. NO.	ILLINOIS	FED. AID PROJECT		
				60B18

TYLIN INTERNATIONAL



I-94 SOUTHBOUND (DAN RYAN EXPWY)
 STA. 1359+00 TO STA. 1360+00

02/27/2006 12:54:55 PM P:\0231_3\road\2530\apk230\ss1715.dgn