

STATE OF ILLINOIS
DEPARTMENT OF TRANSPORTATION

F.A.P. RTE.	SECTION	COUNTY	TOTAL SHEETS	SHEET NO.
344	(45&45X)RS-1	LAKE	2B	1
		ILLINOIS	CONTRACT NO. 62A07	

FOR INDEX OF SHEETS, SEE SHEET NO. 2

DESIGN DESIGNATION

ADT 20,500 (2013)
SPEED LIMIT 30 MPH

**PROPOSED
HIGHWAY PLANS**

FAP 344: US ROUTE 45 (LAKE STREET)
SECTION (45&45X)RS-1
IL ROUTE 176 (MAPLE STREET) TO WOODLAWN DRIVE
RESURFACING (3P) AND PEDESTRIAN RAMPS
LAKE COUNTY

IMPROVEMENT LOCATED IN
THE VILLAGE OF MUNDELEIN



C-91-058-15

END PROJECT
STA. 63 + 84.00

FREMONT TOWNSHIP Range 10E-3rd PM

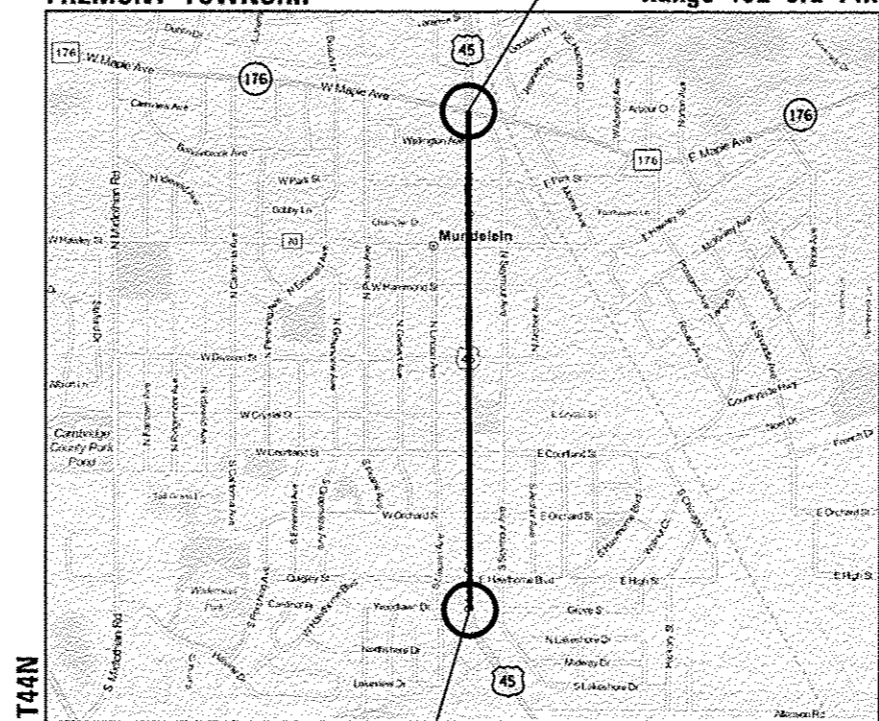

BEGIN PROJECT
STA. 6 + 81.00

LOCATION MAP NOT TO SCALE

GROSS LENGTH = 5703 FT. = 1.08 MILE
NET LENGTH = 5703 FT. = 1.08 MILE

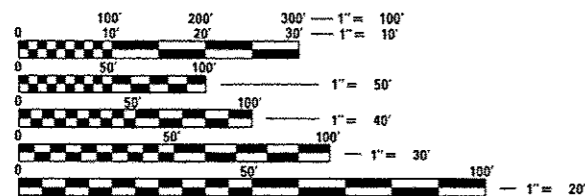

FULL SIZE PLANS HAVE BEEN PREPARED USING STANDARD ENGINEERING SCALES. REDUCED SIZED PLANS WILL NOT CONFORM TO STANDARD SCALES. IN MAKING MEASUREMENTS ON REDUCED PLANS, THE ABOVE SCALES MAY BE USED.

J.U.L.I.E.
JOINT UTILITY LOCATION INFORMATION FOR EXCAVATION
1-800-892-0123
OR 811

PROJECT ENGINEER: MR. J. ALAIN MIDY, P.E. (847) 221-3056
PROJECT MANAGER: MR. ISSAM RAYYAN, P.E. (847) 705-4178

CONTRACT NO. 62A07



COLLINS ENGINEERS, INC.
RYAN CALL
NO. 062-064397
EXPIRES 11-30-2017

COLLINS ENGINEERS, INC.
123 N. HACKER DR., SUITE 900
CHICAGO, IL 60606
(312) 704-9300
ILLINOIS PROFESSIONAL DESIGN FIRM
LICENSE NO. 184-000993

STATE OF ILLINOIS
DEPARTMENT OF TRANSPORTATION
DIVISION OF HIGHWAYS

SUBMITTED March 18 2016
John F. Furtman REGIONAL ENGINEER

May 16 2016
Maureen M. Addis, P.E. ENGINEER OF DESIGN AND ENVIRONMENT

May 16 2016
Andrew J. ... DIRECTOR OF PROGRAM DEVELOPMENT

PRINTED BY THE AUTHORITY
OF THE STATE OF ILLINOIS

INDEX OF SHEETS

1 TITLE SHEET
 2 INDEX OF SHEETS, STATE STANDARDS, AND GENERAL NOTES
 3-7 SUMMARY OF QUANTITIES
 8-9 TYPICAL SECTIONS
 10-12 ROADWAY AND PAVEMENT MARKING PLANS
 13-16 DETECTOR LOOP REPLACEMENT DETAILS
 17 DETAILS FOR FRAME AND LIDS ADJUSTMENT WITH MILLING (BD-8)
 18 PAVEMENT PATCHING FOR HOT-MIX ASPHALT SURFACED PAVEMENT (BD-22)
 19 CURB OR CURB AND GUTTER REMOVAL AND REPLACEMENT (BD-24)
 20 BUTT JOINT AND HOT-MIX ASPHALT TAPER DETAILS (BD-32)
 21 TRAFFIC CONTROL AND PROTECTION FOR SIDE ROADS, INTERSECTIONS, AND DRIVEWAYS (TC-10)
 22 TYPICAL APPLICATIONS RAISED REFLECTIVE PAVEMENT MARKERS (SNOW PLOW RESISTANT) (TC-11)
 23 DISTRICT ONE TYPICAL PAVEMENT MARKINGS (TC-13)
 24 TRAFFIC CONTROL AND PROTECTION AT TURN BAYS (TO REMAIN OPEN TO TRAFFIC (TC-14)
 25 PAVEMENT MARKING LETTERS AND SYMBOLS FOR TRAFFIC STAGING (TC-16)
 26 ARTERIAL ROAD INFORMATION SIGN (TC-22)
 27 DRIVEWAY ENTRANCE SIGNING (TC-26)
 28 DISTRICT ONE DETECTOR LOOP INSTALLATION DETAILS FOR ROADWAY RESURFACING (TS-07)

HIGHWAY STANDARDS

000001-06 STANDARD SYMBOLS, ABBREVIATIONS AND PATTERNS
 424001-08 PERPENDICULAR CURB RAMPS FOR SIDEWALKS
 424011-02 CORNER PARALLEL CURB RAMPS FOR SIDEWALKS
 424021-03 DEPRESSED CORNER FOR SIDEWALKS
 442201-03 CLASS C AND D PATCHES
 604001-04 FRAME AND LIDS TYPE I
 606001-06 CONCRETE CURB TYPE B AND COMBINATION CONCRETE CURB AND GUTTER
 701006-05 OFF-RD OPERATIONS, 2L, 2W, 15' TO 24" FROM PAVEMENT EDGE
 701011-04 OFF ROAD MOVING OPERATIONS, 2L, 2W, DAY ONLY
 701301-04 LANE CLOSURE, 2L, 2W, SHORT TIME OPERATIONS
 701311-03 LANE CLOSURE, 2L, 2W, MOVING OPERATIONS-DAY ONLY
 701427-04 LANE CLOSURE, MULTILANE, INTERMITTENT OR MOVING OPER., FOR SPEEDS <= 40 MPH
 701501-06 URBAN, LANE CLOSURE, 2L, 2W, UNDIVIDED
 701606-10 URBAN SINGLE LANE CLOSURE, MULTILANE, 2W WITH MOUNTABLE MEDIAN
 701701-10 URBAN LANE CLOSURE MULTILANE INTERSECTION
 701801-06 SIDEWALK, CORNER OR CROSSWALK CLOSURE
 701901-05 TRAFFIC CONTROL DEVICES
 780001-05 TYPICAL PAVEMENT MARKINGS

GENERAL NOTES

BEFORE STARTING ANY EXCAVATION, THE CONTRACTOR SHALL CALL "JULIE" AT 1-800-892-0123 OR 811 FOR FIELD LOCATIONS OF BURIED ELECTRIC, TELEPHONE, AND GAS FACILITIES. (48 HOUR NOTIFICATION REQUIRED).

THE CONTRACTOR SHALL COORDINATE CONSTRUCTION ACTIVITIES WITH UTILITY COMPANIES AND THE VILLAGE OF MUNDELEIN.

THE CONTRACTOR WILL NOT BE ALLOWED TO SET UP A YARD OR FIELD OFFICE ON STATE PROPERTY WITHOUT WRITTEN PERMISSION FROM THE DEPARTMENT.

ALL REFERENCES IN THE HIGHWAY STANDARDS AND STANDARD SPECIFICATIONS FOR REINFORCEMENT, DOWEL BARS, AND TIE BARS IN PAVEMENT, SHOULDERS, CURB, CUTTER, COMBINATION CURB AND CUTTER AND MEDIAN, AND CHAIR SUPPORTS FOR CRC PAVEMENT, SHALL BE EPOXY COATED, UNLESS NOTED ON THE PLAN.

WHEN THE MILLED PAVEMENT IS OPEN TO TRAFFIC THE MAXIMUM GRADE DIFFERENTIAL BETWEEN PASSES OF THE MILLING MACHINE SHALL NOT EXCEED 1 1/2 INCHES (40MM) WHERE THE SPEED LIMIT IS 40 MPH (80 KM/HR) OR LESS AND 1 INCH (25 MM) WHERE THE SPEED LIMIT IS GREATER THAN 45 MPH (80KM/HR). WITH WRITTEN APPROVAL FROM THE ENGINEER, A MAXIMUM GRADE DIFFERENTIAL OF 3 INCHES (75MM) MAY BE ALLOWED IF THE EDGE OF THE MILLING IS SLOPED A MINIMUM 1:3 (V:H).

UNLESS OTHER CONDITIONS WARRANT EXTENDED LANE CLOSURES AS DETERMINED AND APPROVED IN WRITING BY THE ENGINEER OR AS PROVIDED FOR IN THE CONTRACT SPECIFICATIONS, OVERNIGHT CLOSURES SHALL NOT BE ALLOWED.

ALL PAVEMENT MARKING AND RAISED REFLECTIVE PAVEMENT MARKERS OBLITERATED BY MILLING AND RESURFACING OPERATIONS ON SIDE STREETS AND ENTRANCES SHALL BE REPLACED AND PAID FOR IN KIND.

BEFORE BEGINNING ANY WORK, THE CONTRACTOR SHALL RETAIN AND RECORD FOR FUTURE REFERENCE, ALL EXISTING PAVEMENT MARKING LINES AND RAISED REFLECTIVE PAVEMENT MARKERS IN ORDER THAT THESE LOCATIONS CAN BE REESTABLISHED FOR STRIPING. EXACT LOCATIONS OF ALL PAVEMENT MARKINGS SHALL BE AS DIRECTED BY THE ENGINEER.

ALL PAVEMENT PATCHING LOCATIONS WILL BE DETERMINED IN THE FIELD BY THE ENGINEER

DRAINAGE AND UTILITY ADJUSTMENT OR RECONSTRUCTION LOCATIONS WILL BE DETERMINED IN THE FIELD BY THE ENGINEER.

LOCATION OF COMBINATION CONCRETE CURB AND GUTTER REPLACEMENT WILL BE DETERMINED IN THE FIELD BY THE ENGINEER.

LIMITS OF PROPOSED CURB RAMP RECONSTRUCTION WILL BE DETERMINED IN THE FIELD BY THE ENGINEER.

IT SHALL BE THE CONTRACTOR'S RESPONSIBILITY TO VERIFY ALL DIMENSIONS AND CONDITIONS EXISTING IN THE FIELD PRIOR TO CONSTRUCTION AND ORDERING OF MATERIALS.

THE CONTRACTOR SHALL CONTACT THE DISTRICT ONE TRAFFIC CONTROL SUPERVISOR AT (847) 705-4470 A MINIMUM OF 72 HOURS IN ADVANCE OF BEGINNING WORK.

THE RESIDENT ENGINEER SHALL CONTACT THE AREA TRAFFIC FIELD ENGINEER, WALTER CZARNY AT (773) 685-4342 A MINIMUM OF TWO (2) WEEKS PRIOR TO PLACEMENT OF PERMANENT PAVEMENT MARKINGS.

THE CONTRACTOR SHALL BE REQUIRED TO PROVIDE ACCESS TO ABUTTING PROPERTY AT ALL TIMES DURING THE CONSTRUCTION OF THE PROJECT.

DO NOT SCALE PLANS FOR CONSTRUCTION DIMENSIONS.

DOUBLE LANE MARKERS ARE TO BE USED AS SHOWN ON THE DISTRICT ONE DETAIL "TYPICAL APPLICATIONS - RAISED REFLECTIVE PAVEMENT MARKERS (SNOW PLOW RESISTANT)" SHOWN ON THE PLANS.

PAVEMENT MARKING TAPE, TYPE III SHALL BE USED FOR SHORT TERM PAVEMENT MARKINGS ON FINAL SURFACES. THE COST OF THE PAVEMENT MARKING TAPE, TYPE III AND ITS REMOVAL SHALL BE INCLUDED IN THE COST OF SHORT TERM PAVEMENT MARKING.

THE CONTRACTOR SHALL CAREFULLY REMOVE, STORE, AND REUSE BRICK PAVERS WHERE APPLICABLE. ANY EXTRA BRICK PAVERS ARE TO BE SALVAGED AND DELIVERED TO VILLAGE OF MUNDELEIN AT 300 PLAZA CIRCLE, MUNDELEIN, IL 60060. THIS WORK SHALL BE INCLUDED IN THE COST OF REMOVE AND REINSTALL BRICK PAVERS.

ADA RAMP NOTES

PRIOR TO PLACING CONCRETE FOR DEPRESSED CURBS, RAMPS, OR SIDEWALKS THE CONTRACTOR SHALL VERIFY THAT LAYOUT OR DESIGN COMPLIES WITH THE REQUIREMENTS OF THE APPLICABLE HIGHWAY STANDARDS.

THE MAXIMUM ALLOWABLE RAMP RUNNING SLOPE IS 1:14, MEASURED AT ANY PORTION OF THE RAMP. THE MAXIMUM ALLOWABLE RAMP CROSS SLOPE IS 1:64, MEASURED AT ANY PORTION OF THE RAMP. IF POSSIBLE, A MORE GRADUAL SLOPE SHALL BE USED.

THE MAXIMUM ALLOWABLE RAMP LANDING SLOPE IS 1:64, MEASURED AT ANY LOCATION AND IN ANY DIRECTION ON THE LANDING. THE RAMP LANDING WIDTH SHALL MATCH THE FULL WIDTH OF THE RAMP FOR A MINIMUM UNOBSTRUCTED DEPTH OF 4'-0". RAMP LANDINGS SHALL BE PROVIDED AT THE TOP AND/OR BOTTOM OF RAMPS WHERE TURNING IS REQUIRED.

RAMP SIDE FLARES SHALL BE INSTALLED AT ANY LOCATION WHERE THE SURFACE ADJACENT TO THE RAMP SURFACE IS INTENDED FOR PEDESTRIAN USE, TRIPPING HAZARDS, INCLUDING STEPS, DROP-OFFS, OR CURBS SHALL NOT BE LOCATED WITHIN THE LIMITS OF THE SIDEWALK. RAMP SIDE FLARES ARE NOT REQUIRED WHERE THE SURFACE ADJACENT TO THE RAMP SURFACE IS LANDSCAPED OR IS OCCUPIED BY A BARRIER THAT BLOCKS PEDESTRIAN ACCESS. EXCEPTIONS TO THIS RULE MAY BE SUBMITTED TO THE ENGINEER FOR APPROVAL.

UTILITIES, SUCH AS LIGHT POLES, TRAFFIC POLES AND HYDRANTS, MAY BE LOCATED IN THE FLARE OF THE RAMP BUT ARE NOT ALLOWED ON THE RAMP SURFACE OR LANDING AREAS. EXISTING UTILITY STRUCTURE LIDS MAY REMAIN WITHIN THE FLARE OR ON THE SURFACE OF THE RAMP AS LONG AS NO VERTICAL LEVEL DIFFERENCES BETWEEN SURFACES ARE GREATER THAN 1/4".

ALTERATIONS SHALL NOT DECREASE THE ACCESSIBILITY TO EXISTING FACILITIES, SIDEWALKS LEADING TO EXISTING FACILITIES, OR DOOR OR GATE ACCESS POINTS TO FACILITIES. THE ELEVATION AT THE EXISTING PROPERTY LINE OR FACILITY ACCESS POINT SHALL BE MAINTAINED AT A MINIMUM. ANY ALTERATIONS ADJACENT TO OR AFFECTING A FACILITY ACCESS POINT SHALL RESULT IN IMPROVED ACCESS OR AT A MINIMUM A REPLICATION OF EXISTING CONDITIONS, INCLUDING SIDEWALK SLOPES AND SURFACE CONDITIONS. FACILITIES INCLUDE, BUT ARE NOT LIMITED TO PRIVATE BUSINESSES, PUBLIC BUILDINGS, RESIDENCES, BUS STOPS, PUBLIC BENCHES, PAY PHONES, AND PARKING METERS.

THE MINIMUM CROSSWALK WIDTH IS 6'-0". CROSSWALKS SHALL BE LOCATED AS SHOWN IN THE PLAN SHEETS DEPENDING ON THE TYPE OF CURB RAMP USED. BEYOND THE CURB FACE AT THE BASE OF CURB RAMPS, A CLEAR SPACE OF 4'-0" BY 4'-0" MINIMUM SHALL BE PROVIDED WITHIN THE STRIPES OF THE CROSSWALK (WHERE PROVIDED).

FILE NAME: I:\72420\72420131 - 26 - Resurfacing US45\CH05\CD00 Sheets\0162087-ut-gennote.dgn



USER NAME = tshah	DESIGNED - RAG	REVISED -
	DRAWN - RAG	REVISED -
PLOT SCALE = 100.0000' / 1"	CHECKED - MGR	REVISED -
PLOT DATE = 3/14/2016	DATE - 2/16/2015	REVISED -

STATE OF ILLINOIS
DEPARTMENT OF TRANSPORTATION

US ROUTE 45 (LAKE STREET)
INDEX OF SHEETS, LIST OF STATE STANDARDS,
AND GENERAL NOTES

F.A.P. RTE.	SECTION	COUNTY	TOTAL SHEETS	SHEET NO.
344	(45&45)RS-1	LAKE	28	2
SCALE: SHEET OF SHEETS STA. TO STA.			CONTRACT NO. 62A07	
[ILLINOIS] FED. AID PROJECT				

CONSTR. CODE

100% STATE

CODE NO.	ITEM	UNIT	TOTAL QUANTITY	ROADWAY
				0005 URBAN
20200100	EARTH EXCAVATION	CU YD	170	170
* 21101615	TOPSOIL FURNISH AND PLACE, 4"	SQ YD	37	37
* 25200110	SODDING, SALT TOLERANT	SQ YD	325	325
* 25200200	SUPPLEMENTAL WATERING	UNIT	3	3
31101200	SUBBASE GRANULAR MATERIAL, TYPE B 4"	SQ YD	944	944
40600290	BITUMINOUS MATERIALS (TACK COAT)	POUND	28044	28044
40600400	MIXTURE FOR CRACKS, JOINTS, AND FLANGEWAYS	TON	6.3	6.3
40600827	POLYMERIZED LEVELING BINDER (MACHINE METHOD), IL-4.75, N50	TON	1704	1704
40600982	HOT-MIX ASPHALT SURFACE REMOVAL - BUTT JOINT	SQ YD	390	390
40603565	POLYMERIZED HOT-MIX ASPHALT SURFACE COURSE, MIX "E", N70	TON	4085	4085
42001300	PROTECTIVE COAT	SQ YD	1346	1346
42400200	PORTLAND CEMENT CONCRETE SIDEWALK 5 INCH	SQ FT	8067	8067
42400800	DETECTABLE WARNINGS	SQ FT	524	524
44000159	HOT-MIX ASPHALT SURFACE REMOVAL, 2 1/2"	SQ YD	41676	41676

* - DENOTES SPECIALTY ITEM

FILE NAME : I:\258\258.33 - 3P Repair Facing US45\CAD00\CAD00 Sheets\0162A07-shv-500.dgn



USER NAME : tahobh	DESIGNED - RAG	REVISED -
PLOT SCALE : 100.0000' / 1" =	DRAWN - RAG	REVISED -
PLOT DATE : 3/14/2016	CHECKED - MGR	REVISED -
	DATE - 2/16/2015	REVISED -

**STATE OF ILLINOIS
DEPARTMENT OF TRANSPORTATION**

**US ROUTE 45 (LAKE STREET)
SUMMARY OF QUANTITIES**

F.A.P. RTE.	SECTION	COUNTY	TOTAL SHEETS	SHEET NO.
344	145&45XRS-1	LAKE	28	3
CONTRACT NO. 62A07			ILLINOIS FED. AID PROJECT	

SCALE: SHEET OF SHEETS STA. TO STA.

FILE NAME = I:\298\298.D3 - 3P Repair Facing US45 CAD\CAD\CAD Sheets\0162A07-11-1500.dgn

CODE NO.	ITEM	UNIT	TOTAL QUANTITY	CONSTR. CODE
				100% STATE ROADWAY 0005 URBAN
44000600	SIDEWALK REMOVAL	SQ FT	8247	8247
44201773	CLASS D PATCHES, TYPE I, 11 INCH	SQ YD	80	80
44201777	CLASS D PATCHES, TYPE II, 11 INCH	SQ YD	60	60
44201781	CLASS D PATCHES, TYPE III, 11 INCH	SQ YD	80	80
44201783	CLASS D PATCHES, TYPE IV, 11 INCH	SQ YD	1070	1070
44201798	CLASS D PATCHES, TYPE I, 13 INCH	SQ YD	30	30
44201803	CLASS D PATCHES, TYPE II, 13 INCH	SQ YD	50	50
44201807	CLASS D PATCHES, TYPE III, 13 INCH	SQ YD	100	100
44201809	CLASS D PATCHES, TYPE IV, 13 INCH	SQ YD	550	550
48102100	AGGREGATE WEDGE SHOULDER, TYPE B	TON	4	4
60250500	CATCH BASINS TO BE ADJUSTED WITH NEW TYPE 1 FRAME, CLOSED LID	EACH	1	1
60255800	MANHOLES TO BE ADJUSTED WITH NEW TYPE 1 FRAME, CLOSED LID	EACH	3	3
60300105	FRAMES AND GRATES TO BE ADJUSTED	EACH	14	14
60600605	CONCRETE CURB, TYPE B	FOOT	1334	1334

* - DENOTES SPECIALTY ITEM



USER NAME = sahehi	DESIGNED - RAG	REVISED -
PLOT SCALE = 100.0000' / in.	DRAWN - RAG	REVISED -
PLOT DATE = 3/14/2016	CHECKED - MGR	REVISED -
	DATE - 2/16/2015	REVISED -

**STATE OF ILLINOIS
DEPARTMENT OF TRANSPORTATION**

**US ROUTE 45 (LAKE STREET)
SUMMARY OF QUANTITIES**

F.A.P. RTE.	SECTION	COUNTY	TOTAL SHEETS	SHEET NO.
344	(45&45)RS-1	LAKE	28	4
CONTRACT NO. 62A07				
[ILLINOIS] FED. AID PROJECT				

SCALE:	SHEET	OF	SHEETS	STA.	TO STA.
--------	-------	----	--------	------	---------

FILE NAME : I:\72181\251823 - 3P Resurfacing US-45\CA80\CA80 Sheets\0162A07.dwt-500.dgn

14

CODE NO.	ITEM	UNIT	TOTAL QUANTITY	CONSTR. CODE
				100% STATE ROADWAY 0005 URBAN
* 66900200	NON-SPECIAL WASTE DISPOSAL	CU YD	250	250
* 66900450	SPECIAL WASTE PLANS AND REPORTS	L SUM	1	1
* 66900530	SOIL DISPOSAL ANALYSIS	EACH	1	1
67000400	ENGINEER'S FIELD OFFICE, TYPE A	CAL MO	6	6
67100100	MOBILIZATION	L SUM	1	1
70102620	TRAFFIC CONTROL AND PROTECTION, STANDARD 701501	L SUM	1	1
70102625	TRAFFIC CONTROL AND PROTECTION, STANDARD 701606	L SUM	1	1
70102635	TRAFFIC CONTROL AND PROTECTION, STANDARD 701701	L SUM	1	1
70102640	TRAFFIC CONTROL AND PROTECTION, STANDARD 701801	L SUM	1	1
70300100	SHORT TERM PAVEMENT MARKING	FOOT	9231	9231
70300210	TEMPORARY PAVEMENT MARKING LETTERS AND SYMBOLS	SQ FT	849	849
70300220	TEMPORARY PAVEMENT MARKING - LINE 4"	FOOT	18095	18095
70300240	TEMPORARY PAVEMENT MARKING - LINE 6"	FOOT	4725	4725
70300250	TEMPORARY PAVEMENT MARKING - LINE 8"	FOOT	547	547

* - DENOTES SPECIALTY ITEM



USER NAME : tshah1	DESIGNED - RAC	REVISED -
PLOT SCALE : 100.0000' / in.	DRAWN - RAC	REVISED -
PLOT DATE : 3/14/2016	CHECKED - MGR	REVISED -
	DATE - 2/16/2015	REVISED -

**STATE OF ILLINOIS
DEPARTMENT OF TRANSPORTATION**

**US ROUTE 45 (LAKE STREET)
SUMMARY OF QUANTITIES**

SCALE: SHEET OF SHEETS STA. TO STA.

F.A.P. RATE	SECTION	COUNTY	TOTAL SHEETS	SHEET NO.
344	(45&45)RS-1	LAKE	28	5
CONTRACT NO. 62A07				
ILLINOIS FED. AID PROJECT				

CODE NO.	ITEM	UNIT	TOTAL QUANTITY	CONSTR. CODE	
				100% STATE	
				ROADWAY	URBAN
70300260	TEMPORARY PAVEMENT MARKING - LINE 12"	FOOT	1540	1540	
70300280	TEMPORARY PAVEMENT MARKING - LINE 24"	FOOT	658	658	
* 78000100	THERMOPLASTIC PAVEMENT MARKING - LETTERS AND SYMBOLS	SQ FT	849	849	
* 78000200	THERMOPLASTIC PAVEMENT MARKING - LINE 4"	FOOT	18095	18095	
* 78000400	THERMOPLASTIC PAVEMENT MARKING - LINE 6"	FOOT	4725	4725	
* 78000500	THERMOPLASTIC PAVEMENT MARKING - LINE 8"	FOOT	547	547	
* 78000600	THERMOPLASTIC PAVEMENT MARKING - LINE 12"	FOOT	1540	1540	
* 78000650	THERMOPLASTIC PAVEMENT MARKING - LINE 24"	FOOT	658	658	
* 78100100	RAISED REFLECTIVE PAVEMENT MARKER	EACH	721	721	
78300100	PAVEMENT MARKING REMOVAL	SQ FT	12458	12458	
78300200	RAISED REFLECTIVE PAVEMENT MARKER REMOVAL	EACH	721	721	
85000200	MAINTENANCE OF EXISTING TRAFFIC SIGNAL INSTALLATION	EACH	5	5	
* 88600600	DETECTOR LOOP REPLACEMENT	FOOT	2675	2675	
* 89502376	REBUILD EXISTING HANDHOLE	EACH	9	9	

* - DENOTES SPECIALTY ITEM

FILE NAME: I:\2015\2015-33 - 3P Repair/Facing US45\CD00\CD00 Sheets\0161507-INT-500.dgn



USER NAME: r_sahni	DESIGNED - RAG	REVISED -
DRAWN - RAG	CHECKED - MGR	REVISED -
PLOT SCALE: 100.0000' / 1" = 100'	DATE: 2/16/2015	REVISED -
PLOT DATE: 3/14/2016		

**STATE OF ILLINOIS
DEPARTMENT OF TRANSPORTATION**

**US ROUTE 45 (LAKE STREET)
SUMMARY OF QUANTITIES**

F.A.P. RTE.	SECTION	COUNTY	TOTAL SHEETS	SHEET NO.
344	45&45XRS-1	LAKE	28	6
			CONTRACT NO. 62A07	

SCALE: SHEET OF SHEETS STA. TO STA. ILLINOIS FED. AID PROJECT

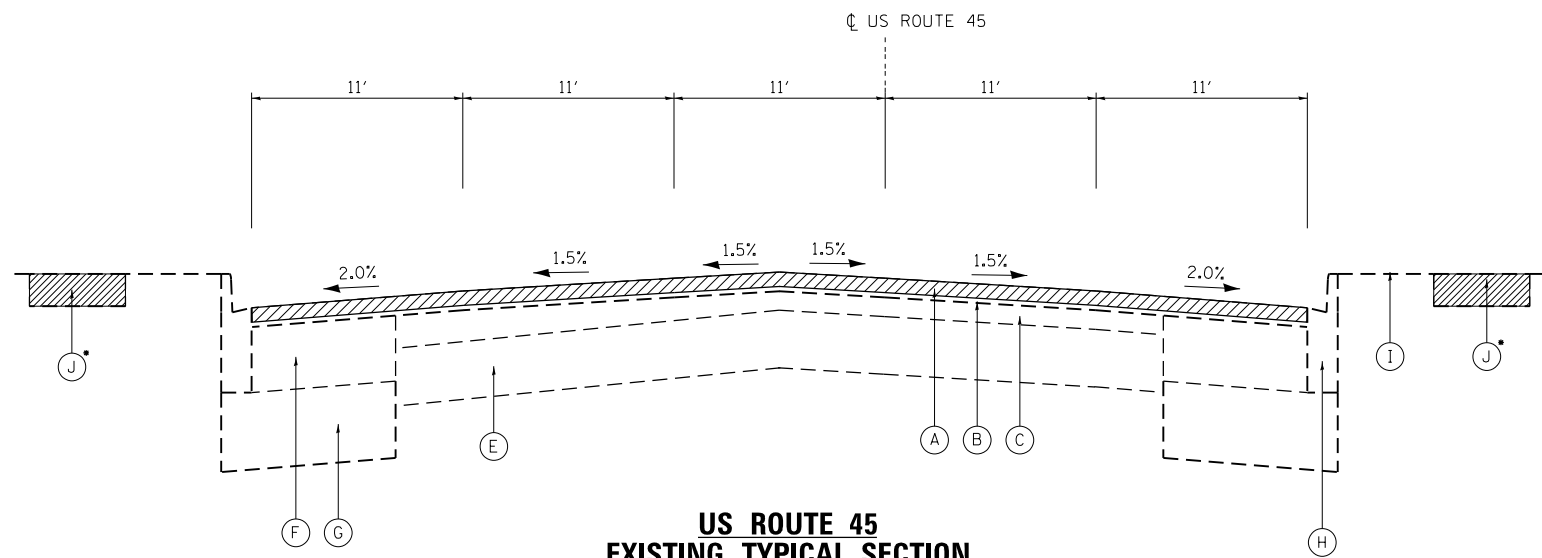

**US ROUTE 45
EXISTING TYPICAL SECTION**
STA. 6+81.00 TO STA. 47+85.00, US RTE. 45

**THE CONTRACTOR SHALL MILL FIRST
BEFORE PATCHING**

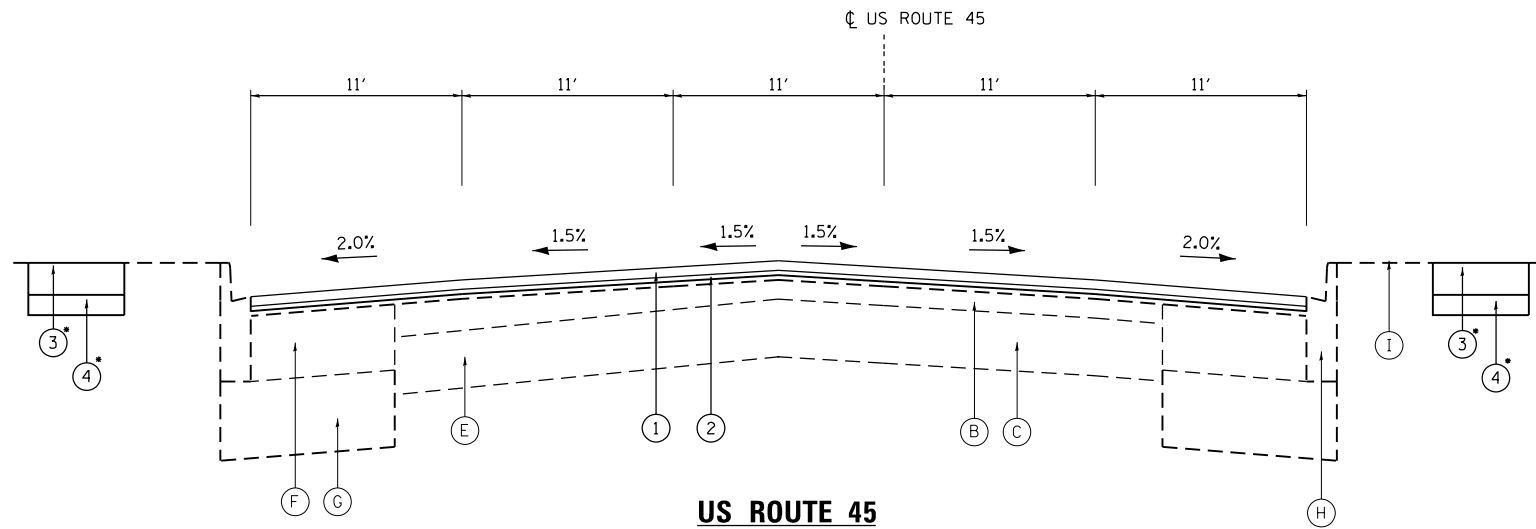

**US ROUTE 45
PROPOSED TYPICAL SECTION**
STA. 6+81.00 TO STA. 47+85.00, US RTE. 45

EXISTING LEGEND:

- (A) PROPOSED HOT-MIX ASPHALT SURFACE REMOVAL, 2 1/2"
- (B) EXISTING HMA BINDER COURSE, +/- 3/4"
- (C) EXISTING HMA PAVEMENT, 3" & VARIES
- (D) NOT USED
- (E) EXISTING PCC BASE COURSE, 9"
- (F) EXISTING HMA BINDER COURSE, 10 1/4"
- (G) EXISTING AGGREGATE SUBGRADE, 12"
- (H) EXISTING CURB & GUTTER
- (I) EXISTING GROUND
- (J) EXISTING SIDEWALK

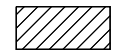

TO BE REMOVED

AS DIRECTED BY THE ENGINEER

PROPOSED LEGEND:

- (1) PROPOSED POLYMERIZED HOT-MIX ASPHALT SURFACE COURSE, MIX "E", N70, 1 3/4"
- (2) PROPOSED POLYMERIZED LEVELING BINDER (MACHINE METHOD), IL-4.75, N50, 3/4"
- (3) PROPOSED PORTLAND CEMENT CONCRETE SIDEWALK, 5"
- (4) PROPOSED SUBBASE GRANULAR MATERIAL, TYPE B, 4"

HOT-MIX ASPHALT MIXTURE REQUIREMENTS MIXTURE TYPE	AIR VOIDS @ NDES	OMP
RESURFACING		
POLYMERIZED HOT-MIX ASPHALT SURFACE COURSE, MIX "E", N70, (IL 9.5 MM)	4% @ 70 GYR.	OCP
POLYMERIZED LEVELING BINDER (MACHINE METHOD) IL-4.75, N50	3.5% @ 50 GYR.	OCP
PATCHING		
CLASS D PATCHES (HMA BINDER IL-19 MM)	4% @ 70 GYR.	QC/OA
OMP DESIGNATION: QUALITY CONTROL/QUALITY ASSURANCE (QC/OA); QUALITY CONTROL FOR PERFORMANCE (OCP)		

THE UNIT WEIGHT USED TO CALCULATE ALL HOT-MIX ASPHALT SURFACE MIXTURES IS 112 LBS/SQ YD / IN.

THE "AC TYPE" FOR ALL POLYMERIZED HMA MIXES SHALL BE "SBS/SBR PG 76-22" AND FOR NON-POLYMERIZED HMA THE "AC TYPE" SHALL BE "PG64-22" UNLESS MODIFIED BY THE DISTRICT ONE SPECIAL PROVISIONS.

FOR USE OF RECYCLED MATERIAL, SEE SPECIAL PROVISIONS.

QUALITY MANAGEMENT PROGRAM (OMP) IDENTIFIES THE PARTICULAR QUALITY CONTROL SPECIFICATION THAT APPLIES TO THE HMA MIXTURE.

FILE NAME = I:\2590\7290.33 - 3P Resurfacing US45\CADD\CADD Sheets\0162A07-sh1-typ.dgn



USER NAME = tshel	DESIGNED - RAG	REVISED -
	DRAWN - RAG	REVISED -
PLOT SCALE = 20.0000' / in.	CHECKED - MGR	REVISED -
PLOT DATE = 3/14/2016	DATE - 2/16/2015	REVISED -

**STATE OF ILLINOIS
DEPARTMENT OF TRANSPORTATION**

US ROUTE 45 (LAKE STREET) TYPICAL SECTIONS	
SCALE:	SHEET OF SHEETS STA. TO STA.

F.A.P. RTE.	SECTION	COUNTY	TOTAL SHEETS	SHEET NO.
344	(45&45)RS-1	LAKE	28	8
CONTRACT NO. 62A07				
ILLINOIS FED. AID PROJECT				

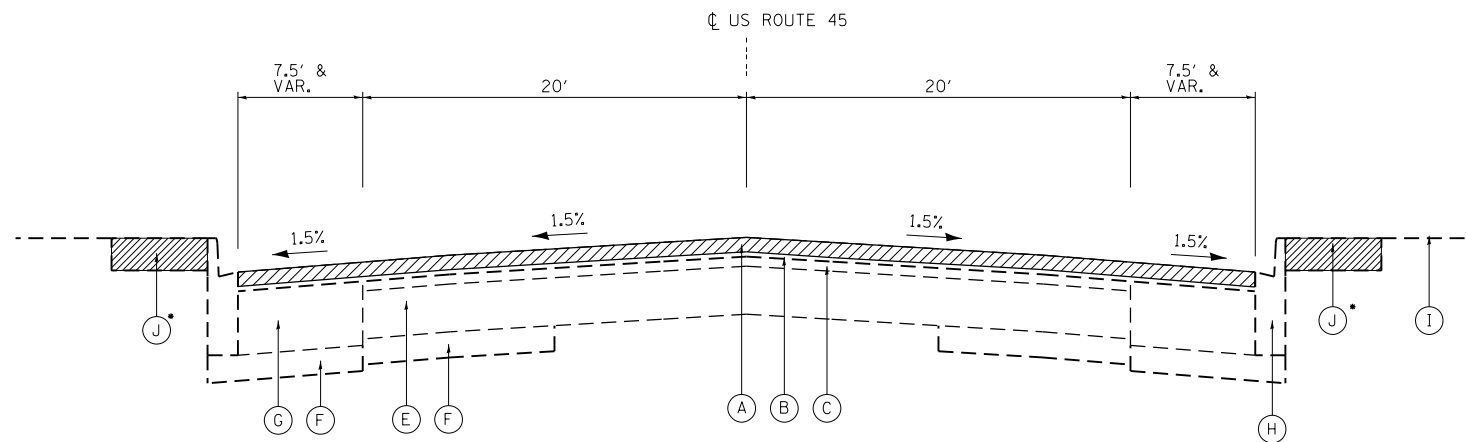

**US ROUTE 45
EXISTING TYPICAL SECTION**

STA. 47+85.00 TO STA. 63+84.00, US RTE. 45

**THE CONTRACTOR SHALL MILL FIRST
BEFORE PATCHING**

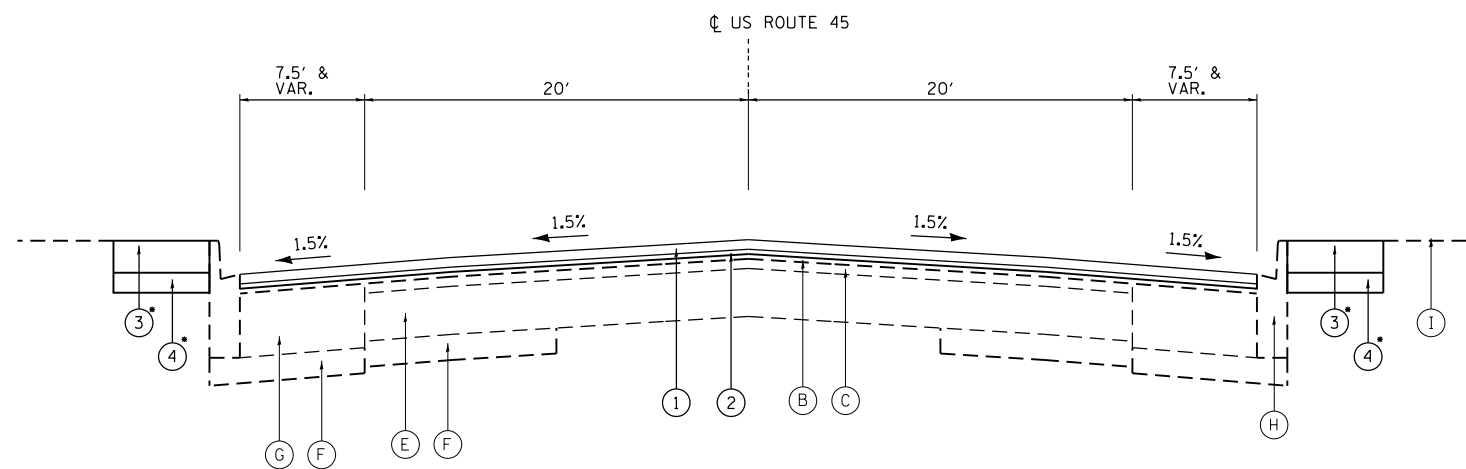

**US ROUTE 45
PROPOSED TYPICAL SECTION**

STA. 47+85.00 TO STA. 63+84.00, US RTE. 45

EXISTING LEGEND:

- (A) PROPOSED HOT-MIX ASPHALT SURFACE REMOVAL, 2 1/2"
- (B) EXISTING HMA BINDER COURSE, +/- 3/4"
- (C) EXISTING HMA PAVEMENT, 3" & VARIES
- (D) NOT USED
- (E) EXISTING PCC BASE COURSE
- (F) EXISTING GRANULAR SUBBASE
- (G) EXISTING HMA BASE COURSE
- (H) EXISTING CURB & GUTTER
- (I) EXISTING GROUND
- (J) EXISTING SIDEWALK

TO BE REMOVED

• AS DIRECTED BY THE ENGINEER

PROPOSED LEGEND:

- (1) PROPOSED POLYMERIZED HOT-MIX ASPHALT SURFACE COURSE, MIX "E", N70, 1 3/4"
- (2) PROPOSED POLYMERIZED LEVELING BINDER (MACHINE METHOD), IL-4.75, N50, 3/4"
- (3) PROPOSED PORTLAND CEMENT CONCRETE SIDEWALK, 5"
- (4) PROPOSED SUBBASE GRANULAR MATERIAL, TYPE B, 4"

FILE NAME = I:\2290\7290.33 - 3P Resurfacing US45\CADD\CADD Sheets\0162A07-sh1-typ.dgn

**COLLINS
ENGINEERS**

USER NAME = tshel	DESIGNED - RAG	REVISED -
	DRAWN - RAG	REVISED -
PLOT SCALE = 20.0000' / in.	CHECKED - MGR	REVISED -
PLOT DATE = 3/14/2016	DATE - 2/16/2015	REVISED -

**STATE OF ILLINOIS
DEPARTMENT OF TRANSPORTATION**

**US ROUTE 45 (LAKE STREET)
TYPICAL SECTIONS**

SCALE: SHEET OF SHEETS STA. TO STA.

F.A.P. RTE.	SECTION	COUNTY	TOTAL SHEETS	SHEET NO.
344	(45&45)RS-1	LAKE	28	9
CONTRACT NO. 62A07			ILLINOIS FED. AID PROJECT	

FILE NAME = I:\V298\7298.33 - 3P Resurfacing US45\CADD\CADD Sheets\0162A07-sh1-plan.dgn

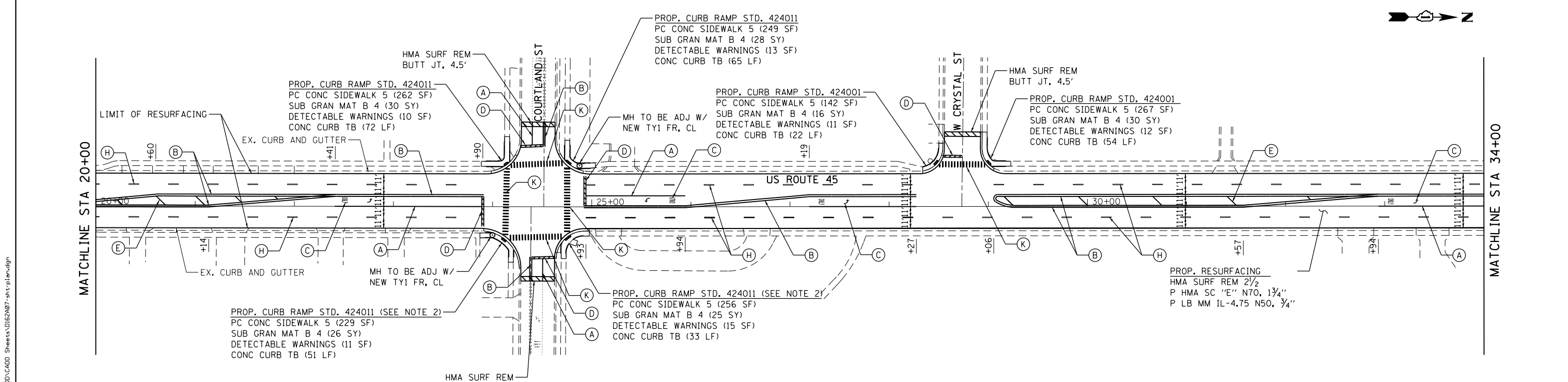
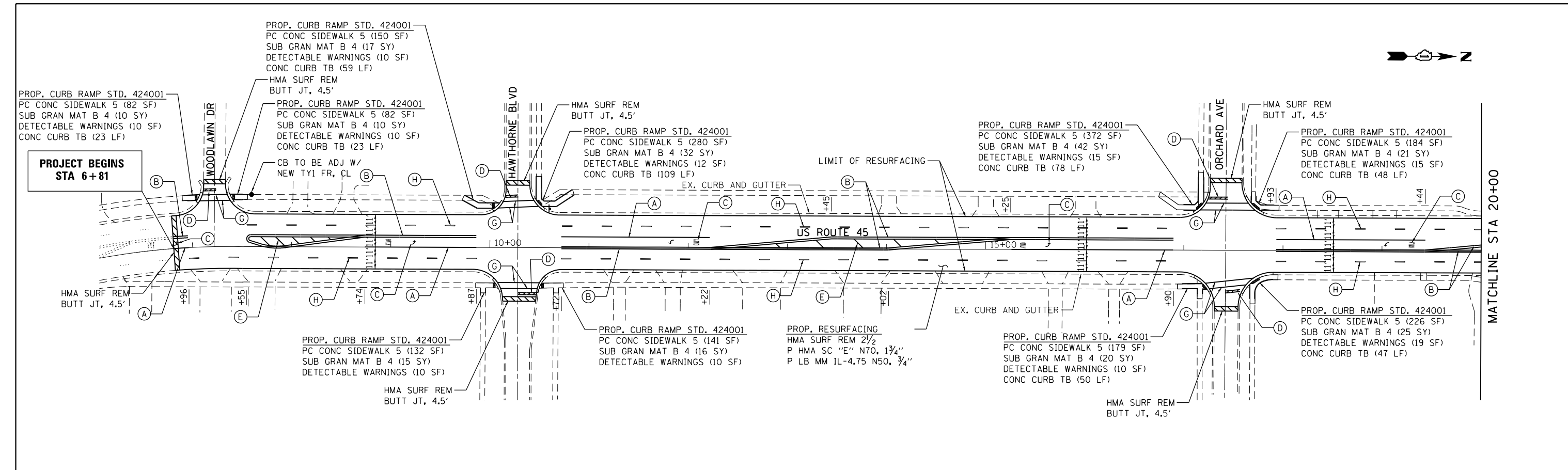

NOTES:

- 1) CONCRETE CURB, TYPE B HAS BEEN PROVIDED AT LOCATIONS WHERE IT IS EXPECTED TO BE NECESSARY IN ORDER TO MEET STANDARDS. SPECIFIC LOCATION AND QUANTITY SHALL BE DETERMINED BY FIELD ENGINEER.
- 2) FIELD ENGINEER IS TO DETERMINE SIDEWALK RAMP SLOPES TO COME CLOSEST TO STANDARD DESIGN OF 1V:12H FOR A MAXIMUM LENGTH OF 15' BETWEEN LOWER AND UPPER LANDINGS.

- (A) PROP. THPL. PAVEMENT MARKING LINE
6" WHITE - TURN LANE LINE (TYP)
- (B) PROP. THPL. PAVEMENT MARKING LINE
2 @ 4" YELLOW - 11" C-C (TYP)
- (C) 8" WHITE - LETTERS AND SYMBOLS (TYP)
(LEFT TURN ONLY, RIGHT TURN ONLY)
- (D) PROP. THPL. PAVEMENT MARKING LINE
24" WHITE SOLID LINE - STOP LINE (TYP)
- (E) PROP. THPL. PAVEMENT MARKING LINE
12" YELLOW - 75' C-C, 45° DIAGONAL (MIN. 5)
- (F) PROP. THPL. PAVEMENT MARKING LINE
6" WHITE - DOTTED LINE
2' DASH, 6' SKIP (TYP)
- (G) PROP. THPL. PAVEMENT MARKING LINE
6" WHITE - CROSSWALK LINES (TYP)
- (H) PROP. THPL. PAVEMENT MARKING LINE
4" WHITE - SKIP DASH LINES
10' DASH, 30' SKIP (TYP)
- (I) PROP. THPL. PAVEMENT MARKING LINE
12" WHITE (RIGHT) / 12" YELLOW (LEFT)
75' C-C, 45° SHOULDER DIAGONALS (MIN. 5)
- (K) PROP. THPL. PAVEMENT MARKING LINE
12" WHITE LINE - PEDESTRIAN CROSSWALK LINES (TYP)
- (L) PROP. THPL. PAVEMENT MARKING LINE
8" WHITE - SHLD (TYP)
- (M) PROP. THPL. PAVEMENT MARKING LINE
4" WHITE - PARKING SPACE LINE (TYP)



USER NAME = tshel	DESIGNED - RAG	REVISED -
PLOT SCALE = 100.0000' / in.	DRAWN - RAG	REVISED -
PLOT DATE = 3/14/2016	CHECKED - MGR	REVISED -
	DATE - 2/16/2015	REVISED -

**STATE OF ILLINOIS
DEPARTMENT OF TRANSPORTATION**

**US ROUTE 45 (LAKE STREET)
ROADWAY AND PAVEMENT MARKING PLAN**

SCALE: SHEET OF SHEETS STA. TO STA.

F.A.P. RTE.	SECTION	COUNTY	TOTAL SHEETS	SHEET NO.
344	(45&45)RS-1	LAKE	28	10
CONTRACT NO. 62A07				

ILLINOIS FED. AID PROJECT

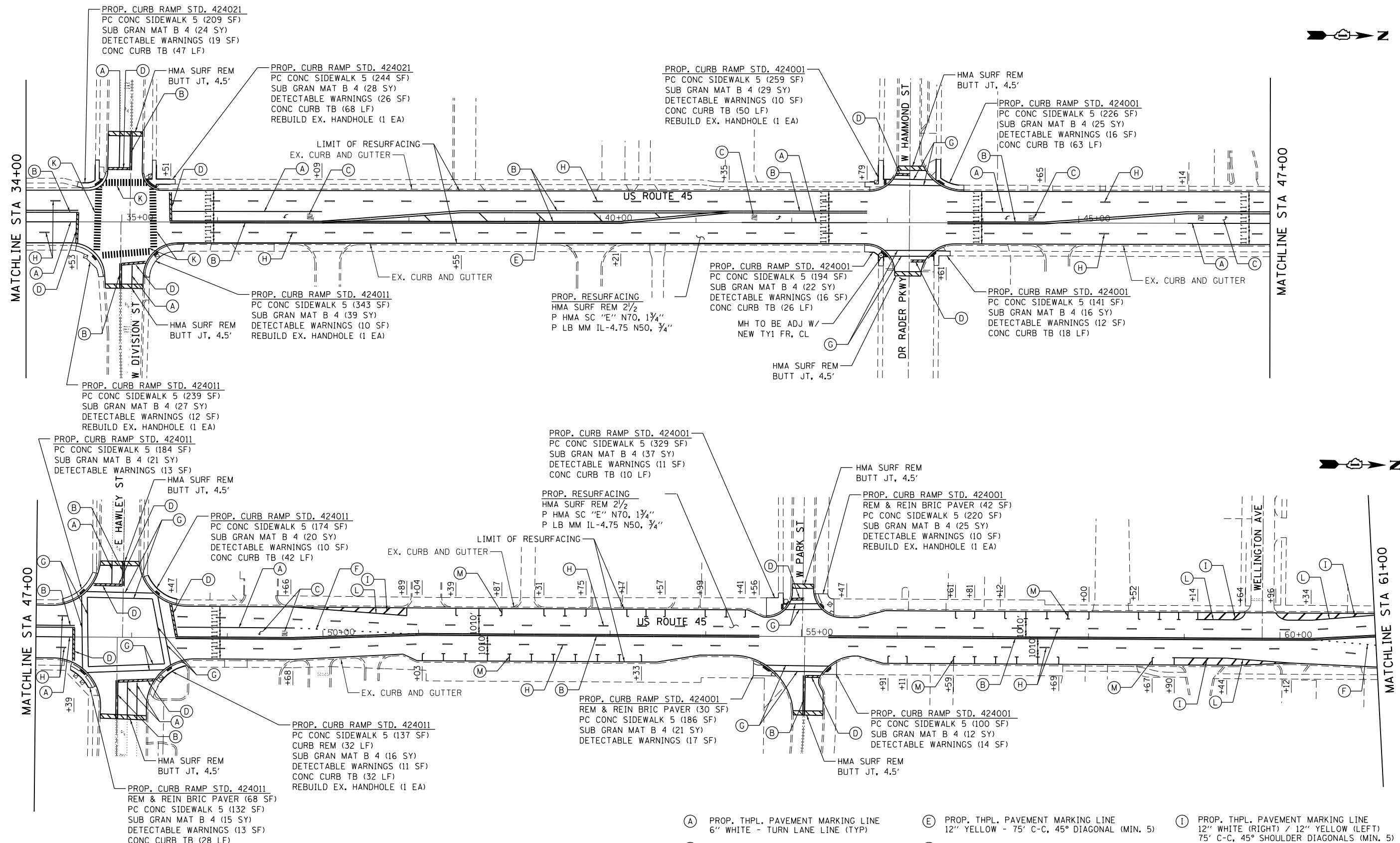
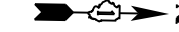
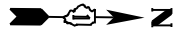

NOTES:

- 1) CONCRETE CURB, TYPE B HAS BEEN PROVIDED AT LOCATIONS WHERE IT IS EXPECTED TO BE NECESSARY IN ORDER TO MEET STANDARDS. SPECIFIC LOCATION AND QUANTITY SHALL BE DETERMINED BY FIELD ENGINEER.
- 2) FIELD ENGINEER IS TO DETERMINE SLOPES OF SIDEWALK RAMPS TO BEST MEET STANDARD DESIGN OF A 1V:12H MAXIMUM.

- | | | |
|---|--|--|
| <p>(A) PROP. THPL. PAVEMENT MARKING LINE
6" WHITE - TURN LANE LINE (TYP)</p> <p>(B) PROP. THPL. PAVEMENT MARKING LINE
2 @ 4" YELLOW - 11" C-C (TYP)</p> <p>(C) 8' WHITE - LETTERS AND SYMBOLS (TYP)
(LEFT TURN ONLY, RIGHT TURN ONLY)</p> <p>(D) PROP. THPL. PAVEMENT MARKING LINE
24" WHITE SOLID LINE - STOP LINE (TYP)</p> | <p>(E) PROP. THPL. PAVEMENT MARKING LINE
12" YELLOW - 75' C-C, 45° DIAGONAL (MIN. 5)</p> <p>(F) PROP. THPL. PAVEMENT MARKING LINE
6" WHITE - DOTTED LINE
2' DASH, 6' SKIP (TYP)</p> <p>(G) PROP. THPL. PAVEMENT MARKING LINE
6" WHITE - CROSSWALK LINES (TYP)</p> <p>(H) PROP. THPL. PAVEMENT MARKING LINE
4" WHITE - SKIP DASH LINES
10' DASH, 30' SKIP (TYP)</p> | <p>(I) PROP. THPL. PAVEMENT MARKING LINE
12" WHITE (RIGHT) / 12" YELLOW (LEFT)
75' C-C, 45° SHOULDER DIAGONALS (MIN. 5)</p> <p>(K) PROP. THPL. PAVEMENT MARKING LINE
12" WHITE LINE - PEDESTRIAN CROSSWALK LINES (TYP)</p> <p>(L) PROP. THPL. PAVEMENT MARKING LINE
8" WHITE - SHLD (TYP)</p> <p>(M) PROP. THPL. PAVEMENT MARKING LINE
4" WHITE - PARKING SPACE LINE (TYP)</p> |
|---|--|--|



USER NAME = tshehi	DESIGNED - RAG	REVISED -
PLOT SCALE = 100.0000' / in.	DRAWN - RAG	REVISED -
PLOT DATE = 3/14/2016	CHECKED - MGR	REVISED -
	DATE - 2/16/2015	REVISED -

**STATE OF ILLINOIS
DEPARTMENT OF TRANSPORTATION**

**US ROUTE 45 (LAKE STREET)
ROADWAY AND PAVEMENT MARKING PLAN**

SCALE: SHEET OF SHEETS STA. TO STA.

F.A.P. RTE.	SECTION	COUNTY	TOTAL SHEETS	SHEET NO.
344	(45&45)RS-1	LAKE	28	11
CONTRACT NO. 62A07				
ILLINOIS FED. AID PROJECT				

FILE NAME = I:\7290\7290.33 - 3P Resurfacing US45\CADD\CADD Sheets\0162A07-sh1-plan.dgn

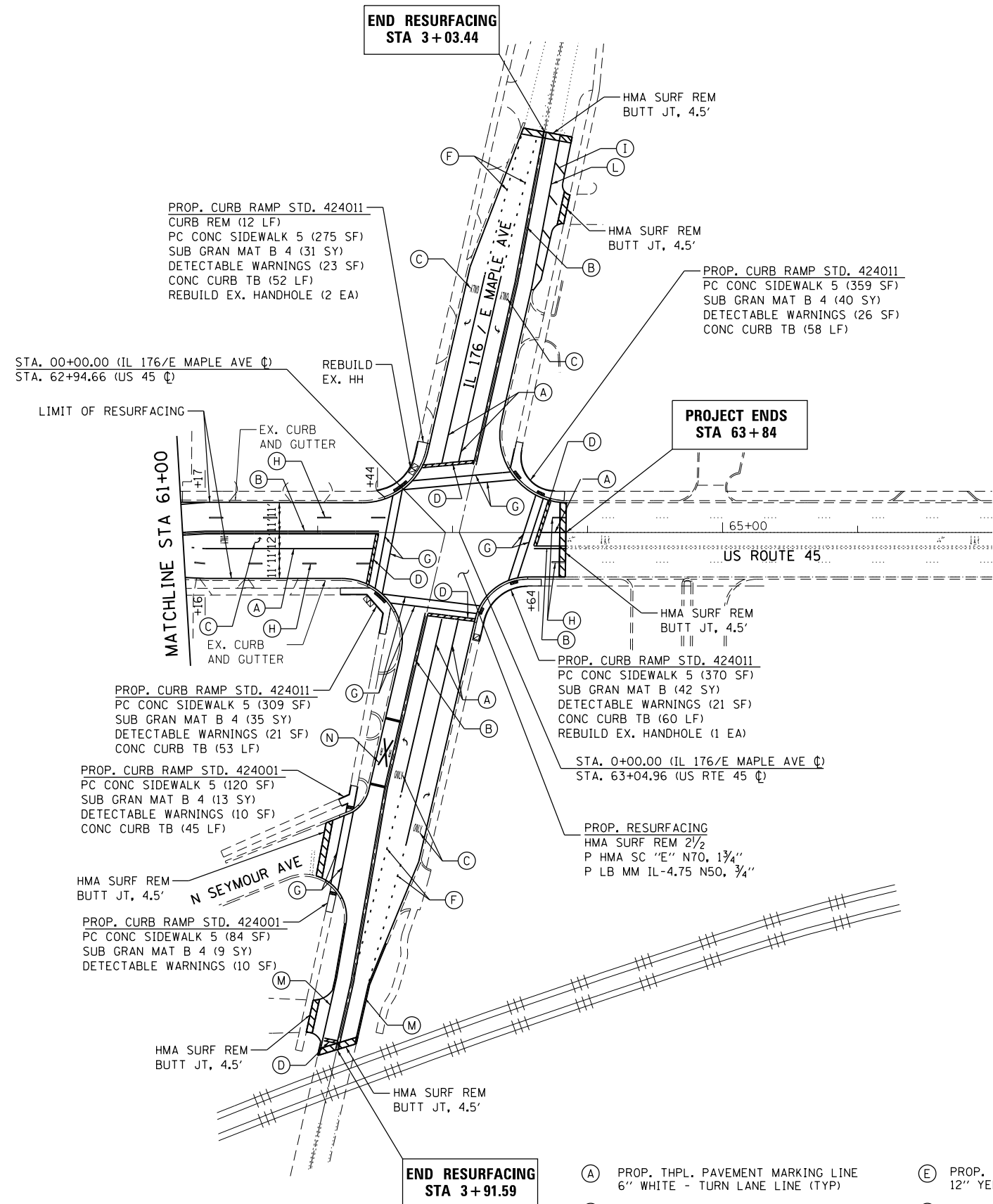

NOTES:

- 1) CONCRETE CURB, TYPE B HAS BEEN PROVIDED AT LOCATIONS WHERE IT IS EXPECTED TO BE NECESSARY IN ORDER TO MEET STANDARDS. SPECIFIC LOCATION AND QUANTITY SHALL BE DETERMINED BY FIELD ENGINEER.
- 2) FIELD ENGINEER IS TO DETERMINE SLOPES OF SIDEWALK RAMPS TO BEST MEET STANDARD DESIGN OF A 1V:12H MAXIMUM.

- (A) PROP. THPL. PAVEMENT MARKING LINE 6" WHITE - TURN LANE LINE (TYP)
- (B) PROP. THPL. PAVEMENT MARKING LINE 2 @ 4" YELLOW - 11" C-C (TYP)
- (C) 8' WHITE - LETTERS AND SYMBOLS (TYP) (LEFT TURN ONLY, RIGHT TURN ONLY)
- (D) PROP. THPL. PAVEMENT MARKING LINE 24" WHITE SOLID LINE - STOP LINE (TYP)
- (E) PROP. THPL. PAVEMENT MARKING LINE 12" YELLOW - 75" C-C, 45° DIAGONAL (MIN. 5)
- (F) PROP. THPL. PAVEMENT MARKING LINE 6" WHITE - DOTTED LINE 2' DASH, 6' SKIP (TYP)
- (G) PROP. THPL. PAVEMENT MARKING LINE 6" WHITE - CROSSWALK LINES (TYP)
- (H) PROP. THPL. PAVEMENT MARKING LINE 4" WHITE - SKIP DASH LINES 10' DASH, 30' SKIP (TYP)
- (I) PROP. THPL. PAVEMENT MARKING LINE 12" WHITE (RIGHT) / 12" YELLOW (LEFT) 75" C-C, 45° SHOULDER DIAGONALS (MIN. 5)
- (K) PROP. THPL. PAVEMENT MARKING LINE 12" WHITE LINE - PEDESTRIAN CROSSWALK LINES (TYP)
- (L) PROP. THPL. PAVEMENT MARKING LINE 8" WHITE - SHLD (TYP)
- (M) PROP. THPL. PAVEMENT MARKING LINE 4" WHITE - EDGE LINE (TYP)
- (N) PROP. THPL. LETTERS AND SYMBOLS (TYP) RAILROAD CROSSING

FILE NAME = I:\7290\7290.33 - 3P Resurfacing US45\CADD\CADD Sheets\182A07-sht-plan.dgn



USER NAME = tsheh	DESIGNED - RAG	REVISED -
	DRAWN - RAG	REVISED -
PLOT SCALE = 100.0000' / in.	CHECKED - MGR	REVISED -
PLOT DATE = 3/14/2016	DATE - 2/16/2015	REVISED -

**STATE OF ILLINOIS
DEPARTMENT OF TRANSPORTATION**

**US ROUTE 45 (LAKE STREET)
ROADWAY AND PAVEMENT MARKING PLAN**

SCALE: SHEET OF SHEETS STA. TO STA.

F.A.P. RTE.	SECTION	COUNTY	TOTAL SHEETS	SHEET NO.
344	(45&45)RS-1	LAKE	28	12
CONTRACT NO. 62A07			ILLINOIS FED. AID PROJECT	

WORK SHALL MEET THE REQUIREMENTS OF THE SPECIAL PROVISION, "TRAFFIC SIGNAL SPECIFICATIONS FOR DETECTOR LOOP REPLACEMENT AND/OR INSTALLATION ON ROADWAY GRINDING, RESURFACING AND PATCHING OPERATIONS". SPECIAL ATTENTION MUST BE MADE TO THE SECTIONS "INSPECTION OF CONSTRUCTION" AND "DETECTOR LOOP REPLACEMENT" FOR INSTALLATION AND INSPECTION REQUIREMENTS. LOOP REPLACEMENT WORK THAT DOES NOT MEET THE CONTRACT REQUIREMENTS SHALL NOT BE PAID. WORK NECESSARY TO COMPLETE THE LOOP REPLACEMENT WORK MAY BE ASSIGNED BY THE ENGINEER TO IDOT'S ELECTRICAL MAINTENANCE CONTRACTOR (EMC); ALL RELATED COSTS WILL BE THE RESPONSIBILITY OF THE CONTRACTOR.

TRAFFIC SIGNAL LEGEND

	PROPOSED	EXISTING
SIGNAL HEAD WITH BACKPLATE	⊕	⊕
SIGNAL HEAD	⊖	⊖
GALVANIZED STEEL CONDUIT IN TRENCH OR PUSHED	---	---
DETECTOR LOOP	□	□
VEHICLE DETECTOR, NON COMPENSATED MAGNETIC TYPE	⊔	⊔
RACEWAY FOR MAGNETIC DETECTOR, TYPE I OR TYPE II	⊔	⊔ "E"

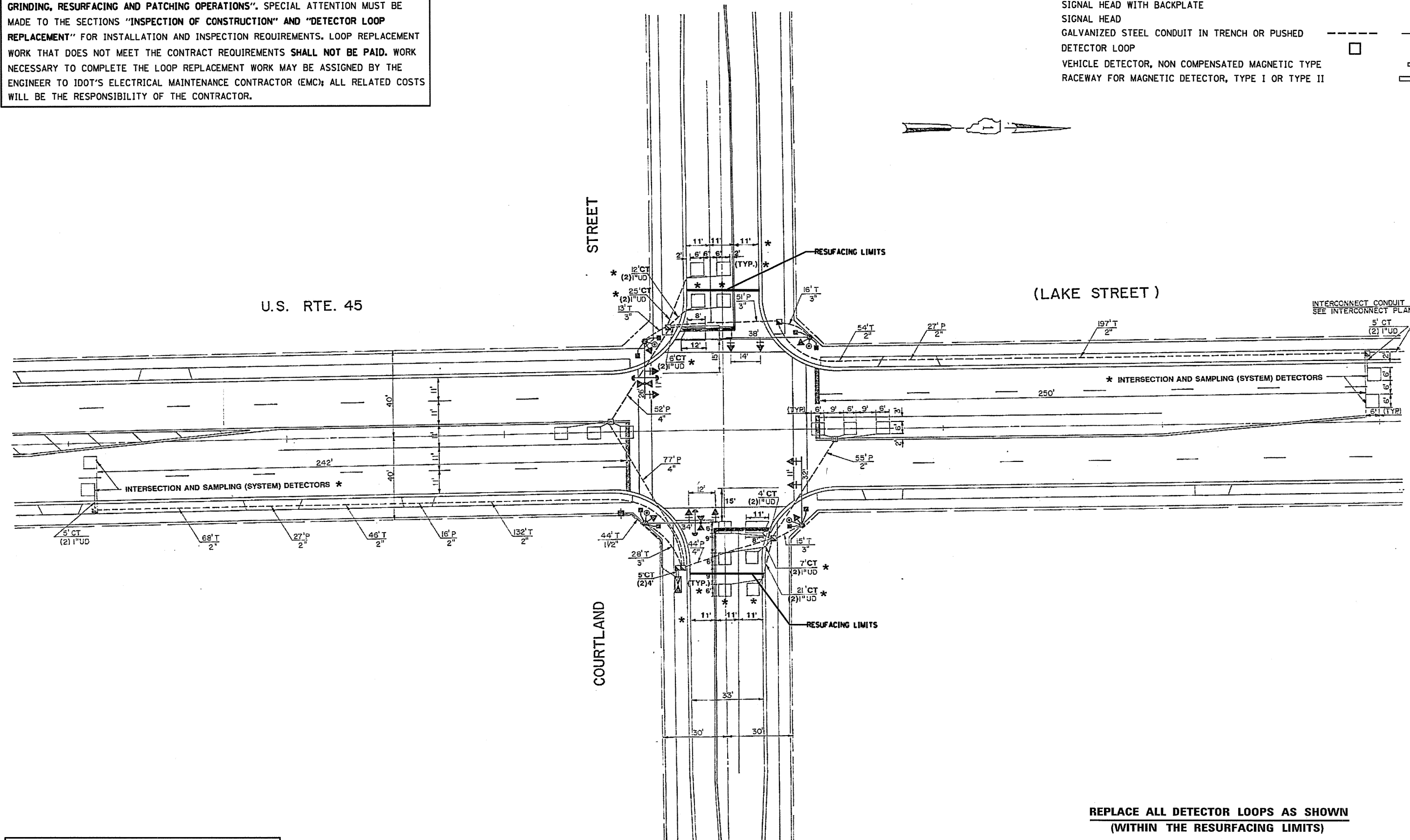

THIS PLAN IS FOR THE SOLE PURPOSE OF DETECTOR LOOP REPLACEMENTS ONLY

REPLACE ALL DETECTOR LOOPS AS SHOWN (WITHIN THE RESURFACING LIMITS)

CODE	QUANTITY	UNIT	ITEM
88600600	632	FOOT	DETECTOR LOOP REPLACEMENT

FILE NAME =	USER NAME = curryja	DESIGNED -	REVISED -	STATE OF ILLINOIS DEPARTMENT OF TRANSPORTATION	DISTRICT ONE - DETECTOR LOOP REPLACEMENT US ROUTE 45 AT COURTLAND ST.	F.A.P. RTE.	SECTION	COUNTY	TOTAL SHEETS	SHEET NO.
S:\WP\Design\JC\Detector Loop Details\62A07\Detector Loop.dgn		DRAWN -	REVISED -			344	(45&45X)RS-1	LAKE	28	13
PLOT SCALE = 100.0001' / in.		CHECKED -	REVISED -			CONTRACT NO. 62A07				
PLOT DATE = 2/5/2015		DATE -	REVISED -			FED. ROAD DIST. NO.	ILLINOIS FED. AID PROJECT			
						SCALE: NTS	SHEET NO.	OF SHEETS	STA.	TO STA.

WORK SHALL MEET THE REQUIREMENTS OF THE SPECIAL PROVISION, "TRAFFIC SIGNAL SPECIFICATIONS FOR DETECTOR LOOP REPLACEMENT AND/OR INSTALLATION ON ROADWAY GRINDING, RESURFACING AND PATCHING OPERATIONS". SPECIAL ATTENTION MUST BE MADE TO THE SECTIONS "INSPECTION OF CONSTRUCTION" AND "DETECTOR LOOP REPLACEMENT" FOR INSTALLATION AND INSPECTION REQUIREMENTS. LOOP REPLACEMENT WORK THAT DOES NOT MEET THE CONTRACT REQUIREMENTS SHALL NOT BE PAID. WORK NECESSARY TO COMPLETE THE LOOP REPLACEMENT WORK MAY BE ASSIGNED BY THE ENGINEER TO IDOT'S ELECTRICAL MAINTENANCE CONTRACTOR (EMC); ALL RELATED COSTS WILL BE THE RESPONSIBILITY OF THE CONTRACTOR.

TRAFFIC SIGNAL LEGEND

	PROPOSED	EXISTING
SIGNAL HEAD WITH BACKPLATE	⇨	⇨
SIGNAL HEAD	⇨	⇨
GALVANIZED STEEL CONDUIT IN TRENCH OR PUSHED	---	---
DETECTOR LOOP	□	□
VEHICLE DETECTOR, NON COMPENSATED MAGNETIC TYPE	—	—
RACEWAY FOR MAGNETIC DETECTOR, TYPE I OR TYPE II	—	— "E"

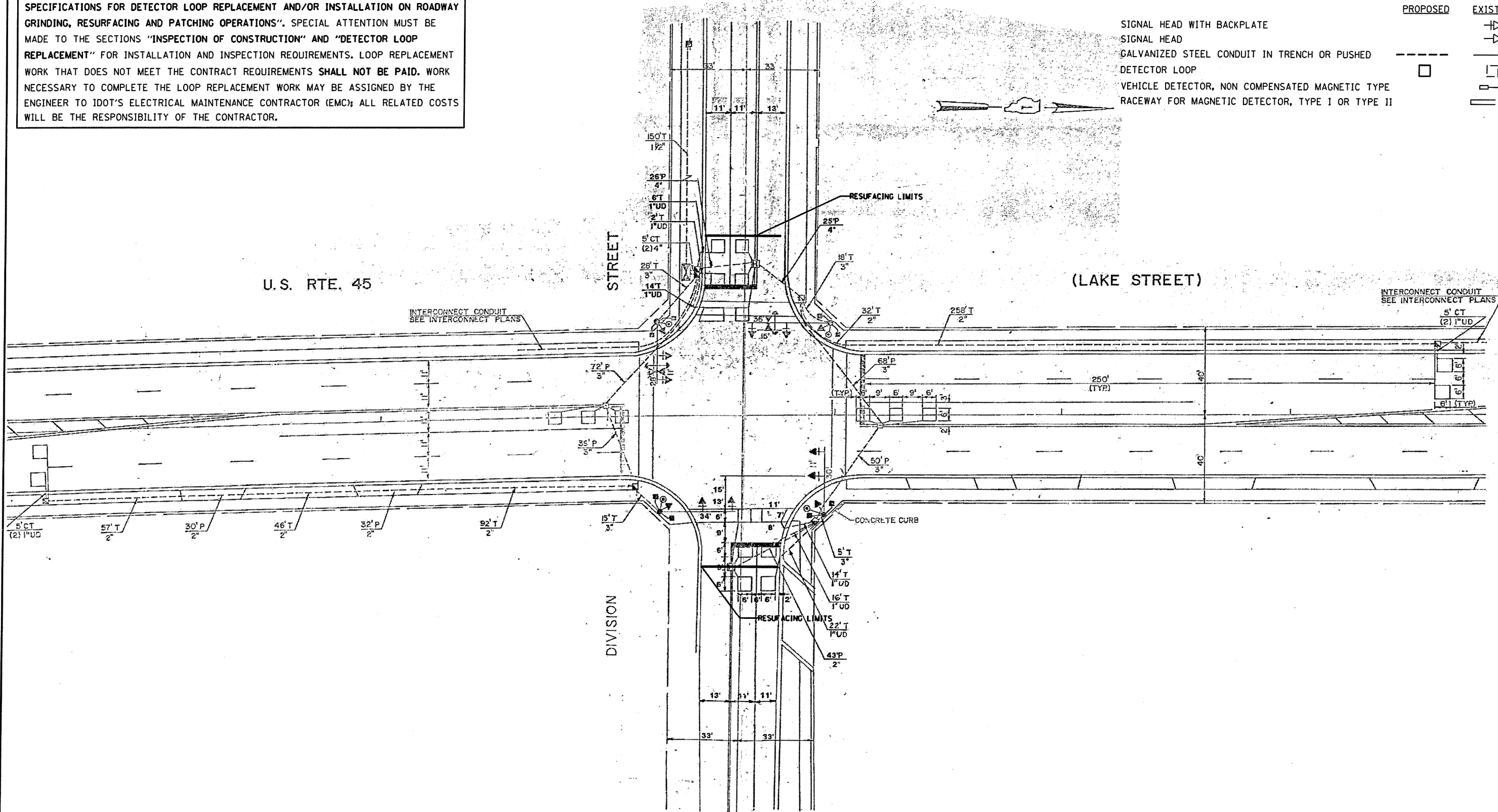

THIS PLAN IS FOR THE SOLE PURPOSE OF DETECTOR LOOP REPLACEMENTS ONLY

REPLACE ALL DETECTOR LOOPS AS SHOWN (WITHIN THE RESURFACING LIMITS)

CODE	QUANTITY	UNIT	ITEM
88600600	675	FOOT	DETECTOR LOOP REPLACEMENT

FILE NAME =	USER NAME = curryjg	DESIGNED -	REVISED -
S:\WP\Design\JC\Detector Loop Details\G	A87\Detector Loop.dgn	DRAWN -	REVISED -
	PLOT SCALE = 100.0001' / in.	CHECKED -	REVISED -
	PLOT DATE = 2/5/2015	DATE -	REVISED -

**STATE OF ILLINOIS
DEPARTMENT OF TRANSPORTATION**

**DISTRICT ONE - DETECTOR LOOP REPLACEMENT
US ROUTE 45 AT DIVISION ST.**

F.A.P. RTE.	SECTION	COUNTY	TOTAL SHEETS	SHEET NO.
344	(45&45)RS-1	LAKE	28	14
FED. ROAD DIST. NO.			ILLINOIS FED. AID PROJECT	
			CONTRACT NO. 62A07	

SCALE: NTS SHEET NO. OF SHEETS STA. TO STA.

WORK SHALL MEET THE REQUIREMENTS OF THE SPECIAL PROVISION, "TRAFFIC SIGNAL SPECIFICATIONS FOR DETECTOR LOOP REPLACEMENT AND/OR INSTALLATION ON ROADWAY GRINDING, RESURFACING AND PATCHING OPERATIONS". SPECIAL ATTENTION MUST BE MADE TO THE SECTIONS "INSPECTION OF CONSTRUCTION" AND "DETECTOR LOOP REPLACEMENT" FOR INSTALLATION AND INSPECTION REQUIREMENTS. LOOP REPLACEMENT WORK THAT DOES NOT MEET THE CONTRACT REQUIREMENTS SHALL NOT BE PAID. WORK NECESSARY TO COMPLETE THE LOOP REPLACEMENT WORK MAY BE ASSIGNED BY THE ENGINEER TO IDOT'S ELECTRICAL MAINTENANCE CONTRACTOR (EMC); ALL RELATED COSTS WILL BE THE RESPONSIBILITY OF THE CONTRACTOR.

TRAFFIC SIGNAL LEGEND

	PROPOSED	EXISTING
SIGNAL HEAD WITH BACKPLATE	→	→
SIGNAL HEAD	→	→
GALVANIZED STEEL CONDUIT IN TRENCH OR PUSHED	---	---
DETECTOR LOOP	□	□
VEHICLE DETECTOR, NON COMPENSATED MAGNETIC TYPE	—	—
RACEWAY FOR MAGNETIC DETECTOR, TYPE I OR TYPE II	—	—

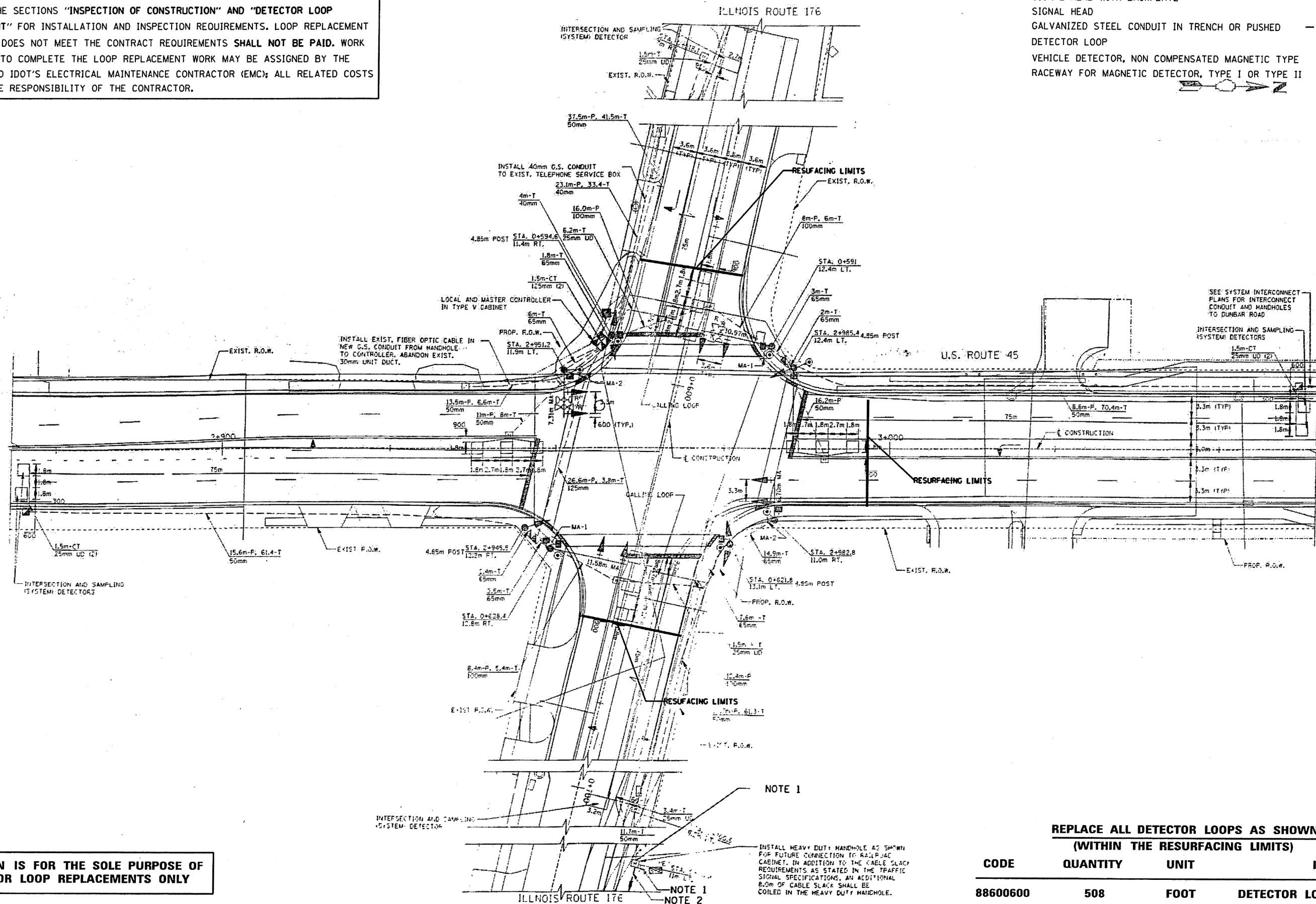

THIS PLAN IS FOR THE SOLE PURPOSE OF DETECTOR LOOP REPLACEMENTS ONLY

REPLACE ALL DETECTOR LOOPS AS SHOWN (WITHIN THE RESURFACING LIMITS)

CODE	QUANTITY	UNIT	ITEM
88600600	508	FOOT	DETECTOR LOOP REPLACEMENT

FILE NAME =	USER NAME = curryjo	DESIGNED -	REVISED -	STATE OF ILLINOIS DEPARTMENT OF TRANSPORTATION	DISTRICT ONE - DETECTOR LOOP REPLACEMENT US ROUTE 45 AT IL ROUTE 176	F.A.P. RTE.	SECTION	COUNTY	TOTAL SHEETS	SHEET NO.	
S:\WP\Design\JC\Detector Loop Details\6	407\Detector Loop.dgn	DRAWN -	REVISED -			344	(45&45)RS-1	LAKE	28	16	
	PLOT SCALE = 100.0001' / in.	CHECKED -	REVISED -			CONTRACT NO. 62A07					
	PLOT DATE = 2/5/2015	DATE -	REVISED -			ILLINOIS FED. AID PROJECT					

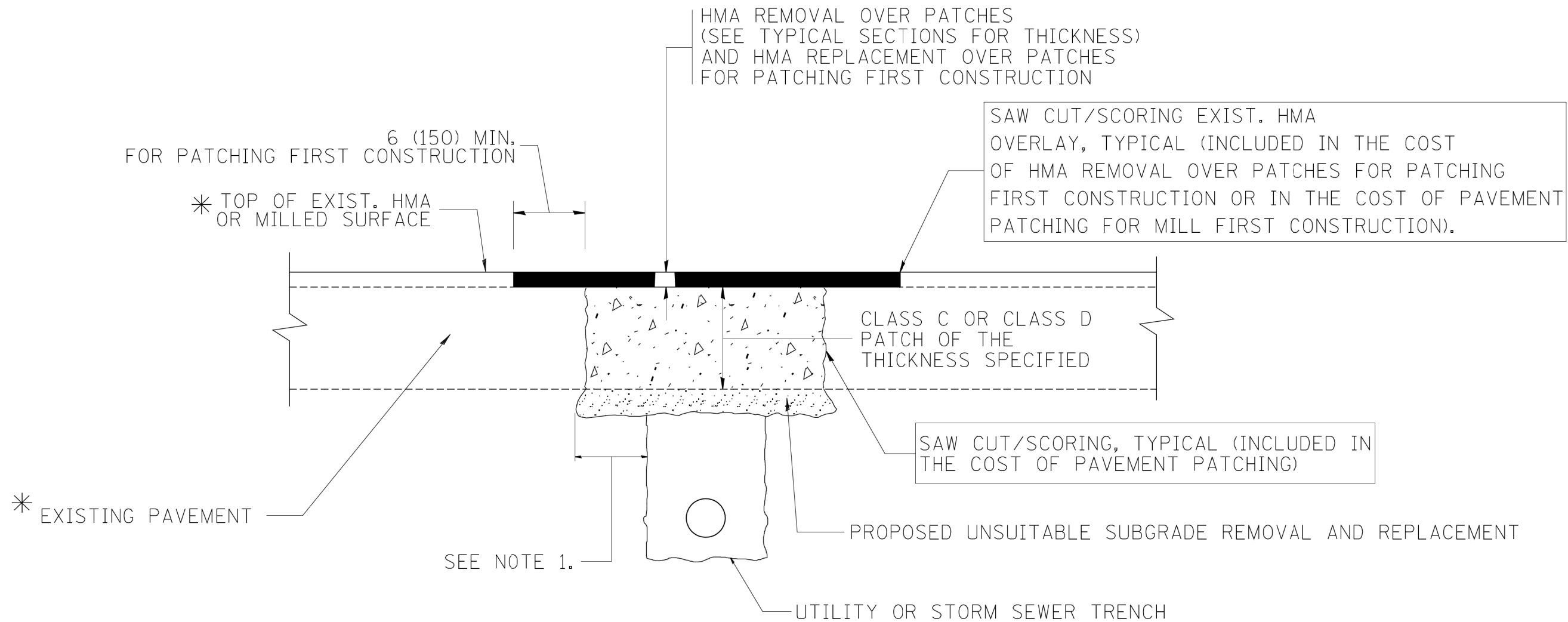

* SEE TYPICAL SECTIONS FOR THICKNESS AND MATERIALS

NOTES:

1. THE WIDTH OF THE FULL DEPTH PATCH OVER A TRENCH SHALL BE 12 (300) WIDER ON EACH SIDE OF THE TRENCH.
2. FOR METHOD OF MEASUREMENT AND BASIS OF PAYMENT, SEE RECURRING SPECIAL PROVISION "PATCHING WITH HOT-MIX ASPHALT OVERLAY REMOVAL".

SEQUENCE OF CONSTRUCTION (PATCHING FIRST)

1. REMOVE THE EXISTING HMA MATERIAL OVER THE AREA TO BE PATCHED.
2. REMOVE AND REPLACE WITH CLASS C OR D PATCH.
3. REPLACE HMA MATERIAL OVER THE AREA TO BE PATCHED.

SEQUENCE OF CONSTRUCTION (MILLING FIRST)

1. MILL HMA FIRST IF THERE IS AT LEAST 4 1/2 INCHES OR MORE OF HMA MATERIAL ON TOP OF THE EXISTING PAVEMENT OR IF THE PAVEMENT IS FULL DEPTH HMA. A MINIMUM OF 2 INCHES OF HMA MATERIAL SHALL BE IN PLACE AFTER MILLING.
2. REMOVE AND REPLACE WITH FULL DEPTH CLASS D PATCHES TO TOP OF MILLED SURFACE.

ALL DIMENSIONS ARE IN INCHES (MILLIMETERS) UNLESS OTHERWISE SHOWN.

FILE NAME = c:\projects\diststd22x34\bd22.dgn	USER NAME = bauerdl	DESIGNED - R. SHAH	REVISED - A. ABBAS 04-27-98	STATE OF ILLINOIS DEPARTMENT OF TRANSPORTATION	PAVEMENT PATCHING FOR HMA SURFACED PAVEMENT			F.A.P. RTE.	SECTION	COUNTY	TOTAL SHEETS	SHEET NO.	
		DRAWN -	REVISED - R. BORO 01-01-07		SCALE: NONE	SHEET NO. 1 OF 1 SHEETS	STA.	TO STA.	344	(45&45X)RS-1	LAKE	28	18
		PLOT SCALE = 50.000' / IN.	REVISED - R. BORO 09-04-07					BD400-04 (BD-22)		CONTRACT NO. 62A07			
		PLOT DATE = 10/27/2008	REVISED - K. ENG 10-27-08		FED. ROAD DIST. NO. 1 ILLINOIS FED. AID PROJECT								

VARIABLE - TO MEET EXISTING DIMENSIONS AND FIELD CONDITIONS (SEE NOTE ②)

PROP. CONC. CURB OR CURB AND GUTTER REPLACEMENT IN ACCORDANCE WITH STATE STANDARD 606001. (SEE NOTE ②)

SAW CUT FULL DEPTH - INCLUDED IN THE COST OF SIDEWALK, DRIVEWAY OR MEDIAN SURFACE REMOVAL PAY ITEM.

SEE STATE STANDARD 606001
EXISTING OR PROPOSED HMA SURFACE (IF APPLICABLE)

18" (450) MAX.

1/4" (5) **

EXISTING SIDEWALK, DRIVEWAY, MEDIAN SURFACE, SOD OR GROUND.

PROPOSED SIDEWALK, DRIVEWAY PAVEMENT, MEDIAN SURFACE OR SODDING SALT TOLERANT WITH TOP SOIL, 4" (100) SOD RESTORATION (SEE NOTE ①).

EXISTING CONCRETE PAVEMENT, CONCRETE BASE COURSE OR FLEXIBLE PAVEMENT

3" (75) MIN.

SUITABLE BACKFILL MATERIAL (INCLUDED IN THE COST OF CURB OR CURB AND GUTTER REMOVAL AND REPLACEMENT)

PROPOSED 3/4" (20) PREFORMED EXPANSION JOINT AT CONCRETE SIDEWALKS, DRIVEWAYS, AND MEDIANS. (INCLUDED IN THE COST OF CURB OR CURB AND GUTTER REMOVAL AND REPLACEMENT.)

- * 3" (75) MINIMUM FROM TOP AND BOTTOM OF THE CONCRETE PAVEMENT OR BASE COURSE.
- ** IF THE FINAL SURFACE OF THE PAVEMENT IS CONCRETE, THE GUTTER IS TO BE FLUSH WITH THE PAVEMENT.

UNSUITABLE SUB-BASE MATERIAL TO BE REMOVED, IF DIRECTED BY THE ENGINEER, SHALL BE REPLACED WITH EITHER SUB-BASE GRANULAR MATERIAL, TYPE B OR ADDITIONAL THICKNESS OF CONCRETE.

NOTE: ① SIDEWALK, DRIVEWAY PAVEMENT OR MEDIAN SURFACE SHALL BE SIMILAR TO THE MATERIAL BEING REMOVED AND WILL BE PAID FOR SEPARATELY.

REMOVAL AND REPLACEMENT 4" (100) OR LESS IS INCLUDED IN THE COST OF CURB OR CURB AND GUTTER REMOVAL AND REPLACEMENT.

SODDING, SALT TOLERANT AND TOP SOIL, FURNISH AND PLACE 4" WILL BE PAID FOR SEPARATELY,

REMOVAL AND REPLACEMENT IN EXCESS OF 4" (100) WILL BE PAID FOR IN ACCORDANCE WITH ARTICLE 109.04 OF THE STANDARD SPECIFICATIONS.

- ② FERTILIZER FOR THE PLACEMENT OF THE SOD IS NOT REQUIRED
- ③ CURB OR CURB AND GUTTER REPLACEMENT SHALL MATCH THE SHAPE OF THE EXISTING CURB OR CURB AND GUTTER UNLESS OTHERWISE SPECIFIED.
- ④ FOR CURB OR CURB AND GUTTER REMOVAL AND REPLACEMENT ADJACENT TO FLEXIBLE PAVEMENT DELETE EPOXY COATED TIE BARS.

PROPOSED #6 (20) EPOXY COATED TIE BARS 24" (600) LONG AT 24" (600) CENTERS WILL NOT BE PAID FOR SEPARATELY. DELETE EPOXY COATED TIE BARS IF EXISTING TIE BARS ARE USUABLE AS DETERMINED BY THE ENGINEER. (SEE NOTE ③).

⑤ LONGITUDINAL BARS, IF ENCOUNTERED IN THE EXISTING CURB OR CURB AND GUTTER, ARE NOT TO BE REPLACED. CUTTING AND REMOVING LONGITUDINAL BARS SHALL BE INCLUDED IN THE COST OF CURB OR CURB AND GUTTER REMOVAL AND REPLACEMENT.

BASIS OF PAYMENT:
THIS WORK WILL BE PAID FOR AT THE CONTRACT UNIT PRICE PER FOOT (METER) FOR "CURB REMOVAL AND REPLACEMENT" OR "COMBINATION CONCRETE CURB AND GUTTER REMOVAL AND REPLACEMENT".

⑥ THE COST OF HMA SURFACE REMOVAL IN THE EXISTING GUTTER FLAG SHALL BE INCLUDED IN THE COST OF THE CURB AND GUTTER REMOVAL AND REPLACEMENT.

⑦ THE REMOVAL AND REPLACEMENT OF THE EXISTING CURB OR CURB AND GUTTER SHALL BE DONE IN ACCORDANCE WITH THE APPLICABLE PORTIONS OF SECTION 440 AND 606 OF THE STANDARD SPECIFICATIONS.

⑧ THE LOCATIONS OF REMOVAL AND REPLACEMENT OF EXISTING CURB OR CURB AND GUTTER SHALL BE DETERMINED BY THE RESIDENT ENGINEER AT THE TIME OF CONSTRUCTION.

CURB OR CURB AND GUTTER REMOVAL AND REPLACEMENT

ALL DIMENSIONS ARE IN INCHES (MILLIMETERS) UNLESS OTHERWISE SHOWN.

FILE NAME =	USER NAME = drivkosgn	DESIGNED - A. HOUSEH	REVISED - R. SHAH 10-03-96	STATE OF ILLINOIS DEPARTMENT OF TRANSPORTATION	CURB OR CURB AND GUTTER REMOVAL AND REPLACEMENT	F.A.P. RTE.	SECTION	COUNTY	TOTAL SHEETS	SHEET NO.
c:\p\work\p\dot\drivkosgn\d0108315\bc24.dgn		DRAWN -	REVISED - A. ABBAS 03-21-97			344	(45&45X)RS-1	LAKE	28	19
PLOT SCALE = 50.000' / IN.	CHECKED -	REVISED - M. GOMEZ 01-22-01				BD600-06 (BD-24)		CONTRACT NO. 62A07		
PLOT DATE = 12/15/2009	DATE - 03-11-94	REVISED - R. BORO 12-15-09				SCALE: NONE	SHEET NO. 1 OF 1 SHEETS	STA.	TO STA.	FED. ROAD DIST. NO. 1 ILLINOIS FED. AID PROJECT

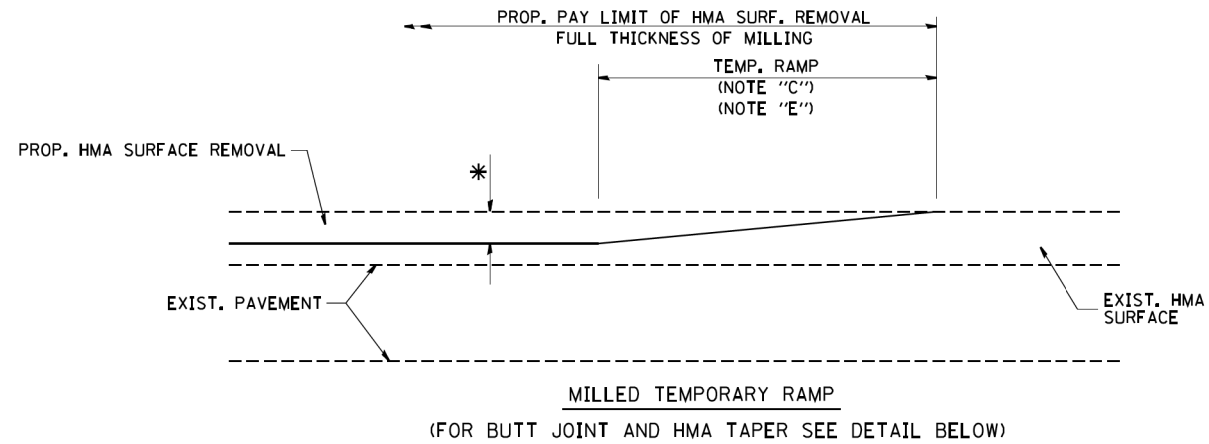

MILLED TEMPORARY RAMP
(FOR BUTT JOINT AND HMA TAPER SEE DETAIL BELOW)

OPTION 1

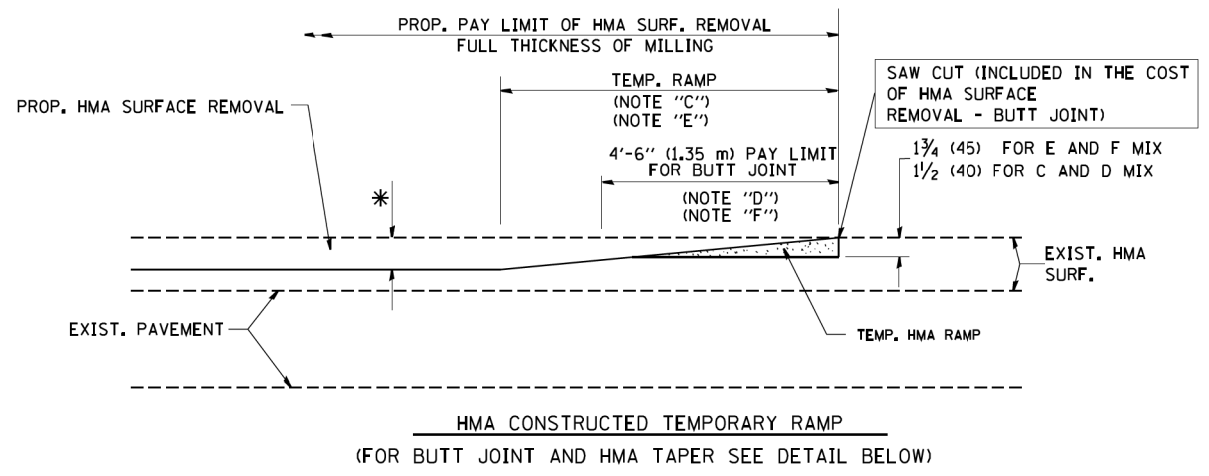

HMA CONSTRUCTED TEMPORARY RAMP
(FOR BUTT JOINT AND HMA TAPER SEE DETAIL BELOW)

OPTION 2
TYPICAL TEMPORARY RAMP

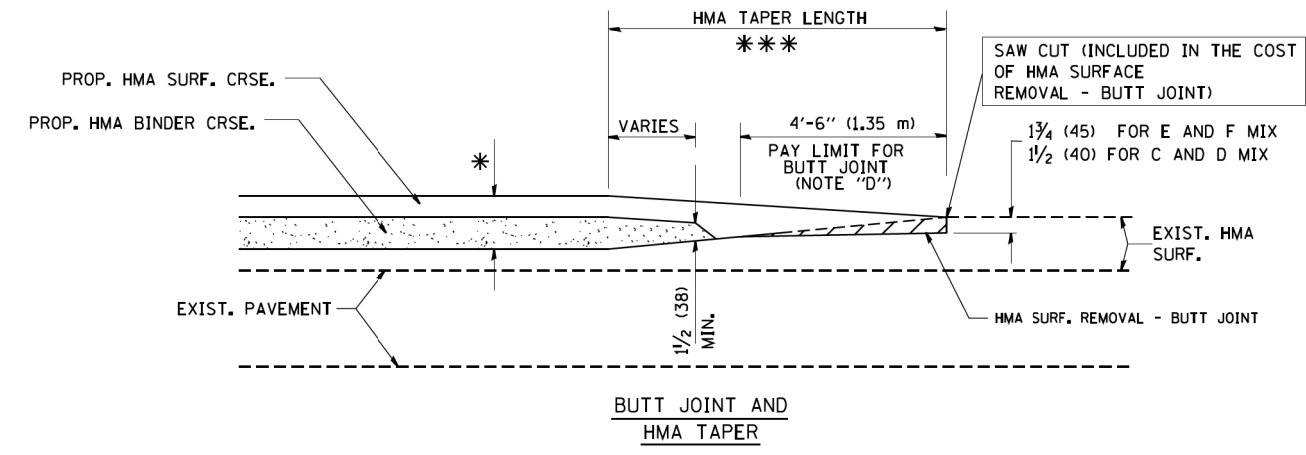

TYPICAL BUTT JOINT AND HMA TAPER
FOR MILLING AND RESURFACING

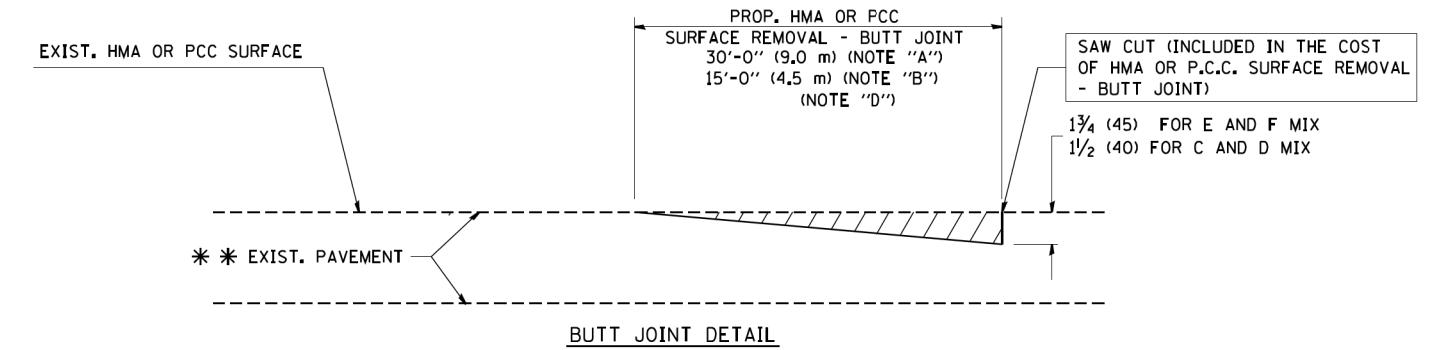

BUTT JOINT DETAIL

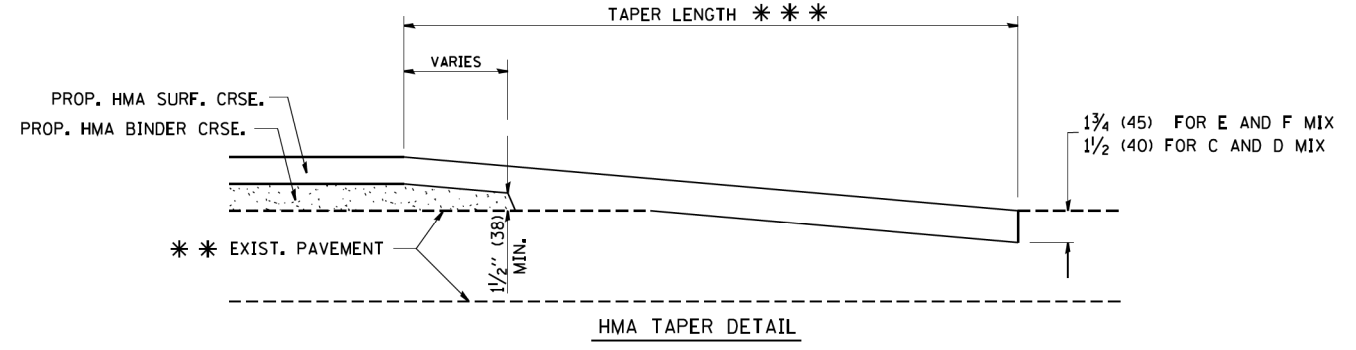

HMA TAPER DETAIL

TYPICAL BUTT JOINT AND HMA TAPER
FOR RESURFACING ONLY

*** PC CONCRETE, HMA OR HMA RESURFACED PAVEMENT.

NOTES

- A: MAINLINE ROADWAYS AND MAJOR SIDE ROADS.
 - B: MINOR SIDE ROADS.
 - C: THE TEMP. RAMP SHALL BE CONSTRUCTED IMMEDIATELY UPON REMOVAL OF THE EXISTING HMA SURFACE.
 - D: THE BUTT JOINT SHALL BE CONSTRUCTED IMMEDIATELY PRIOR TO PLACING THE PROPOSED HMA COURSES.
 - E: TAPER THE TEMP. RAMP AT A RATE OF 3'-0" (900 mm) PER 1 INCH (25 mm) OF MILLING THICKNESS.
 - F: INSTALLATION AND REMOVAL OF THE 4'-6" (1.35 m) TEMP. RAMP IS INCLUDED IN COST OF HMA SURFACE REMOVAL - BUTT JOINT
 - G: SEE ARTICLE 406.08 AND 406.14 OF THE STANDARD SPECIFICATIONS FOR "HMA AND/OR PCC SURFACE REMOVAL, BUTT JOINT".
- * SEE TYPICAL SECTIONS FOR MILLING THICKNESS.
- *** 20'-0" (6.1 m) PER 1 (25) RESURFACING (NOTE "A")
10'-0" (3.0 m) PER 1 (25) RESURFACING (NOTE "B")

BASIS OF PAYMENT:

THE BUTT JOINT WILL BE PAID FOR AT THE CONTRACT UNIT PRICE PER SQUARE YARD (SQUARE METER) FOR "HOT-MIX ASPHALT SURFACE REMOVAL - BUTT JOINT" OR FOR "PORTLAND CEMENT CONCRETE SURFACE REMOVAL - BUTT JOINT".

ALL DIMENSIONS ARE IN INCHES (MILLIMETERS) UNLESS OTHERWISE SHOWN.

FILE NAME = W:\distata\22x34\bd32.dgn	USER NAME = gegl1enobt	DESIGNED - M. DE YONG	REVISED - R. SHAH 10-25-94
		DRAWN -	REVISED - A. ABBAS 03-21-97
	PLOT SCALE = 50.0000' / IN.	CHECKED -	REVISED - M. GOMEZ 04-06-01
	PLOT DATE = 1/4/2008	DATE - 06-13-90	REVISED - R. BORO 01-01-07

STATE OF ILLINOIS
DEPARTMENT OF TRANSPORTATION

BUTT JOINT AND
HMA TAPER DETAILS

SCALE: NONE SHEET NO. 1 OF 1 SHEETS STA. TO STA.

F.A.P. RTE.	SECTION	COUNTY	TOTAL SHEETS	SHEET NO.
344	(45&45X)RS-1	LAKE	28	20
BD400-05 BD32		CONTRACT NO. 62A07		
FED. ROAD DIST. NO. 1 ILLINOIS FED. AID PROJECT				

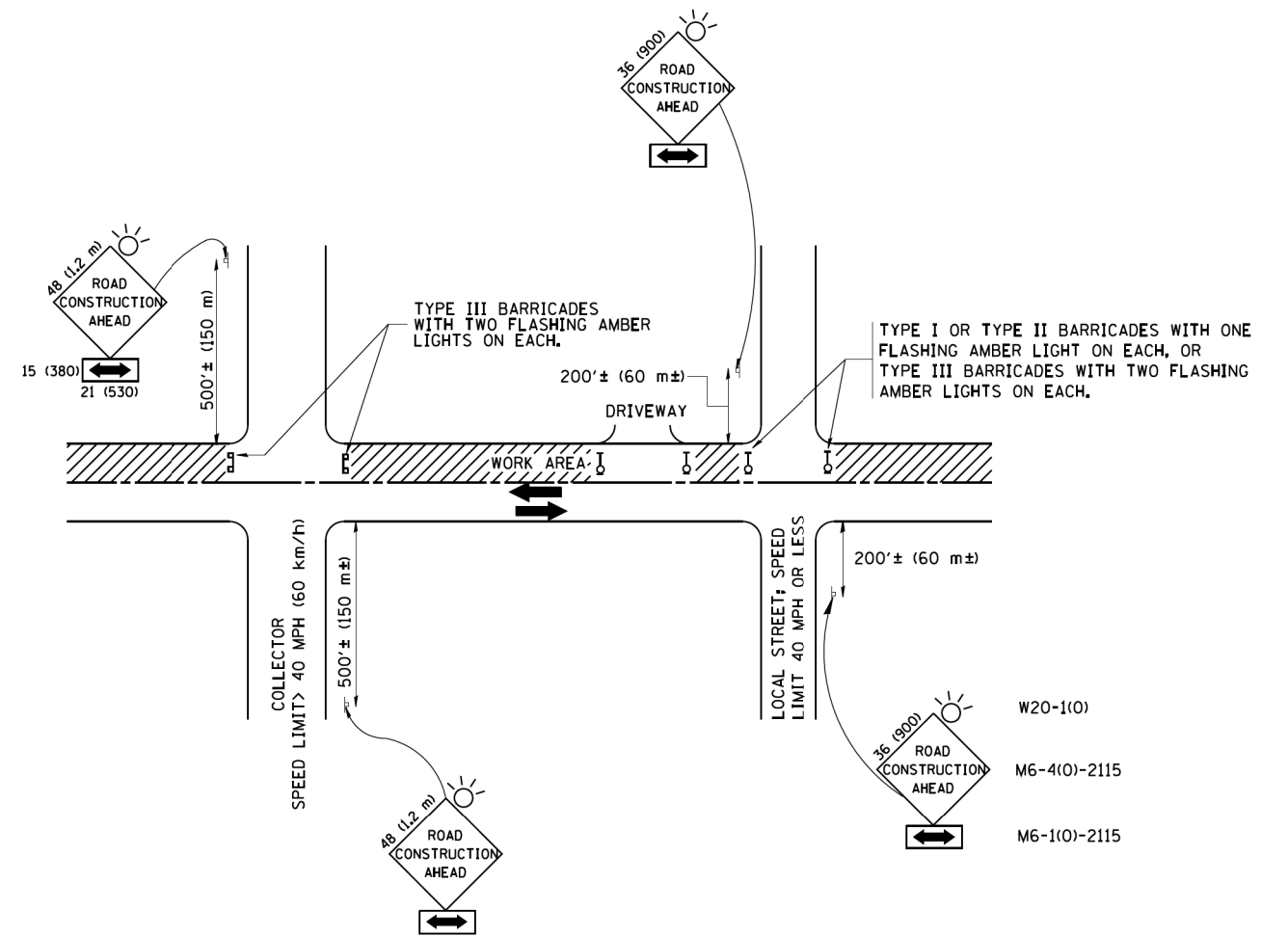

TRAFFIC CONTROL AND PROTECTION FOR SIDE ROADS, INTERSECTIONS, AND DRIVEWAYS

NOTES:

A. FOR NO LANE RESTRICTION ON THE SIDE ROAD OR DRIVEWAYS

1. SIDE ROAD WITH A SPEED LIMIT OF 40 MPH (60 km/h) OR LESS AS SHOWN ON THE DRAWING AND AS DIRECTED BY THE ENGINEER:

a) ONE ROAD CONSTRUCTION AHEAD SIGN 36 x 36 (900x900) WITH A FLASHER AND FLAG MOUNTED ON IT APPROXIMATELY 200' (60 m) IN ADVANCE OF THE MAIN ROUTE.

b) THE CLOSED PORTION OF THE MAIN ROUTE SHALL BE PROTECTED BY BLOCKING WITH TYPE I, TYPE II OR TYPE III BARRICADES, 1/3 OF THE CROSS SECTION OF THE CLOSED PORTION.

2. SIDE ROAD WITH A SPEED LIMIT GREATER THAN 40 MPH (60 km/h) AS SHOWN ON THE DRAWING AND AS DIRECTED BY THE ENGINEER:

a) ONE ROAD CONSTRUCTION AHEAD SIGN 48 x 48 (1.2 m x 1.2 m) WITH A FLASHER MOUNTED ON IT APPROXIMATELY 500' (150 m) IN ADVANCE OF THE MAIN ROUTE.

b) THE CLOSED PORTION OF THE MAIN ROUTE SHALL BE PROTECTED BY BLOCKING WITH TYPE III BARRICADES, 1/2 OF THE CROSS SECTION OF THE CLOSED PORTION.

3. WHEN THE SIDE ROAD LIES BETWEEN THE BEGINNING OF THE MAINLINE SIGNING AND THE WORK ZONE, A SINGLE HEADED ARROW (M6-1) SHALL BE USED IN LIEU OF THE DOUBLE HEADED ARROW (M6-4).

B. FOR A LANE CLOSURE ON A SIDE ROAD OR DRIVEWAY:

USE APPLICABLE PORTIONS OF THE TYPICAL APPLICATION OF TRAFFIC CONTROL DEVICES (STD. 701501, STD. 701606 OR THE APPROPRIATE STANDARD). THE SPACING OF SIGNS AND BARRICADES SHALL BE ADJUSTED FOR FIELD CONDITIONS AS DIRECTED BY THE ENGINEER. THE DIRECTIONAL ARROW SHALL BE COVERED OR REMOVED WHEN NO LONGER CONSISTENT WITH THE SIDE ROAD LANE CLOSURE.

C. ADVANCE WARNING SIGNS ARE TO BE OMITTED ON DRIVEWAY UNLESS OTHERWISE NOTED.

D. THE TRAFFIC CONTROL AND PROTECTION FOR SIDE ROADS, INTERSECTIONS, AND DRIVEWAYS SHALL BE INCIDENTAL TO THE COST OF SPECIFIED TRAFFIC CONTROL STANDARDS OR ITEMS.

All dimensions are in millimeters (inches) unless otherwise shown.

FILE NAME =	USER NAME = gegl1enobt	DESIGNED - LHA	REVISED - J. OBERLE 10-18-95
W:\diststd\22x34\1010.dgn		DRAWN -	REVISED - A. HOUSEH 03-06-96
	PLOT SCALE = 50.000' / IN.	CHECKED -	REVISED - A. HOUSEH 10-15-96
	PLOT DATE = 1/4/2008	DATE - 06-89	REVISED - T. RAMMACH 01-06-00

STATE OF ILLINOIS
DEPARTMENT OF TRANSPORTATION

TRAFFIC CONTROL AND PROTECTION FOR
SIDE ROADS, INTERSECTIONS, AND DRIVEWAYS

SCALE: NONE SHEET NO. 1 OF 1 SHEETS STA. TO STA.

F.A.P. RTE.	SECTION	COUNTY	TOTAL SHEETS	SHEET NO.
344	(45&45X)RS-1	LAKE	28	21
TC-10			CONTRACT NO. 62A07	
FED. ROAD DIST. NO. 1 ILLINOIS FED. AID PROJECT				

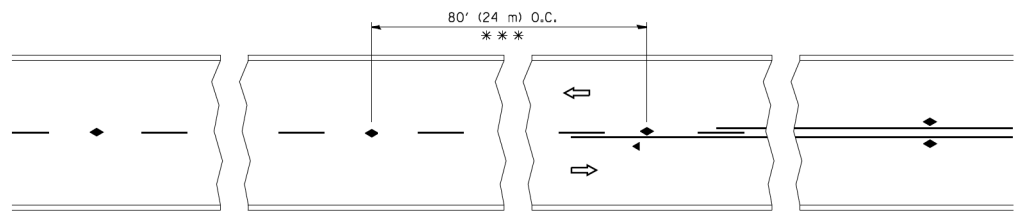

*** REDUCE TO 40' (12 m) O.C. ON CURVES WITH POSTED OR ADVISORY SPEED 45 M.P.H. (70 km/h) OR LESS.

TWO-LANE/TWO-WAY

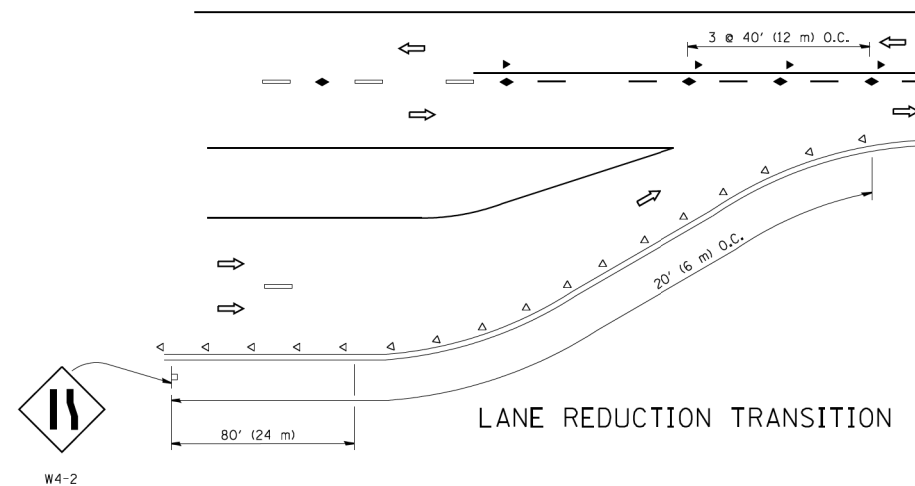

LANE REDUCTION TRANSITION

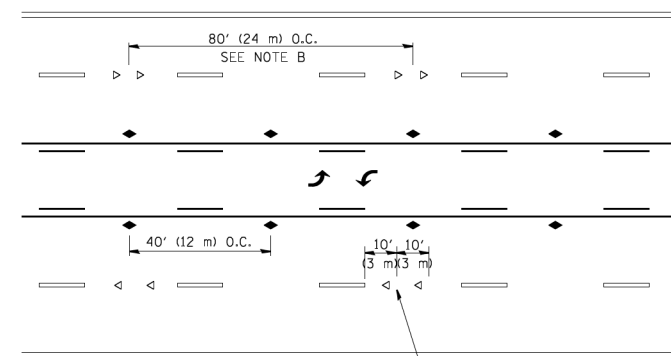

TWO-WAY LEFT TURN

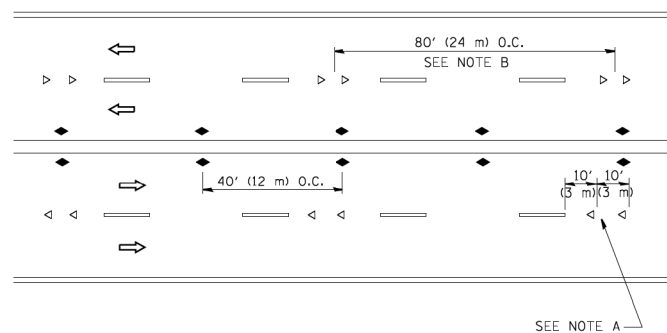

MULTI-LANE/UNDIVIDED

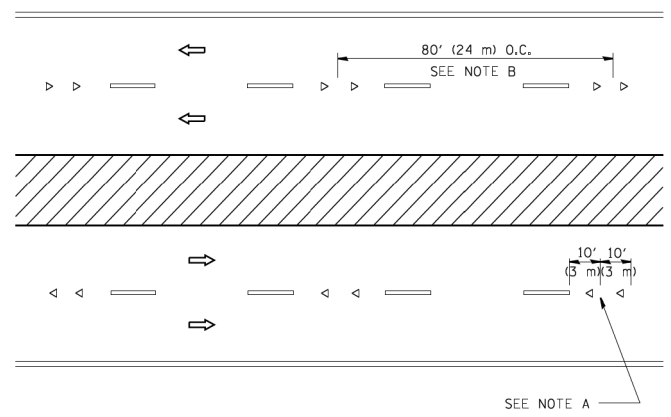

MULTI-LANE/DIVIDED

GENERAL NOTES

1. MARKERS USED WITH DASHED LINES SHALL BE CENTERED IN THE GAP BETWEEN SEGMENTS.
2. MARKERS USED ADJACENT TO SOLID LINES SHALL BE OFFSET 2 TO 3 (50 TO 75) TOWARD TRAFFIC AS SHOWN.
3. MARKERS THROUGH TANGENTS LESS THAN 500' (150 m) IN LENGTH BETWEEN CURVES SHALL BE INSTALLED AT THE LESSER OF THE TWO CURVE SPACINGS.

SYMBOLS

- YELLOW STRIPE
- WHITE STRIPE
- ◀ ONE-WAY AMBER MARKER
- ◁ ONE-WAY CRYSTAL MARKER (W/O)
- ◆ TWO-WAY AMBER MARKER

LANE MARKER NOTES

- A. USE DOUBLE LANE LINE MARKERS SPACED AS SHOWN.
- B. REDUCE TO 40' (12 m) O.C. ON CURVES WHERE ADVISORY SPEEDS ARE 10 M.P.H (20 km/h) LOWER THAN POSTED SPEEDS.

DESIGN NOTES

1. DOUBLE LANE LINE MARKERS SHALL BE USED UNLESS SPECIFIED OTHERWISE.
2. EXCEPT AS SHOWN ON THE LANE REDUCTION TRANSITION AND FREEWAY EXIT RAMP DETAIL, MARKERS ARE NOT TO BE SPECIFIED ON RIGHT EDGE LINES.
3. THE EXACT MARKER LIMITS, SPACING, AND COLOR SHALL BE INCLUDED IN THE PLANS WHEN STANDARD SPECIFICATIONS ARE NOT BEING USED.
4. MARKERS SHOULD NOT BE USED ALONGSIDE CURBS EXCEPT FOR EXTREMELY SHORT SECTIONS OF CURBS WHERE NOT MORE THAN TWO MARKERS WOULD BE INVOLVED.

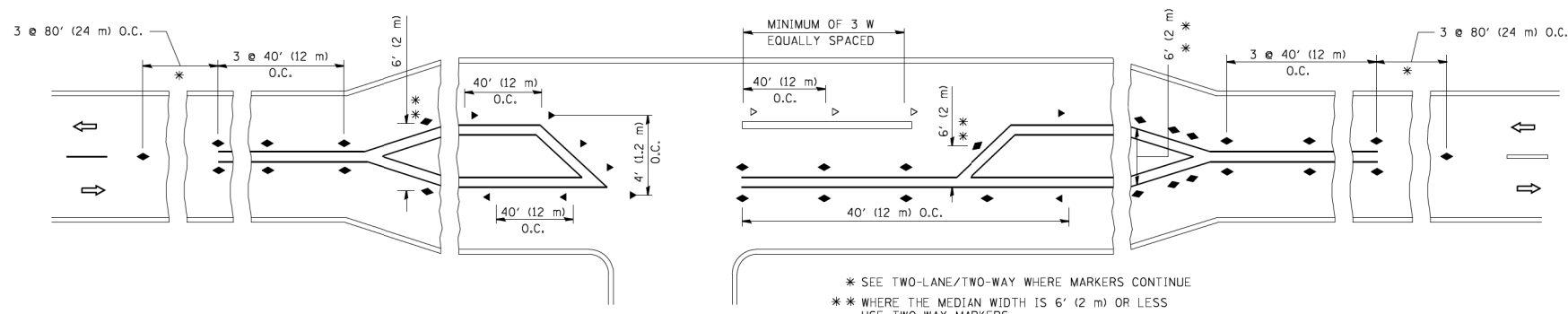

LEFT TURN

* SEE TWO-LANE/TWO-WAY WHERE MARKERS CONTINUE
 ** WHERE THE MEDIAN WIDTH IS 6' (2 m) OR LESS USE TWO-WAY MARKERS.

All dimensions are in inches (millimeters) unless otherwise shown.

FILE NAME =	USER NAME = lveys	DESIGNED -	REVISED - T. RAMMACHER 09-19-94	STATE OF ILLINOIS DEPARTMENT OF TRANSPORTATION	TYPICAL APPLICATIONS RAISED REFLECTIVE PAVEMENT MARKERS (SNOW-PLOW RESISTANT)			F.A.P. RTE. 344	SECTION (45&45X)RS-1	COUNTY LAKE	TOTAL SHEETS 28	SHEET NO. 22
ca:\pki\work\pki\dot\lveys\d0108315\tcl1.dgn		DRAWN -	REVISED - T. RAMMACHER 03-12-99		SCALE: NONE	SHEET NO. 1 OF 1 SHEETS	STA. TO STA.	TC-11		CONTRACT NO. 62A07		
		PLOT SCALE = 50.000' / IN.	REVISED - T. RAMMACHER 01-06-00		FED. ROAD DIST. NO. 1 ILLINOIS FED. AID PROJECT							
		PLOT DATE = 3/2/2011	REVISED - C. JUCIUS 09-09-09									

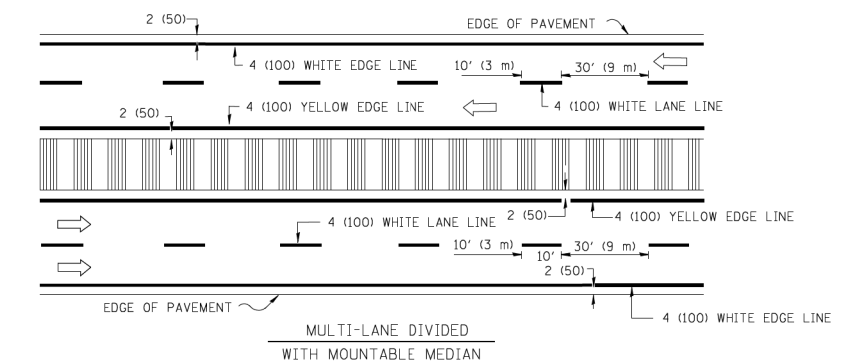
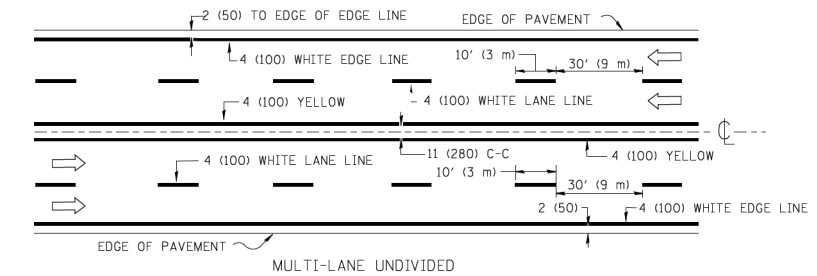
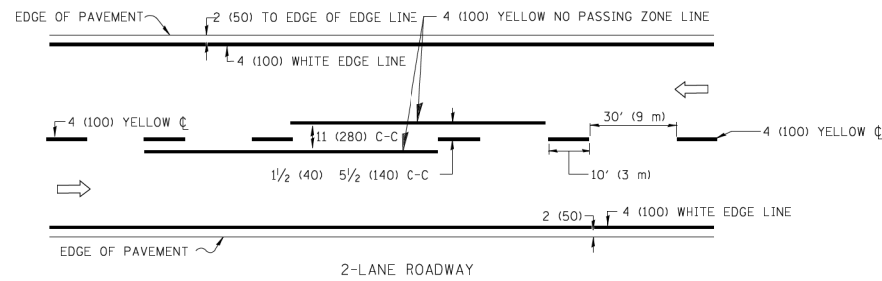

NOTE: MEDIANS WITH BARRIER CURB DO NOT REQUIRE AN EDGE LINE

TYPICAL LANE AND EDGE LINE MARKING

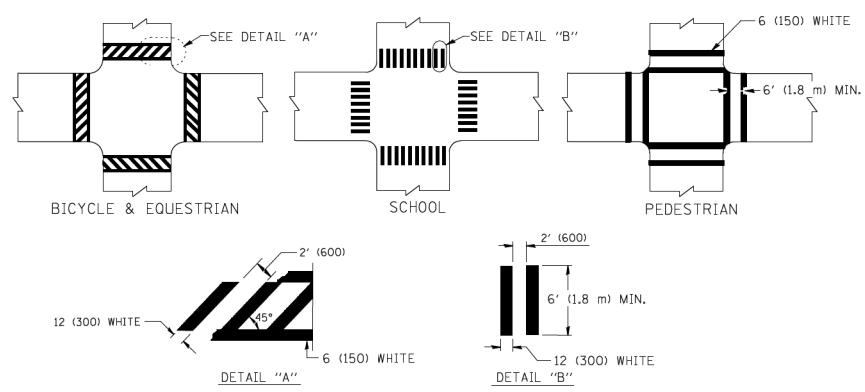

TYPICAL CROSSWALK MARKING

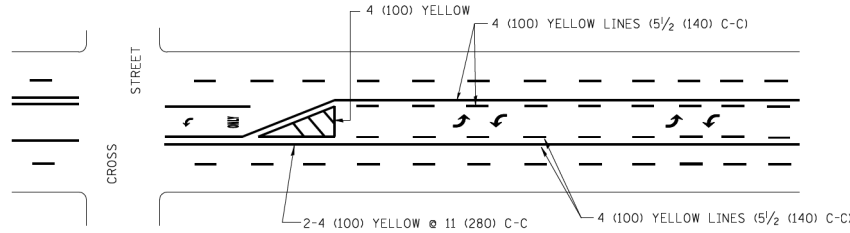
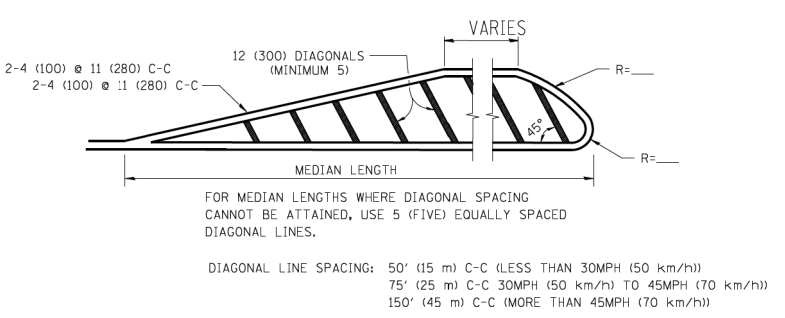
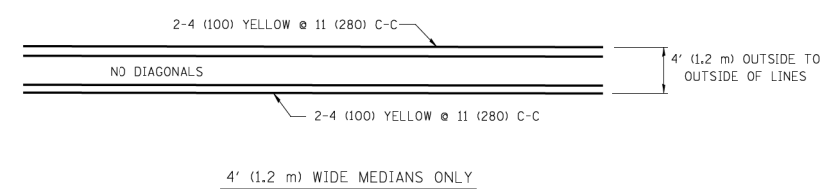

A MINIMUM OF TWO PAIRS OF TURN ARROWS SHALL BE USED, WHITE IN COLOR. ADDITIONAL PAIRS SHALL BE PLACED AT 200' (60 m) TO 300' (90 m) INTERVALS.

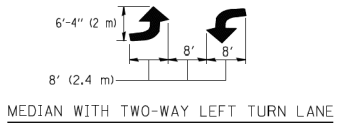

TYPICAL PAINTED MEDIAN MARKING

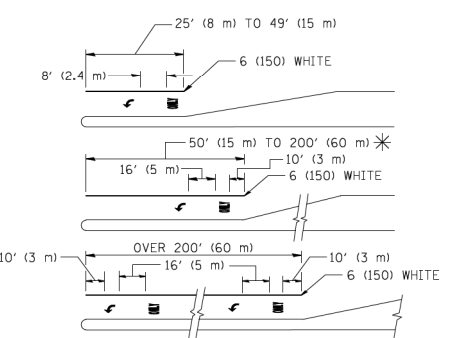

FULL SIZE LETTERS 8' (2.4 m) AND ARROWS SHALL BE USED. AREA = 15.6 SQ. FT. (1.5 m²) ONLY AREA = 20.8 SQ. FT. (1.9 m²)
 * TURN LANES IN EXCESS OF 400' (120 m) IN LENGTH MAY HAVE AN ADDITIONAL SET OF ARROW - "ONLY" INSTALLED MIDWAY BETWEEN THE OTHER TWO SETS OF ARROW - "ONLY".

TYPICAL LEFT (OR RIGHT) TURN LANE

TYPICAL TURN LANE MARKING

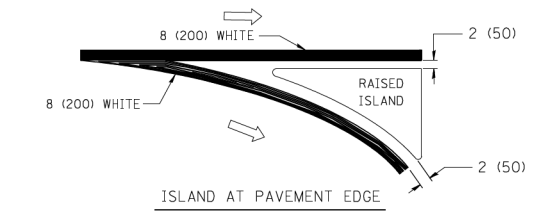
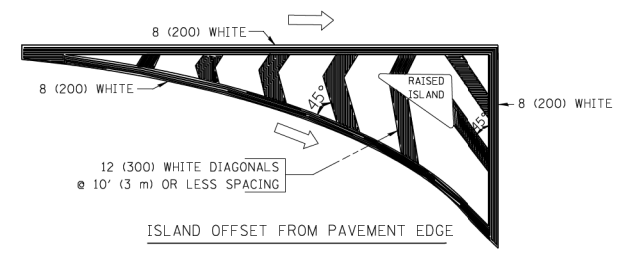

TYPICAL ISLAND MARKING

TYPE OF MARKING	WIDTH OF LINE	PATTERN	COLOR	SPACING / REMARKS
CENTERLINE ON 2 LANE PAVEMENT	4 (100)	SKIP-DASH	YELLOW	10' (3 m) LINE WITH 30' (9 m) SPACE
CENTERLINE ON MULTI-LANE UNDIVIDED PAVEMENT	2 @ 4 (100)	SOLID	YELLOW	11 (280) C-C
NO PASSING ZONE LINES FOR ONE DIRECTION FOR BOTH DIRECTIONS	4 (100) 2 @ 4 (100)	SOLID SOLID	YELLOW YELLOW	5/2 (140) C-C FROM SKIP-DASH CENTERLINE 11 (280) C-C OMIT SKIP DASH CENTERLINE BETWEEN
LANE LINES	4 (100) 5 (125) ON FREEWAYS	SKIP-DASH SKIP-DASH	WHITE WHITE	10' (3 m) LINE WITH 30' (9 m) SPACE
DOTTED LINES (EXTENSIONS OF CENTER, LANE OR TURN LANE MARKINGS)	SAME AS LINE BEING EXTENDED	SKIP-DASH	SAME AS LINE BEING EXTENDED	2' (600) LINE WITH 6' (1.8 m) SPACE
EDGE LINES	4 (100)	SOLID	YELLOW-LEFT WHITE-RIGHT	OUTLINE MOUNTABLE MEDIANS IN YELLOW; EDGE LINES ARE NOT USED NEXT TO BARRIER CURB
TURN LANE MARKINGS	6 (150) LINE; FULL SIZE LETTERS & SYMBOLS (8' (2.4m))	SOLID	WHITE	SEE TYPICAL TURN LANE MARKING DETAIL
TWO WAY LEFT TURN MARKING	2 @ 4 (100) EACH DIRECTION 8' (2.4m) LEFT ARROW	SKIP-DASH AND SOLID IN PAIRS	YELLOW WHITE	10' (3 m) LINE WITH 30' (9 m) SPACE FOR SKIP-DASH; 5/2 (140) C-C BETWEEN SOLID LINE AND SKIP-DASH LINE SEE TYPICAL TWO-WAY LEFT TURN MARKING DETAIL
CROSSWALK LINES (PEDESTRIAN) A. DIAGONALS (BIKE & EQUESTRIAN) B. LONGITUDINAL BARS (SCHOOL)	2 @ 6 (150) 12 (300) @ 45° 12 (300) @ 90°	SOLID SOLID SOLID	WHITE WHITE WHITE	NOT LESS THAN 6' (1.8 m) APART 2' (600) APART 2' (600) APART SEE TYPICAL CROSSWALK MARKING DETAILS.
STOP LINES	24 (600)	SOLID	WHITE	PLACE 4' (1.2 m) IN ADVANCE OF AND PARALLEL TO CROSSWALK, IF PRESENT. OTHERWISE, PLACE AT DESIRED STOPPING POINT. PARALLEL TO CROSSROAD CENTERLINE, WHERE POSSIBLE
PAINTED MEDIANS	2 @ 4 (100) WITH 12 (300) DIAGONALS @ 45° NO DIAGONALS USED FOR 4' (1.2 m) WIDE MEDIANS	SOLID	YELLOW: TWO WAY TRAFFIC WHITE: ONE WAY TRAFFIC	11 (280) C-C FOR THE DOUBLE LINE SEE TYPICAL PAINTED MEDIAN MARKING.
GORE MARKING AND CHANNELIZING LINES	8 (200) WITH 12 (300) DIAGONALS @ 45°	SOLID	WHITE	DIAGONALS: 15' (4.5 m) C-C (LESS THAN 30MPH (50 km/h)) 20' (6 m) C-C 30MPH (50 km/h) TO 45MPH (70 km/h) 30' (9 m) C-C (OVER 45MPH (70 km/h))
RAILROAD CROSSING	24 (600) TRANSVERSE LINES; "RR" IS 6' (1.8 m) LETTERS; 16 (400) LINE FOR "X"	SOLID	WHITE	SEE STATE STANDARD 780001 AREA OF: "R"=3.6 SQ. FT. (0.33 m ²) EACH "X"=54.0 SQ. FT. (5.0 m ²)
SHOULDER DIAGONALS	12 (300) @ 45°	SOLID	WHITE - RIGHT YELLOW - LEFT	50' (15 m) C-C (LESS THAN 30MPH (50 km/h)) 75' (25 m) C-C (30 MPH (50 km/h) TO 45MPH (70 km/h)) 150' (45 m) C-C (OVER 45MPH (70 km/h))

FOR FURTHER DETAILS ON PAVEMENT MARKING REFER TO STANDARD SPECIFICATIONS FOR ROAD AND BRIDGE CONSTRUCTION AND STATE STANDARD 780001.

All dimensions are in inches (millimeters) unless otherwise shown.

FILE NAME = c:\pki\work\pki\dot\drivakosgn\d0108315\to3.dgn	USER NAME = drivakosgn	DESIGNED - EVERS	REVISED -T. RAMMACHER 10-27-94
		DRAWN -	REVISED -C. JUCIUS 09-09-09
	PLOT SCALE = 50.000' / IN.	CHECKED -	REVISED -
	PLOT DATE = 9/9/2009	DATE - 03-19-90	REVISED -

**STATE OF ILLINOIS
DEPARTMENT OF TRANSPORTATION**

DISTRICT ONE		F.A.P. RTE.	SECTION	COUNTY	TOTAL SHEETS	SHEET NO.
TYPICAL PAVEMENT MARKINGS		344	(45&45X)RS-1	LAKE	28	23
SCALE: NONE		SHEET NO. 1 OF 1 SHEETS		STA. TO STA.	CONTRACT NO. 62A07	
		FED. ROAD DIST. NO. 1 ILLINOIS		FED. AID PROJECT		

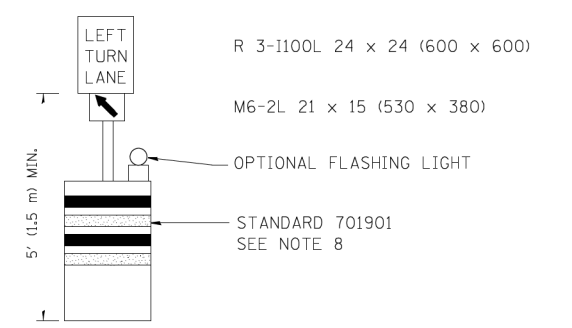
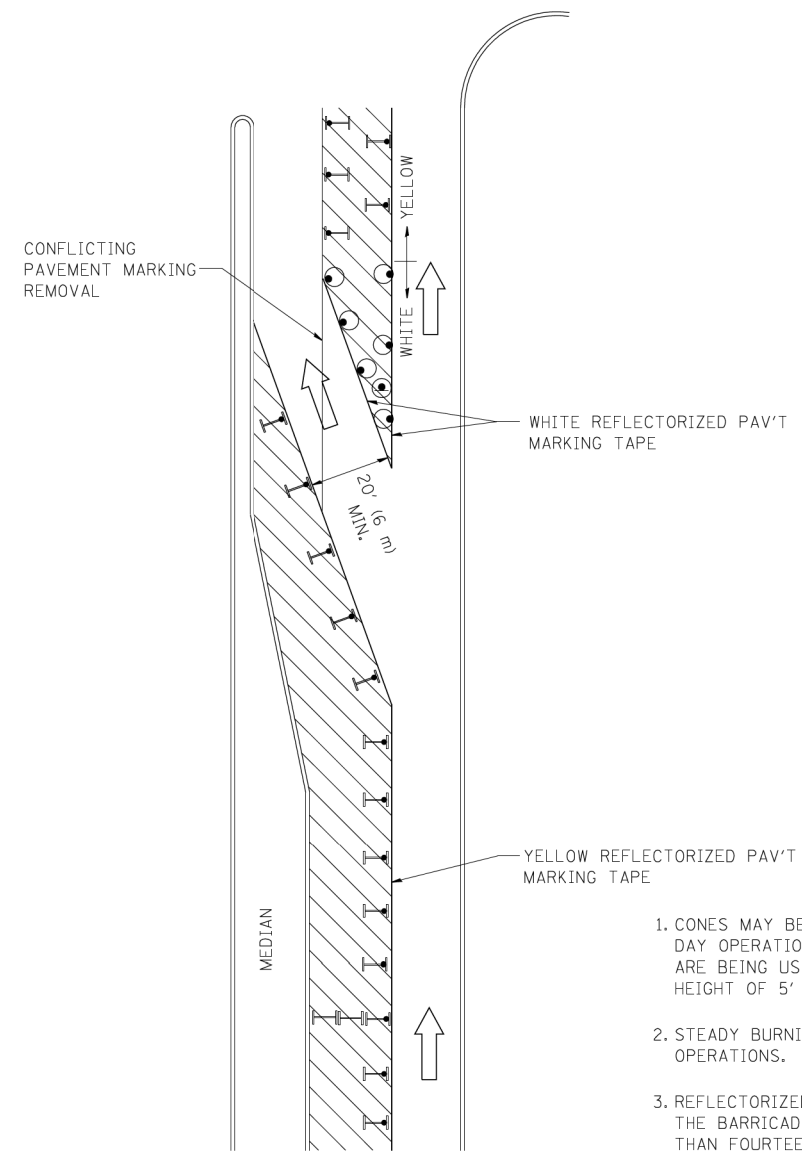





GENERAL NOTES

1. CONES MAY BE SUBSTITUTED FOR BARRICADES OR DRUMS AT HALF THE SPACING DURING DAY OPERATIONS. CONES SHALL BE A MINIMUM OF 28 (710) IN HEIGHT. WHEN CONES ARE BEING USED, THE "LEFT TURN LANE" SIGN MAY BE SKID MOUNTED AT A MINIMUM HEIGHT OF 5' (1.5 m).
2. STEADY BURNING LIGHTS WILL NOT BE REQUIRED ON BARRICADES OR DRUMS FOR DAY OPERATIONS. ALL LIGHTS SHALL BE MONODIRECTIONAL.
3. REFLECTORIZED TEMPORARY PAVEMENT MARKING TAPE SHALL BE PLACED THROUGHOUT THE BARRICADED AREA OF EACH TURN BAY WHERE THE CLOSURE TIME IS GREATER THAN FOURTEEN DAYS.
4. THIS APPLICATION ALSO APPLIES WHEN WORK IS BEING PERFORMED IN THE RIGHT LANE(S) AND THE RIGHT TURN BAY IS TO REMAIN OPEN. UNDER THIS CONDITION, "RIGHT TURN LANE" R3-100 24 x 24 (600 x 600) AND M6-2R 21 x 15 (530 x 380) SHALL BE USED.
5. THESE CONTROLS SHALL SUPPLEMENT MAINLINE TRAFFIC CONTROL FOR LANE CLOSURES.
6. LONGITUDINAL DIMENSIONS MAY BE ADJUSTED TO FIT FIELD CONDITIONS.
7. FORM OPER 725 IS REQUIRED.
8. IF A DRUM OR TYPE II BARRICADE WITH AN ATTACHED SIGN PANEL WHICH MEETS NCHRP 350 REQUIREMENTS IS NOT AVAILABLE, THE SIGNS SHALL BE MOUNTED, ABOVE THE BARRICADES, ON SEPARATE SIGNS SUPPORTS THAT MEET NCHRP 350 PREQUIREMENTS.
9. TRAFFIC CONTROL AND PROTECTION AT TURN BAYS (TO REMAIN OPEN TO TRAFFIC) SHALL BE INCLUDED IN THE COST SPECIFIED TRAFFIC CONTROL STANDARDS OR ITEMS.

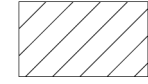
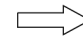
All dimensions are in inches (millimeters) unless otherwise shown.

LEGEND

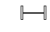
-  WORK AREA
-  LANE OPEN TO TRAFFIC
-  TYPE I OR II BARRICADE WITH STEADY BURN LIGHT
-  DRUM WITH STEADY BURN LIGHT
-  DRUM WITH SIGN (WITH OPTIONAL FLASHING LIGHT) SEE DETAIL
-  TYPE I OR II CHECK BARRICADE WITH FLASHING LIGHT

FILE NAME =	USER NAME = drivakosgn	REVISED -T. RAMMACHER 09-08-94	REVISED - R. BORO 09-14-09
c:\p\work\PWIDOT\DRIVAKOSGN\d0108315\td14.dgn		REVISED - A. HOUSEH 11-07-95	REVISED -
		REVISED - A. HOUSEH 10-12-96	REVISED -
		REVISED -T. RAMMACHER 01-06-00	REVISED -

**STATE OF ILLINOIS
DEPARTMENT OF TRANSPORTATION**

**TRAFFIC CONTROL AND PROTECTION AT TURN BAYS
(TO REMAIN OPEN TO TRAFFIC)**

SCALE: NONE SHEET NO. 1 OF 1 SHEETS STA. TO STA.

F.A.P. RTE.	SECTION	COUNTY	TOTAL SHEETS	SHEET NO.
344	(45&45X)RS-1	LAKE	28	24
TC-14		CONTRACT NO. 62A07		
FED. ROAD DIST. NO. 1 ILLINOIS FED. AID PROJECT				

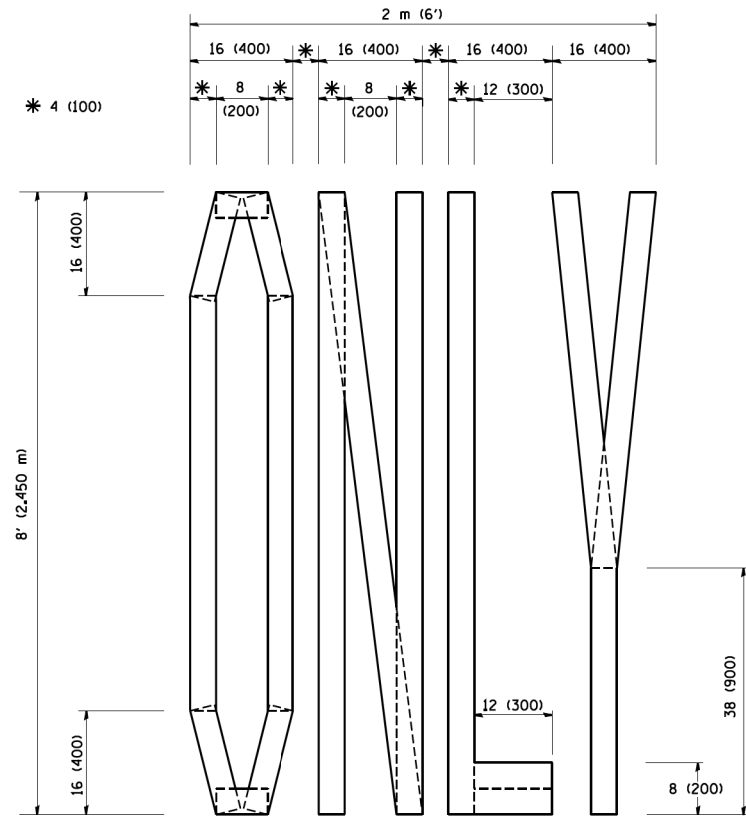

QUANTITY
 4 (100) LINE = 64.1 ft. (19.7 m)
 21.1 sq. ft. (1.97 sq. m)

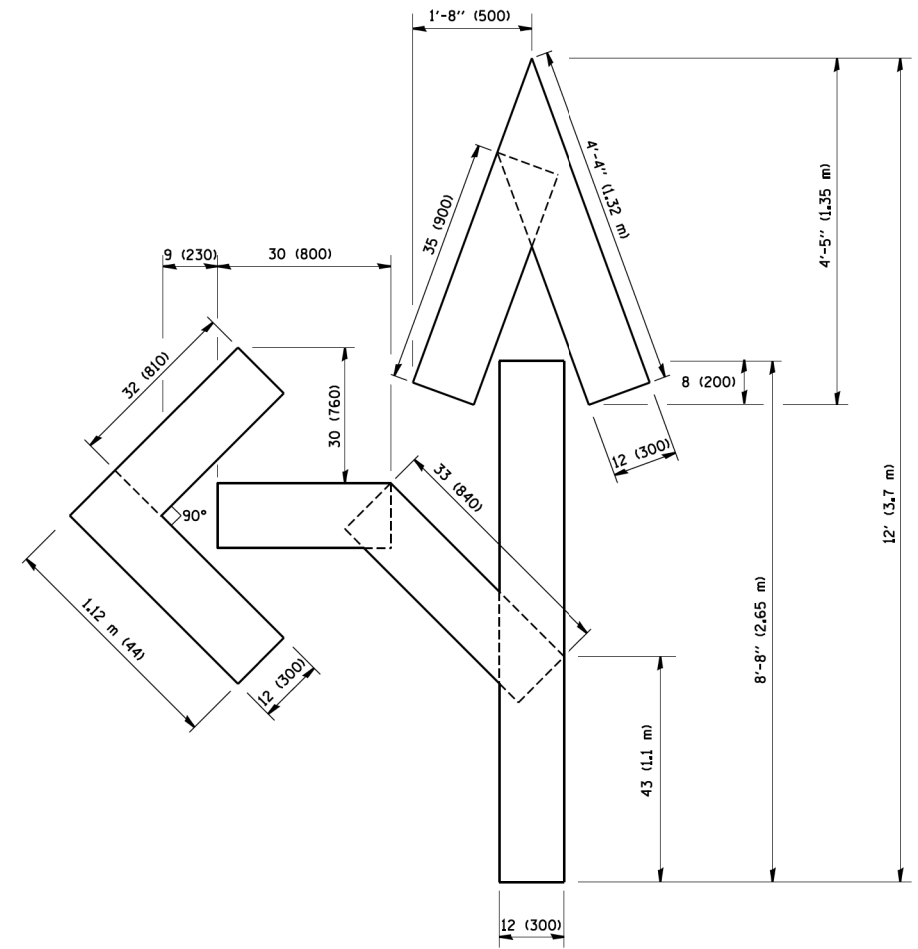

QUANTITY
 4 (100) LINE = 82.5 ft. (25.3 m)
 27.5 sq. ft. (2.53 sq. m)

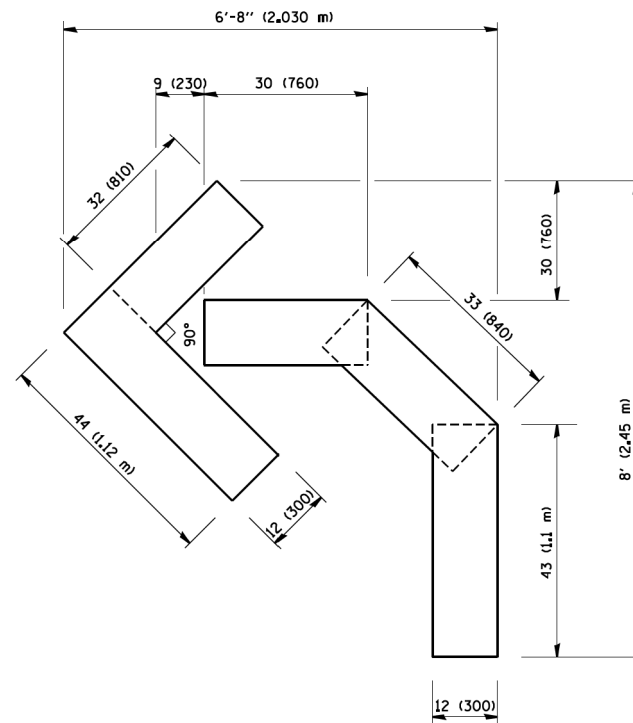

QUANTITY
 4 (100) LINE = 45.5 ft. (13.9 m)
 15.2 sq. ft. (1.39 sq. m)

All dimensions are in inches (millimeters) unless otherwise shown.

FILE NAME = W:\diststd\22x34\tel6.dgn	USER NAME = geglennobt	DESIGNED -	REVISED -T. RAMMACHER 06-05-96
		DRAWN -	REVISED -T. RAMMACHER 11-04-97
	PLOT SCALE = 50.0000' / IN.	CHECKED -	REVISED -T. RAMMACHER 03-02-98
	PLOT DATE = 1/4/2008	DATE - 09-18-94	REVISED -E. GOMEZ 08-28-00

STATE OF ILLINOIS
 DEPARTMENT OF TRANSPORTATION

PAVEMENT MARKING LETTERS AND SYMBOLS
 FOR TRAFFIC STAGING

SCALE: NONE SHEET NO. 1 OF 1 SHEETS STA. TO STA.

F.A.P. RTE.	SECTION	COUNTY	TOTAL SHEETS	SHEET NO.
344	(45&45X)RS-1	LAKE	28	25
TC-16		CONTRACT NO. 62A07		
FED. ROAD DIST. NO. 1 ILLINOIS FED. AID PROJECT				

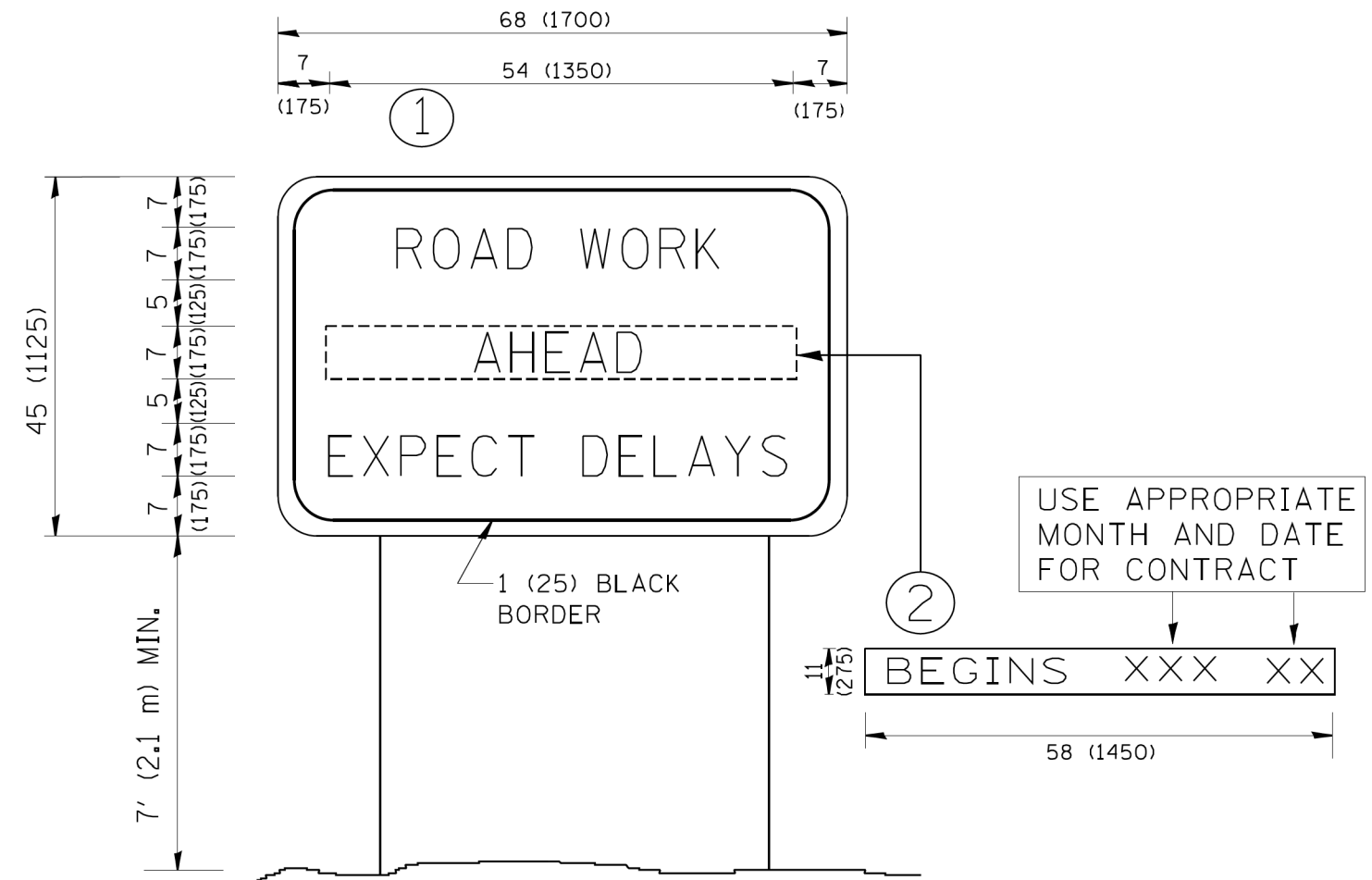

NOTES:

1. USE BLACK LETTERING ON ORANGE BACKGROUND.
2. ERECT SIGNS IN ADVANCE OF THE LOCATION FOR THE "ROAD CONSTRUCTION AHEAD" SIGN AT LOCATIONS AS DIRECTED BY THE ENGINEER.
3. ERECT SIGN ① WITH INSTALLED PANEL ② ONE WEEK PRIOR TO THE START OF CONSTRUCTION.
4. REMOVE PANEL ② SOON AFTER THE START OF CONSTRUCTION.
5. SEE SPECIAL PROVISION FOR "TEMPORARY INFORMATION SIGNING" FOR ADDITIONAL INFORMATION.
6. ONE SIGN ASSEMBLY EQUALS 25.70 SQ. FT. (2.3 SQ. M.)
7. SHALL BE PAID FOR AS TEMPORARY INFORMATION SIGNING.

ALL DIMENSIONS ARE IN INCHES (MILLIMETERS) UNLESS OTHERWISE SHOWN.

FILE NAME = W:\diststd\22x34\tc22.dgn	USER NAME = gegl1enobt	DESIGNED -	REVISED - R. MIRS 09-15-97
		DRAWN -	REVISED - R. MIRS 12-11-97
	PLOT SCALE = 50.000 ' / IN.	CHECKED -	REVISED - T. RAMMACHER 02-02-99
	PLOT DATE = 1/4/2008	DATE -	REVISED - C. JUCIUS 01-31-07

**STATE OF ILLINOIS
DEPARTMENT OF TRANSPORTATION**

**ARTERIAL ROAD
INFORMATION SIGN**

SCALE: NONE SHEET NO. 1 OF 1 SHEETS STA. TO STA.

F.A.P. RTE.	SECTION	COUNTY	TOTAL SHEETS	SHEET NO.
344	(45&45)RS-1	LAKE	28	26
TC-22		CONTRACT NO. 62A07		
FED. ROAD DIST. NO. 1 ILLINOIS FED. AID PROJECT				

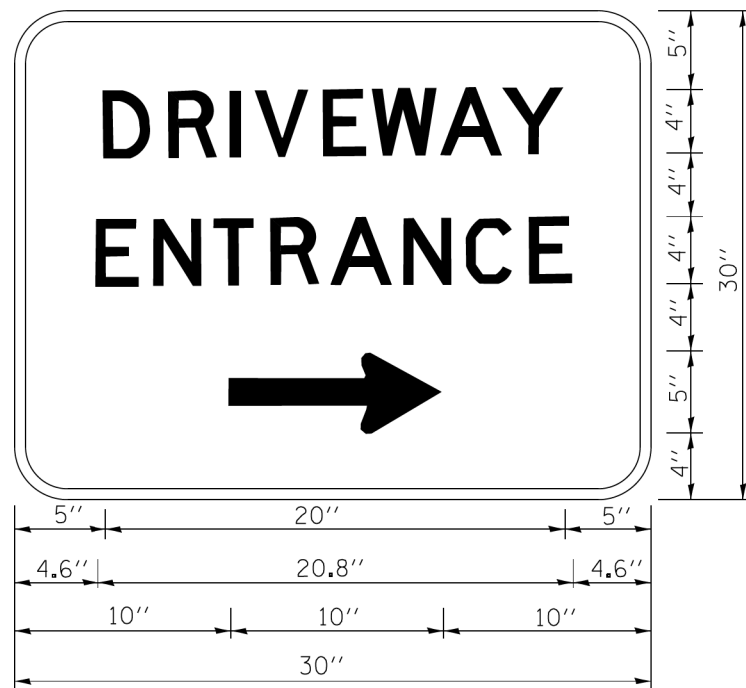

3.0" RADIUS, 0.5" BORDER, WHITE ON GREEN; REFLECTORIZED
 "DRIVEWAY" D; "ENTRANCE" D; STANDARD ARROW CUSTOM 12.0" x 5.0"

NOTES:

1. HALF OF THE SIGNS WILL REQUIRE A LEFT HAND FACING ARROW.
2. TWO SIGNS SHALL BE USED AT EACH COMMERCIAL ENTRANCE PLACED BACK-TO-BACK; ONE WITH A RIGHT HAND ARROW (SHOWN) SHALL BE PLACED ON THE NEAR RIGHT SIDE THE DRIVEWAY AND ONE WITH A LEFT HAND ARROW SHALL BE PLACED ON THE FAR LEFT SIDE OF THE DRIVEWAY.
3. SIGNS TO BE PAID FOR AS ITEM "TEMPORARY INFORMATION SIGNING".

FILE NAME =	USER NAME = gaglianob	DESIGNED -	REVISED - C. JUCIUS 02-15-07
ca\p\work\p\dot\gaglianob\d0108315\tp6.dgn		DRAWN -	REVISED -
		CHECKED -	REVISED -
		DATE -	REVISED -

**STATE OF ILLINOIS
 DEPARTMENT OF TRANSPORTATION**

DRIVEWAY ENTRANCE SIGNING

SCALE: NONE SHEET NO. 1 OF 1 SHEETS STA. TO STA.

F.A.P. RTE.	SECTION	COUNTY	TOTAL SHEETS	SHEET NO.
344	(45&45X)RS-1	LAKE	28	27
TC-26			CONTRACT NO. 62A07	
FED. ROAD DIST. NO. 1 ILLINOIS FED. AID PROJECT				

