

INDEX OF SHEETS

1. COVER SHEET
2. GENERAL NOTES
- 3 - 4. SUMMARY OF QUANTITIES
- 5 - 7. TYPICAL SECTIONS
- 8 - 10. SCHEDULES
11. TRAFFIC CONTROL AND PROTECTION, STANDARD 701400 (SPECIAL)
12. PAVEMENT MARKING
- 13 - 15. PAVEMENT PATCHING DETAILS

STANDARDS

- | | |
|-----------|--|
| 000001-06 | STANDARD SYMBOLS, ABBREVIATIONS AND PATTERNS |
| 001001-02 | AREAS OF REINFORCEMENT BARS |
| 001006 | DECIMAL OF AN INCH AND OF A FOOT |
| 420001-08 | PAVEMENT JOINTS |
| 420701-03 | PAVEMENT WELDED WIRE REINFORCEMENT |
| 421001-03 | BAR REINFORCEMENT FOR CRC PAVEMENT |
| 701001-02 | OFF-ROAD OPERATIONS 2L, 2W, MORE THAN 15' (4.5 m) AWAY |
| 701006-05 | OFF-ROAD OPERATIONS 2L, 2W, 15' (4.5 m) TO 24" (600 mm) FROM PAVEMENT EDGE |
| 701101-05 | OFF-ROAD OPERATIONS, MULTILANE, 15' (4.5 m) TO 24" (600 mm) FROM PAVEMENT EDGE |
| 701106-02 | OFF-ROAD OPERATIONS, MULTILANE, MORE THAN 15' (4.5 m) AWAY |
| 701201-04 | LANE CLOSURE, 2L, 2W, DAY ONLY, FOR SPEEDS ≥ 45 MPH |
| 701301-04 | LANE CLOSURE, 2L, 2W, SHORT TIME OPERATIONS |
| 701401-09 | LANE CLOSURE, FREEWAY/EXPRESSWAY |
| 701411-09 | LANE CLOSURE, MULTILANE, AT ENTRANCE OR EXIT RAMP FOR SPEEDS ≥ 45 MPH |
| 701426-08 | LANE CLOSURE, MULTILANE INTERMITTENT OR MOVING OPERATION, FOR SPEEDS ≥ 45 MPH |
| 701428-01 | TRAFFIC CONTROL, SETUP AND REMOVAL, FREEWAY/EXPRESSWAY |
| 701451-03 | RAMP CLOSURE FREEWAY/EXPRESSWAY |
| 701456-03 | PARTIAL EXIT RAMP CLOSURE FREEWAY/EXPRESSWAY |
| 701901-05 | TRAFFIC CONTROL DEVICES |
| 701011-04 | OFF-RD MOVING OPERATIONS 2L, 2W, DAY ONLY |

STATE OF ILLINOIS
DEPARTMENT OF TRANSPORTATION
DIVISION OF HIGHWAYS

PROPOSED
HIGHWAY PLANS

F.A.I. ROUTE 55 (I-55)
SECTION D3 PATCHING 2017-1
PAVEMENT PATCHING
LIVINGSTON COUNTY

C-93-067-16

IMPROVEMENT ENDS
GRUNDY COUNTY LINE
(M.M. 218.81)

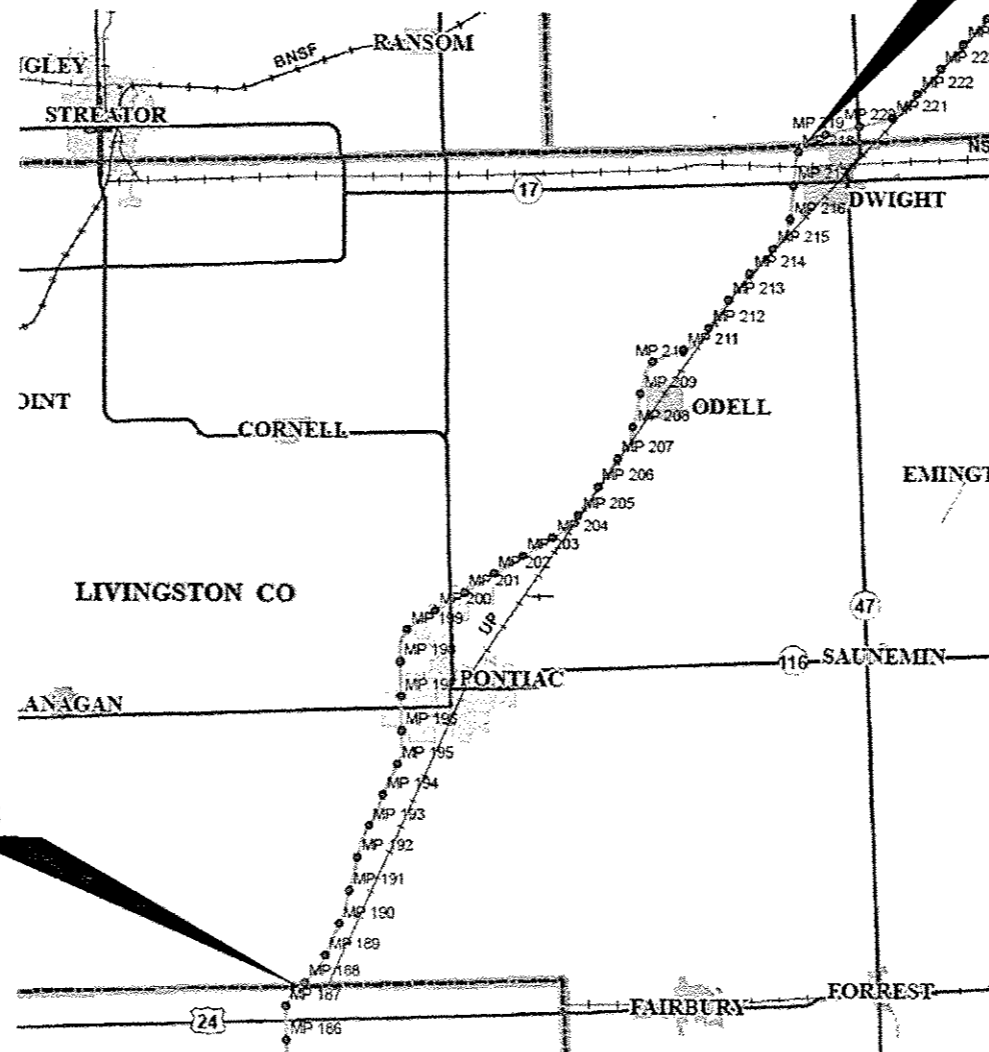

IMPROVEMENT BEGINS
MCLEAN COUNTY LINE
(M.M. 187.93)

GROSS LENGTH = 163,046 FT. = 30.88 MILE
NET LENGTH = 226 FT. = 0.043 MILE

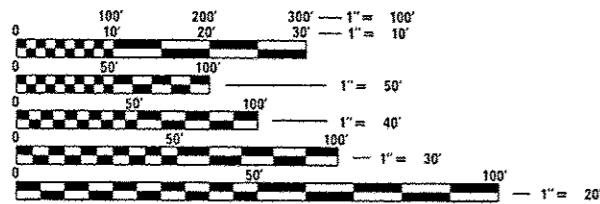

FULL SIZE PLANS HAVE BEEN PREPARED USING STANDARD ENGINEERING SCALES. REDUCED SIZED PLANS WILL NOT CONFORM TO STANDARD SCALES. IN MAKING MEASUREMENTS ON REDUCED PLANS, THE ABOVE SCALES MAY BE USED.

J.U.L.I.E.
JOINT UTILITY LOCATION INFORMATION FOR EXCAVATION
1-800-892-0123
OR 811

PROJECT ENGINEER: JOE KANNEL P.E.
UNIT CHIEF: RON WOODSHANK
TOWNSHIPS: VARIOUS
CONTRACT NO. 66F36

F.A.I. RTE.	SECTION	COUNTY	TOTAL SHEETS	SHEET NO.
55	D3 PATCHING 2017-1	LIVINGSTON	15	1
		ILLINOIS	CONTRACT NO. 66F36	

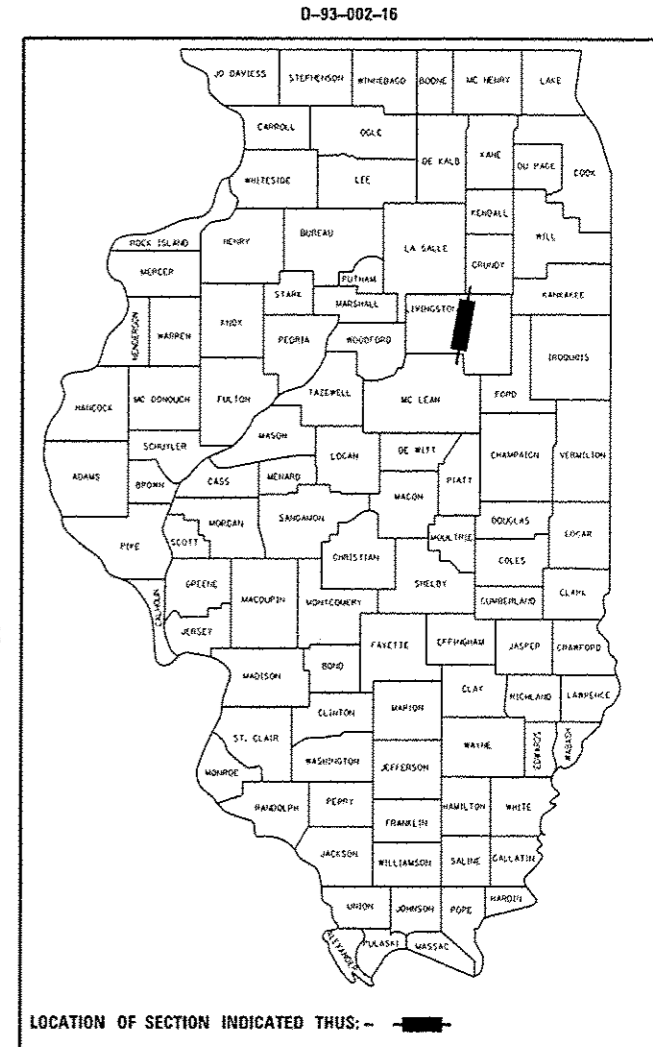

RURAL INTERSTATE 55 (I-55)

2015 ADT	
MAINLINE	
ADT	22600
P.V.	68.79%
S.U.	6.67%
M.U.	24.54%

STATE OF ILLINOIS
DEPARTMENT OF TRANSPORTATION
DIVISION OF HIGHWAYS

SUBMITTED *March 24 2016*
Paul Coate P.E.
DEPUTY DIRECTOR OF HIGHWAYS, REGION ENGINEER

May 6 2016
Maureen M. Addis P.E.
ENGINEER OF DESIGN AND ENVIRONMENT

May 6 2016
Omer Osman P.E.
DIRECTOR OF HIGHWAYS, CHIEF ENGINEER

PRINTED BY THE AUTHORITY
OF THE STATE OF ILLINOIS

GENERAL NOTES

COMMITMENTS

PLAN DIMENSIONS AND DETAILS RELATIVE TO EXISTING PLANS ARE SUBJECT TO NOMINAL CONSTRUCTION VARIATIONS. THE CONTRACTOR SHALL FIELD VERIFY EXISTING DIMENSIONS AND DETAILS AFFECTING NEW CONSTRUCTION AND MAKE NECESSARY APPROVED ADJUSTMENTS PRIOR TO CONSTRUCTION OR ORDERING OF MATERIALS. SUCH VARIATIONS SHALL NOT BE CAUSE FOR ADDITIONAL COMPENSATION FOR A CHANGE IN SCOPE OF WORK; HOWEVER, THE CONTRACTOR WILL BE PAID FOR THE QUANTITY ACTUALLY FURNISHED AT THE UNIT PRICE BID FOR THE WORK.

ON EXISTING PAVEMENT WHICH MAY BE SUPERELEVATED, THE NEW CONCRETE PAVEMENT SHALL BE BUILT WITH THE SAME SUPERELEVATION UNLESS NEW SUPERELEVATION RATES ARE GIVEN ON THE PLANS.

ANY REFERENCE TO A STANDARD IN THESE PLANS SHALL BE INTERPRETED TO MEAN THE EDITION AS INDICATED BY THE SUBNUMBER SHOWN IN THE LIST OF STANDARDS OR THE COPY INCLUDED IN THESE PLANS.

THE CONTRACTOR SHALL CONTACT JULIE AT LEAST 48 HOURS PRIOR TO EXCAVATION TO DETERMINE WHICH UTILITIES ARE IN THE AREA.

ALL EXCAVATED MATERIAL, WHICH INCLUDES DIGGING OR GRADING OF ANY SOIL OR FILL MATERIAL, WITH THE EXCEPTION OF AGGREGATE FILLS, MUST BE INCORPORATED WITHIN THE IDOT RIGHT OF WAY DUE TO ENVIRONMENTAL DOCUMENTATION REQUIREMENTS.

STATE OF ILLINOIS
DEPARTMENT OF TRANSPORTATION
DISTRICT THREE
AS BUILT INFORMATION

SUPERVISING CONSTRUCTION FIELD ENGINEER

RESIDENT ENGINEER / TECHNICIAN

START & END DATES
OF CONSTRUCTION:

INSPECTORS:

DATE: March 24, 2016

PREPARED BY: Tom Bevin
DISTRICT STUDIES & PLANS ENGINEER

EXAMINED BY: [Signature]
DISTRICT CONSTRUCTION ENGINEER

[Signature]
DISTRICT MATERIALS ENGINEER

[Signature]
DISTRICT OPERATIONS ENGINEER

STATE OF ILLINOIS
DEPARTMENT OF TRANSPORTATION

GENERAL NOTES

FILE NAME :	USER NAME : platechr	DESIGNED -	REVISED -	STATE OF ILLINOIS DEPARTMENT OF TRANSPORTATION	GENERAL NOTES	F.A.I. RTE.	SECTION	COUNTY	TOTAL SHEETS	SHEET NO.	
p:\11084EBID\INTEG\Illinois.gov\PI\DOT\Documents\IDOT Offices\District 3\Projects\036	DrawnData\036F36-shr-details.dgn	CHECKED -	REVISED -			55	03 PATCHING 2017-1	LIVINGSTON	15	2	
Default	PLOT SCALE = 100.0000' / in.	DATE -	REVISED -			SCALE:	SHEET 1 OF 1 SHEETS	STA. TO STA.	ILLINOIS FED. AID PROJECT		
	PLOT DATE = 3/24/2016									CONTRACT NO. 66F36	

CODE NO.	ITEM	UNIT	TOTAL QUANTITY	CONST. CODE
				CONT. MAINT. 100% STATE ROADWAY 0005 RURAL
44200541	CLASS A PATCHES, TYPE II, 9 INCH	SO YD	280	280
44200545	CLASS A PATCHES, TYPE III, 9 INCH	SO YD	84	84
44200547	CLASS A PATCHES, TYPE IV, 9 INCH	SO YD	161	161
44200934	CLASS B PATCHES, TYPE II, 8 INCH	SO YD	77	77
44200956	CLASS B PATCHES, TYPE II, 9 INCH	SO YD	1430	1430
44200982	CLASS B PATCHES, TYPE II, 11 INCH	SO YD	110	110
44201299	DOWEL BARS 1 1/2"	EACH	4116	4116
44213000	PATCHING REINFORCEMENT	SO YD	525	525
44213200	SAW CUTS	FOOT	11046	11046
44213204	TIE BARS 3/4"	EACH	1739	1739
67100100	MOBILIZATION	LSUM	1	1
70100420	TRAFFIC CONTROL AND PROTECTION, STANDARD 701411	EACH	6	6
70100825	TRAFFIC CONTROL AND PROTECTION, STANDARD 701456	LSUM	1	1
70103815	TRAFFIC CONTROL SURVEILLANCE	CAL DA	20	20

14

CODE NO.	ITEM	UNIT	TOTAL QUANTITY	CONST. CODE	
				CONT. MAINT. 100% STATE	
				ROADWAY 0005	RURAL
78008210	POLYUREA PAVEMENT MARKING TYPE I - LINE 4"	FOOT	3268	3268	
78008230	POLYUREA PAVEMENT MARKING TYPE I - LINE 6"	FOOT	1310	1310	
X0326880	MESSAGE BOARD VEHICLE DRIVER	HOUR	250	250	
X0326907	PORTABLE, VEHICLE MOUNTED, CHANGEABLE MESSAGE SIGN	CAL MO	1	1	
X7010410	SPEED DISPLAY TRAILER	CAL MO	1	1	
X7010805	TRAFFIC CONTROL AND PROTECTION, STANDARD 701401 (SPECIAL)	LSUM	1	1	
Z0030850	TEMPORARY INFORMATION SIGNING	SO FT	42	42	

7 •SPECIALITY ITEMS

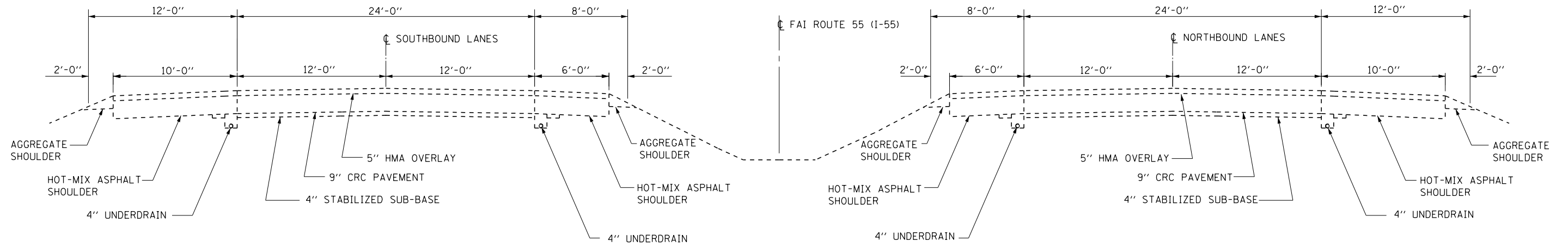

**TYPICAL SECTION
MAINLINE**
M.M. 187.70 TO M.M. 215.40

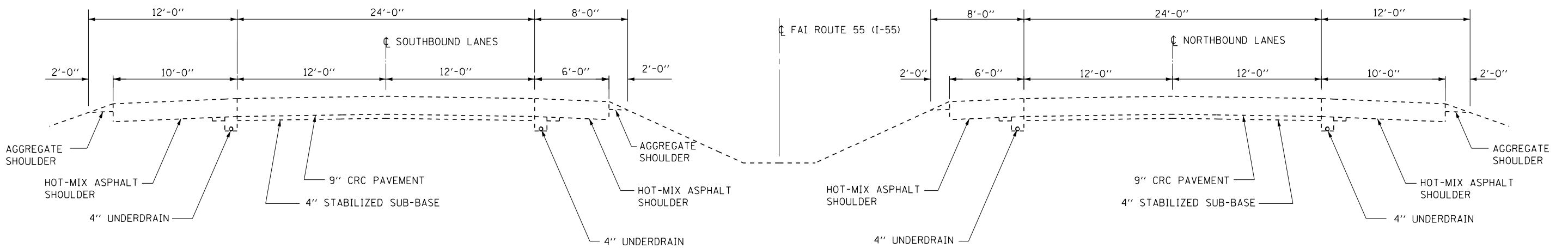

**TYPICAL SECTION
MAINLINE**
M.M. 215.40 TO M.M. 218.07

FILE NAME =	USER NAME = pletschr	DESIGNED -	REVISED -	STATE OF ILLINOIS DEPARTMENT OF TRANSPORTATION	TYPICAL SECTIONS			F.A.I. RTE.	SECTION	COUNTY	TOTAL SHEETS	SHEET NO.
pw:\IL\084EBIDINTEG.illinois.gov\PWIDOT\Documents\DOT Offices\District 3\Projects\0366F36\Drawings\B366F36-shd-details.dgn	PLOT SCALE = 100.0000' / in.	CHECKED -	REVISED -					55	D3 PATCHING 2017-1	LIVINGSTON	15	5
Default	PLOT DATE = 3/24/2016	DATE -	REVISED -		SCALE: SHEET 1 OF 3 SHEETS STA. TO STA.			ILLINOIS FED. AID PROJECT				
CONTRACT NO. 66F36												

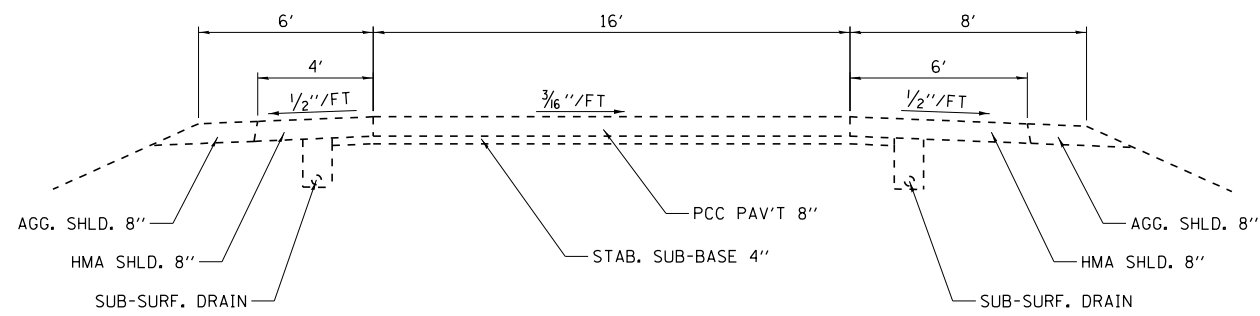

TANGENT SECTION

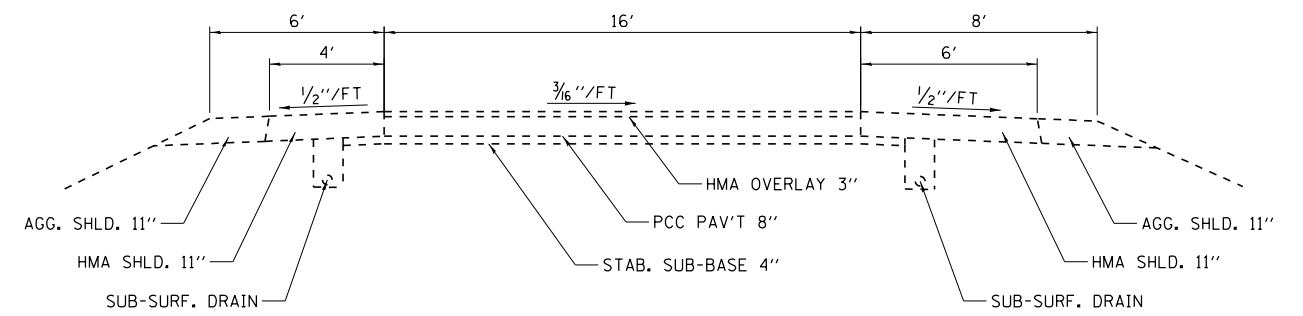

TANGENT SECTION

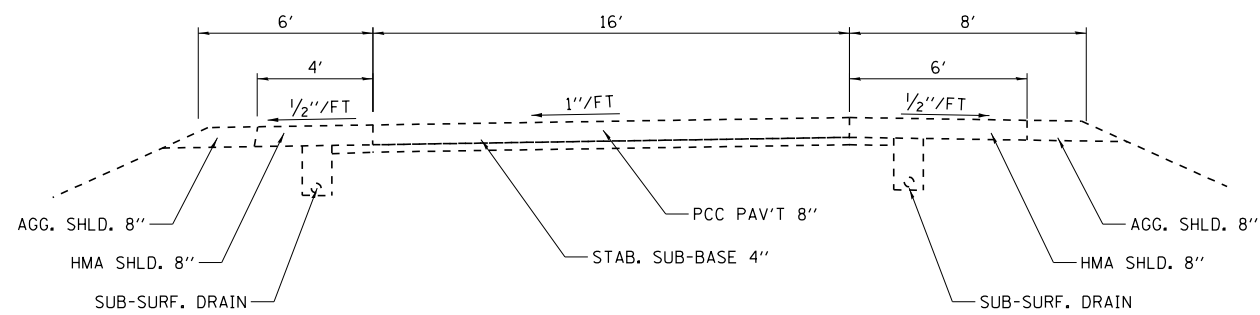

SUPERELEVATION TO LEFT

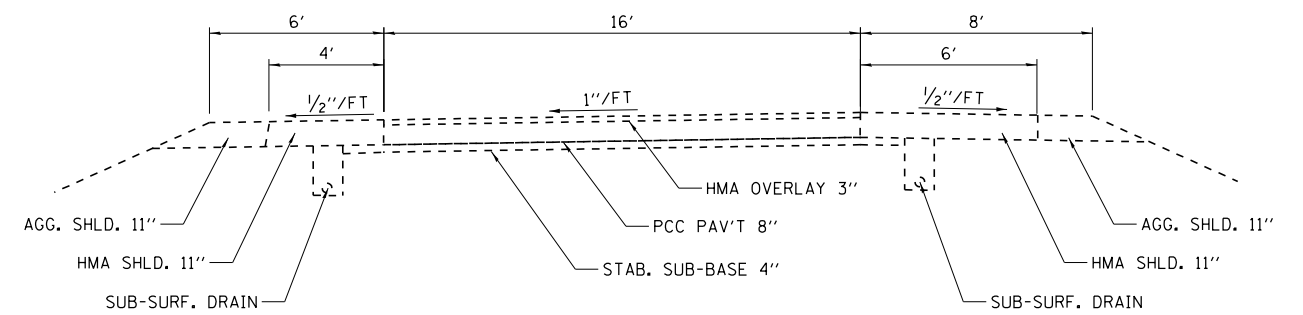

SUPERELEVATION TO LEFT

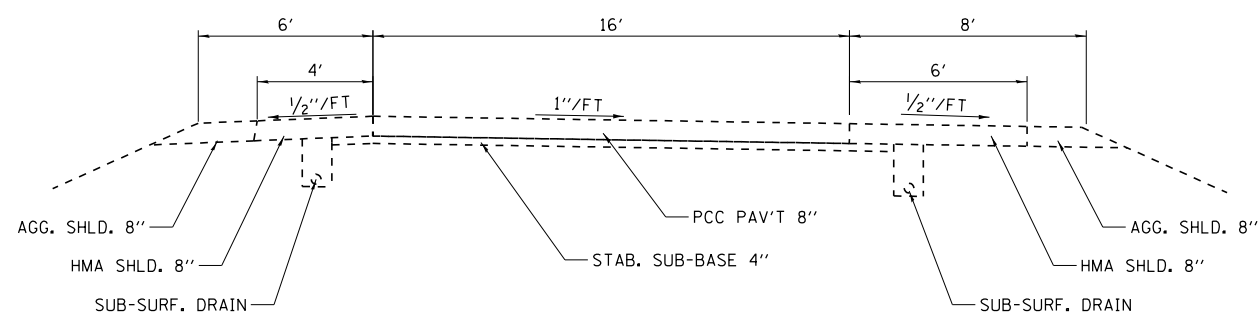

SUPERELEVATION TO RIGHT

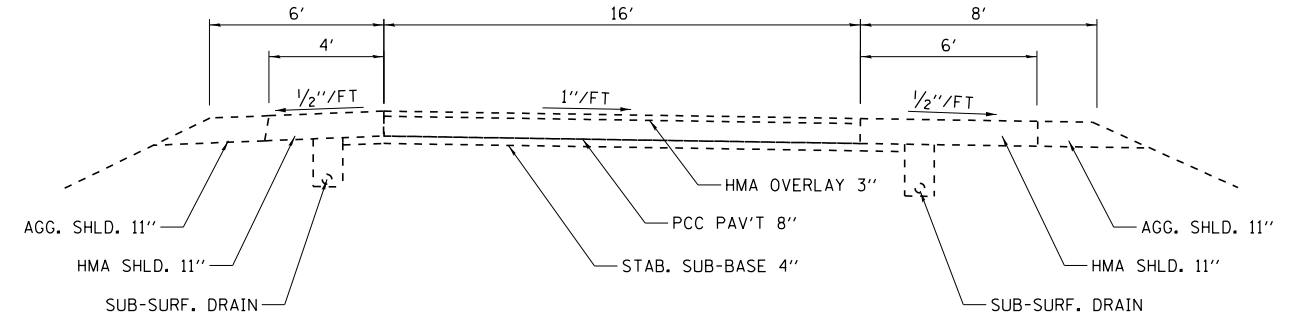

SUPERELEVATION TO RIGHT

TYPICAL SECTION – RAMPS
IL 17, IL 23, IL 116

TYPICAL SECTION – RAMPS
ODELL

FILE NAME =	USER NAME = pletschr	DESIGNED -	REVISED -	STATE OF ILLINOIS DEPARTMENT OF TRANSPORTATION	TYPICAL SECTIONS		F.A.I. RTE.	SECTION	COUNTY	TOTAL SHEETS	SHEET NO.
pw:\IL\084EBIDINTEG\illinois.gov\PWIDOT\Documents\IDOT Offices\District 3\Projects\0366\Drawings\0366F36-shd-details.dgn		CHECKED -	REVISED -				55	D3 PATCHING 2017-1	LIVINGSTON	15	6
Default	PLOT SCALE = 100.0000' / in.	DATE -	REVISED -		CONTRACT NO. 66F36			ILLINOIS FED. AID PROJECT			
	PLOT DATE = 3/24/2016				SCALE:	SHEET 2 OF 3 SHEETS	STA.	TO STA.			

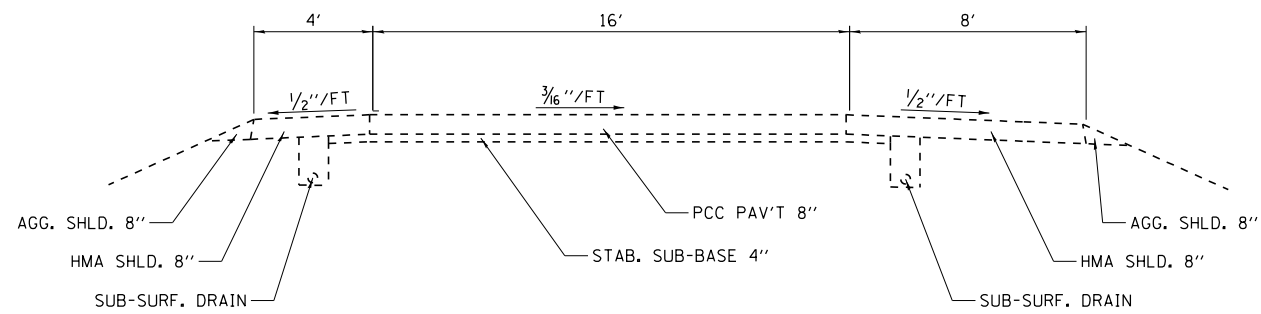

CAR ENTRANCE AND EXIT RAMP

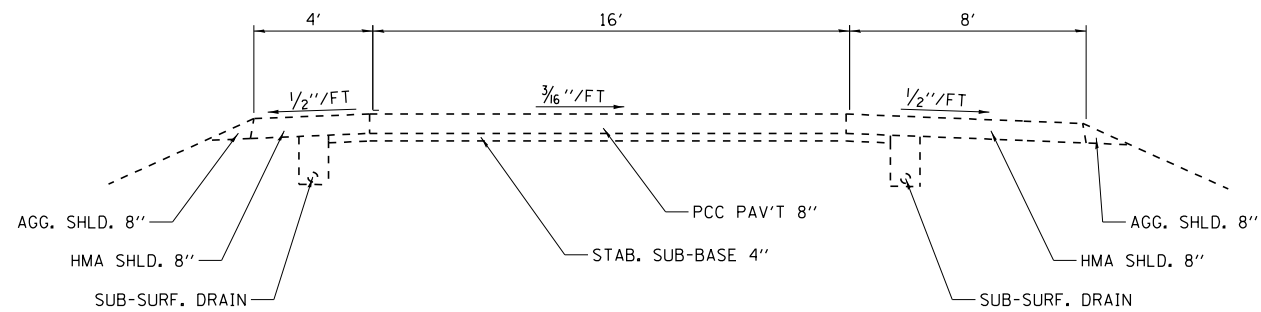

NORTHBOUND TRUCK RAMP

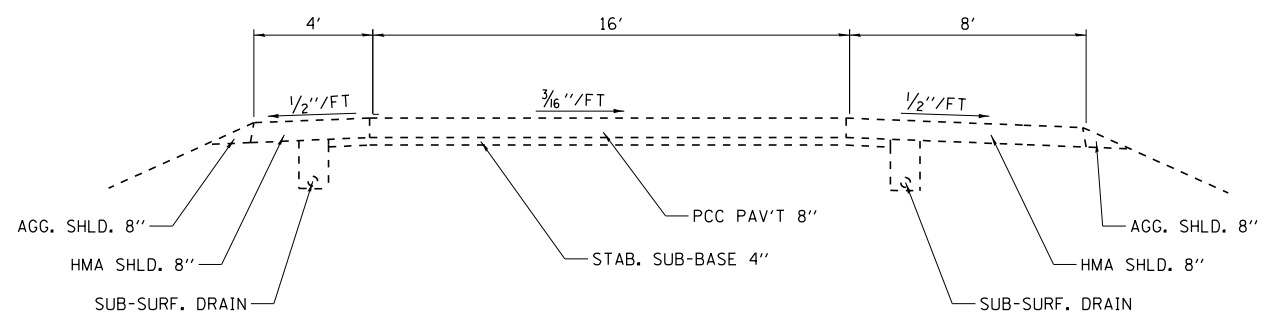

SOUTHBOUND TRUCK RAMP

**TYPICAL SECTION
NORTHBOUND AND SOUTHBOUND
REST AREAS**

FILE NAME =	USER NAME = pletschr	DESIGNED -	REVISED -
pw:\IL\084EBIDINTEG.illinois.gov\PIWIDOT\Documents\DOT Offices\District 3\Projects\0366F36\Drawings\B366F36-shr-details.dgn			
Default	PLOT SCALE = 100.0000' / in.	CHECKED -	REVISED -
	PLOT DATE = 3/24/2016	DATE -	REVISED -

**STATE OF ILLINOIS
DEPARTMENT OF TRANSPORTATION**

TYPICAL SECTIONS	
SCALE:	SHEET 3 OF 3 SHEETS STA. TO STA.

F.A.I. RTE.	SECTION	COUNTY	TOTAL SHEETS	SHEET NO.
55	D3 PATCHING 2017-1	LIVINGSTON	15	7
CONTRACT NO. 66F36				
ILLINOIS FED. AID PROJECT				

PATCHING SCHEDULE - NORTHBOUND

LOCATION MILE POST	DRIVING LANE						
	PATCH LENGTH FEET	CLASS A PATCHING			PATCH REINF. SQ YD	SAW CUTS FOOT	TIE BARS 3/4" EACH
		TYPE II 9" SQ YD	TYPE III 9" SQ YD	TYPE IV 9" SQ YD			
NORTHBOUND LANES							
215.30	6	8			8	48	42
215.40	6	8			8	48	42
215.40	15		20		20	66	42
215.40	20			27	27	76	52
215.50	6	8			8	48	42
216.40	6	8			8	48	42
216.90	6	8			8	48	42
216.90	6	8			8	48	42
216.90	8	11			11	52	42
217.00	6	8			8	48	42
217.00	8	11			11	52	42
217.10	6	8			8	48	42
217.10	6	8			8	48	42
217.20	10	13			13	56	42
217.30	8	11			11	52	42
217.50	10	13			13	56	42
217.50	20			27	27	76	52
217.50	6	8			8	48	42
217.50	25			33	33	86	54
217.50	6	8			8	48	42
217.50	35			47	47	106	59
217.70	12		16		16	60	42
217.70	6	8			8	48	42
217.80	6	8			8	48	42
218.00	6	8			8	48	42
218.20	10	13			13	56	42
TOTALS		184	36	134	354	1466	1141

PAVEMENT MARKING SCHEDULE

LOCATION MILE POST	POLYUREA PAVEMENT MARKING TYPE 1 LINE - 4"	POLYUREA PAVEMENT MARKING TYPE 1 LINE - 6"
	FEET	FEET
	WHITE	WHITE
NORTHBOUND LANES		
215.30	6	10
215.40	6	10
215.40	15	10
215.40	20	10
215.50	6	10
216.40	6	10
216.90	6	10
216.90	6	10
216.90	8	10
217.00	6	10
217.00	8	10
217.10	6	10
217.10	6	10
217.20	10	10
217.30	8	10
217.50	10	10
217.50	20	10
217.50	6	10
217.50	25	10
217.50	6	10
217.50	35	20
217.70	12	10
217.70	6	10
217.80	6	10
218.00	6	10
218.20	10	10
TOTAL	265	270

PATCHING SCHEDULE - SOUTHBOUND

LOCATION MILE POST	DRIVING LANE						
	PATCH LENGTH FEET	CLASS A PATCHING			PATCH REINF. SQ YD	SAW CUTS FOOT	TIE BARS 3/4" EACH
		TYPE II 9" SQ YD	TYPE III 9" SQ YD	TYPE IV 9" SQ YD			
SOUTHBOUND LANES							
218.20	6	8			8	48	42
218.10	12		16		16	60	42
218.10	10	13			13	56	42
217.90	6	8			8	48	42
217.90	6	8			8	48	42
217.80	8	11			11	52	42
217.50	6	8			8	48	42
217.00	6	8			8	48	42
216.20	6	8			8	48	42
215.60	12		16		16	60	42
215.60	20			27	27	76	52
215.50	10	13			13	56	42
215.50	12		16		16	60	42
215.40	8	11			11	52	42
TOTALS		96	48	27	171	760	598

PAVEMENT MARKING SCHEDULE

LOCATION MILE POST	POLYUREA PAVEMENT MARKING TYPE 1 LINE - 4"	POLYUREA PAVEMENT MARKING TYPE 1 LINE - 6"
	FEET	FEET
	WHITE	WHITE
SOUTHBOUND LANES		
218.20	6	10
218.10	12	10
218.10	10	10
217.90	6	10
217.90	6	10
217.80	8	10
217.50	6	10
217.00	6	10
216.20	6	10
215.60	12	10
215.60	20	10
215.50	10	10
215.50	12	10
215.40	8	10
TOTAL	128	140

CLASS B PATCHING SCHEDULE - NORTHBOUND

LOCATION	ENTRANCE RAMP			EXIT RAMP				
	ENTRANCE RAMP	EXIT RAMP	TYPE II	DOWEL BARS	SAW CUTS	TYPE II	DOWEL BARS	SAW CUTS
	(FT)	(FT)	9"	EACH	FOOT	9"	EACH	FOOT
EXIT 197 IL 116 SOUTH SIDE OF PONTIAC	6	6	11	28	60	11	28	60
	6	6	11	28	60	11	28	60
	6	6	11	28	60	11	28	60
	6	6	11	28	60	11	28	60
	6	6	11	28	60	11	28	60
	6	6	11	28	60	11	28	60
	6	6	11	28	60	11	28	60
	6	6	11	28	60	11	28	60
	6	6	11	28	60	11	28	60
	6	6	11	28	60	11	28	60
	6	6	11	28	60	11	28	60
	6	6	11	28	60	11	28	60
	6	6	11	28	60	11	28	60
	6	6	11	28	60	11	28	60
	6	6	11	28	60	11	28	60
	6	6	11	28	60	11	28	60
	6	6	11	28	60	11	28	60
	6	6	11	28	60	11	28	60
	6	6	11	28	60	11	28	60
	6	6	11	28	60	11	28	60
TOTAL			275	700	1500	220	560	1200

CLASS B PATCHING SCHEDULE - NORTHBOUND

LOCATION	ENTRANCE RAMP			EXIT RAMP				
	ENTRANCE RAMP	EXIT RAMP	TYPE II	DOWEL BARS	SAW CUTS	TYPE II	DOWEL BARS	SAW CUTS
	(FT)	(FT)	9"	EACH	FOOT	9"	EACH	FOOT
EXIT 201 IL 23 NORTH SIDE OF PONTIAC	6	6	11	28	60	11	28	60
	6	6	11	28	60	11	28	60
	6	6	11	28	60	11	28	60
	6	6	11	28	60	11	28	60
	6	6	11	28	60	11	28	60
	6	6	11	28	60	11	28	60
	6	6	11	28	60	11	28	60
	6	6	11	28	60	11	28	60
	6	6	11	28	60	11	28	60
	6	6	11	28	60	11	28	60
	6	6	11	28	60	11	28	60
	6	6	11	28	60	11	28	60
	6	6	11	28	60	11	28	60
	6	6	11	28	60	11	28	60
TOTAL			66	168	360	143	364	780

CLASS B PATCHING SCHEDULE - NORTHBOUND

LOCATION	ENTRANCE RAMP			EXIT RAMP				
	ENTRANCE RAMP	EXIT RAMP	TYPE II	DOWEL BARS	SAW CUTS	TYPE II	DOWEL BARS	SAW CUTS
	(FT)	(FT)	11"	EACH	FOOT	11"	EACH	FOOT
EXIT 209 2600N RD ODELL	6	6	11	28	60	11	28	60
	6	6	11	28	60	11	28	60
	6	6	11	28	60	11	28	60
	6	6	11	28	60	11	28	60
TOTAL			33	84	180	33	84	180

CLASS B PATCHING SCHEDULE - NORTHBOUND

LOCATION	ENTRANCE RAMP			EXIT RAMP				
	ENTRANCE RAMP	EXIT RAMP	TYPE II	DOWEL BARS	SAW CUTS	TYPE II	DOWEL BARS	SAW CUTS
	(FT)	(FT)	8"	EACH	FOOT	8"	EACH	FOOT
EXIT 217 IL 17 DWIGHT	6	6	11	28	60	11	28	60
	6	6	11	28	60	11	28	60
	6	6	11	28	60	11	28	60
	6	6	11	28	60	11	28	60
TOTAL			33	84	180	44	112	240

SCHEDULE
PAVEMENT MARKING
NORTHBOUND RAMPS

LOCATION		POLYUREA PAVEMENT MARKING TYPE 1 LINE 4"	
		FEET	
		YELLOW	WHITE
EXIT 197 (IL 116)	ENTRANCE RAMP	150	150
	EXIT	120	120
EXIT 201 (IL 23)	ENTRANCE RAMP	36	36
	EXIT	78	78
EXIT 209 (ODELL)	ENTRANCE RAMP	18	18
	EXIT	18	18
EXIT 217 (IL 17)	ENTRANCE RAMP	18	18
	EXIT	24	24
SUBTOTAL		462	438
TOTAL		900	

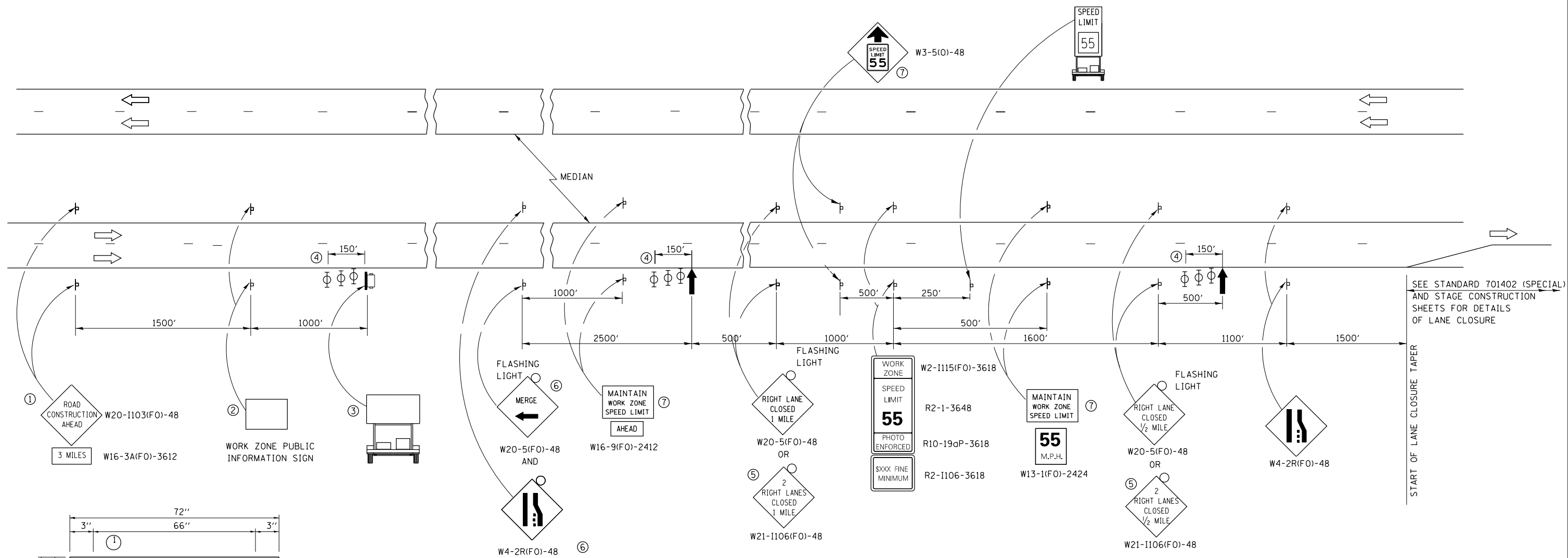

SEE STANDARD 701402 (SPECIAL) AND STAGE CONSTRUCTION SHEETS FOR DETAILS OF LANE CLOSURE

START OF LANE CLOSURE TAPER

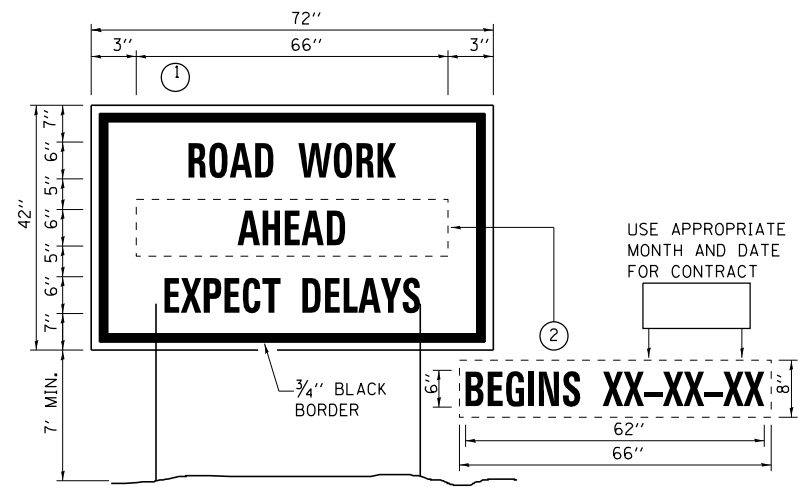

TEMPORARY INFORMATION SIGNING

- NOTES:**
1. USE 6" D BLACK LETTERING ON FLOURESENT ORANGE BACKGROUND.
 2. ERECT SIGNS AT LOCATIONS IN ADVANCE OF THE "ROAD CONSTRUCTION AHEAD" SIGNS ON EACH SIDE OF THE ROADWAY AS DIRECTED BY THE ENGINEER.
 3. ERECT SIGN ① WITH INSTALLED PANEL ② A MINIMUM OF ONE WEEK PRIOR TO THE START OF THE LANE CLOSURE.
 4. REMOVE PANEL ② ON THAT DATE.
 5. SEE SPECIAL PROVISION "TEMPORARY INFORMATION SIGNING" FOR ADDITIONAL INFORMATION.
 6. WILL BE PAID FOR PER SQ FT AS "TEMPORARY INFORMATION SIGNING". EACH SIGN = 21 SQ FT AND THE DATE PANEL ② WILL NOT BE MEASURED SEPARATELY FOR PAYMENT.

- ① THE ROAD CONSTRUCTION AHEAD SIGN SHALL BE LOCATED 3 MILES IN ADVANCE OF THE PROJECT LIMITS.
- ② THE MESSAGE AND SIZE OF THE WORK ZONE PUBLIC INFORMATION SIGN SHALL BE AS SPECIFIED BY THE DEPARTMENT.
- ③ TO BE PLACED IN THE MEDIAN WHEN FEASIBLE. THE MESSAGE BOARD SHALL BE USED TO DISPLAY STATUS OF LANES WITHIN THE PROJECT. THE PRIMARY MESSAGES SHALL BE:
"RIGHT LANE CLOSED" / " x MILES AHEAD"
"LEFT LANE CLOSED" / " x MILES AHEAD"
"ALL LANES OPEN"
- ④ THREE, TYPE II BARRICADES, DRUMS, OR VERTICAL BARRICADES AT 50' CENTERS.
- ⑤ THIS SIGN SHALL BE USED WHEN 2 LANES ARE CLOSED.
- ⑥ WHEN THE LEFT LANE IS CLOSED, SWITCH THESE TWO SIGNS AND THE DIRECTION OF THE MERGE ARROW.
- ⑦ THIS SIGN SHALL ONLY BE USED IF THE EXISTING SPEED LIMIT IS GREATER THAN 65 MPH.

⑦ 48"x36" FLUORESCENT ORANGE SIGN WITH BLACK LETTERS.

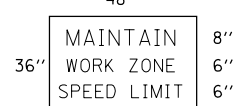

- ↑ ARROW BOARD
- ☐ PORTABLE CHANGEABLE MESSAGE SIGN
- ⊥ SIGN
- ⊕ TYPE II BARRICADE, DRUM, OR VERTICAL BARRICADE WITH MONODIRECTIONAL FLASHING LIGHT
- 🚚 SPEED DISPLAY TRAILER

GENERAL NOTE:

THIS STANDARD IS USED WHERE AT ANY TIME A LANE IS CLOSED ON A FREEWAY/EXPRESSWAY.

WHEN THE LEFT LANE IS CLOSED, LEFT LANE CLOSED SIGNS SHALL BE SUBSTITUTED FOR THE RIGHT LANE CLOSED SIGNS.

THE FIRST TWO SIGNS AND THE MESSAGE BOARD ARE STATIONARY. THE OTHER SIGNS AND ARROWBOARDS SHALL BE MOVED AS NECESSARY TO MAINTAIN THE REQUIRED DISTANCE FROM THE START OF THE LANE CLOSURE TAPER(S).

SEE SPECIAL PROVISIONS.

FILE NAME =	USER NAME = pletschr	DESIGNED -	REVISED -	STATE OF ILLINOIS DEPARTMENT OF TRANSPORTATION	TRAFFIC CONTROL AND PROTECTION STANDARD 701400 (SPECIAL)	F.A.I. RTÉ.	SECTION	COUNTY	TOTAL SHEETS	SHEET NO.	
p:\1\084EBIDINTEG.illinois.gov\PI\DOT\Documents\DOT Offices\District 3\Projects\0366FD\Drawings\B366F36-shd-details.dgn	PLOT SCALE = 100.0000' / in.	CHECKED -	REVISED -			55	D3 PATCHING 2017-1	LIVINGSTON	15	11	
Default	PLOT DATE = 3/24/2016	DATE -	REVISED -			CONTRACT NO. 66F36					
						ILLINOIS FED. AID PROJECT					

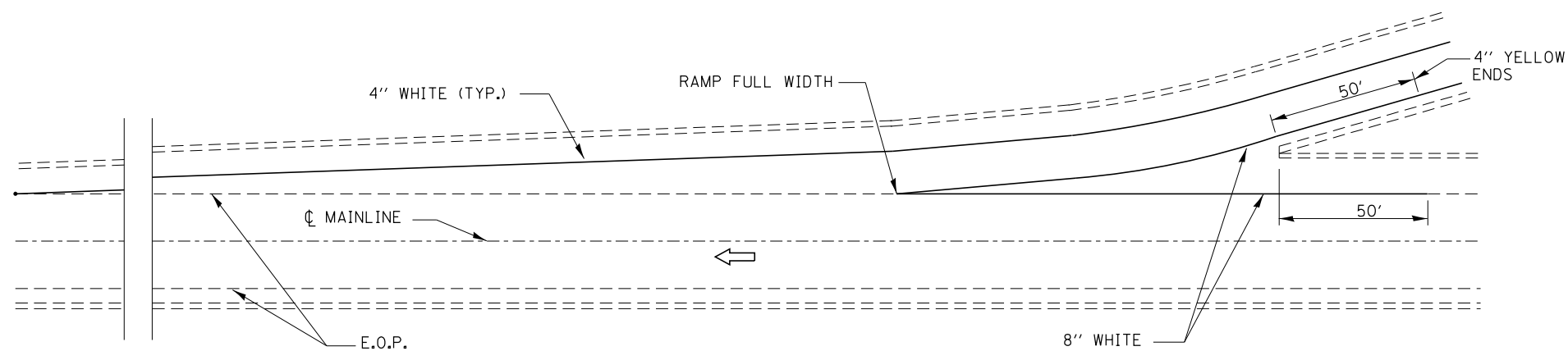

TYPICAL PAVEMENT MARKING FOR ENTRANCE RAMP TERMINALS

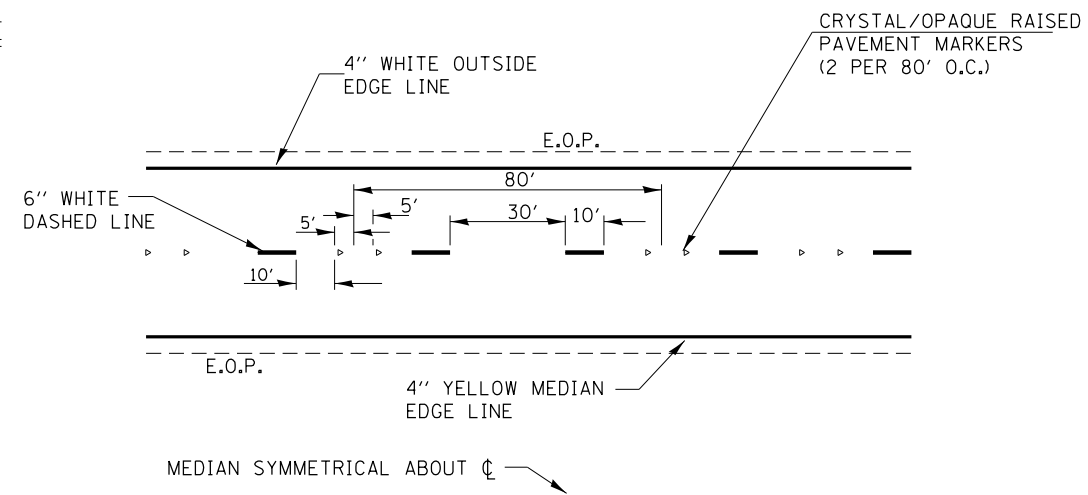

TYPICAL PAVEMENT MARKINGS

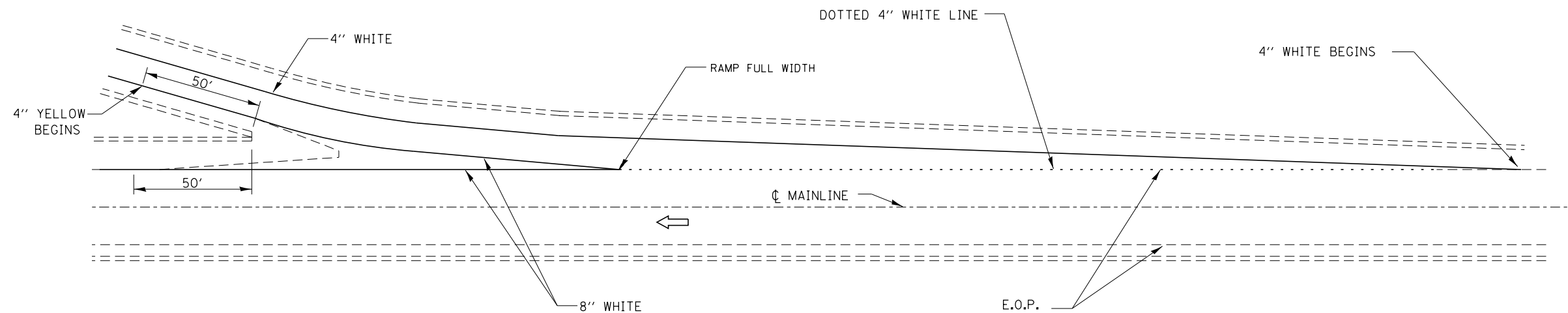

TYPICAL PAVEMENT MARKINGS FOR EXIT RAMP TERMINALS

FILE NAME =	USER NAME = pletschr	DESIGNED -	REVISED -	STATE OF ILLINOIS DEPARTMENT OF TRANSPORTATION	PAVEMENT MARKING		F.A.I. RTE.	SECTION	COUNTY	TOTAL SHEETS	SHEET NO.
pw:\IL\084EBIDINTEG.illinois.gov\PIWIDOT\Documents\IDOT Offices\District 3\Projects\0366F36\DRAWING\0366F36-shr-details.dgn	PLOT SCALE = 100.0000' / in.	CHECKED -	REVISED -				55	D3 PATCHING 2017-1	LIVINGSTON	15	12
Default	PLOT DATE = 3/24/2016	DATE -	REVISED -		CONTRACT NO. 66F36			ILLINOIS FED. AID PROJECT			
					SCALE:	SHEET 1 OF 1 SHEETS	STA.	TO STA.			

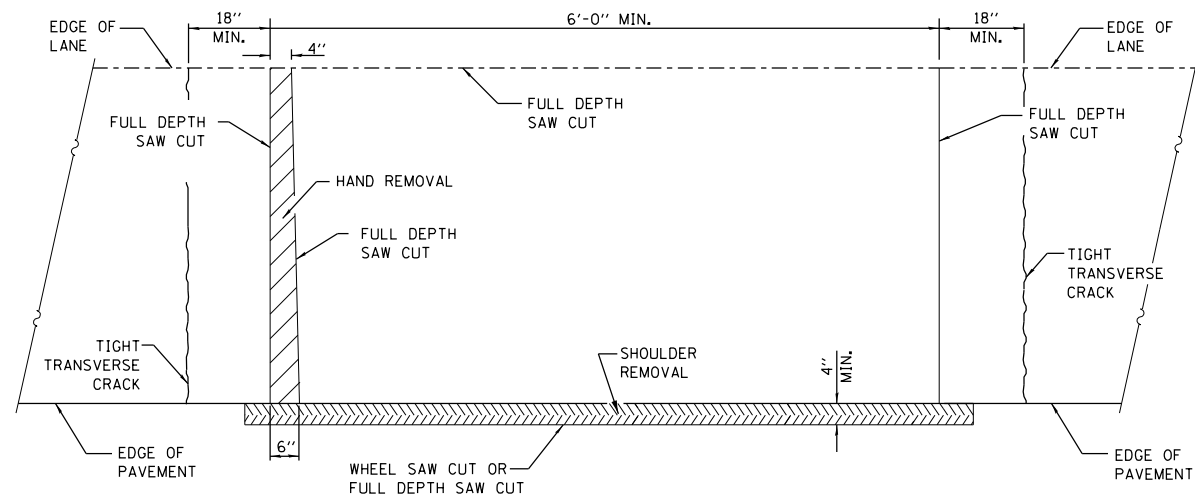

(HMA SHOULDER)

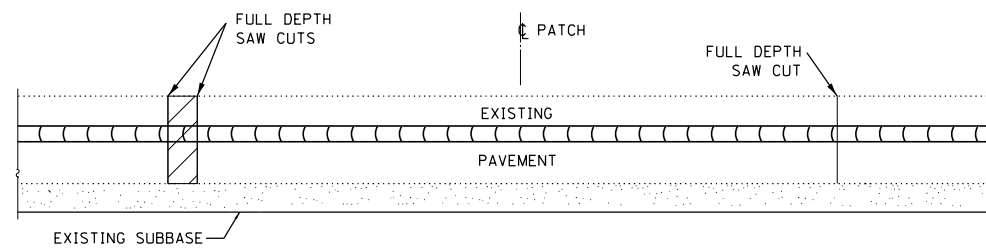

WITHOUT HMA SURFACE

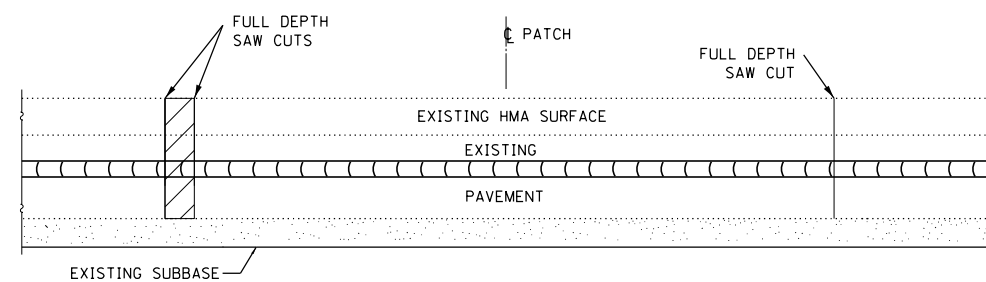

WITH HMA SURFACE

**PAVEMENT SAWING DETAIL FOR CLASS A PATCHING
(CRC PAVEMENT)**

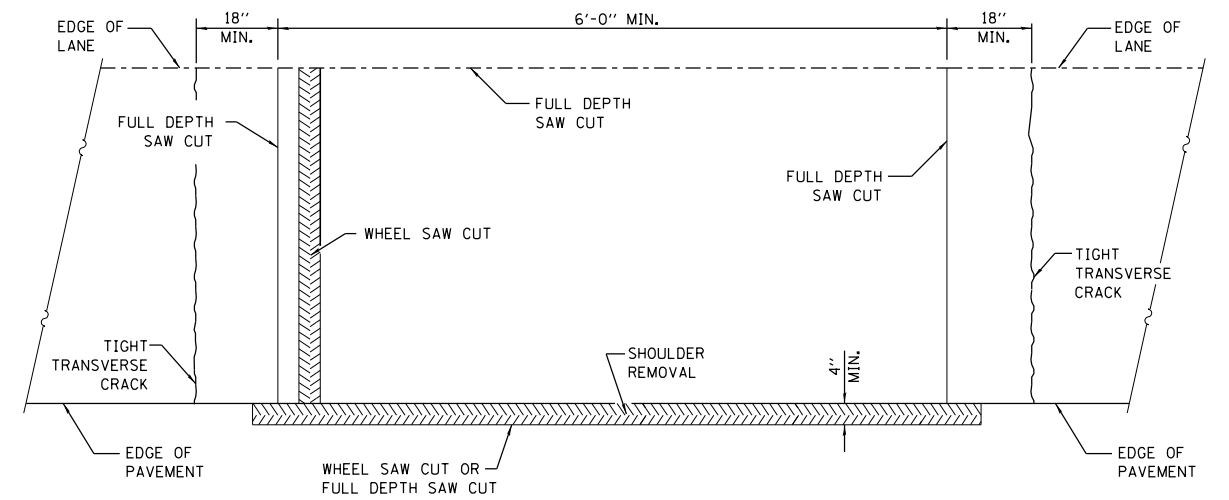

(HMA SHOULDER)

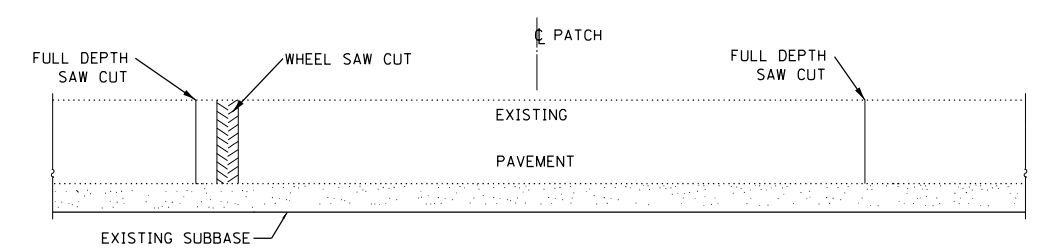

WITHOUT HMA SURFACE

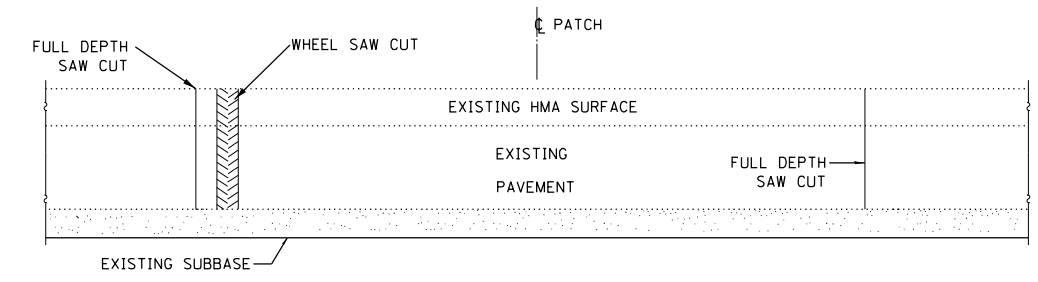

WITH HMA SURFACE

**PAVEMENT SAWING DETAIL FOR CLASS B PATCHING
(PCC PAVEMENT)**

FILE NAME =	USER NAME = pletschr	DESIGNED -	REVISED -
p:\11\084EBIDINTEG\illinois.gov\PIWIDOT\Documents\IDOT Offices\District 3\Projects\03666\DRAWING\B3666F36-shd-details.dgn		REVISED -	REVISED -
Default	PLOT SCALE = 100.0000' / in.	CHECKED -	REVISED -
	PLOT DATE = 3/24/2016	DATE -	REVISED -

**STATE OF ILLINOIS
DEPARTMENT OF TRANSPORTATION**

PAVEMENT PATCHING DETAILS

SCALE: SHEET 1 OF 3 SHEETS STA. TO STA.

F.A.I. RTE.	SECTION	COUNTY	TOTAL SHEETS	SHEET NO.
55	D3 PATCHING 2017-1	LIVINGSTON	15	13
			CONTRACT NO. 66F36	
ILLINOIS FED. AID PROJECT				

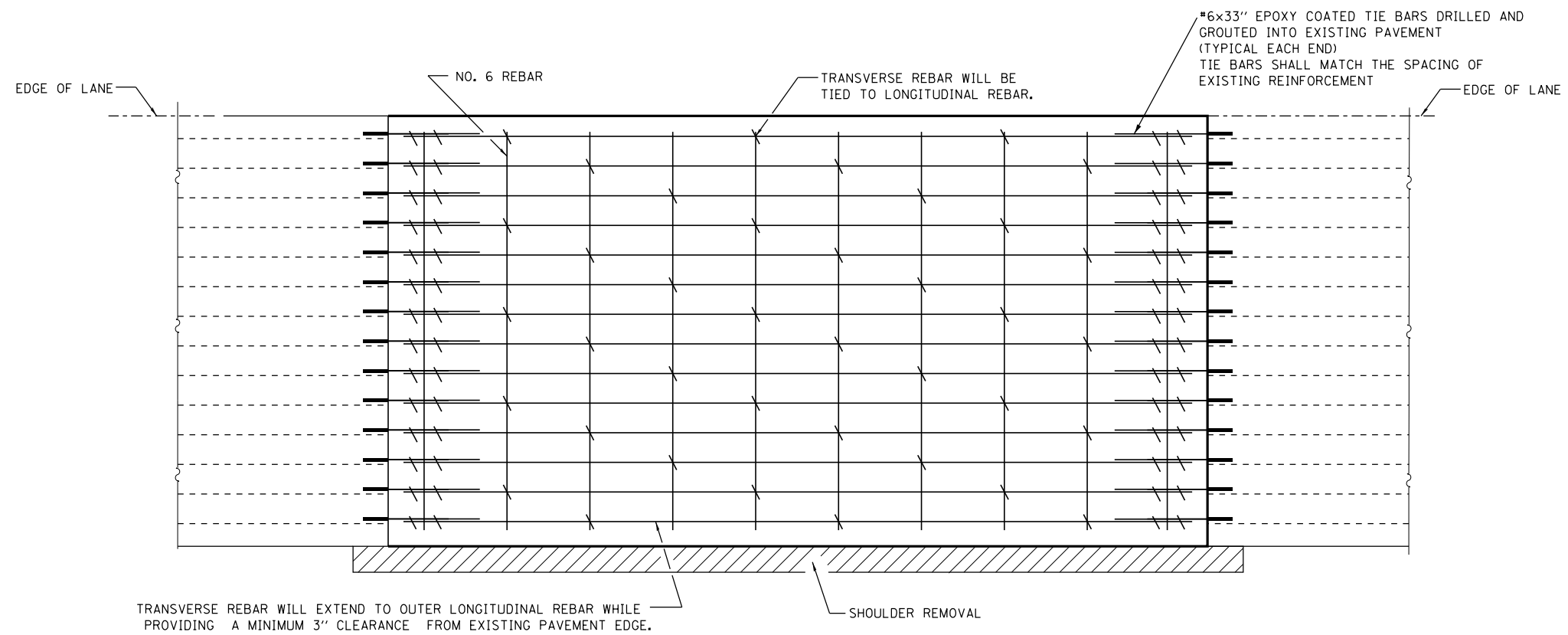

PAVEMENT REINFORCEMENT DETAIL

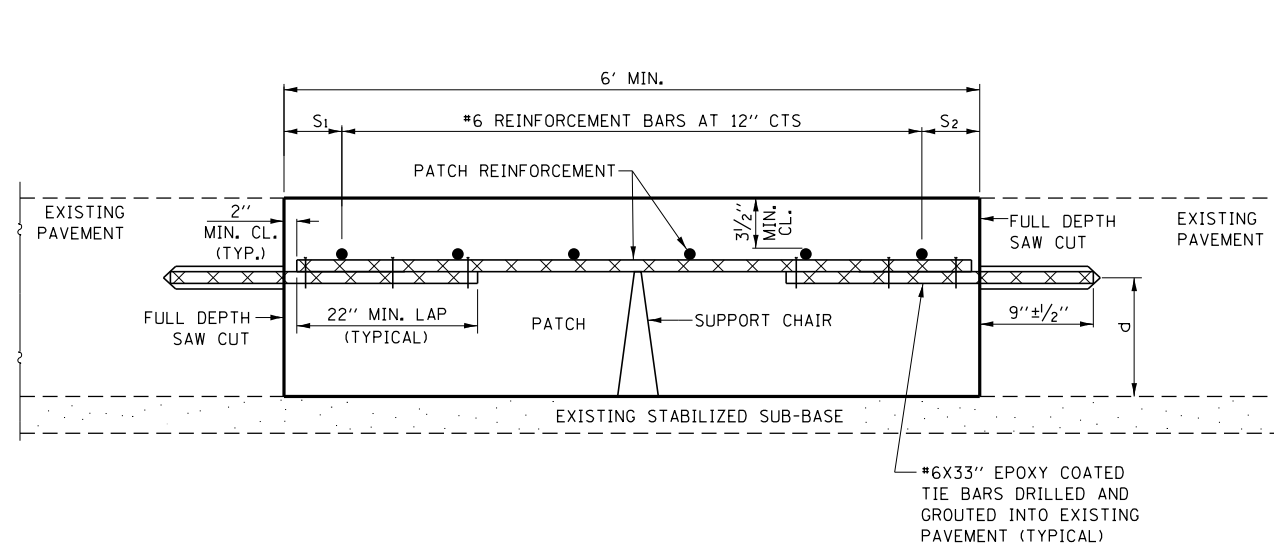

WITHOUT HOT-MIX ASPHALT OVERLAY

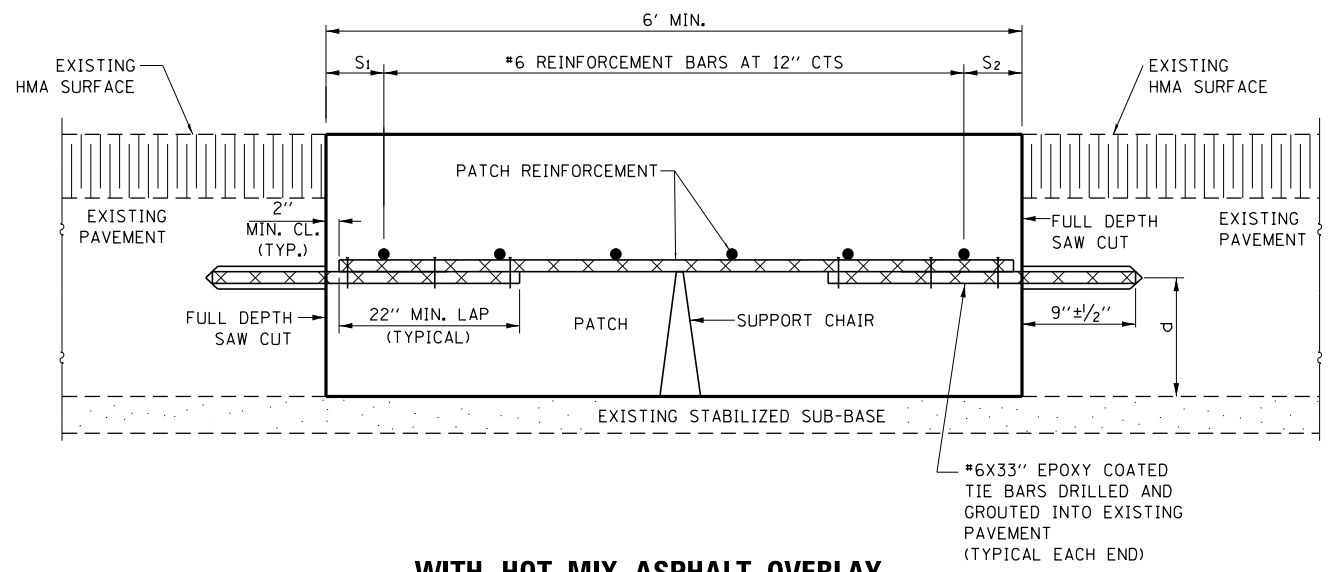

WITH HOT-MIX ASPHALT OVERLAY

**PATCHING DETAIL FOR CLASS A PATCHING
(CRC PAVEMENT)**

NOTES:
 EVERY THIRD INTERSECTION MUST BE TIED
 WHEN THE MINIMUM CLEARANCE CANNOT BE OBTAINED WITH THE TRANSVERSE BAR ON TOP THEN THE TRANSVERSE REBAR SHALL BE TIED TO THE BOTTOM OF THE LONGITUDINAL REBAR.
 VARIABLES WHERE S AND S ARE 2 1/2" MIN. AND 12" MAX.
 d = VERTICAL PLACEMENT OF EXISTING REINFORCEMENT

FILE NAME =	USER NAME = pletschr	DESIGNED -	REVISED -	STATE OF ILLINOIS DEPARTMENT OF TRANSPORTATION	PAVEMENT PATCHING DETAILS			F.A.I. RT.	SECTION	COUNTY	TOTAL SHEETS	SHEET NO.
pw:\IL\084EBIDINTEG.illinois.gov\PI\DOT\Documents\DOT Offices\District 3\Projects\0366\DRAWING\0366F36-shd-details.dgn	PLOT SCALE = 100.0000' / in.	CHECKED -	REVISED -					55	D3 PATCHING 2017-1	LIVINGSTON	15	14
Default	PLOT DATE = 3/24/2016	DATE -	REVISED -		SCALE: SHEET 2 OF 3 SHEETS STA. TO STA.			CONTRACT NO. 66F36				
											ILLINOIS FED. AID PROJECT	

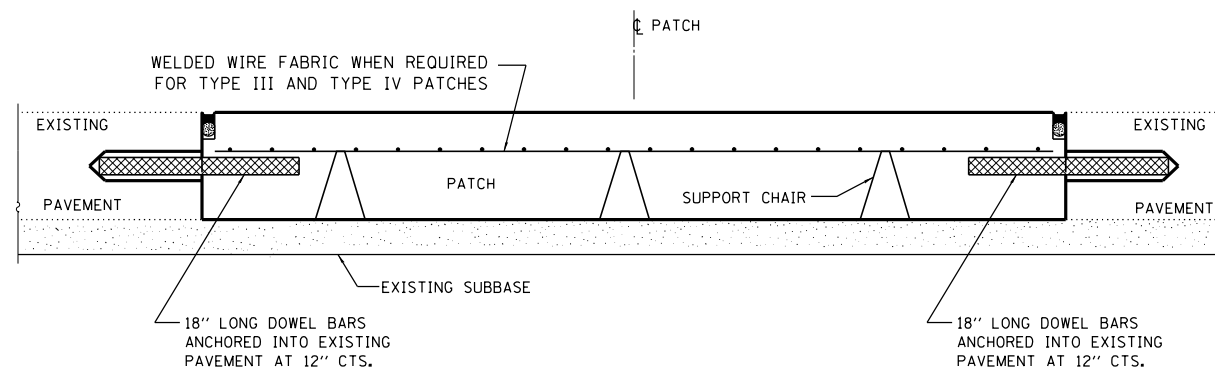

WITHOUT HMA SURFACE

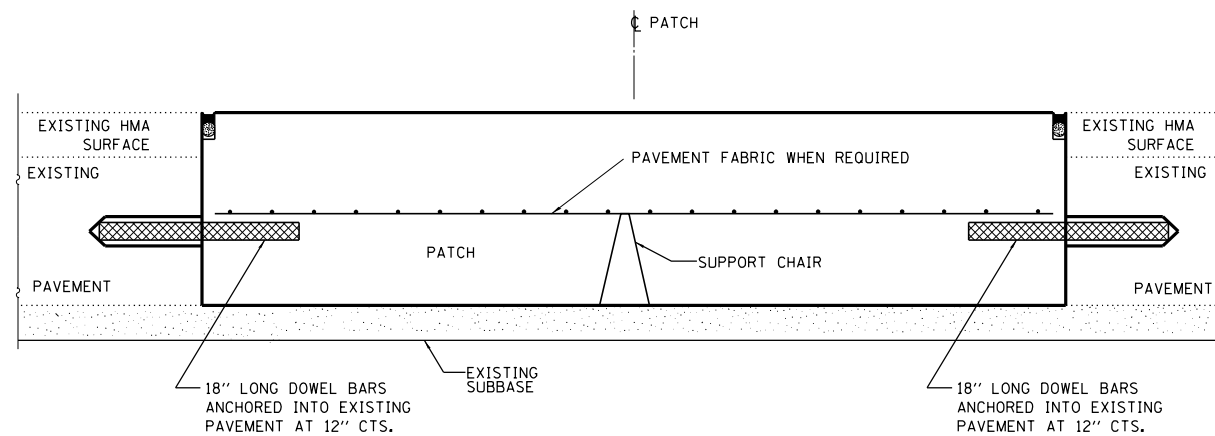

WITH HMA SURFACE

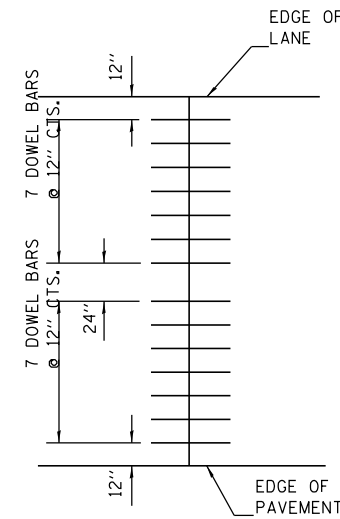

16' WIDE RAMP

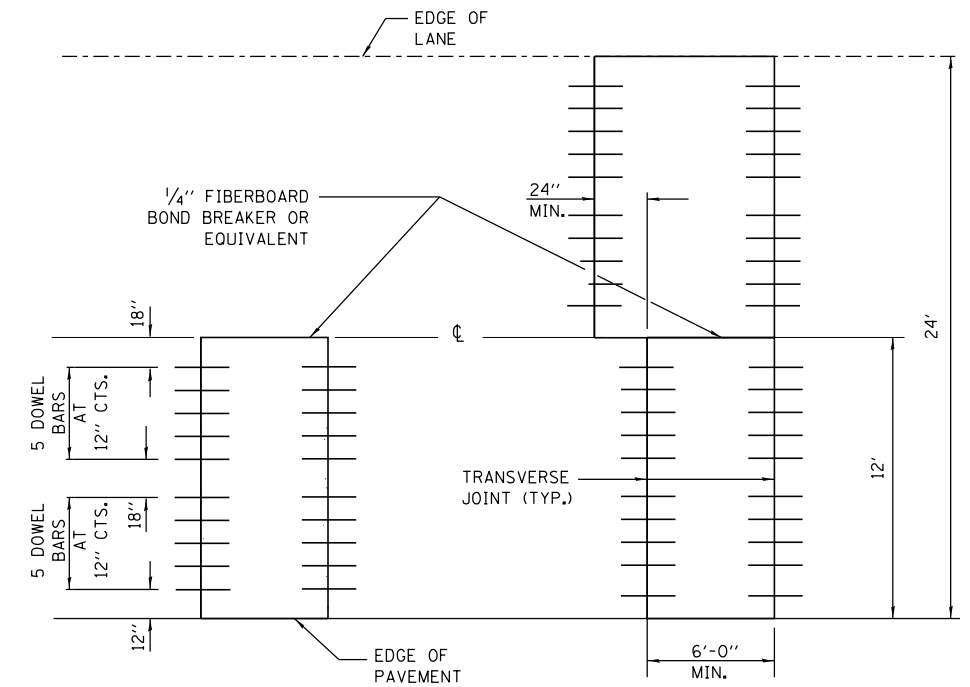

12' WIDE LANES

DOWEL BAR TABLE		
PAVEMENT THICKNESS	DOWEL BAR DIAMETER	HOLE DIAMETER
8" OR GREATER	1 1/2"	1 5/8"
7" THRU 7 5/8"	1 1/4"	1 3/8"
LESS THAN 7"	1"	1 1/8"

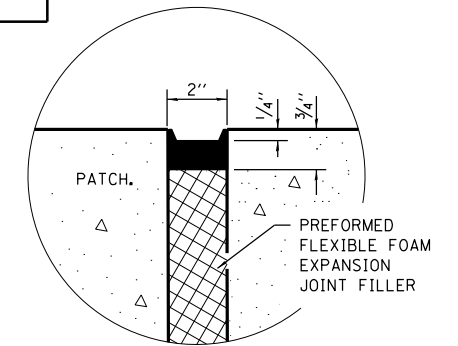

SEALING DETAIL

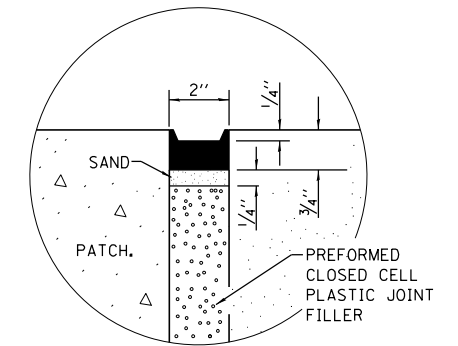

SEALING DETAIL

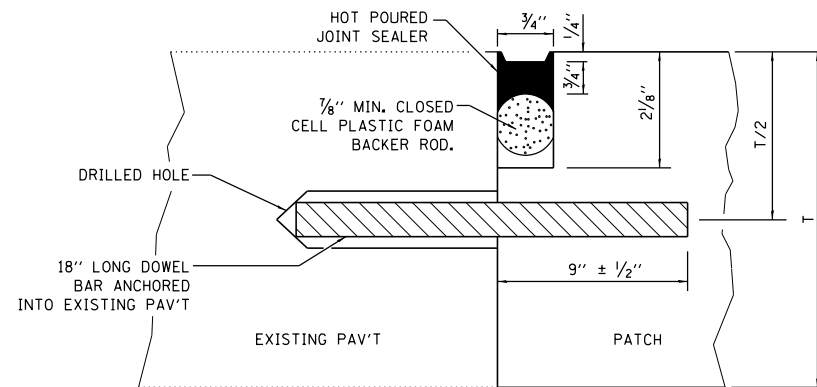

TRANSVERSE JOINT

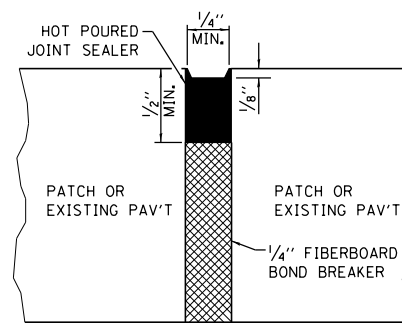

CENTERLINE JOINT

**PATCHING DETAIL FOR CLASS B PATCHING
(PCC PAVEMENT)**

FILE NAME =	USER NAME = pletschr	DESIGNED -	REVISED -
pw:\IL\084EBID\INTEG\illinois.gov\PIWIDOT\Documents\IDOT Offices\District 3\Projects\0366F36\Drawings\B366F36-shd-details.dgn		REVISED -	REVISED -
Default	PLOT SCALE = 100.0000' / in.	CHECKED -	REVISED -
	PLOT DATE = 3/24/2016	DATE -	REVISED -

**STATE OF ILLINOIS
DEPARTMENT OF TRANSPORTATION**

PAVEMENT PATCHING DETAILS

SCALE: SHEET 3 OF 3 SHEETS STA. TO STA.

F.A.I. RE.	SECTION	COUNTY	TOTAL SHEETS	SHEET NO.
55	D3 PATCHING 2017-1	LIVINGSTON	15	15
				CONTRACT NO. 66F36
ILLINOIS FED. AID PROJECT				