

STATE OF ILLINOIS
DEPARTMENT OF TRANSPORTATION
DIVISION OF HIGHWAYS

F.A.P. RTE.	SECTION	COUNTY	TOTAL SHEETS	SHEET NO.
37	(3BR)SCR	KNOX	8	1
		ILLINOIS	CONTRACT NO. 68D07	

FOR INDEX OF SHEETS, SEE SHEET NO. 2

LIST OF STANDARDS

- 000001-06
- 701001-02
- 701011-04
- 701201-04
- 701301-04

**PROPOSED
HIGHWAY PLANS**

FAP ROUTE 37(US 34)
SECTION (3BR)SCR
SCOUR MITIGATION
KNOX COUNTY

C-94-036-16

ADT = 2500 (2015)
SU = 4.0% (100)
MU = 5.2% (130)

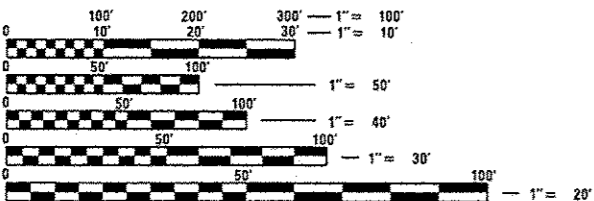

FULL SIZE PLANS HAVE BEEN PREPARED USING STANDARD ENGINEERING SCALES. REDUCED SIZED PLANS WILL NOT CONFORM TO STANDARD SCALES. IN MAKING MEASUREMENTS ON REDUCED PLANS, THE ABOVE SCALES MAY BE USED.

J.U.L.I.E.
JOINT UTILITY LOCATION INFORMATION FOR EXCAVATION
1-800-892-0123
OR 811

PROJECT ENGINEER: NICHOLAS JACK
PROJECT MANAGER: ANTONIO LOPEZ DIAZ
CATALOG NO. 035374-00D
CONTRACT NO. 68D07

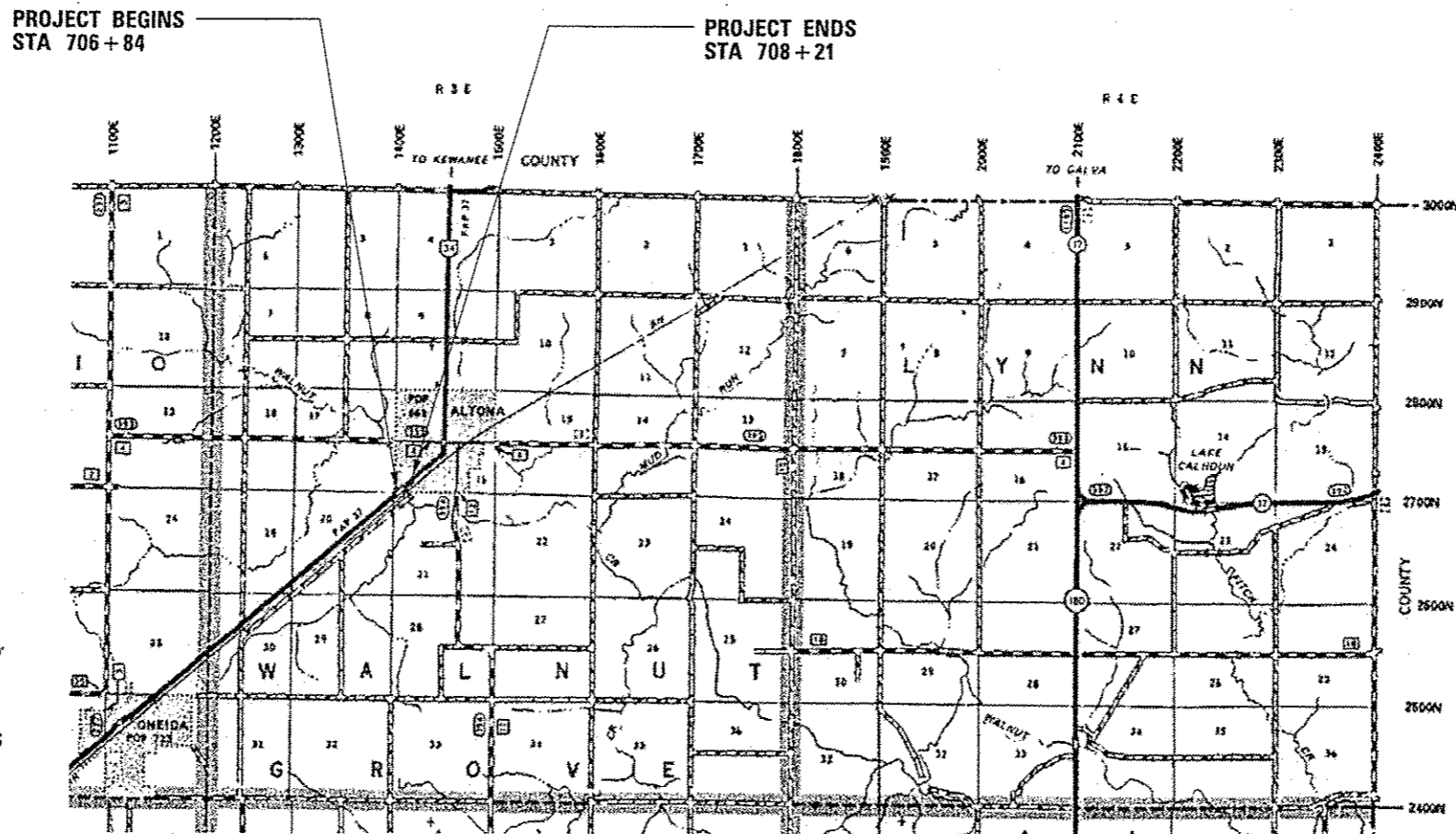

GROSS LENGTH = 137 FT. = 0.026 MILE
NET LENGTH = 137 FT. = 0.026 MILE



DESCRIPTION: SCOUR MITIGATION AT SN 048-0038 CARRYING US 34 OVER WALNUT CREEK AT SCL OF ALTONA

STATE OF ILLINOIS
DEPARTMENT OF TRANSPORTATION
DIVISION OF HIGHWAYS

SUBMITTED 3/23 20 16
Karel G. Swartz
REGION THREE ENGINEER

May 6 20 16
Maureen M. Addis, P.E.
acting ENGINEER OF DESIGN AND ENVIRONMENT

May 6 20 16
Omer Osman, P.E.
DIRECTOR OF HIGHWAYS, CHIEF ENGINEER

PRINTED BY THE AUTHORITY
OF THE STATE OF ILLINOIS

INDEX OF SHEETS

- 1. COVER SHEET
- 2. GENERAL NOTES AND PROJECT SPECIFIC NOTES
- 3. SUMMARY OF QUANTITIES
- 4. SCHEDULE OF QUANTITIES
- 5. GENERAL PLAN AND SUGGESTED SEQUENCE OF CONSTRUCTION
- 6. PROPOSED SITE PLAN
- 7-8. CROSS SECTIONS

PROJECT SPECIFIC NOTES

- 1. Plan dimensions and details relative to the existing structure (including High Water Elevation) have been taken from existing plans and are subject to nominal construction variations. It shall be the Contractor's responsibility to verify such dimensions and details in the field and make necessary approved adjustments prior to construction or ordering of materials. Such variations shall not be cause for additional compensation for a change in the scope of the work. However, the Contractor will be paid for the quantity actually furnished at the unit price bid for the work.
- 2. The Contractor shall be responsible for diverting the water flow from the construction site. The Contractor may use either method of dewatering as described in the Dewatering Special Provision.
- 3. Due to the changing nature of the streambed at the structure being protected, the cross-sections used at each structure may not be representative of existing field conditions. Layout of scour protection systems may be varied in the field to suit ground conditions as directed by the engineer.
- 4. All areas disturbed during construction shall be graded, fertilized, seeded and mulched as directed by the Engineer. Section 250 and 251 of the Standard Specifications shall govern this work.
- 5. It is anticipated that the majority of this work will not require highway traffic lane closures. Lane closures will be permitted on a limited basis and are restricted to one-lane daytime only closures in accordance to IDOT Standards 701201 and 701301.
- 6. The locations of existing water mains, gas mains, sewers, electric power lines, telephones lines and other utilities as shown on the plans are based on careful field investigation and the best information available, but they are not guaranteed. Unless elevations are shown -- all utility locations shown on the cross sections are based on the approximate depth supplied by the utility company. It shall be the Contractor's responsibility to ascertain their exact location from the utility companies and by field inspection.

GENERAL NOTES

PLAN ELEVATIONS - U.S.G.S. MEAN SEA LEVEL DATUM
All elevations shown on the plans are established from U.S.G.S. mean sea level datum.

PROPERTY OWNER ACCESS REQUIREMENT
Access must be maintained to all existing properties during construction per Article 107.09 unless arrangements are made in writing by the Contractor with the property owners with a copy to the Engineer for short-term closures.

EARTHWORK QUANTITIES (TYPICAL SECTIONS VS CROSS SECTIONS)
The earthwork quantities shown on the plans have been computed to agree with the details as shown on the typical sections and not to the limits shown on the cross sections.

FILE NAME :	USER NAME : lmggenm	DESIGNED - ALO	REVISED -	STATE OF ILLINOIS DEPARTMENT OF TRANSPORTATION	GENERAL NOTES	F.A.P. RTE.	SECTION	COUNTY	TOTAL SHEETS	SHEET NO.	
p:\1\1804EDIDINTEG\Illinois.gov\PI\001\00	Documents\DOT Offices\District 4\Projects\04	DRAWN:GAC	REVISED -			37	(38)ISCR	KNOX	8	2	
	PLOT SCALE : 40,0000 ' / in.	CHECKED -	REVISED -			CONTRACT NO. 68007					
Copy of Default	PLOT DATE : 3/16/2016	DATE -	REVISED -			ILLINOIS FED. AID PROJECT					
				SCALE:	SHEET OF SHEETS	STA.	TO STA.				

100% STATE

CONST. CODE

ROADWAY

0044

CODE NO.	ITEM	UNIT	TOTAL QUANTITY	CONST. CODE
20200100	EARTH EXCAVATION	CU YD	23.6	23.6
20300100	CHANNEL EXCAVATION	CU YD	66.6	66.6
28100107	STONE RIPRAP, CLASS A4	SO YD	261.2	261.2
28100111	STONE RIPRAP, CLASS A6	SO YD	370.6	370.6
28200200	FILTER FABRIC	SO YD	631.8	631.8
67100100	MOBILIZATION	L SUM	1	1
70100450	TRAFFIC CONTROL AND PROTECTION, STANDARD 701201	L SUM	1	1
X0301852	DEWATERING STRUCTURE NO. 1	EACH	1	1

FILE NAME * p:\N\1804EBID\INTEG\Illinois.gov\PHDOT\Do	USER NAME * lorenson	DESIGNED - ALD	REVISED -
Documents\DOT Offices\District 4\Projects\04-		CHECKED -	REVISED -
		DATE -	REVISED -
PLOT SCALE * 40,0000' / in.			
PLOT DATE * 3/16/2016			

**STATE OF ILLINOIS
DEPARTMENT OF TRANSPORTATION**

SUMMARY OF QUANTITIES

F.A.P. RTE. 37	SECTION (S)RISCR	COUNTY KNOX	TOTAL SHEETS 8	SHEET NO. 3
			CONTRACT NO. 68007	
ILLINOIS FED. AID PROJECT				

EARTH EXCAVATION	
LOCATION	VOLUME (CY)
STA 706+84 - STA 707+29 LT	23.6
TOTAL	23.6

MOBILIZATION	
LOCATION	L SUM
JOBSITE	1
TOTAL	1

STONE RIP-RAP			
LOCATION	RR CLASS A4 (SY)	RR CLASS A6 (SY)	FILTER FABRIC (SY)
STA 706+84 - 708+21 LT&RT	261.2	370.6	631.8
TOTAL	261.2	370.6	631.8

TRAFFIC CONTROL & PROTECTION STANDARD 701201	
LOCATION	L SUM
JOBSITE	1
TOTAL	1

DEWATERING STRUCTURE NO. 1	
LOCATION	EACH
WALNUT CREEK UNDER STRUCTURE	1
TOTAL	1

CHANNEL EXCAVATION			
LOCATION	AREA (SF)	LENGTH (FT)	VOLUME (CY)
STA 707+01 RT - STA 707+79 LT	27.73	35.00	35.95
	25.62	31.00	29.42
	5.66	5.75	1.21
TOTAL			66.6

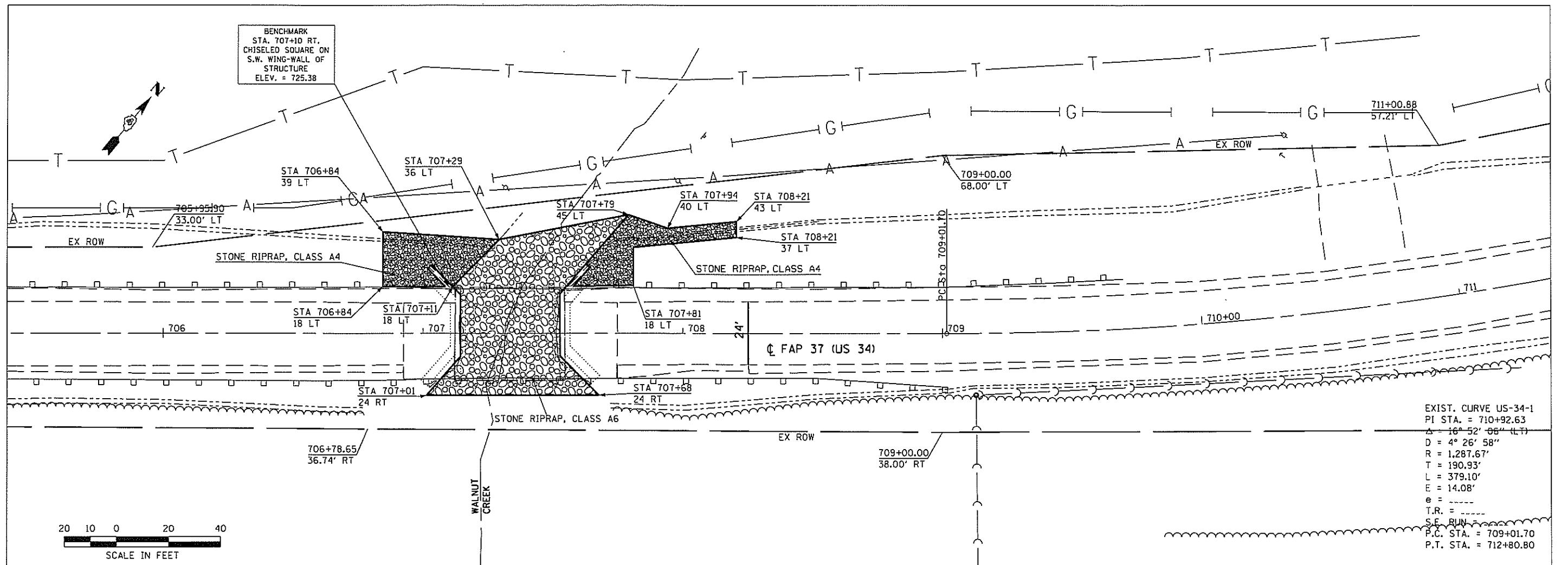



STRUCTURE NUMBER 048-0038 CONSISTS OF ONE SPAN CAST IN PLACE CONCRETE SLAB BRIDGE SUPPORTED ON A CLOSED REINFORCED CONCRETE ABUTMENT AND TWO SUPPLEMENTAL 2'x2' CONCRETE PIERS

SUGGESTED SEQUENCE OF CONSTRUCTION

1. Install dewatering system and divert water flow from the construction area.
2. Excavate to the lines, grades, contours, and dimensions shown. The prepared area shall be inspected and approved by the Engineer before further work can take place.
3. Install filter fabric on the graded surfaces as shown on the drawings.
4. Install site specific scour countermeasures. See detail sheet for specific installations procedures.
5. Remove dewatering system.
6. Grade and seed ground disturbed during construction (Cost included with Earth Excavation).

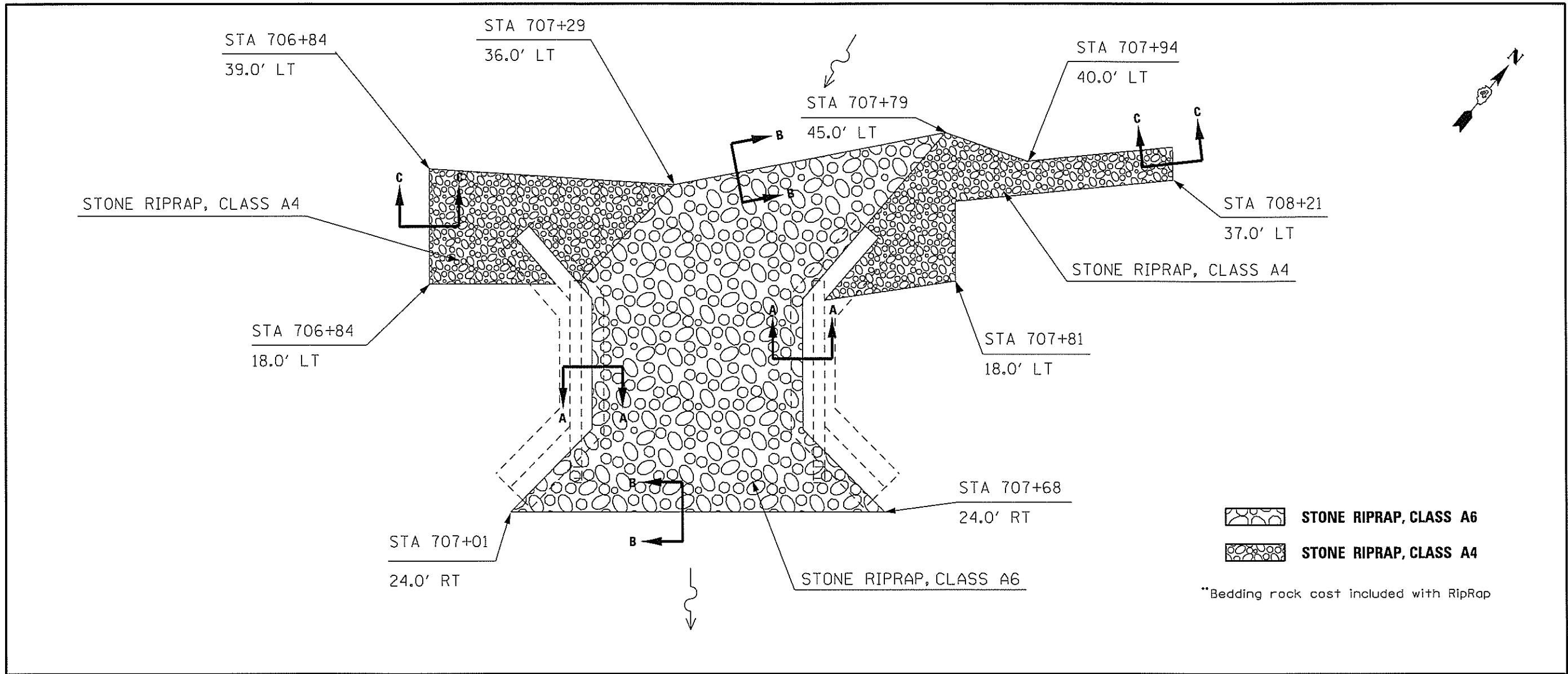
FILE NAME =	USER NAME = jengenen	DESIGNED - ALD	REVISED -	STATE OF ILLINOIS DEPARTMENT OF TRANSPORTATION	GENERAL PLAN	F.A.P. RTE.	SECTION	COUNTY	TOTAL SHEETS	SHEET NO.	
p:\11\084EB\INTEG\illinois.gov\PI\007\Documents\1007 Offices\District 4\Projects\048-0038\Drawings\CADD\048-0038-CADD.d	DRAWN Data\CADD\ALD\048-0038-CADD.d	CHECKED -	REVISED -			37	(38)R/SCR	KNOX	8	5	
PLOT SCALE = 40.0000' / in.	DATE -	REVIS	REVIS			CONTRACT NO. 68D07					
PLOT DATE = 3/16/2016	DATE -	REVIS	REVIS			[ILLINOIS] FED. AID PROJECT					

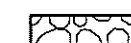

 **STONE RIPRAP, CLASS A6**
 **STONE RIPRAP, CLASS A4**

**Bedding rock cost included with RipRap

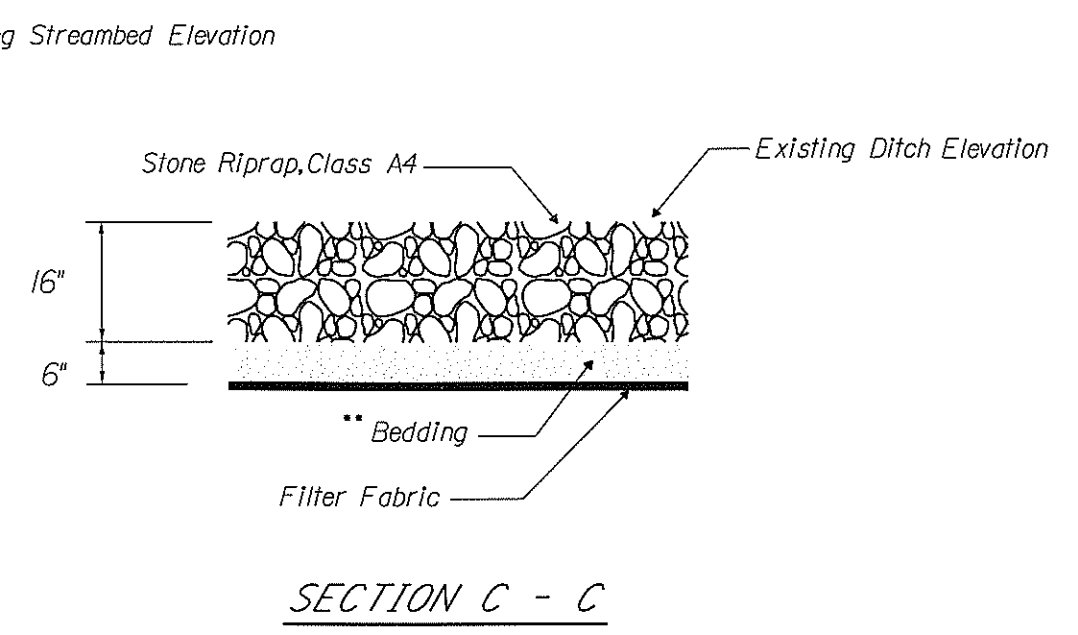
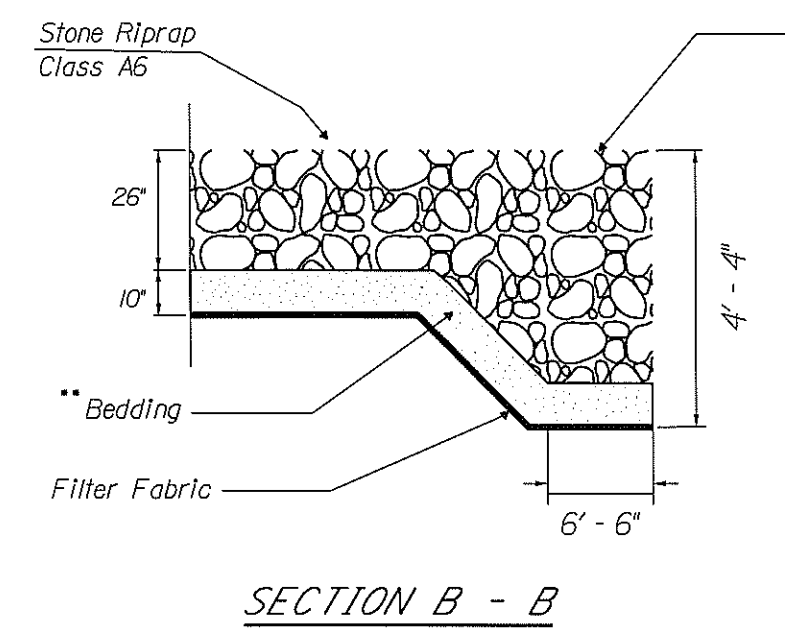
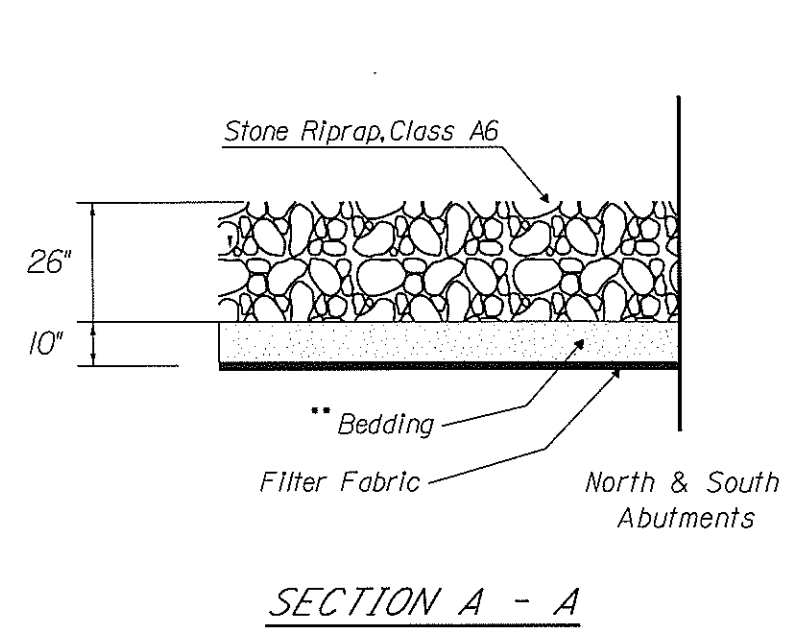

FILE NAME =	USER NAME = longanm	DESIGNED - ALD	REVISED -	STATE OF ILLINOIS DEPARTMENT OF TRANSPORTATION	RIPRAP DETAILS		F.A.P. RTE.	SECTION	COUNTY	TOTAL SHEETS	SHEET NO.	
\\11094EBIDINTEG\illinois.gov\PI00T\Documents\100T Offices\District 4\Projects\04-00-0000\04-00-0000\CADD\ALD\04-00-0000-CADD.dwg	PLotted to CAD	ALD	04-00-0000-CADD.dwg				37	(38R)SCR	KNOX	8	6	
Copy of Default	PLOT SCALE = 48,0000' / in.	CHECKED -	REVISED -		SCALE:	SHEET	OF	SHEETS	STA.	TO	STA.	CONTRACT NO. 68007
	PLOT DATE = 3/15/2016	DATE -	REVISED -									ILLINOIS FED. AID PROJECT

PLAN	DATE
BY	
NO.	
DATE	
BY	
NO.	
DATE	
BY	
NO.	
DATE	

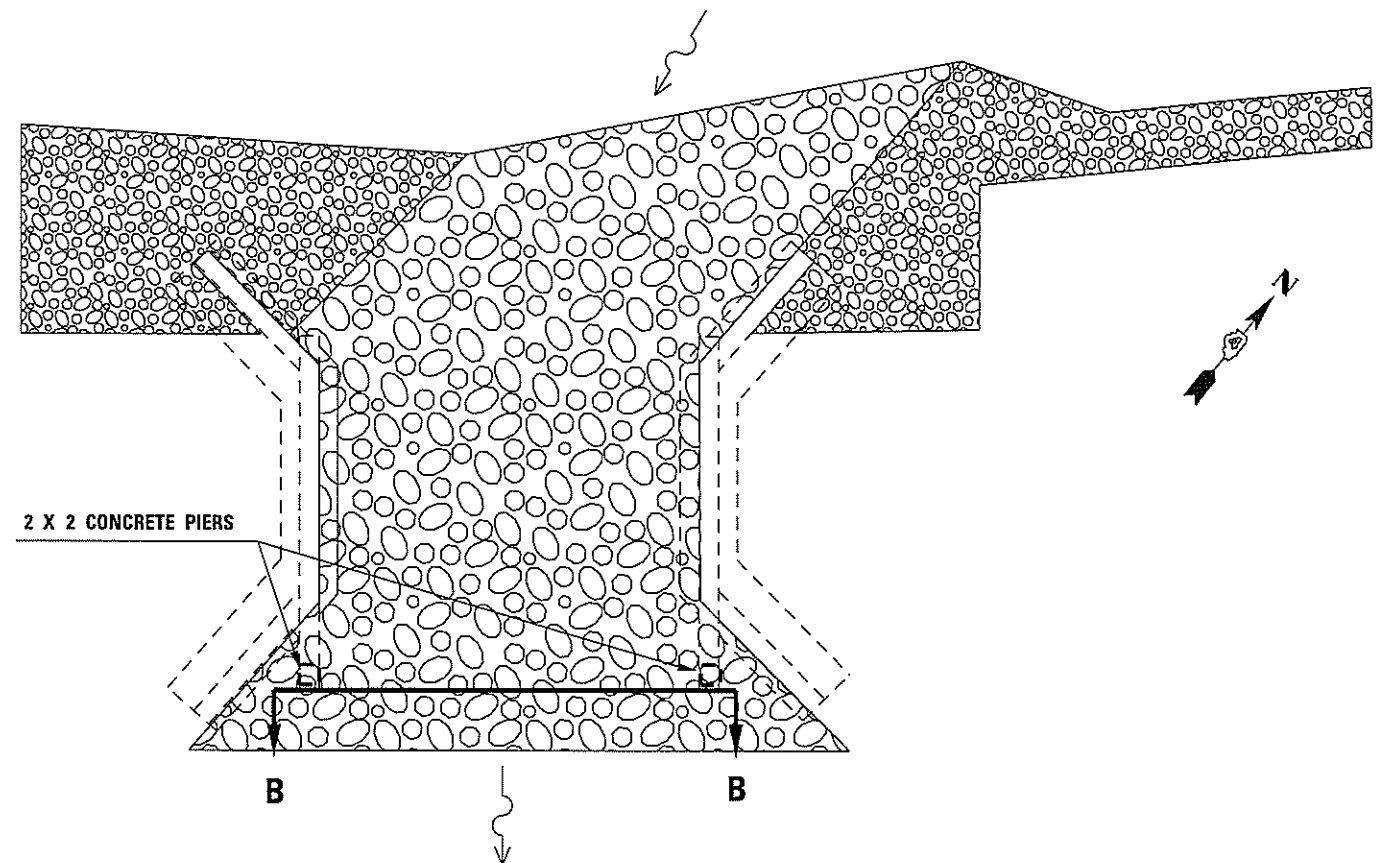
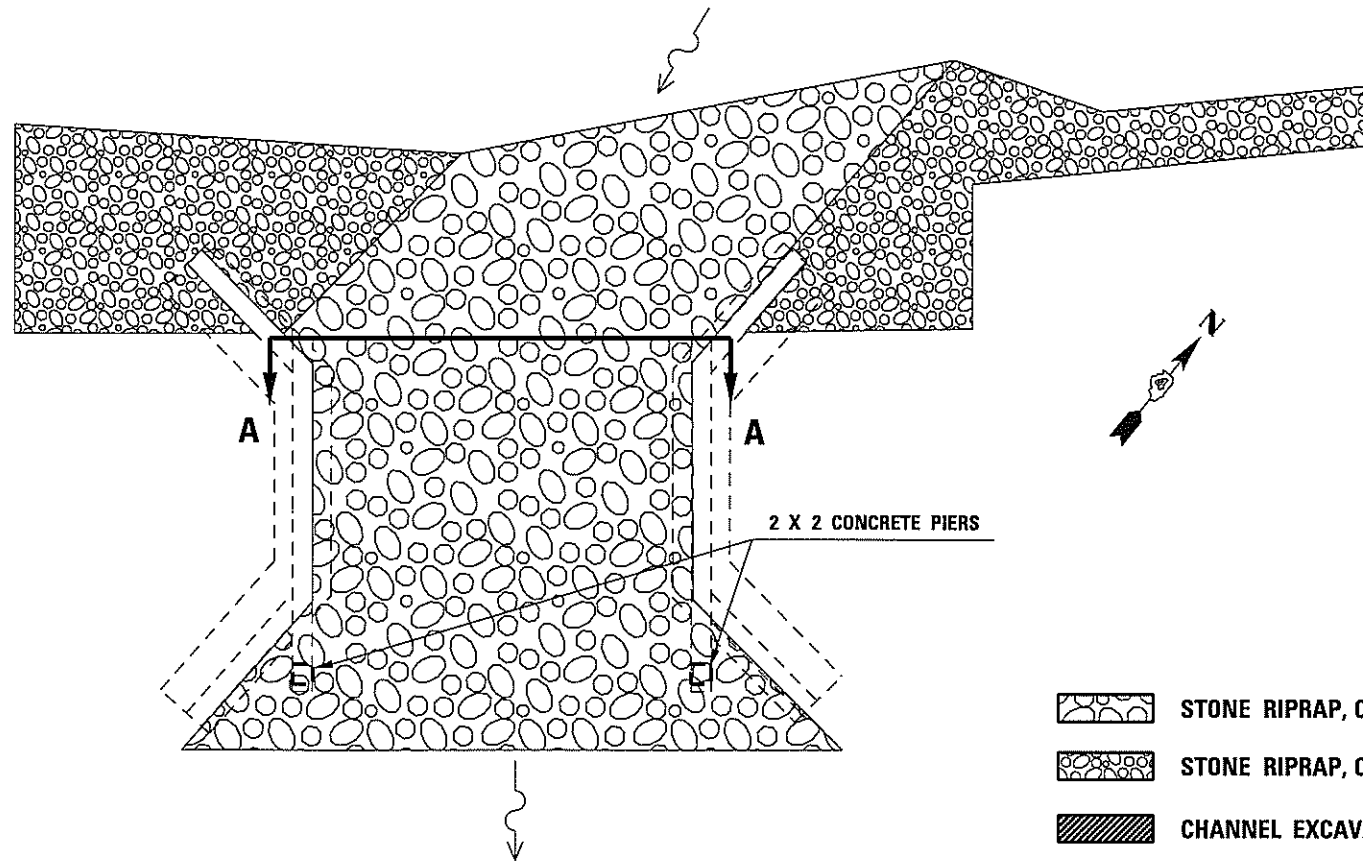

- STONE RIPRAP, CLASS A6
- STONE RIPRAP, CLASS A4
- CHANNEL EXCAVATION

PROFILE	DATE
BY	
NO.	
DATE	
BY	
NO.	
DATE	
BY	
NO.	
DATE	

SECTION A - A

SECTION B - B

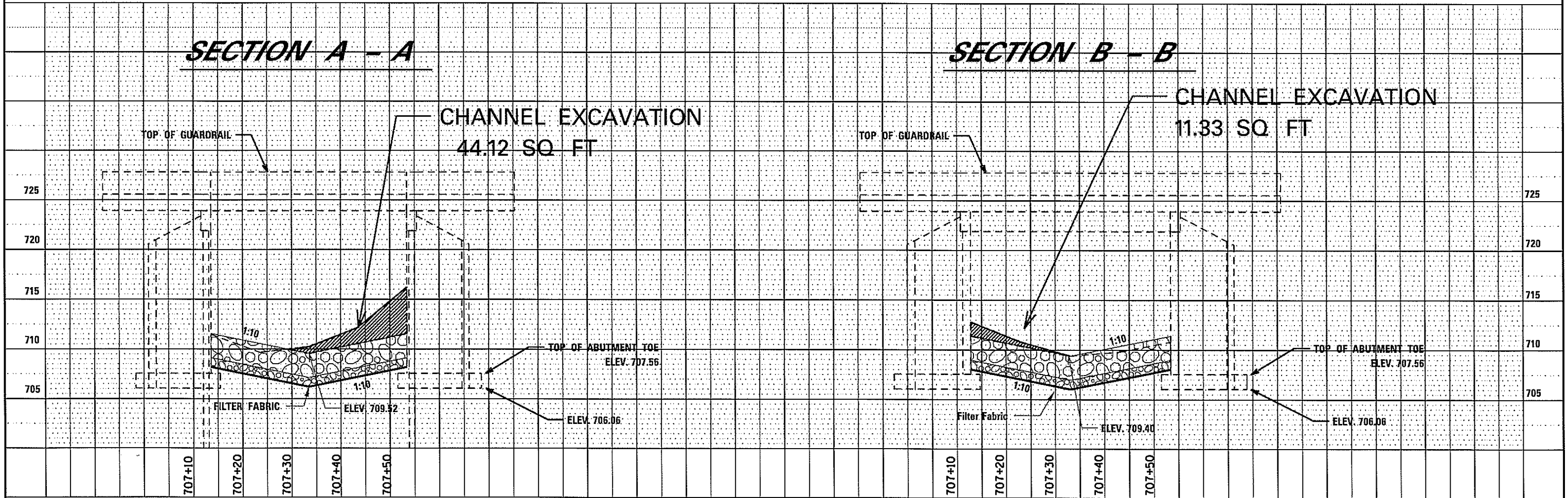



FILE NAME =	USER NAME = langanen	DESIGNED - ALD	REVISED -	STATE OF ILLINOIS DEPARTMENT OF TRANSPORTATION	CROSS SECTIONS	F.A.P. RTE.	SECTION	COUNTY	TOTAL SHEETS	SHEET NO.
pw\1084EBID\INTEG\illinois.gov\PW\DOT\Documents\DOT Offices\District 4\Projects\04_6807\Drawings\CADD\04_6807-CADD.dwg	PLDT SCALE = 48.0000' / 1"	CHECKED -	REVISED -			37	(3)BRISCR	KNOX	8	7
Copy of Default	PLDT DATE = 3/16/2015	DATE -	REVISED -			SCALE:	SHEET OF SHEETS	STA.	TO STA.	CONTRACT NO. 68007
										ILLINOIS FED. AID PROJECT

DATE _____ BY _____
 PLAN SURVEYED _____
 PLOTTED _____
 NOTE BOOK _____
 NO. _____

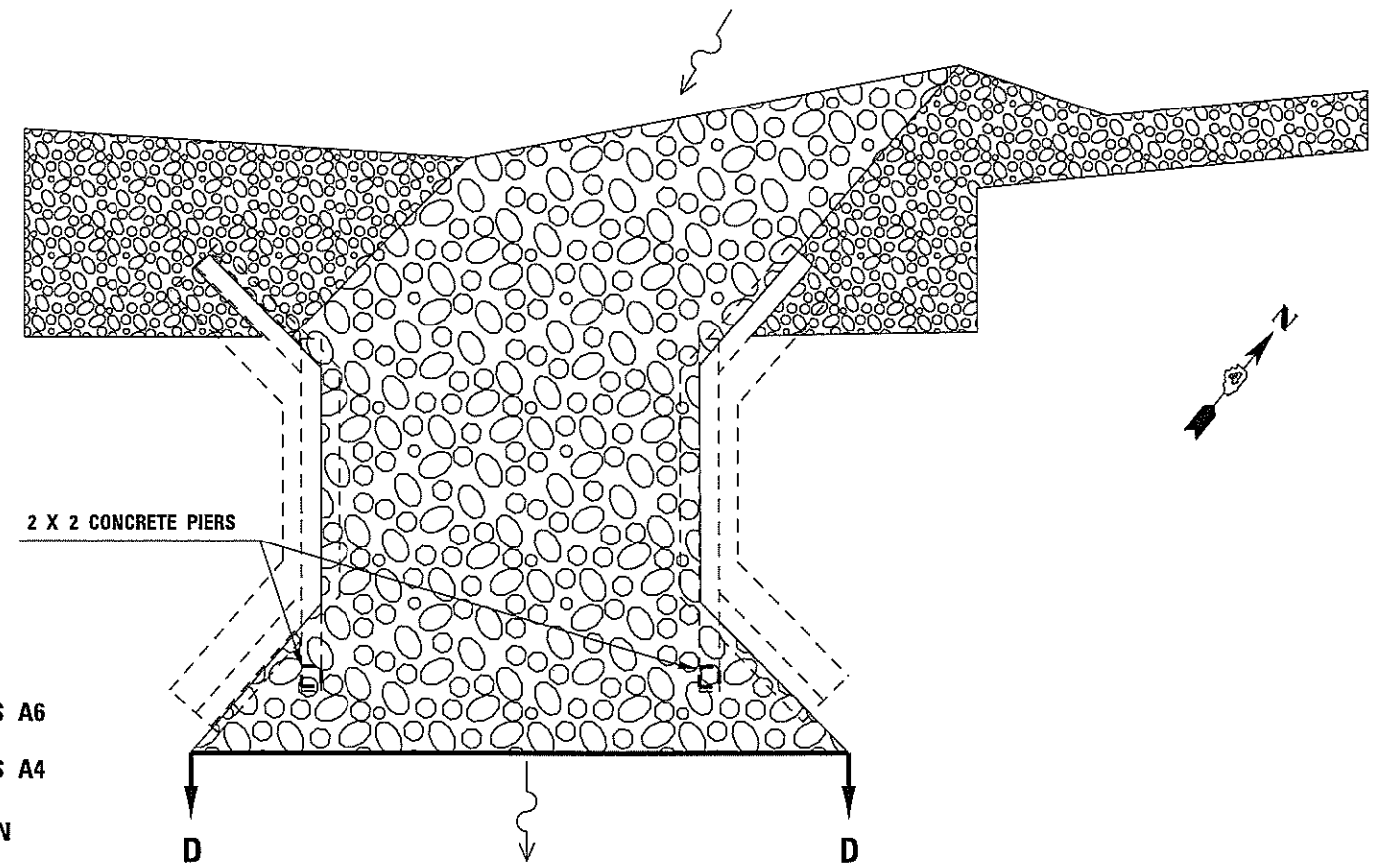
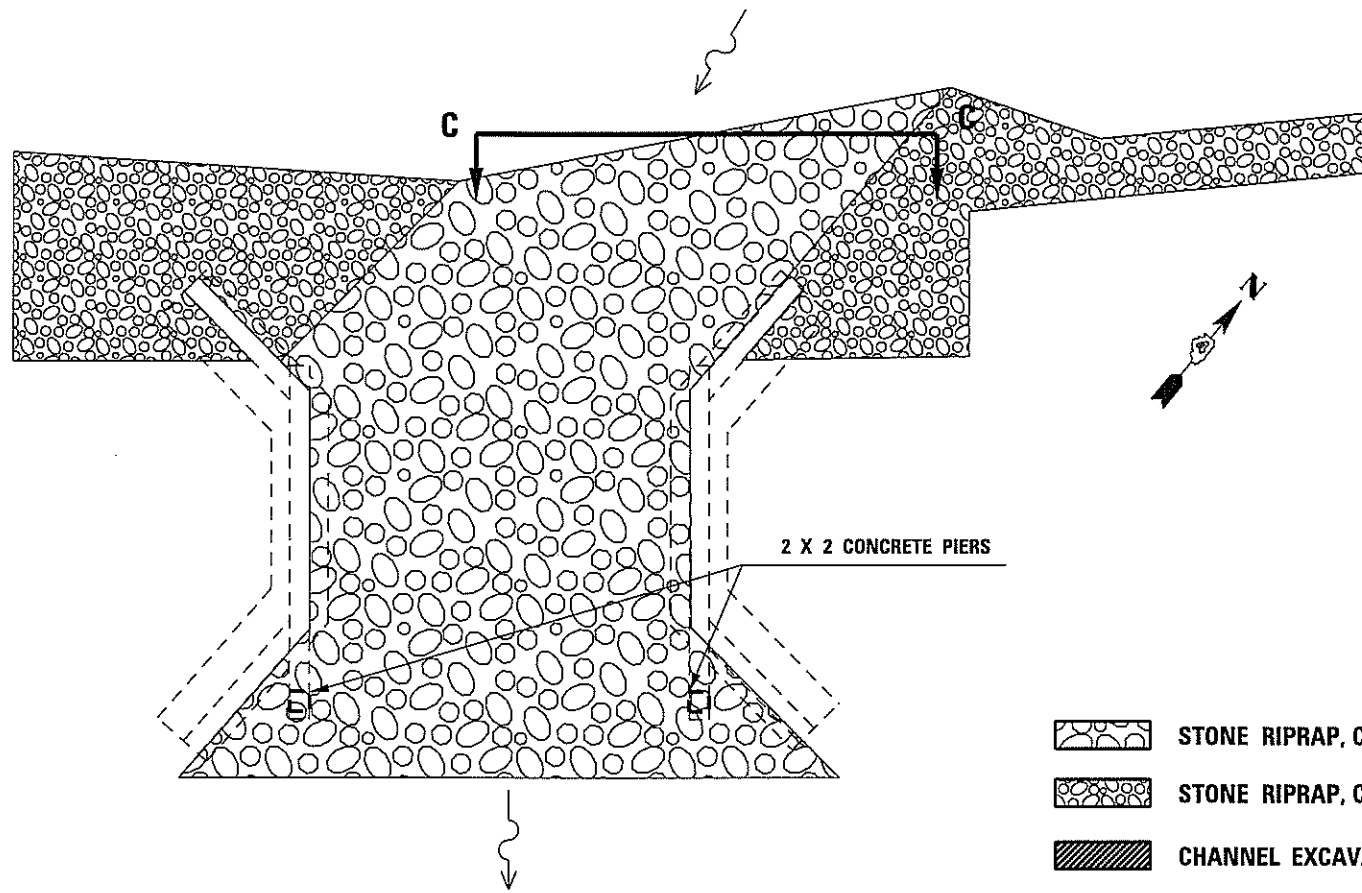
DATE _____ BY _____
 PROFILE SURVEYED _____
 PLOTTED _____
 GRADES CHECKED _____
 NO. _____



-  STONE RIPRAP, CLASS A6
-  STONE RIPRAP, CLASS A4
-  CHANNEL EXCAVATION

SECTION C - C

SECTION D - D

725	SECTION C - C										SECTION D - D										725	
720																					720	
715	CHANNEL EXCAVATION 7.13 SQ. FT.										CHANNEL EXCAVATION 0.00 SQ. FT.										715	
710																					710	
705																					705	
	707+10	707+20	707+30	707+40	707+50	707+60	707+70	707+80	707+90		707+10	707+20	707+30	707+40	707+50		707+10	707+20	707+30	707+40	707+50	

