

STATE OF ILLINOIS
 DEPARTMENT OF TRANSPORTATION
 DIVISION OF HIGHWAYS

F.A. RTE.	SECTION	COUNTY	TOTAL SHEETS	SHEET NO.
9701	12(1-2)	JACKSON	21	1
		ILLINOIS	CONTRACT NO. 78463	

FOR INDEX OF SHEETS, SEE SHEET NO. 3

**PROPOSED
 HIGHWAY PLANS**

FAU ROUTE 9701 (OLD IL 13)
 SECTION 12(1-2)

**NEW SIDEWALK AND SIGNAGE
 JACKSON COUNTY**

C-99-028-15

PROPOSED SIDEWALK, SIGNAGE
 AND LANDSCAPING

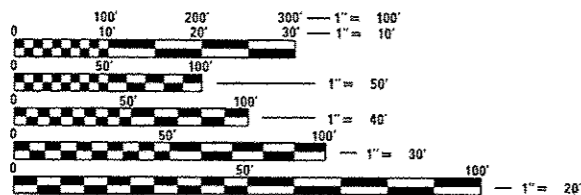
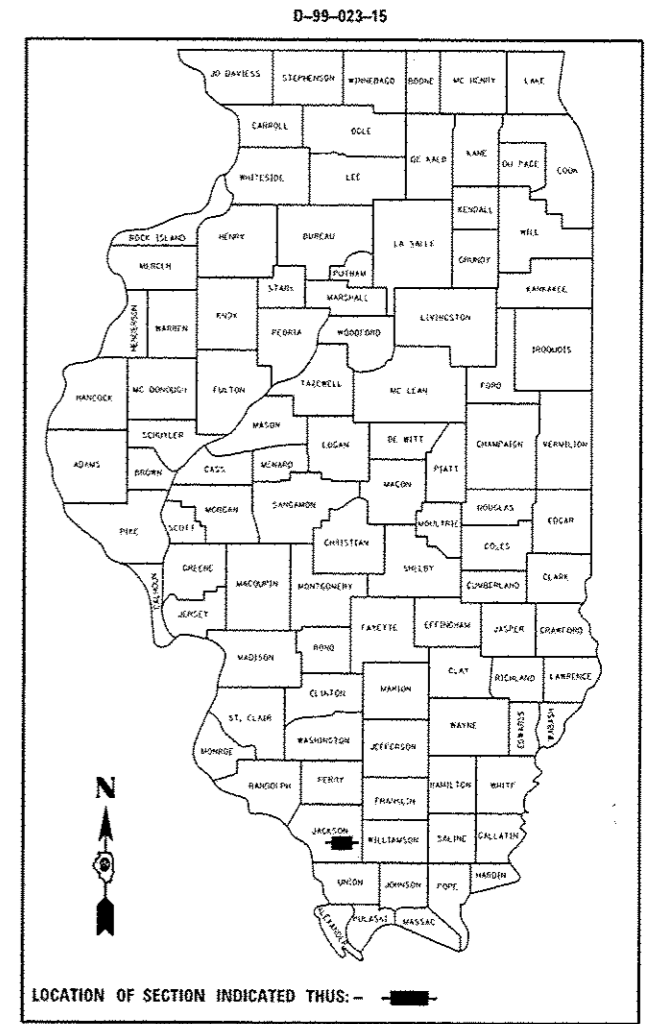

FULL SIZE PLANS HAVE BEEN PREPARED USING STANDARD ENGINEERING SCALES. REDUCED SIZED PLANS WILL NOT CONFORM TO STANDARD SCALES. IN MAKING MEASUREMENTS ON REDUCED PLANS, THE ABOVE SCALES MAY BE USED.

J.U.L.I.E.
 JOINT UTILITY LOCATION INFORMATION FOR EXCAVATION
 1-800-892-0123
 OR 811

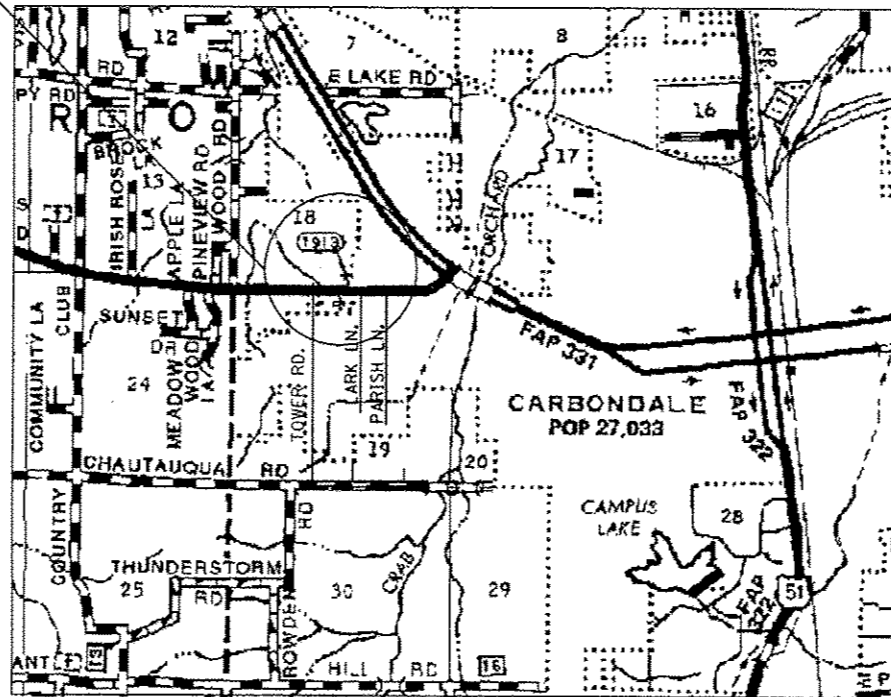

GROSS LENGTH = 927 FT. = 0.175 MILE
 NET LENGTH = 927 FT. = 0.175 MILE

PROJECT ENGINEER CHARLES STEIN
 PROJECT DESIGNER JOSEPH R. SMILEY

CONTRACT NO. 78463

STATE OF ILLINOIS
 DEPARTMENT OF TRANSPORTATION
 DIVISION OF HIGHWAYS

SUBMITTED May 17 2016
Jeffrey L. Keim
 REGION FIVE ENGINEER

May 16 2016
Matthew M. Addis
 ENGINEER OF DESIGN AND ENVIRONMENT

May 16 2016
Travis A. [Signature]
 DIRECTOR OF PROGRAM DEVELOPMENT

**PRINTED BY THE AUTHORITY
 OF THE STATE OF ILLINOIS**

SUMMARY OF QUANTITIES

COUNTY:	JACKSON
ROUTE:	FAU 9701, OLD IL 13
FUNDING:	100% STATE
LOCATION:	URBAN
TOTAL QUANTITY	SIDEWALK/SIGNAGE 0021

CODE NUMBER	ITEM DESCRIPTION	UNIT	TOTAL QUANTITY	
20100110	TREE REMOVAL (6 TO 15 UNITS DIAMETER)	UNIT	14	
20200100	EARTH EXCAVATION	CU YD	90	
20400800	FURNISHED EXCAVATION	CU YD	75	
20700220	POROUS GRANULAR EMBANKMENT	CU YD	2	
25000115	SEEDING, CLASS 1B	ACRE	0.4	
25000400	NITROGEN FERTILIZER NUTRIENT	POUND	40	
25000500	PHOSPHORUS FERTILIZER NUTRIENT	POUND	40	
25000600	POTASSIUM FERTILIZER NUTRIENT	POUND	40	
25000700	AGRICULTURAL GROUND LIMESTONE	TON	1	
42001300	PROTECTIVE COAT	SQ YD	21	
42400100	PORTLAND CEMENT CONCRETE SIDEWALK 4 INCH	SQ FT	4,308	
42400800	DETECTABLE WARNINGS	SQ FT	60	

12

SUMMARY OF QUANTITIES - CONT

COUNTY:	JACKSON
ROUTE:	FAU 9701, OLD IL 13
FUNDING:	100% STATE
LOCATION:	URBAN
TOTAL QUANTITY	SIDEWALK/SIGNAGE 0021

CODE NUMBER	ITEM DESCRIPTION	UNIT	TOTAL QUANTITY	
4400500	COMBINATION CURB AND GUTTER REMOVAL	FOOT	62	
4400600	SIDEWALK REMOVAL	SQ FT	366	
60605000	COMBINATION CONCRETE CURB AND GUTTER, TYPE B-6.24	FOOT	62	
67100100	MOBILIZATION	LSUM	1	
70102622	TRAFFIC CONTROL AND PROTECTION, STANDARD 701502	LSUM	1	
70102640	TRAFFIC CONTROL AND PROTECTION, STANDARD 701801	LSUM	1	
73400100	CONCRETE FOUNDATIONS	CU YD	0.7	
X0301115	LANDSCAPE EDGING	FOOT	96	
X0320031	SIGN LIGHTING UNIT COMPLETE	EACH	1	
X0323117	LANDSCAPING GRAVEL	SQ YD	189	
X0325541	REMOVE EXISTING LIGHTING SYSTEM	LSUM	1	
X0320032	SIGN STRUCTURE	L SUM	1	

12
*Specialty Item

SUMMARY OF QUANTITIES - CONT

COUNTY:	JACKSON
ROUTE:	FAU 9701, OLD IL 13
FUNDING:	100% STATE
LOCATION:	<i>URBAN</i>
TOTAL QUANTITY	SIDEWALK/SIGNAGE
	<i>0021</i>

CODE NUMBER	ITEM DESCRIPTION	UNIT	TOTAL QUANTITY
X0327618	LANDSCAPING, SPECIAL	LSUM	1
X7240207	REMOVE EXISTING SIGN COMPLETE	EACH	1

λ

PCC SIDEWALK, CURB AND GUTTER AND FOUNDATION SCHEDULE

LOCATION - STATION TO STATION	LENGTH	WIDTH	PCC SIDEWALK 4 INCH	SIDEWALK REMOVAL	COMB. CONC. CURB AND GUTTER, B-6.24 TY.	COMB. CURB AND GUTTER REMOVAL	CONCRETE FOUNDATIONS	PROTECTIVE COAT	DETECTABLE WARNINGS
	(FT)	(FT)	(SQ FT)	(SQ FT)	(FT)	(FT)	(CU YD)	(SQ YD)	(SQ FT)
PROP. SIDEWALK TANGENT LINE: STA. 0+00 TO STA. 9+27									
0+00 TO 3+17	317	5.0	1585						
0+00 TO 0+28	28	6.0		171					10
3+17					11	11		3.3	10
3+89					11	11		3.3	10
3+89 TO 7+00	311	5.0	1555						
4+55							0.60	2.2	
7+00					26	26		7.8	10
7+48					7	7		2.1	10
7+48 TO 9+27	179	5.0	895						
9+27					7	7		2.1	10
IN FRONT OF OFFICE BUILDING									
EXIST. 3' SIDEWALK	50	3.0	150	150					
EXIST. 3' SIDEWALK	15	3.0	45	45					
NORTH OF WEST PARKING LOT									
PICNIC TABLE PAD	8	6.0	48						
PICNIC TABLE ACCESS SIDEWALK	10	3.0	30						
TOTALS			4,308	366	62	62	0.60	21	60

LANDSCAPING SCHEDULE

LOCATION - STATION TO STATION				LANDSCAPING GRAVEL	LANDSCAPE EDGING	POROUS GRANULAR EMBANKMENT	TREE REMOVAL (6 TO 15 UNITS DIA.)	REMARKS
				CU YD	FOOT	CU YD	UNIT	
FRONT YARD OF DIST. NINE OFFICE								EAST BED
RT	5+55				18	1		EAST BED
RT	5+37	TO	5+55		18			EAST BED
RT	4+68	TO	5+55	117				EAST BED
RT	4+52	TO	4+64	21	60	1		SIGN
RT	3+73	TO	4+43	51				WEST BED
RT	3+02						14	
TOTALS				189	96	2	14	

PLAN	SURVEYED	DATE
	PLOTTED	
	NOTE BOOK	
	NO. _____	
	ALIGNED	
	CHECKED	
	FILE NAME	

PROFILE	SURVEYED	DATE
	PLOTTED	
	GRADES CHECKED	
	NO. _____	
	STRUCTURE	
	NOTATION	

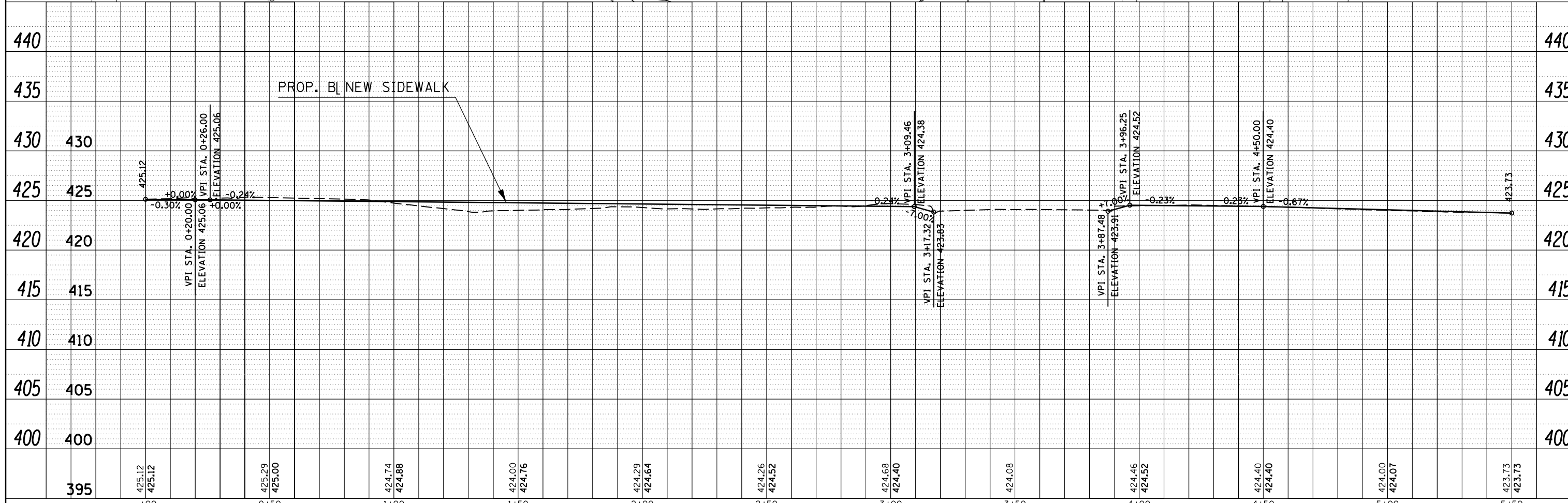
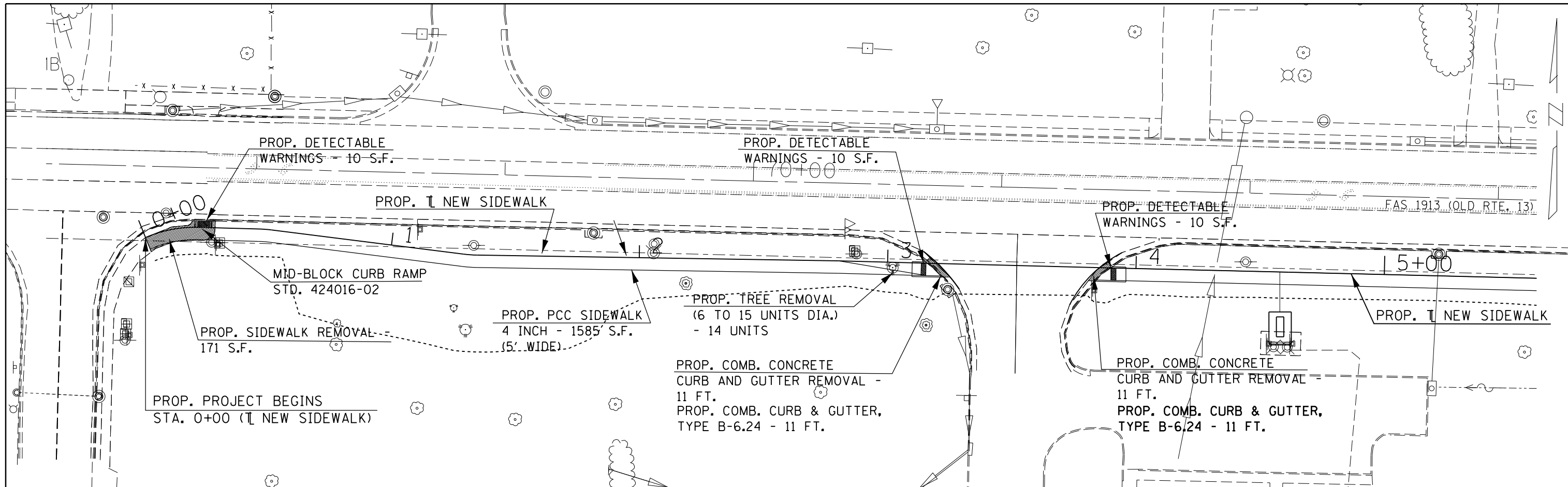

FILE NAME =	USER NAME = smileyjr	DESIGNED -	REVISED -	STATE OF ILLINOIS DEPARTMENT OF TRANSPORTATION	PLAN AND PROFILE STA. 0 + 00 TO STA. 5 + 50	F.A.U. RTE.	SECTION	COUNTY	TOTAL SHEETS	SHEET NO.	
Default	PLOT SCALE = 40.0000' / in.	CHECKED -	REVISED -			9701	12(1-2)	JACKSON	21	9	
	PLOT DATE = 4/1/2016	DATE -	REVISED -			CONTRACT NO. 78463					
						ILLINOIS FED. AID PROJECT					

PLAN	SURVEYED	DATE
	PLOTTED	
	ALIGNED	
	CHECKED	
	FILED	
	NO.	
	NO.	

PROFILE	SURVEYED	DATE
	PLOTTED	
	GRADES	
	CHECKED	
	STRUCTURE	
	NOTATIONS	
	CHKD	
	NO.	

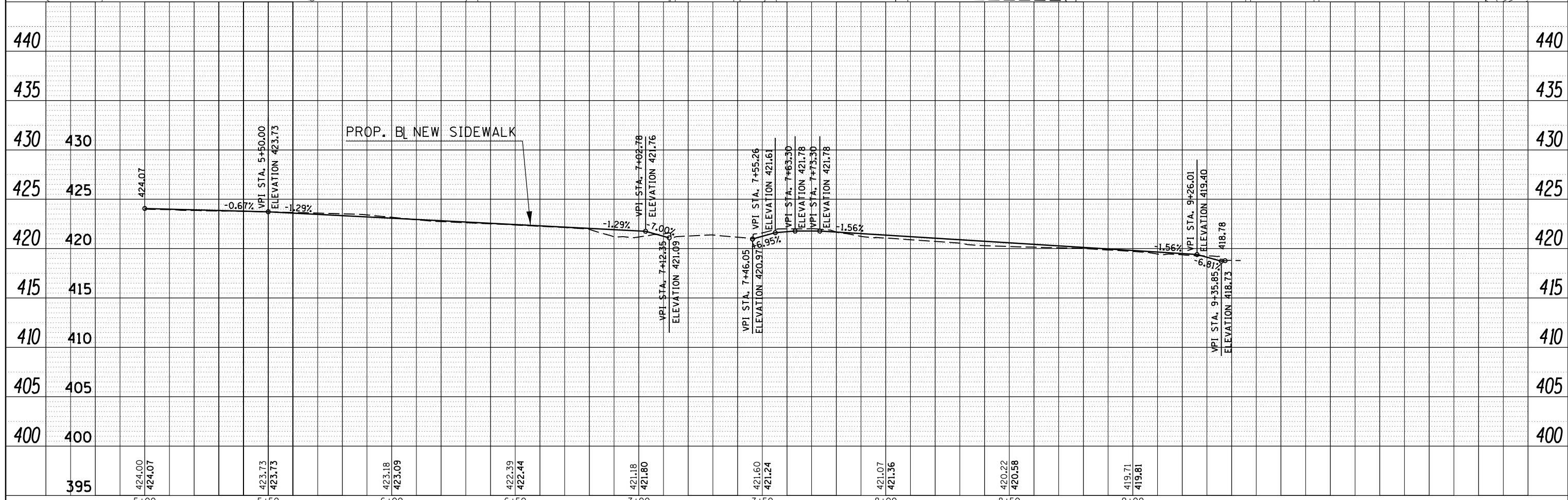
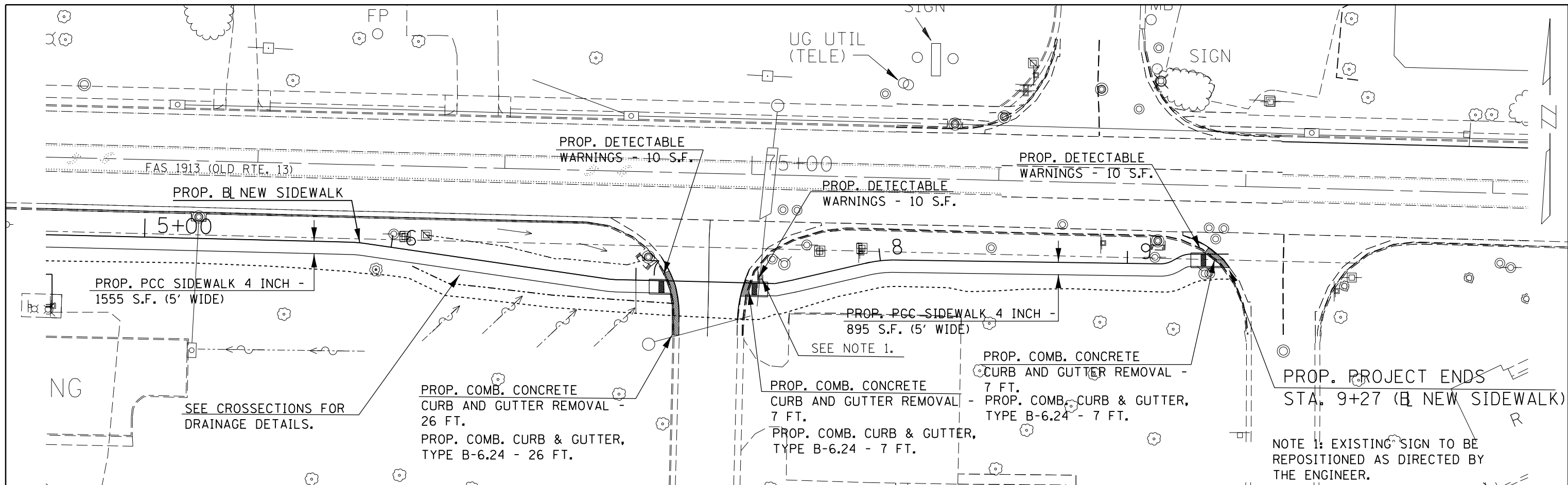

FILE NAME =	USER NAME = smileyjr	DESIGNED -	REVISED -	STATE OF ILLINOIS DEPARTMENT OF TRANSPORTATION	PLAN AND PROFILE STA. 5+50 TO STA. 9+27.22	F.A.U. RTE.	SECTION	COUNTY	TOTAL SHEETS	SHEET NO.	
Default		CHECKED -	REVISED -			9701	12(1-2)	JACKSON	21	10	
		DATE -	REVISED -			CONTRACT NO. 78463					
						ILLINOIS FED. AID PROJECT					

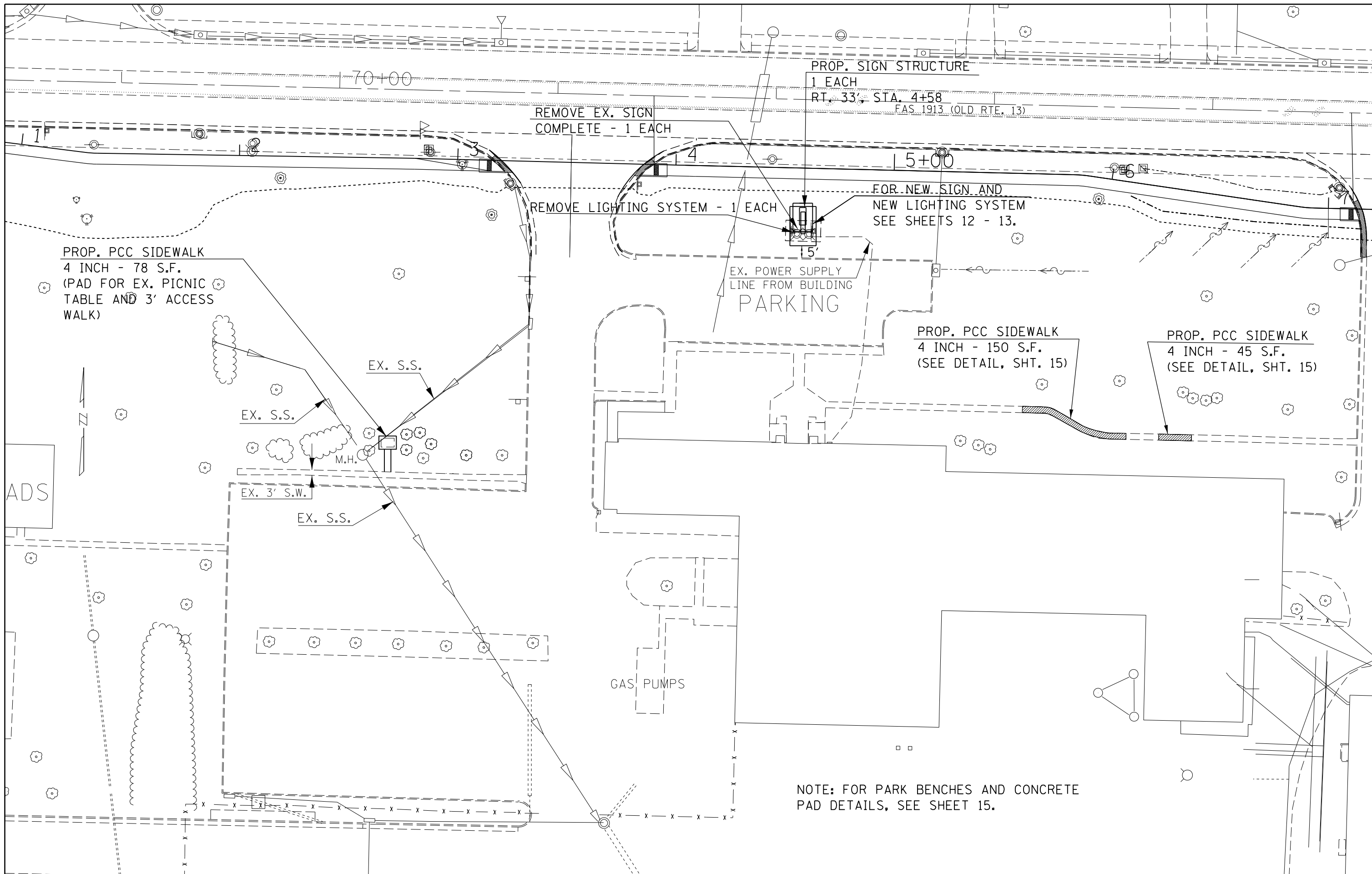

FILE NAME =	USER NAME = smileyjr	DESIGNED -	REVISED -
p:\11\084EBIDINTEG.illinois.gov\PIWIDOT\Documents\IDOT Offices\District 9\Projects\78463\Drawings\CAD\Sheets\78463-planprf.dgn		DRAWN -	REVISED -
PLOT SCALE = 40.0000' / in.	CHECKED -	REVISED -	REVISED -
Default	DATE -	REVISED -	REVISED -

**STATE OF ILLINOIS
DEPARTMENT OF TRANSPORTATION**

**PLAN LAYOUT - REPAIR OF EXIST.
OFFICE SIDEWALK AND PARK BENCH LOCATIONS**

SCALE: SHEET OF SHEETS STA. TO STA.

F.A.U. RTE.	SECTION	COUNTY	TOTAL SHEETS	SHEET NO.
9701	12(1-2)	JACKSON	21	11
CONTRACT NO. 78463				
ILLINOIS FED. AID PROJECT				

PROPOSED SIGN STRUCTURE

FOR IDOT LOGO INFORMATION,
SEE NOTE 2.

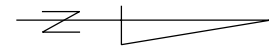

PROP. BRUSHED,
STAINLESS STEEL
SURFACE MOUNTED
BASE - 2 EACH
(SEE SPEC. PROV.)

FRONT VIEW

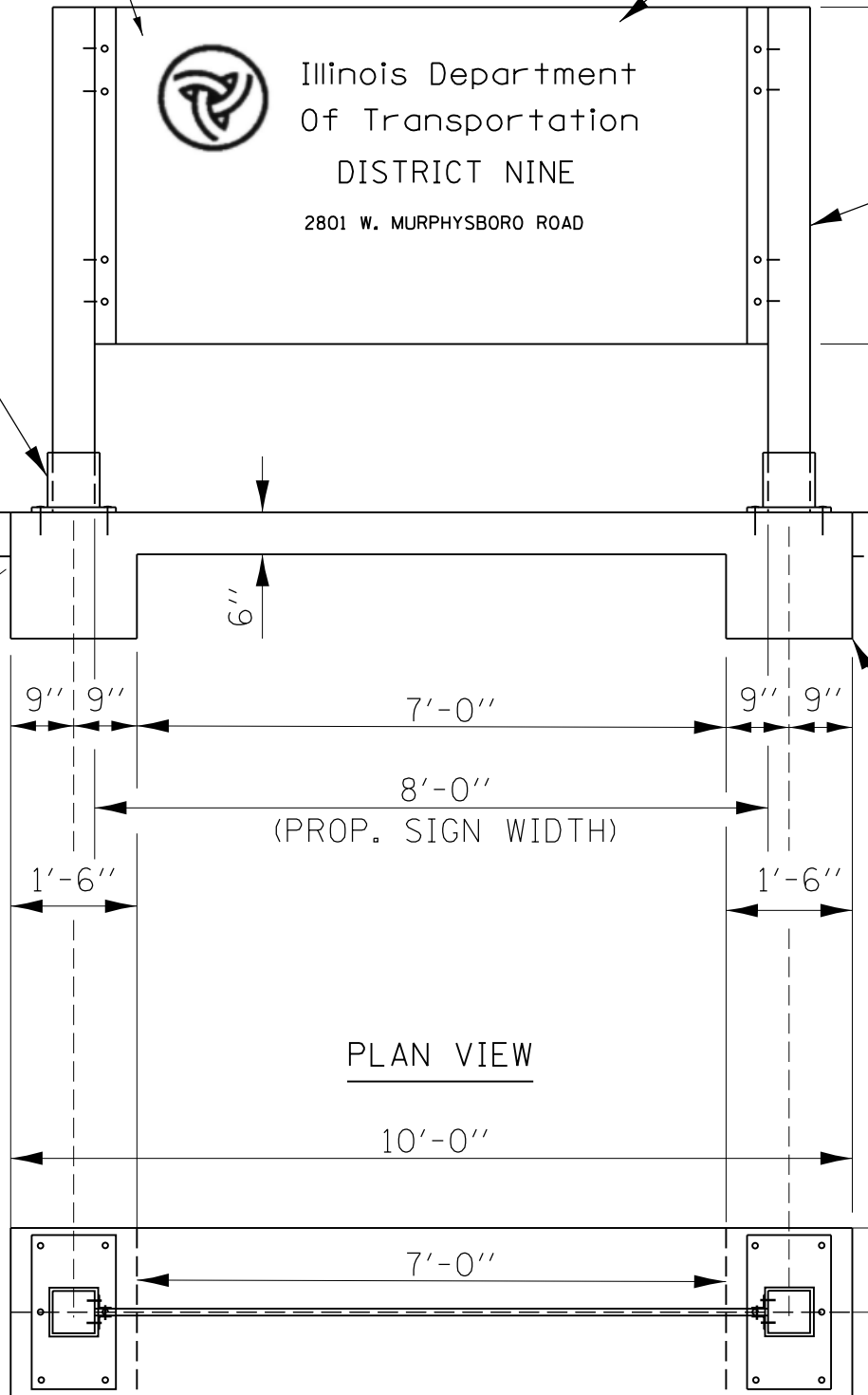

PROP. POLYETHYLENE SIGN
WITH ENGRAVED LETTERING
ON BOTH SIDES (4'X8')
- 1 EACH (SEE NOTE 1.)

END VIEW

PROP. BRUSHED, STAINLESS
STEEL METAL POSTS,
6"X6"X6' - 2 EACH (SEE
SPEC. PROV.)

PROP. BRUSHED,
STAINLESS STEEL
SURFACE MOUNTED
BASE - 2 EACH
(SEE SPEC. PROV.)

EXISTING
GROUNDLINE

EXISTING
GROUNDLINE

PLAN VIEW

PROP. CONCRETE FOUNDATIONS -
0.7 CU. YD. (TO BE CONSTRUCTED
ACCORDING TO ART. 734.03(C) IN
THE STANDARD SPEC. FOR ROAD
AND BRIDGE CONSTRUCTION)

NOTE 1: ALL WORK AND MATERIAL FOR INSTALLING THE SIGN, SIGN POSTS, POST SURFACE MOUNTED BASES AND LETTERING ON SIGN SHALL BE PAID FOR AT THE CONTRACT UNIT PRICE PER LUMP SUM FOR SIGN STRUCTURE. (SEE SPECIAL PROVISIONS).

NOTE 2: ILLINOIS DEPARTMENT OF TRANSPORTATION LOGO AND LETTERING SHALL BE DONE ACCORDING TO IDOT POLICIES AND STANDARDIZATION. FOR VENDOR INFORMATION, CONTACT JASON GOULD AT (217) 782-4952. (SEE SPECIAL PROVISIONS).

FILE NAME =	USER NAME = smileyjr	DESIGNED -	REVISED -	STATE OF ILLINOIS DEPARTMENT OF TRANSPORTATION	PROPOSED SIGN STRUCTURE			F.A.U. RTE.	SECTION	COUNTY	TOTAL SHEETS	SHEET NO.
pw:\IL\084EBIDINTEG\Illinois.gov\PIDOT\Documents\IDOT Offices\District 9\Projects\78463\Drawings\CABsheets\78463-planpr.dgn		CHECKED -	REVISED -		RT. STA. 4 + 58			9701	12(1-2)	JACKSON	21	12
Default	PLOT SCALE = 40.0000' / in.	DATE -	REVISED -		SCALE: SHEET OF SHEETS STA. TO STA.			CONTRACT NO. 78463				
	PLOT DATE = 4/1/2016							ILLINOIS FED. AID PROJECT				

PROPOSED SIGN LIGHTING UNIT COMPLETE

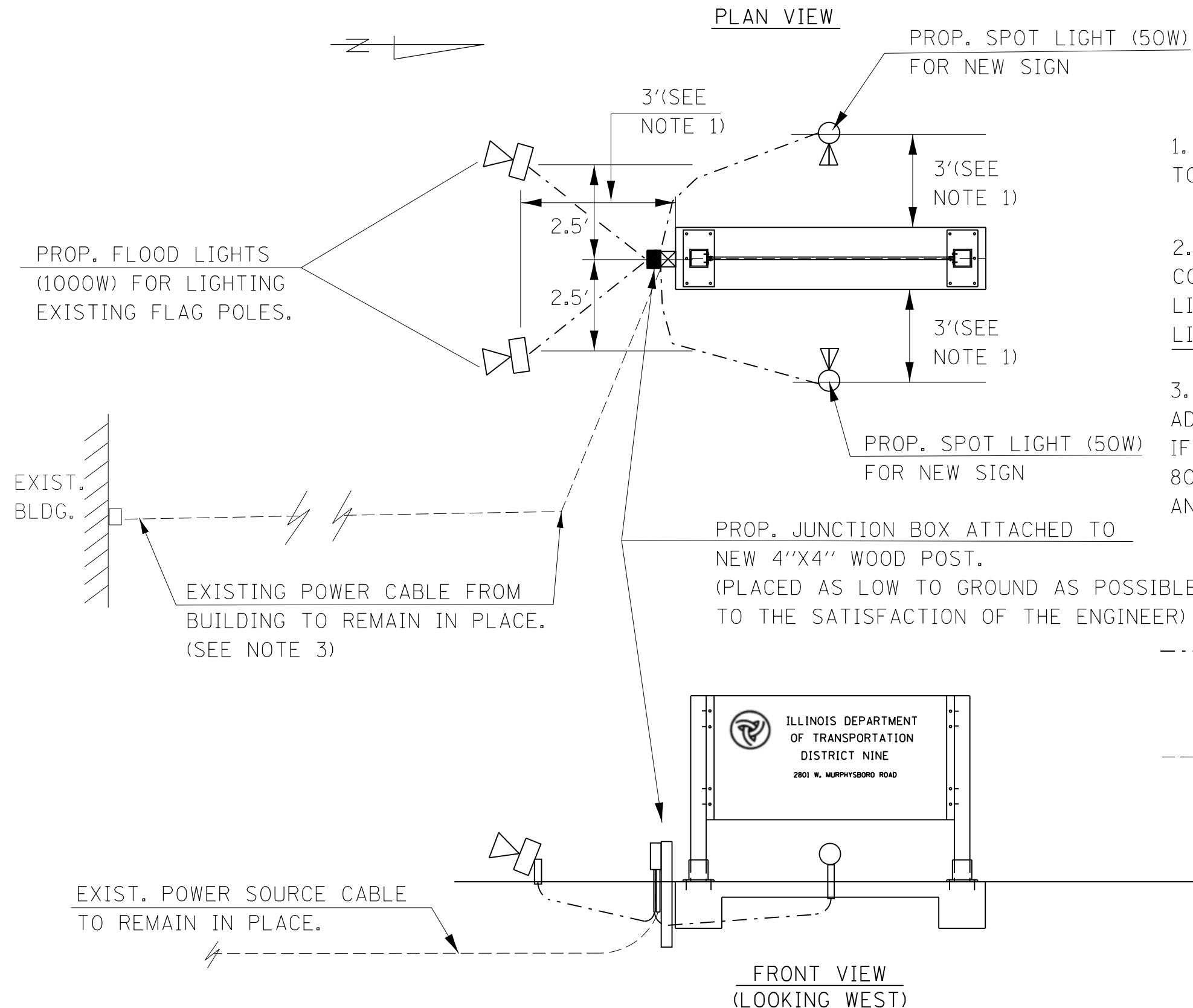

NOTES

1. ALL LIGHT FIXTURES AND JUNCTION BOX TO BE LOCATED AS DIRECTED BY THE ENGINEER.
2. ALL LUMINAIRES, JUNCTION BOX, ELECTRIC CABLES, CONDUITS, HARDWARE AND WORK TO INSTALL PROPOSED LIGHTING SYSTEM SHALL BE COVERED UNDER SIGN LIGHTING UNIT COMPLETE.
3. AN EQUIPMENT GROUND CONDUCTOR (EGC) SHALL BE ADDED TO THE NEW LIGHTING SYSTEM ELECTRICAL FEED IF ONE IS NOT ALREADY ATTACHED AS PER ARTICLE 801.04 OF THE STANDARD SPECIFICATIONS FOR ROAD AND BRIDGE CONSTRUCTION.

LEGEND

- PROPOSED UNIT DUCT AND WIRING NO. 8 AWG
- EXISTING ELECTRICAL POWER TO SIGN LIGHTING (TO REMAIN IN PLACE)

FILE NAME =	USER NAME = smileyjr	DESIGNED -	REVISED -	STATE OF ILLINOIS DEPARTMENT OF TRANSPORTATION	PROPOSED LIGHTING FOR NEW OFFICE SIGN - RT. STA. 4 + 58	F.A.U. RTE.	SECTION	COUNTY	TOTAL SHEETS	SHEET NO.	
pw:\IL\084EBIDINTEG\illinois.gov\PIDOT\Documents\IDOT Offices\District 9\Projects\78463\Drawings\CABsheets\78463-planprf.dgn		REVISION	REVISION			9701	12(1-2)	JACKSON	21	13	
Default	PLOT SCALE = 40.0000' / in.	CHECKED -	REVISION			CONTRACT NO. 78463					
	PLOT DATE = 4/1/2016	DATE -	REVISION			ILLINOIS FED. AID PROJECT					

PROPOSED SIGN LANDSCAPING DETAIL

EAST SIGN FACE
(LOOKING WEST)

SOUTH END
(LOOKING NORTH)

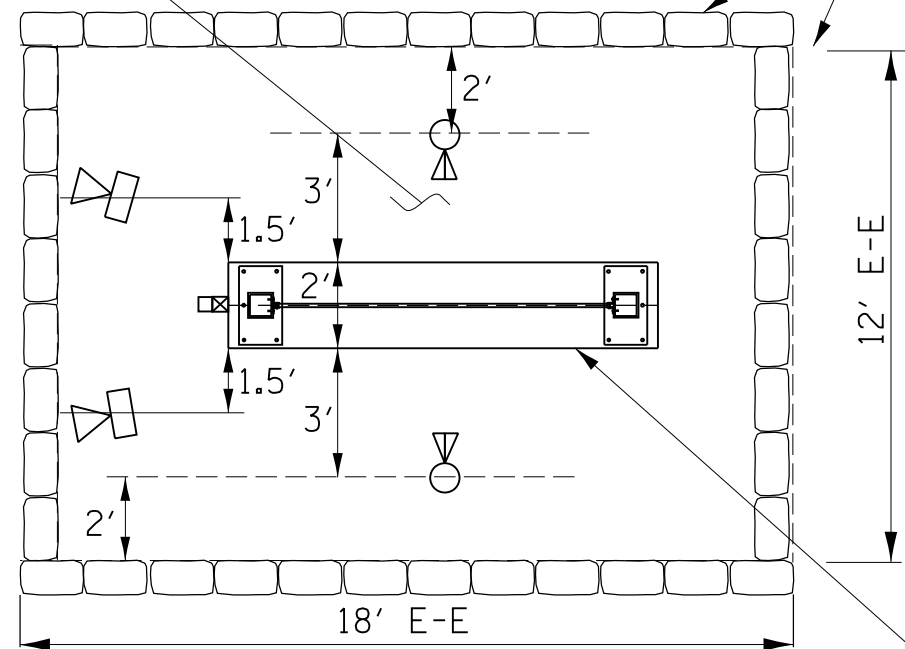
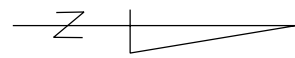
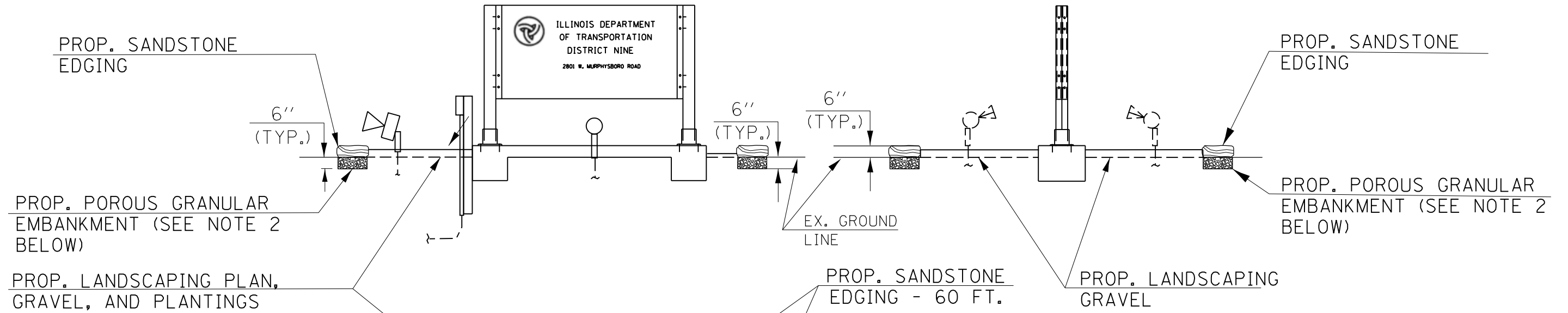

PLAN VIEW

NOTES

1. SIGN STRUCTURE TO BE CENTERED IN LANDSCAPE EDGING ENCLOSURE
2. THE POROUS GRANULAR EMBANKMENT TO BE USED UNDER THE SANDSTONE EDGERS SHALL BE CA10 AGGREGATE.

PROP. SIGN STRUCTURE -
1 LUMP SUM (SEE SPEC.
PROV. AND DETAIL SHT. 12).

FILE NAME =	USER NAME = smileyjr	DESIGNED -	REVISED -	STATE OF ILLINOIS DEPARTMENT OF TRANSPORTATION	PROPOSED LANDSCAPING FOR NEW OFFICE SIGN - RT. 4+58	F.A.U. RTE.	SECTION	COUNTY	TOTAL SHEETS	SHEET NO.	
pw:\IL\084EBIDINTEG.illinois.gov\PWIDOT\Documents\IDOT Offices\District 9\Projects\78463\Drawings\CADsheets\78463-planprf.dgn		CHECKED -	REVISED -			9701	12(1-2)	JACKSON	21	14	
Default	PLOT SCALE = 40.0000' / in.	DATE -	REVISED -			CONTRACT NO. 79463			ILLINOIS FED. AID PROJECT		
	PLOT DATE = 4/1/2016					SCALE:	SHEET	OF	SHEETS	STA.	TO

**DETAIL OF PROP. PICNIC TABLE
AND PARK BENCH AREA**

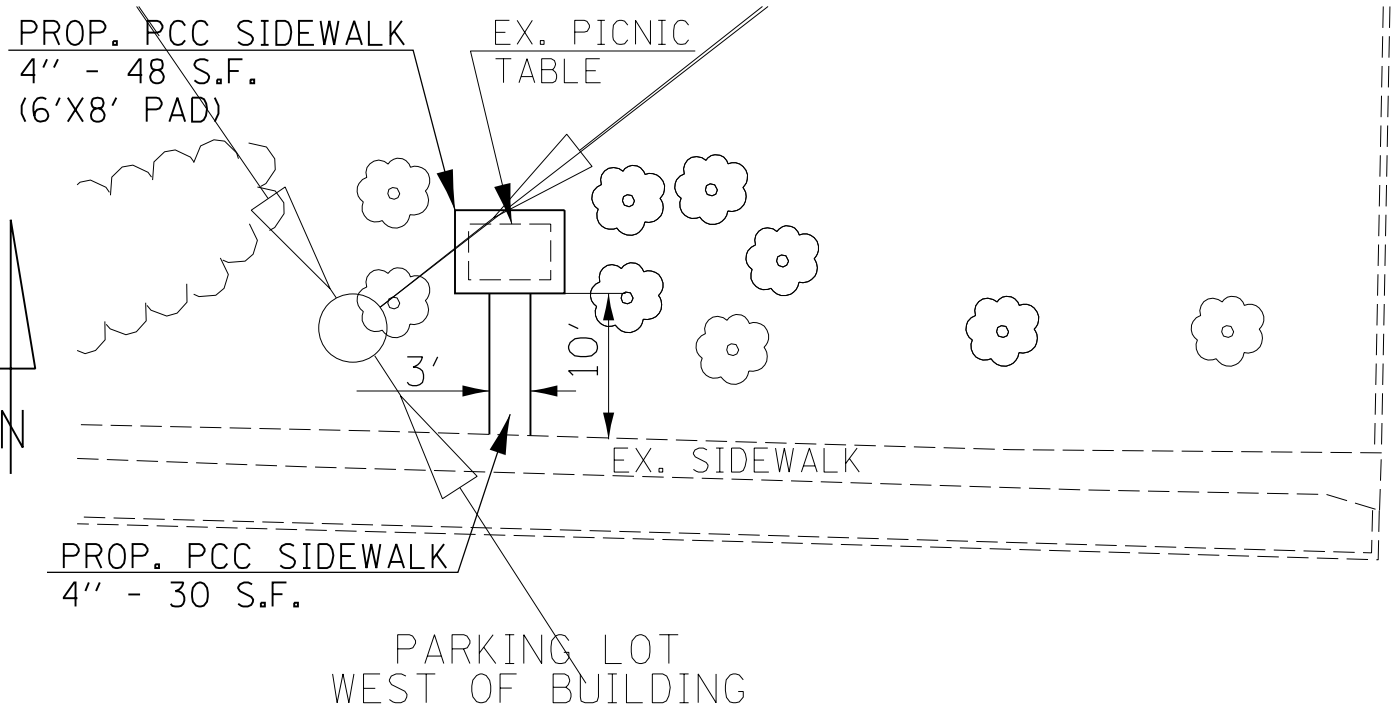

**PROP. SIDEWALK REPAIR
FRONT OF MAIN OFFICE**

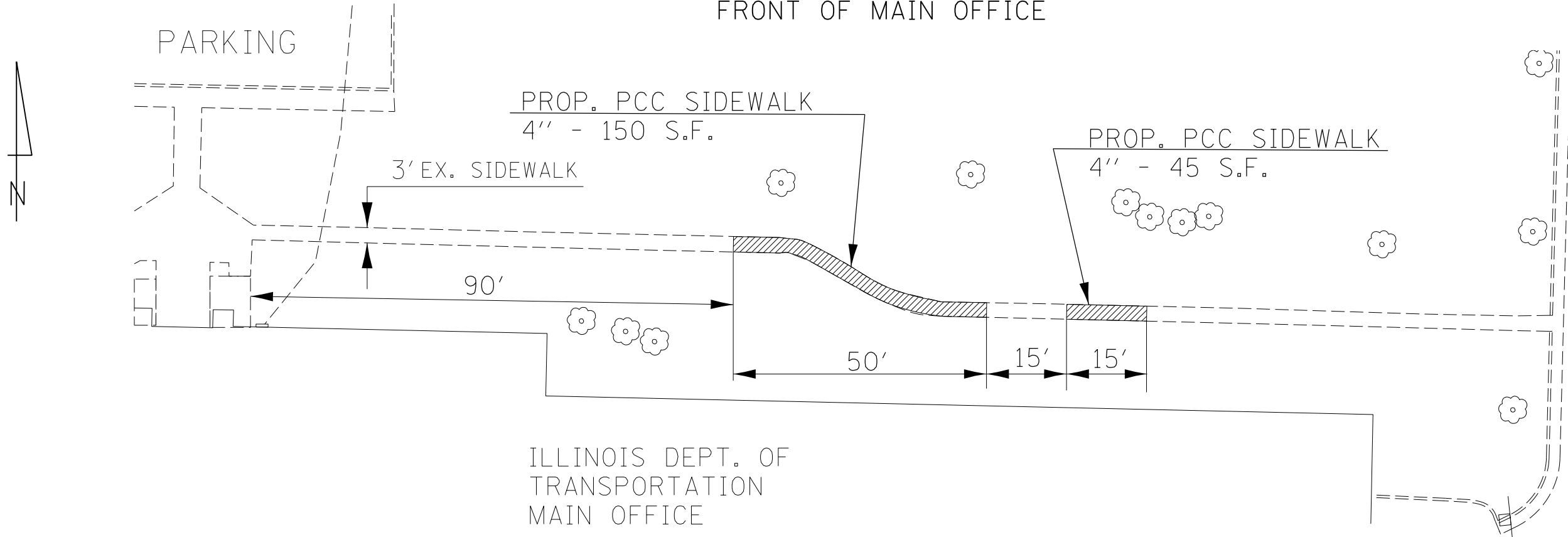

FILE NAME = p:\11\084EBIDINTEG.illinois.gov\PIWIDOT\Documents\IDOT Offices\District 9\Projects\78463\Drawings\CADsheets\78463-planprf.dgn	USER NAME = smileyjr	DESIGNED -	REVISED -	STATE OF ILLINOIS DEPARTMENT OF TRANSPORTATION	DETAIL: CONCRETE PADS AND NEW OFFICE SIDEWALK			F.A.U. RTE.	SECTION	COUNTY	TOTAL SHEETS	SHEET NO.
	PLOT SCALE = 40.0000' / in.	CHECKED -	REVISED -					9701	12(1-2)	JACKSON	21	15
Default	PLOT DATE = 4/1/2016	DATE -	REVISED -	SCALE:	SHEET	OF	SHEETS	STA.	TO	STA.	ILLINOIS FED. AID PROJECT CONTRACT NO. 78463	

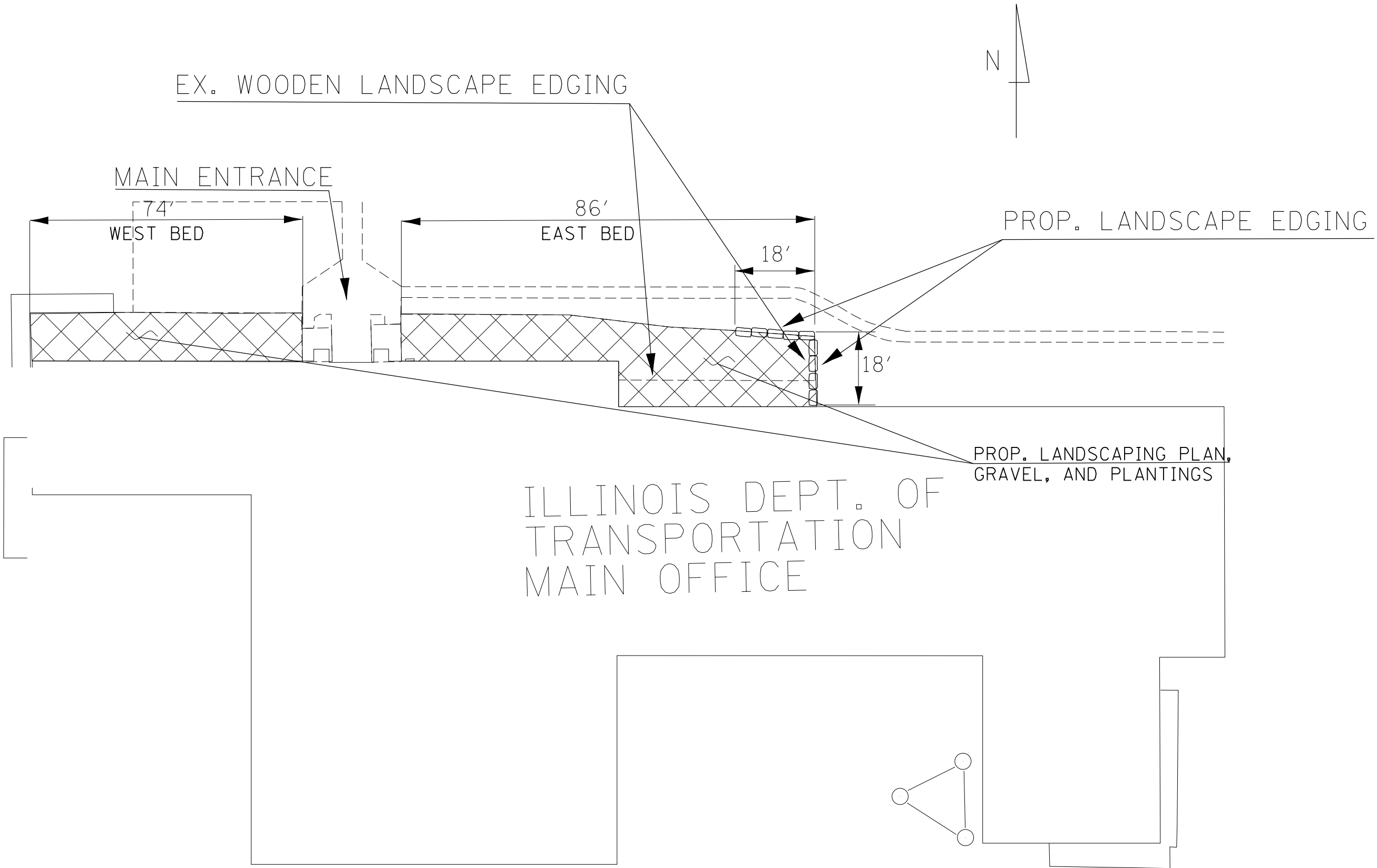

FILE NAME =	USER NAME = smileyjr	DESIGNED -	REVISED -
p:\11\084EBIDINTEG.illinois.gov\PIWIDOT\Documents\IDOT Offices\District 9\Projects\78463\Drawings\CADsheets\78463-planpr.f.dgn		CHECKED -	REVISED -
Default	PLOT SCALE = 40.0000' / in.	DATE -	REVISED -
	PLOT DATE = 4/1/2016		

**STATE OF ILLINOIS
DEPARTMENT OF TRANSPORTATION**

**DETAIL: LANDSCAPE EDGING AROUND NORTHERN PERIMETER OF
IDOT BUILDING**

SCALE: SHEET OF SHEETS STA. TO STA.

F.A.U. RTE.	SECTION	COUNTY	TOTAL SHEETS	SHEET NO.
9701	12(1-2)	JACKSON	21	16
CONTRACT NO. 78463				
ILLINOIS FED. AID PROJECT				

DATE	
BY	
SURVEYED	
PLOTTED	
TEMPLATE	
AREAS	
CHECKED	
NO.	

DATE	
BY	
SURVEYED	
PLOTTED	
TEMPLATE	
AREAS	
CHECKED	
NO.	

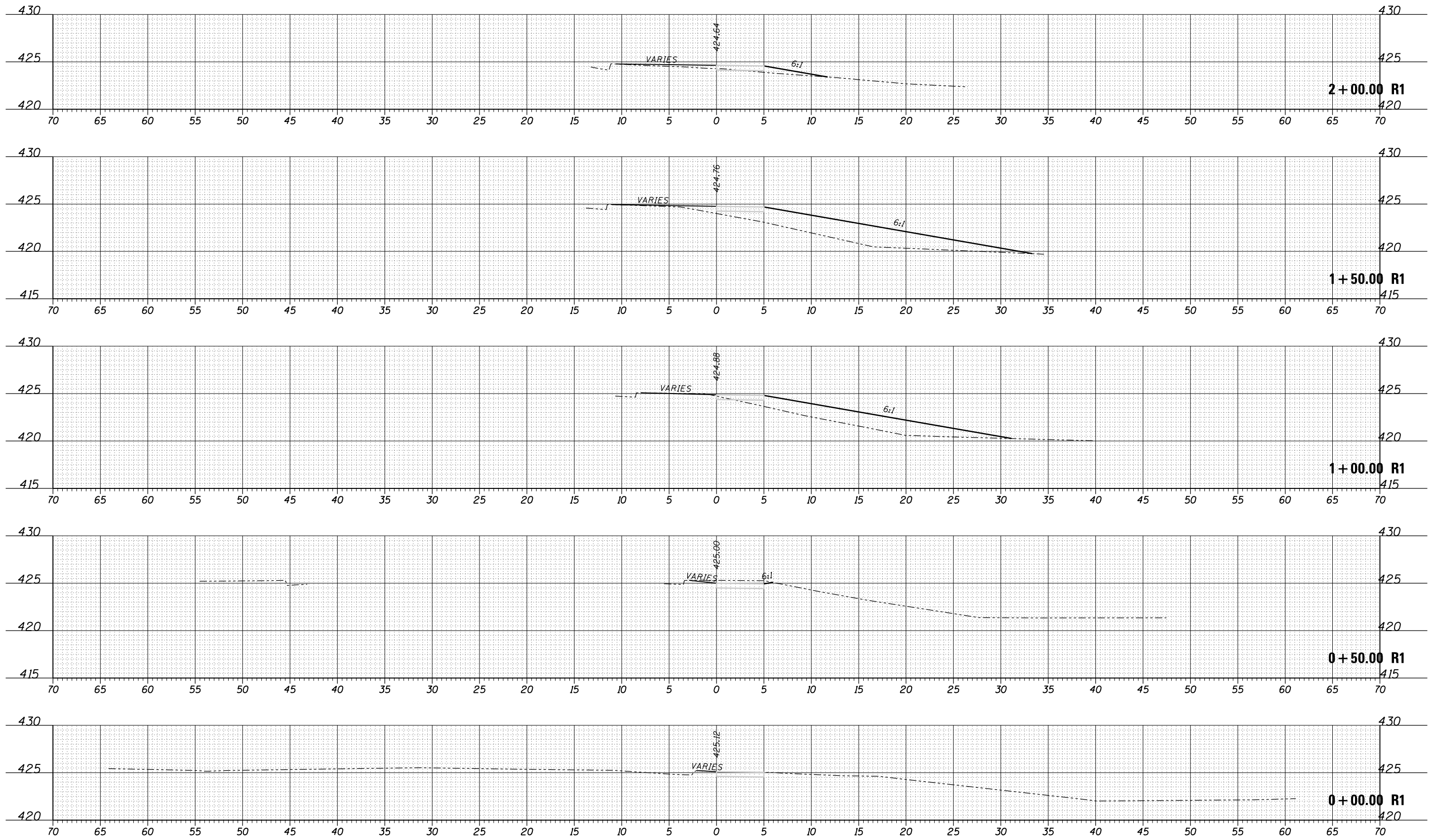

FILE NAME =	USER NAME = smileyjr	DESIGNED -	REVISED -
p:\IL084EBIDINTEG\Illinois.gov\PWIDOT\Documents\IDOT Offices\District 9\Projects\78463\CADD\Drawings\78463_xs.sht.dgn		DRAWN	REVISED -
PROP_SW.1	PLOT SCALE = 10.0000' / in.	CHECKED -	REVISED -
	PLOT DATE = 4/1/2016	DATE -	REVISED -

**STATE OF ILLINOIS
DEPARTMENT OF TRANSPORTATION**

SCALE:	SHEET	OF	SHEETS	STA. 0+00.00 R1 TO STA. 2+00.00 R1
--------	-------	----	--------	------------------------------------

CROSS SECTIONS

F.A. RTE.	SECTION	COUNTY	TOTAL SHEETS	SHEET NO.
9701	12(1-2)	JACKSON	21	17
CONTRACT NO. 78463				
ILLINOIS FED. AID PROJECT				

DATE	
BY	
FINAL SURVEY	SURVEYED
NOTE BOOK	PLOTTED
NO.	TEMPLATE
	AREAS
	CHECKED

DATE	
BY	
ORIGINAL SURVEY	SURVEYED
NOTE BOOK	PLOTTED
NO.	TEMPLATE
	AREAS
	CHECKED

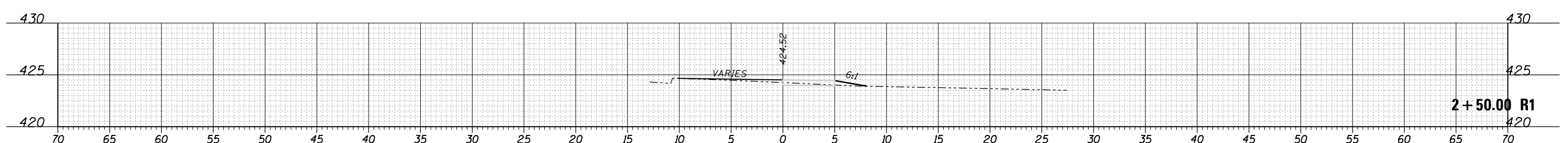
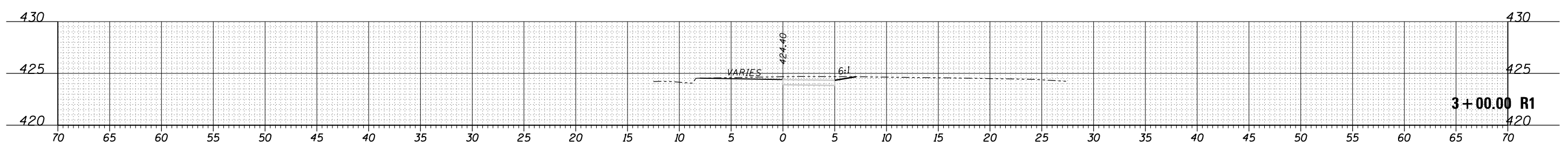
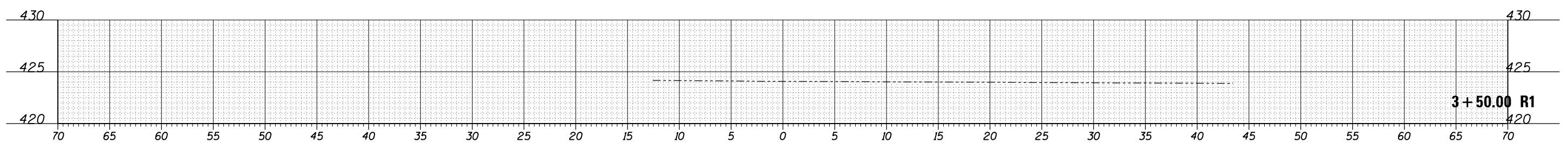
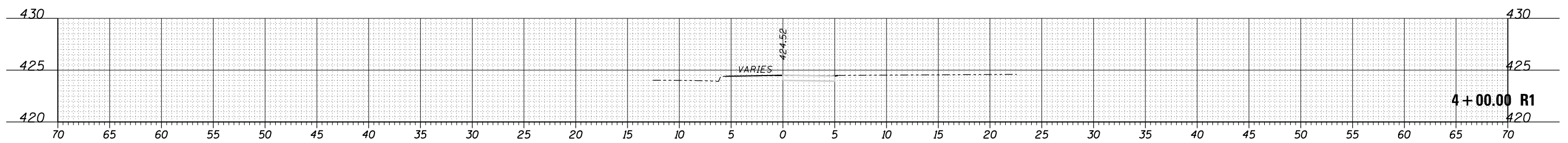
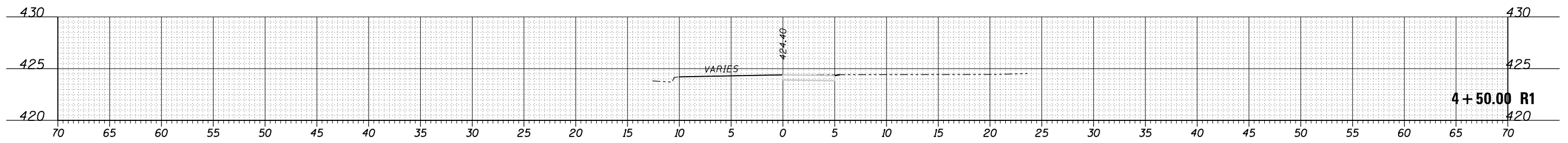
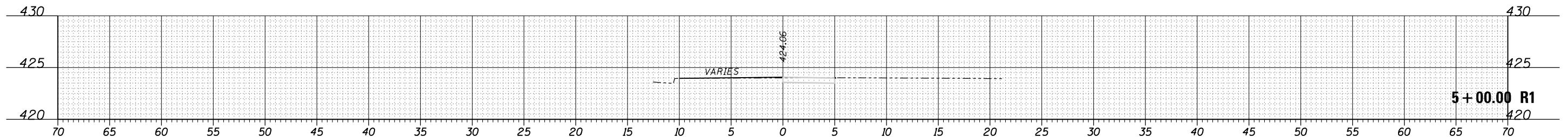

FILE NAME =	USER NAME = smiegr	DESIGNED -	REVISED -
p:\11\084EBIDINTEG\Illinois.gov\PIDOT\Documents\DOT Offices\District 9\Projects\78463\CADD\Drawings\78463_xs.sht.dgn		CHECKED -	REVISED -
PROP_SW.1	PLOT SCALE = 10.0000' / in.	DATE -	REVISED -
	PLOT DATE = 4/1/2016		

**STATE OF ILLINOIS
DEPARTMENT OF TRANSPORTATION**

SCALE:	SHEET	OF	SHEETS	STA. 2+50.00 R1 TO STA. 5+00.00 R1
--------	-------	----	--------	------------------------------------

CROSS SECTIONS

F.A. RTE.	SECTION	COUNTY	TOTAL SHEETS	SHEET NO.
9701	12(1-2)	JACKSON	21	18
CONTRACT NO. 78463				
ILLINOIS FED. AID PROJECT				

DATE	
BY	
FINAL SURVEY	SURVEYED
NOTE BOOK	PLOTTED
NO.	TEMPLATE
	AREAS
	CHECKED

DATE	
BY	
ORIGINAL SURVEY	SURVEYED
NOTE BOOK	PLOTTED
NO.	TEMPLATE
	AREAS
	CHECKED

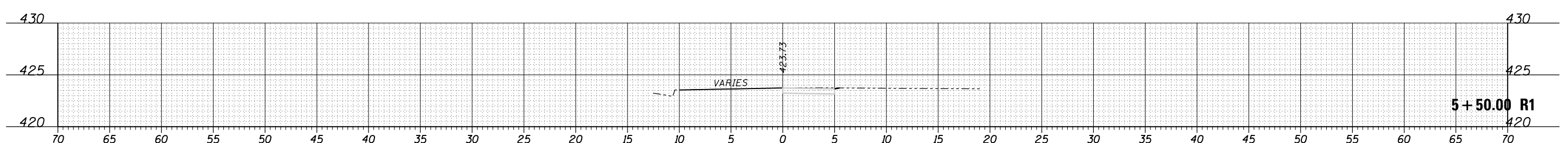
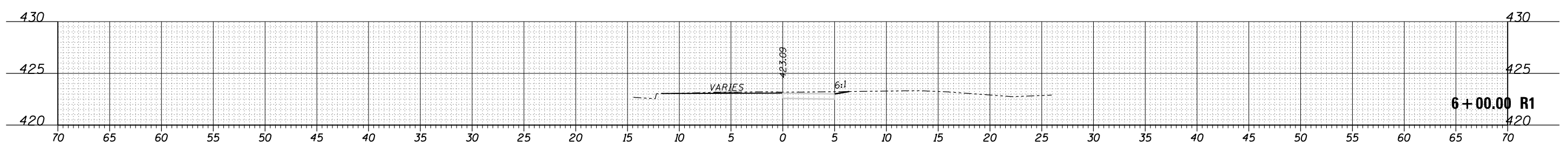
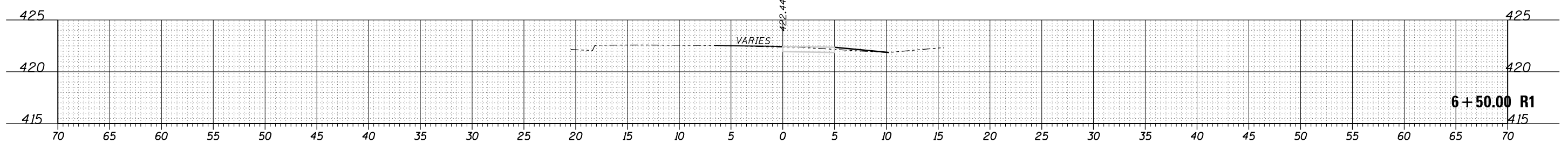
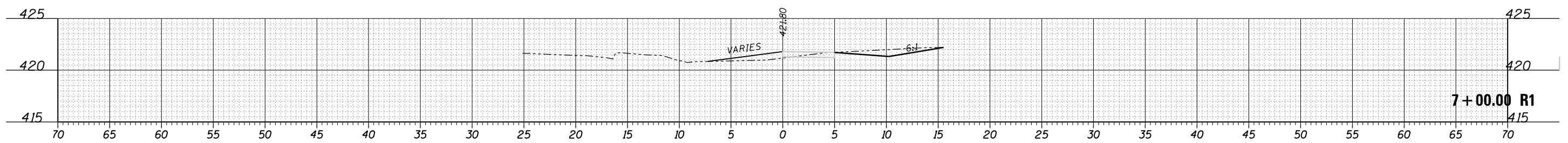
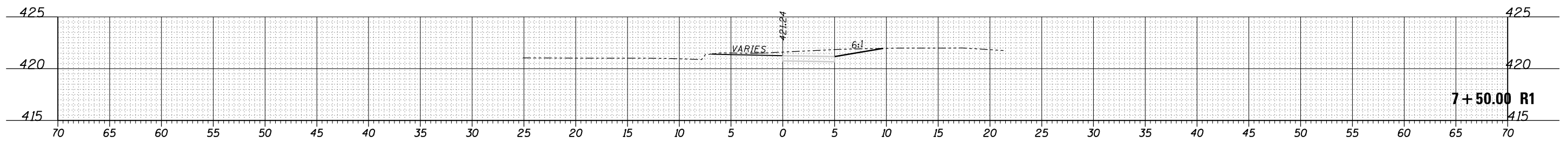
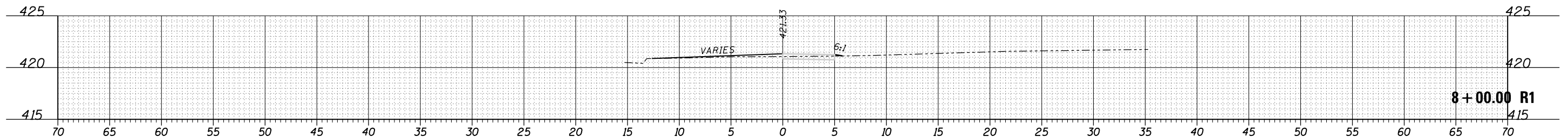

FILE NAME =	USER NAME = smiegr	DESIGNED -	REVISED -
p:\1\084EBIDINTEG\Illinois.gov\PIDOT\Documents\DOT Offices\District 9\Projects\78463\CADD\Drawings\78463_xs.sht.dgn		CHECKED -	REVISED -
PROP.SW.1	PLOT SCALE = 10.0009' / in.	DATE -	REVISED -
	PLOT DATE = 4/1/2016		

**STATE OF ILLINOIS
DEPARTMENT OF TRANSPORTATION**

CROSS SECTIONS	
SCALE:	SHEET OF SHEETS STA. 5+50.00 R1 TO STA. 8+00.00 R1

F.A. RTE.	SECTION	COUNTY	TOTAL SHEETS	SHEET NO.
9701	12(1-2)	JACKSON	21	19
CONTRACT NO. 78463				
ILLINOIS FED. AID PROJECT				

DATE	
BY	
SURVEYED	
PLOTTED	
TEMPLATE	
AREAS	
CHECKED	
FINAL SURVEY NOTE BOOK NO.	

DATE	
BY	
SURVEYED	
PLOTTED	
TEMPLATE	
AREAS	
CHECKED	
ORIGINAL SURVEY NOTE BOOK NO.	

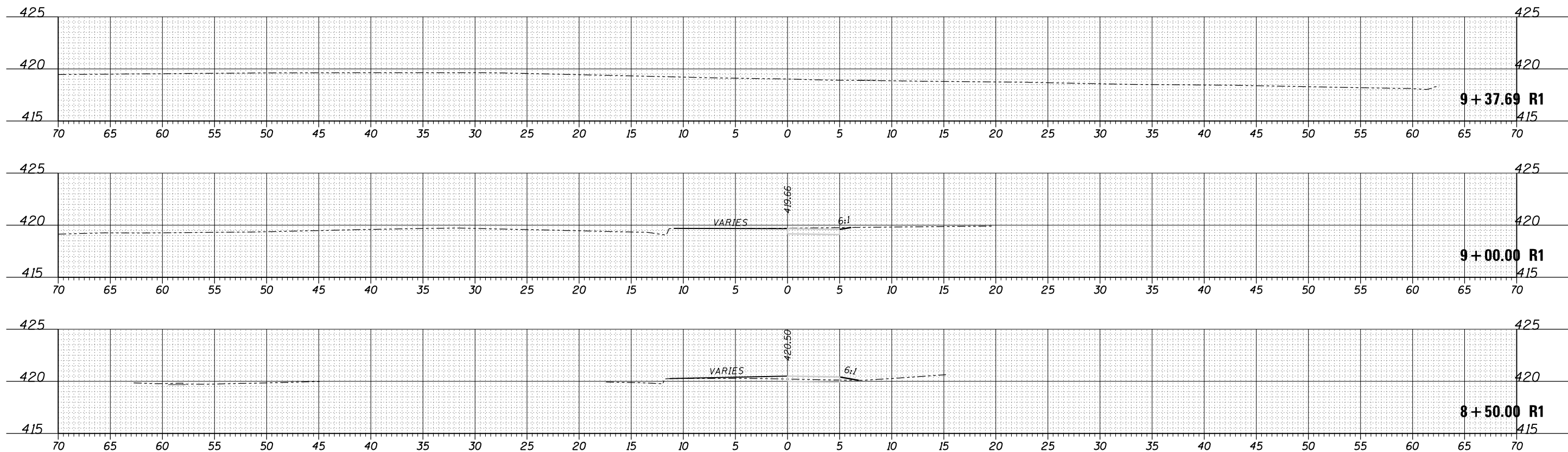

FILE NAME =	USER NAME = smieyjr	DESIGNED -	REVISED -
p:\11084EBIDINTEG\Illinois.gov\PIWIDOT\Documents\IDOT Offices\District 9\Projects\78463\CADD\Drawings\Drawings\78463.sht.dgn		DRAWN	REVISED -
PROP.SW.1	PLOT SCALE = 10.0000' / in.	CHECKED -	REVISED -
	PLOT DATE = 4/1/2016	DATE -	REVISED -

**STATE OF ILLINOIS
DEPARTMENT OF TRANSPORTATION**

CROSS SECTIONS

SCALE: SHEET OF SHEETS STA. 8+50.00 R1 TO STA. 9+37.69 R1

F.A. RTE.	SECTION	COUNTY	TOTAL SHEETS	SHEET NO.
9701	12(1-2)	JACKSON	21	20
ILLINOIS FED. AID PROJECT			CONTRACT NO. 78463	

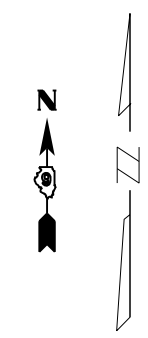

0 50 100 150
SCALE IN FEET

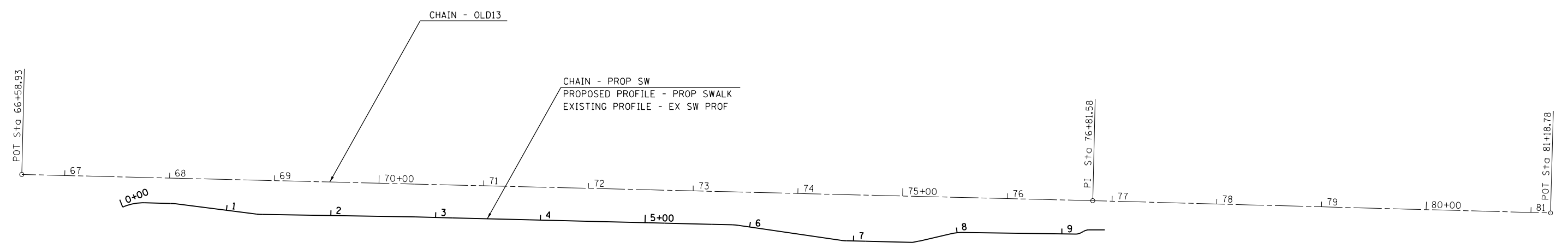

PROP SW CURVE DATA

<p>PROP. CURVE PROP_SW_3 PI STA. = 0+11.81 $\Delta = 23^\circ 27' 34''$ (RT) D = 114° 35' 30" R = 50.00' T = 10.38' L = 20.47' E = 1.07' e = ----- T.R. = ----- S.E. RUN = ----- P.C. STA. = 0+01.42 P.T. STA. = 0+21.90</p>	<p>PROP. CURVE PROP_SW_6 PI STA. = 0+48.77 $\Delta = 5^\circ 18' 18''$ (RT) D = 104° 10' 27" R = 55.00' T = 2.55' L = 5.09' E = 0.06' e = ----- T.R. = ----- S.E. RUN = ----- P.C. STA. = 0+46.22 P.T. STA. = 0+51.31</p>	<p>PROP. CURVE PROP_SW_9 PI STA. = 1+31.95 $\Delta = 6^\circ 15' 58''$ (LT) D = 114° 35' 30" R = 50.00' T = 2.74' L = 5.47' E = 0.07' e = ----- T.R. = ----- S.E. RUN = ----- P.C. STA. = 1+29.21 P.T. STA. = 1+34.68</p>	<p>PROP. CURVE PROP_SW_28 PI STA. = 5+86.13 $\Delta = 6^\circ 53' 15''$ (RT) D = 114° 57' 30" R = 49.84' T = 3.00' L = 5.99' E = 0.09' e = ----- T.R. = ----- S.E. RUN = ----- P.C. STA. = 5+83.13 P.T. STA. = 5+89.13</p>	<p>PROP. CURVE PROP_SW_31 PI STA. = 6+90.54 $\Delta = 7^\circ 08' 56''$ (LT) D = 114° 35' 30" R = 50.00' T = 3.12' L = 6.24' E = 0.10' e = ----- T.R. = ----- S.E. RUN = ----- P.C. STA. = 6+87.42 P.T. STA. = 6+93.66</p>	<p>PROP. CURVE PROP_SW_38 PI STA. = 7+63.58 $\Delta = 2^\circ 00' 57''$ (LT) D = 114° 35' 30" R = 50.00' T = 0.88' L = 1.76' E = 0.01' e = ----- T.R. = ----- S.E. RUN = ----- P.C. STA. = 7+62.70 P.T. STA. = 7+64.46</p>	<p>PROP. CURVE PROP_SW_41 PI STA. = 7+99.74 $\Delta = 13^\circ 09' 17''$ (RT) D = 114° 35' 30" R = 50.00' T = 5.77' L = 11.48' E = 0.33' e = ----- T.R. = ----- S.E. RUN = ----- P.C. STA. = 7+93.97 P.T. STA. = 8+05.45</p>	<p>PROP. CURVE PROP_SW_44 PI STA. = 9+16.12 $\Delta = 30^\circ 25' 39''$ (LT) D = 572° 57' 28" R = 10.00' T = 2.72' L = 5.31' E = 0.36' e = ----- T.R. = ----- S.E. RUN = ----- P.C. STA. = 9+13.40 P.T. STA. = 9+18.71</p>	<p>PROP. CURVE PROP_SW_47 PI STA. = 9+24.02 $\Delta = 29^\circ 36' 55''$ (RT) D = 572° 57' 28" R = 10.00' T = 2.64' L = 5.17' E = 0.34' e = ----- T.R. = ----- S.E. RUN = ----- P.C. STA. = 9+21.38 P.T. STA. = 9+26.55</p>
---	--	--	---	---	---	---	--	--

FILE NAME =	USER NAME = smileyjr	DESIGNED -	REVISED -	STATE OF ILLINOIS DEPARTMENT OF TRANSPORTATION	GEOPAK ELEMENTS			F.A.U. RTE.	SECTION	COUNTY	TOTAL SHEETS	SHEET NO.
pw\11084EBIDINTEG\illinois.gov\PI\DOT\Documents\DOT Offices\District 9\Projects\78463\Drawn\CAD\Sheets\78463-planprf.dgn		CHECKED -	REVISED -					9701	12(1-2)	JACKSON	21	21
Default	PLOT SCALE = 100.0000' / in.	DATE -	REVISED -					CONTRACT NO. 78463				
	PLOT DATE = 4/1/2016							ILLINOIS FED. AID PROJECT				
				SCALE:	SHEET	OF	SHEETS	STA.	TO	STA.		