

F.A.S. RTE.	SECTION	COUNTY	TOTAL SHEETS	SHEET NO.
371	16-00093-01-RS	MARSHALL	6	1
FED. ROAD DIST. NO. -	ILLINOIS	CONTRACT NO. 89703		

STATE OF ILLINOIS
DEPARTMENT OF TRANSPORTATION
DIVISION OF HIGHWAYS

CH 12 TAX SCHOOL ROAD ROAD IMPROVEMENTS

FAS 371 (TAX SCHOOL ROAD)

SECTION: 16-00093-01-RS
PROJECT: RS-0371(108)
MARSHALL COUNTY, ILLINOIS
C-94-048-16



INDEX OF SHEETS

- 1 TITLE SHEET
- 2 GENERAL NOTES & SUMMARY OF QUANTITIES
- 3 SCHEDULE OF QUANTITIES
- 4 TYPICAL SECTIONS & PROJECT OVERVIEW
- 5 MISCELLANEOUS DETAILS
- 6 MISCELLANEOUS DETAILS

STANDARDS

- 630001-10 STEEL PLATE BEAM GUARDRAIL (SHEETS 1 TO 4)
- 630301-06 SHOULDER WIDENING FOR TYPE 1 (SPECIAL) GUARDRAIL TERMINALS (SHEETS 1 TO 2)
- 701011-04 OFF-ROAD MOVING OPERATIONS, 2 LANE, 2 WAY DAY ONLY
- 701201-04 LANE CLOSURE, 2 LANE, 2 WAY, DAY ONLY, FOR SPEEDS > 45 MPH
- 701301-04 LANE CLOSURE, 2 LANE, SHORT TIME OPERATIONS
- 701306-03 LANE CLOSURE, 2 LANE, 2 WAY, SLOW MOVING OPERATIONS DAY ONLY, FOR SPEEDS > 45 MPH
- BLR 27-1 TRAFFIC BARRIER TERMINALS TYPE 5A



FULL SIZE PLANS (22x34) HAVE BEEN PREPARED USING STANDARD ENGINEERING SCALES. REDUCED SIZE PLANS WILL NOT CONFORM TO STANDARD SCALES. WHEN MAKING MEASUREMENTS ON REDUCED PLANS, THE ABOVE SCALES MAY BE USED.

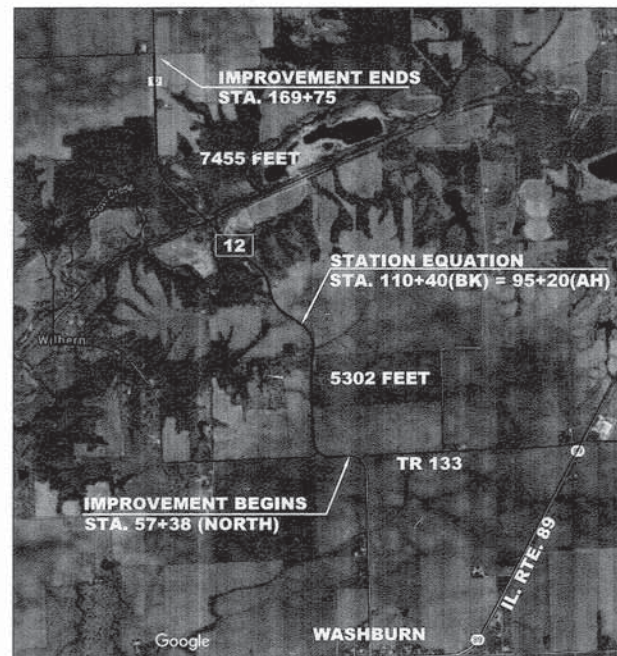

SE & SW 1/4 SECTION 25
NE & NW 1/4 SECTION 36
IN RICHLAND TOWNSHIP

NET LENGTH 12,757 FEET 2.416 MILES

AGENCY RESPONSIBLE FOR LETTING

APPROVED Mar. 8, 2016
Pat. G. S.
MARSHALL COUNTY ENGINEER

PASSED March 14 2016
[Signature]
DISTRICT FOUR ENGINEER OF LOCAL ROADS AND STREETS

RELEASING FOR BID BASED ON March 14 2016 LIMITED REVIEW
[Signature]
REGION THREE ENGINEER

Pat. G. S. 3-8-16
PATRICK SLOAN, PE DATE
LICENSED PROFESSIONAL ENGINEER
ILLINOIS NO. 43444 EXPIRES 11-30-17

CALL JULIE 1-800-892-0123
WITH THE FOLLOWING:
COUNTY MARSHALL
CITY-TOWNSHIP _____
SEC. & 1/4 SEC. NO. _____
OPERATES 24 HOURS 48 HOURS BEFORE YOU DIG.
365 DAYS EXCLUDING SAT., SUN., & HOLIDAYS

DESIGNED BY: MARSHALL COUNTY HIGHWAY DEPARTMENT
PH: 309-246-6401
CATALOG NUMBER: 035344-02

STATE OF ILLINOIS
DEPARTMENT OF TRANSPORTATION

GENERAL NOTES:

THE "STANDARD SPECIFICATIONS FOR ROAD AND BRIDGE CONSTRUCTION" ADOPTED JANUARY 1, 2016 AND THE "SUPPLEMENTAL SPECIFICATIONS AND RECURRING SPECIAL PROVISIONS" ADOPTED JANUARY 1, 2016 SHALL GOVERN THE CONSTRUCTION OF THE PROPOSED WORK EXCEPT AS MODIFIED BY THE DRAWINGS.

THE CONTRACTOR SHALL BE RESPONSIBLE FOR HAVING THE UTILITY COMPANIES LOCATE THEIR FACILITIES ON SITE PRIOR TO ANY CONSTRUCTION AND WILL BE HELD RESPONSIBLE FOR THE MAINTENANCE AND PRESERVATION OF THEIR FACILITIES. THE CONTRACTOR SHALL DETERMINE THE EXACT LOCATIONS OF UTILITIES. THE CONTRACTOR SHALL CALL J.U.L.I.E. AT 1-800-892-0123 FOR UTILITY LOCATIONS.

THE CONTRACTOR WILL BE RESPONSIBLE FOR REPAIRS TO ANY UTILITY LINE AND EXISTING IMPROVEMENTS TO REMAIN THAT ARE DAMAGES AS A RESULT OF THE WORK.

ALL EXISTING SURROUNDING AREAS AND PROPERTIES SHALL BE PROTECTED FROM DAMAGE AND LEFT UNHARMED BY THE OPERATION OF THE CONTRACTOR. ANY OF THE SURROUNDING PROPERTY DAMAGED BY THE CONTRACTOR SHALL BE REPAIRED OR REPLACED TO AN EQUAL OR BETTER CONDITION THAN WHAT EXISTED PRIOR TO CONSTRUCTION AT THE CONTRACTOR'S EXPENSE.

ADJUSTMENTS OF PROPOSED GRADES TO MATCH EXISTING ENTRANCES OR OTHER FIELD CONDITIONS MAY BE REQUIRED AS DIRECTED BY THE ENGINEER.

THE CONTRACTOR SHALL FIELD VERIFY ALL DIMENSIONS AND EXISTING CONDITIONS PRIOR TO CONSTRUCTION AND NOTIFY THE ENGINEER OF ANY DISCREPANCY IMMEDIATELY.

THE SUMMARY OF QUANTITIES HAS BEEN PROVIDED FOR THE CONTRACTOR'S REFERENCE. CONTRACTOR IS ALERTED TO THE FACT THAT THESE NUMBERS ARE ESTIMATES AND IT IS RECOMMENDED THAT THE CONTRACTOR VERIFY QUANTITIES PRIOR TO ORDERING MATERIALS.

THE OWNER RESERVES THE RIGHT TO REDUCE ANY QUANTITY OR DELETE PAY ITEMS FROM THIS CONTRACT. NO ADDITIONAL COMPENSATION WILL BE ALLOWED.

EXCESS MATERIAL, IF NOT USED FOR OTHER ON-SITE PURPOSES, SHALL BE COMPLETELY REMOVED FROM THE CONSTRUCTION SITE AND DISPOSED OF OFF-SITE BY THE CONTRACTOR.

ACCESS MUST BE MAINTAINED TO ALL EXISTING PROPERTIES DURING CONSTRUCTION PER ARTICLE 107.08 OF THE I.D.O.T. STANDARD SPECIFICATIONS, UNLESS ARRANGEMENTS ARE MADE IN WRITING BY THE CONTRACTOR WITH PROPERTY OWNER AND A COPY TO THE ENGINEER FOR SHORT-TERM CLOSURES.

EXISTING ROAD SIGNS THAT INTERFERE WITH THE CONSTRUCTION WILL BE RELOCATED AS DIRECTED BY THE ENGINEER OR OWNER, AFTER CONSTRUCTION IS COMPLETE, THE CONTRACTOR SHALL REPLACE THE SIGNS AS DIRECTED, SIGN REMOVAL, STORAGE AND RELOCATION'S SHALL BE CONSIDERED INCIDENTAL TO THE CONTRACT AND WILL NOT BE PAID FOR SEPARATELY.

THE WORK AREA SHALL BE POSITIVELY DRAINED DURING CONSTRUCTION, FINAL GRADES SHALL BE PROTECTED AGAINST DAMAGE FROM EROSION, SEDIMENTATION, AND TRAFFIC.

CONSTRUCTION OPERATIONS SHALL BE CONDUCTED IN SUCH A MANNER THAT EROSION AND WATER POLLUTION WILL BE MINIMIZED.

EROSION CONTROL IS A REQUIREMENT OF THIS PROJECT, ANY FINES OR PENALTIES LEVIED AGAINST THIS PROJECT FOR NONCOMPLIANCE WILL BE BORNE SOLELY BY THE CONTRACTOR.

PERIMETER EROSION BARRIER, TEMPORARY DITCH CHECKS, AND OTHER EROSION CONTROL ITEMS SHALL BE INSPECTED BY THE CONTRACTOR AFTER EACH RAIN EVENT AND REPAIRS SHALL BE MADE BY THE CONTRACTOR AS NEEDED.

ENVIRONMENTAL REVIEWS

PRIOR TO THE USE OF ANY PROPOSED BORROW AREAS, USE AREAS (TEMPORARY ACCESS ROADS, DETOURS, RUN-AROUND, ETC.) AND/OR WASTE AREAS, THE CONTRACTORS SHALL FILE THE REQUIRED ENVIRONMENTAL RESOURCE REQUEST SURVEYS ACCORDING TO SECTION 107.22 OF THE STANDARD SPECIFICATIONS. THESE SURVEYS ARE REQUIRED IN ORDER FOR THE DEPARTMENT TO CONDUCT CULTURAL AND BIOLOGICAL RESOURCE SURVEYS FOR THE PROPOSED SITE.

COMMITMENTS

THERE ARE NO COMMITMENTS.

SUMMARY OF QUANTITIES

ITEM PAY CODE	ITEM	UNIT	TOTAL QUANTITY
40600290	BITUMINOUS MATERIALS (TACK COAT)	POUND	28065
40600982	HOT-MIX ASPHALT SURFACE REMOVAL - BUTT JOINT	SQ YD	406
40603080	HOT-MIX ASPHALT BINDER COURSE, IL-19.0, N50	TON	7417
40603310	HOT-MIX ASPHALT SURFACE COURSE, MIX "C", N50	TON	4238
40800050	INCIDENTAL HOT MIX ASPHALT SURFACING	TON	229
48101200	AGGREGATE SHOULDERS, TYPE B	TON	2083
△ 63000001	STEEL BEAM GUARDRAIL, TYPE A, 6 FOOT POSTS	FOOT	1206
△ 63000003	STEEL BEAM GUARDRAIL, TYPE A, 9 FOOT POSTS	FOOT	1929
△ 63100075	TRAFFIC BARRIER TERMINAL, TYPE 5A	EACH	8
△ 63100169	TRAFFIC BARRIER TERMINAL, TYPE 1 (SPECIAL) FLARED	EACH	12
△ 63200310	GUARDRAIL REMOVAL	FOOT	3839
67100100	MOBILIZATION	L SUM	1
△ 78001110	PAINT PAVEMENT MARKING - LINE 4"	FOOT	49135
X7010216	TRAFFIC CONTROL AND PROTECTION (SPECIAL)	L SUM	1

△ SPECIALTY ITEMS

HMA MIXTURE REQUIREMENTS

LOCATION(S):	PROJECT # RS-0371(108)
USE(S):	BINDER AND SURFACE
PG:	58-22
DESIGN AIR VOIDS:	4% @ N50
MIXTURE COMPOSITION: (MIXTURE GRADATION)	IL 9.5
FRICTION AGGREGATE:	MIX "C"
MIXTURE WEIGHT:	112 LBS/IN/SQ YD
QUALITY MANAGEMENT PROGRAM:	QCQA
SUBLOT SIZE:	N.A.

DESIGNED -- PGS	EXAMINED	DATE	STATE OF ILLINOIS DEPARTMENT OF TRANSPORTATION	GENERAL NOTES AND SUMMARY OF QUANTITIES	F.A.S. RTE.	SECTION	COUNTY	TOTAL SHEETS	SHEET NO.
CHECKED -- PGS	ACTING ENGINEER OF BRIDGE DESIGN	REVISED			371	16-00093-01-RS	MARSHALL	6	2
DRAWN -- JLP	PASSED	REVISED			FED. ROAD DIST. NO. -	ILLINOIS	CONTRACT NO. 89703		
CHECKED -- PGS	ACTING ENGINEER OF BRIDGES AND STRUCTURES	REVISED							

STATE OF ILLINOIS
DEPARTMENT OF TRANSPORTATION

40600982 HOT MIX ASPHALT SURFACE REMOVAL - BUTT JOINT

STATION	SQ. YD.
STA. 57+38	122
STA. 114+95	81
STA. 120+80	81
STA. 169+75	122
TOTAL	406

48203017 HOT MIX ASPHALT SHOULDERS, 5", 4' WIDE,

RIGHT SHOULDER		EXISTING SHOULDER AGG/HMA	LENGTH, FT	WIDTH, FT	DEPTH, IN	HMA SHOULDERS		GUARDRAIL LIMITS	
STATION BEGIN	STATION END					AREA, SY	TONS	BEGIN	END
8944	6626	AGG*	682	4	5	303	85		
10206	10956	AGG*	750	4	5	333	93		
10000	11500	HMA	1500	4	5	667	187	10700	11402
11670	11900	HMA	230	4	5	102	29	11670	11900
12080	12350	HMA	270	4	5	120	34	12080	12113
13075	14175	HMA	1100	4	5	489	137		
SUB TOTAL						2014	565		

LEFT SHOULDER		EXISTING SHOULDER AGG/HMA	LENGTH, FT	WIDTH, FT	DEPTH, IN	HMA SHOULDERS		GUARDRAIL LIMITS	
STATION BEGIN	STATION END					AREA, SY	TONS	BEGIN	END
8906	9766	AGG*	860	4	5	382	107	8945	9195
9580	11500	HMA	1920	4	5	853	239	10750	11450
11670	11900	HMA	230	4	5	102	29	11865	11900
12080	13390	HMA	1310	4	5	582	163	12600	13390
SUB TOTAL						1919	538		
TOTAL						3933	1103		

* EXISTING AGGREGATE SHOULDERS SHALL BE CORED AND RECEIVE A MINIMUM OF 6" AGGREGATE BASE COURSE, TYPE B, PRIOR TO PLACING HMA SHOULDERS.

78001110 PAINT PAVEMENT MARKING - LINE 4"

STATION	WHITE EDGE ROAD	YELLOW CENTERLINE	DASHED YELLOW
STA. 57+38 TO STA. 169+75	25514		
STA. 57+38 TO STA. 150+20		21604	
STA. 150+20 TO STA. 158+20		800	
STA. 162+00 TO STA. 169+00		700	
STA. 150+20 TO STA. 169+75			489
WASBURN ROAD			28
SUB TOTAL	25514	23104	517
TOTAL 49135			

ENTRANCE AND MAILBOX TURNOUT

STA.	RIGHT LEFT	TYPE	WIDTH FEET	LENGTH FEET	TAPPER FEET	HMA/AREA SQUARE YARD
7470	RIGHT	F.E.	22	5	5	15
8135	RIGHT	P.E.	22	5	5	15
8241	LEFT	MB	20	4	30	22.2
8254	LEFT	F.E.	22	5	5	15
8270	RIGHT	P.E.	22	5	5	15
8276	LEFT	F.E.	22	5	5	15
8877	LEFT	MB	20	4	30	22.2
8894	LEFT	P.E.	22	5	5	15
9367	RIGHT	F.E.	40	5	5	25
10143	LEFT	F.E.	22	5	5	15
10543	LEFT	MB	20	4	30	22.2
10570	LEFT	P.E.	22	5	5	15
STATION EQUATION 110+40(BK) = 95+20(AH)						SUB 211.60 SY

STA.	RIGHT LEFT	TYPE	WIDTH FEET	LENGTH FEET	TAPPER FEET	HMA/AREA SQUARE YARD
9680	LEFT	MB	20	4	30	22.2
9687	RIGHT	P.E.	32	5	5	20.6
9700	LEFT	P.E.	16	5	5	11.7
9913	LEFT	P.E.	16	5	5	11.7
10050	LEFT	P.E.	16	5	5	11.7
10081	LEFT	MB	20	4	30	22.2
11447	RIGHT	C.E.	30	5	5	19.4
11720	LEFT	P.E.	24	5	5	16.1
12332	RIGHT	C.E.	16			180
12405	LEFT	MB	20	4	30	22.2
13935	RIGHT	P.E.	16	5	5	11.7
13950	LEFT	MB	20	4	30	22.2
14165	RIGHT	P.E.	20	5	5	13.9
14175	LEFT	MB	20	4	30	22.2
15193	LEFT	F.E.	16	5	5	11.7
15238	LEFT	F.E.	16	5	5	11.7
15370	LEFT	F.E.	16	5	5	11.7
15386	RIGHT	P.E.	16	5	5	11.7
15396	LEFT	MB	20	4	30	22.2
16350	RIGHT	F.E.	16	5	5	11.7
16720	LEFT	F.E.	16	5	5	11.7
16795	LEFT	SR-CH 16				SUB 500.20 SY
TOTAL						711.80 SY

C.E. COMMERCIAL ENTRANCE
F.E. FIELD ENTRANCE
P.E. PRIVATE ENTRANCE
MB MAILBOX TURNOUT
SR SIDE ROAD

GUARDRAIL

STATION	RIGHT LEFT	TYPE	WIDTH FEET	LENGTH FEET	TAPPER FEET	HMA/AREA SQUARE YARD	63100169	63000001	63000003	63000075	63200310
							TR BAR TRM T1 SPL FLR	SPBGR TY A 6FT POSTS	SPBGR TY A 9FT POSTS	TRAF BAR TRM T5A	GUARDRAIL REMOV
STA. 89+00 TO STA. 89+50, RT.							1	X	X	X	50
STA. 89+50 TO STA. 91+25, RT.							X	175	X	X	175
STA. 91+25 TO STA. 91+75, RT.							1	X	X	X	50
STA. 89+45 TO STA. 89+95, LT.							1	X	X	X	50
STA. 89+95 TO STA. 91+45, LT.							X	150	X	X	150
STA. 91+45 TO STA. 91+95, LT.							1	X	X	X	50
STA. 107+90 TO STA. 108+40, LT.							1	X	X	X	50
STA. 108+40 TO STA. 109+90, LT.							X	150	X	X	150
STA. 109+90 TO STA. 110+40, LT.							1	X	X	X	50
STATION EQUATION 110+40(BK) = 95+20(AH)											
STA. 106+77 TO STA. 107+27, RT.							1	X	X	X	50
STA. 107+27 TO STA. 114+02, RT.							X	X	675	X	675
STA. 114+02 TO STA. 114+28, RT.							X	X	39*	X	39
STA. 107+26 TO STA. 107+76, LT.							1	X	X	X	50
STA. 107+76 TO STA. 114+76, LT.							X	X	700	X	700
STA. 114+76 TO STA. 114+89, LT.							X	X	X	1	13
STA. 114+66 TO STA. 114+87, RT.							X	X	39*	X	39
STA. 114+87 TO STA. 115+00, RT.							X	X	X	1	13
STA. 116+68 TO STA. 116+81, LT.							X	X	X	1	13
STA. 116+81 TO STA. 117+04, LT.							X	X	39*	X	39
STA. 116+79 TO STA. 116+92, RT.							X	X	X	1	13
STA. 116+92 TO STA. 118+75, RT.							X	X	183	X	183
STA. 118+75 TO STA. 118+88, RT.							X	X	X	1	13
STA. 117+36 TO STA. 117+62, LT.							X	X	39*	X	39
STA. 117+62 TO STA. 118+88, LT.							X	X	126	X	126
STA. 118+88 TO STA. 119+01, LT.							X	X	X	1	13
STA. 120+75 TO STA. 120+88, RT.							X	X	X	1	13
STA. 120+88 TO STA. 121+14, RT.							X	X	26	X	26
STA. 121+14 TO STA. 121+64, RT.							1	X	X	X	50
STA. 120+88 TO STA. 121+01, LT.							X	X	X	1	13
STA. 121+01 TO STA. 121+64, LT.							X	X	63	X	63
STA. 121+64 TO STA. 122+14, LT.							1	X	X	X	50
STA. 125+80 TO STA. 126+61, LT.							1	X	X	X	50
STA. 126+30 TO STA. 133+61, LT.							X	731	X	X	731
STA. 133+61 TO STA. 134+11, LT.							1	X	X	X	50
TOTALS							12	1206	1929	8	3839

DESIGNED - PGS	EXAMINED	DATE
CHECKED - PGS	ACTING ENGINEER OF BRIDGE DESIGN	REVISED
DRAWN - JLP	PASSED	REVISED
CHECKED - PGS	ACTING ENGINEER OF BRIDGES AND STRUCTURES	REVISED

STATE OF ILLINOIS
DEPARTMENT OF TRANSPORTATION

SCHEDULE OF QUANTITIES

F.A.S. RTE.	SECTION	COUNTY	TOTAL SHEETS	SHEET NO.
371	16-00093-01-RS	MARSHALL	6	3
ILLINOIS CONTRACT NO. 89203				

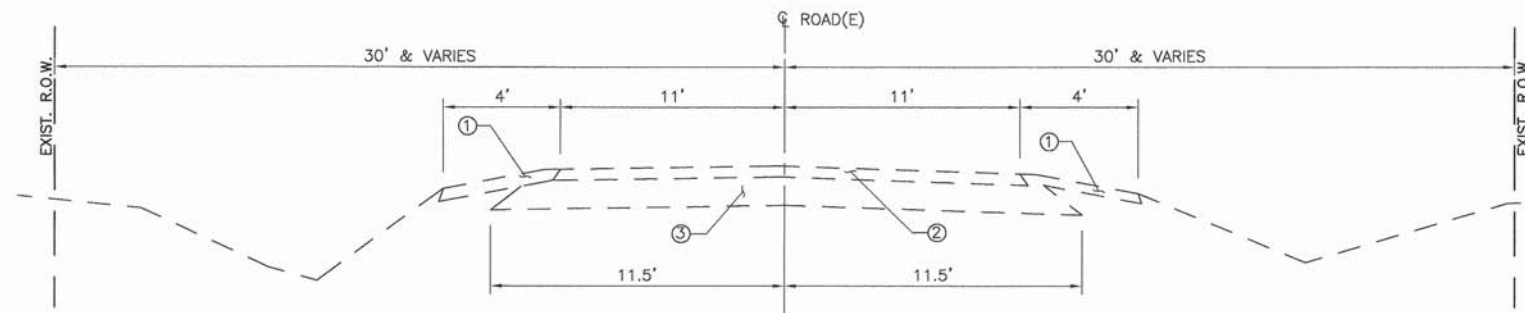

- ① EXISTING SHOULDER
- ② EXISTING 3" CLASS B BITUMINOUS MIXTURE WITH SEAL COAT SURFACE
- ③ EXISTING 7" COMPRESSED AGGREGATE BASE COURSE WITH 2" ORIGINAL A-1 AND SUCCESSIVE SEALS

TYPICAL EXISTING SECTION

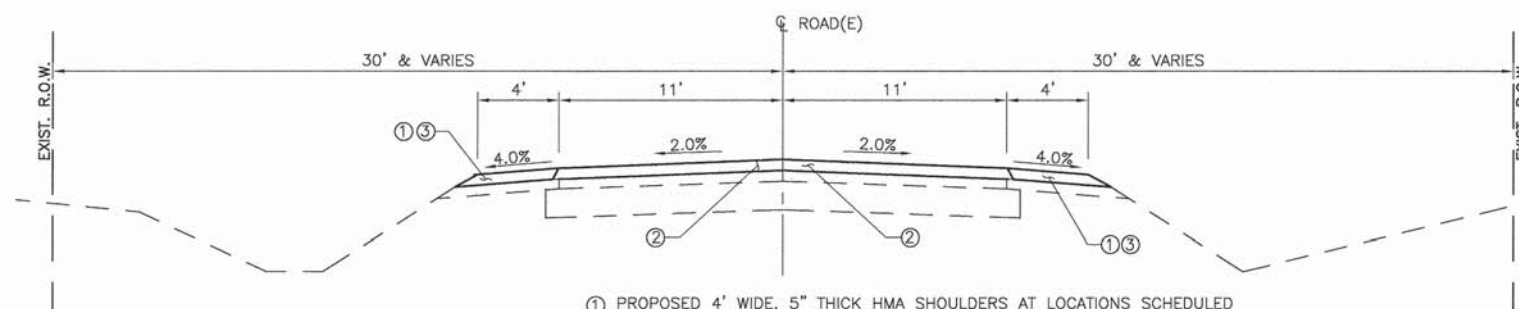

- ① PROPOSED 4' WIDE, 5" THICK HMA SHOULDERS AT LOCATIONS SCHEDULED
- ② PROPOSED HMA OVERLAY, 5 1/2" 3.5" BINDER, IL-19.0, N50 & 2" SURFACE, MIX "C", N50
- ③ PROPOSED AGGREGATE SHOULDERS, TYPE B, TYPICAL

TYPICAL PROPOSED RESURFACING SECTION
 STA. 57+38 (NORTH) TO
 STA. 110+40(BK) = 95+20(AH)
 TO STA. 169+75

NOTE:

EXISTING AGGREGATE SHOULDERS SHALL BE CORED AND RECEIVE A MINIMUM OF 6" AGGREGATE BASE COURSE, TYPE B, PRIOR TO PLACING HMA SHOULDERS.

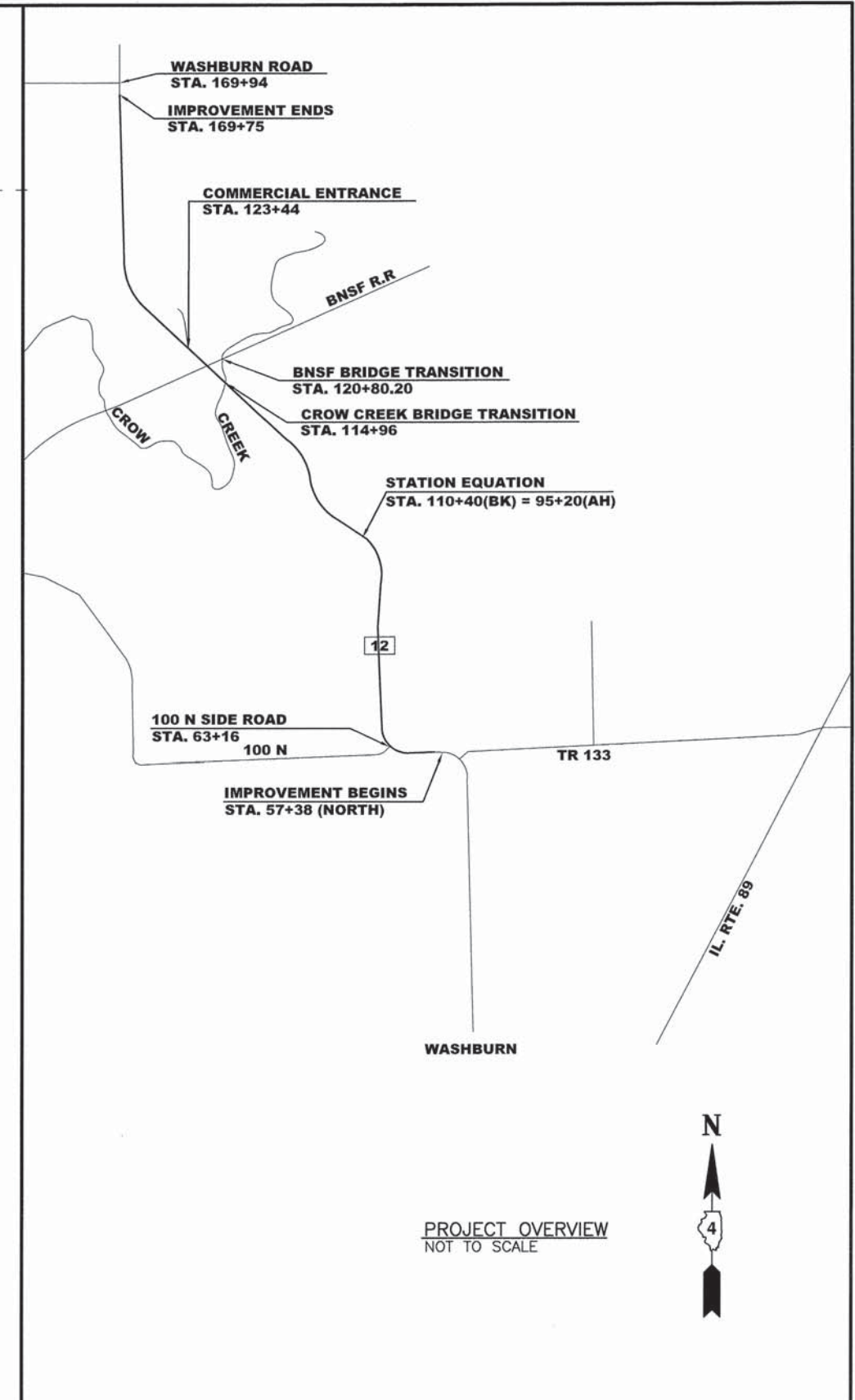

PROJECT OVERVIEW
 NOT TO SCALE

DESIGNED — PGS	EXAMINED _____	DATE _____
CHECKED — PGS	ACTING ENGINEER OF BRIDGE DESIGN	REVISED _____
DRAWN — JLP	PASSED _____	REVISED _____
CHECKED — PGS	ACTING ENGINEER OF BRIDGES AND STRUCTURES	

STATE OF ILLINOIS
 DEPARTMENT OF TRANSPORTATION

TYPICAL SECTIONS
 AND
 PROJECT OVERVIEW

F.A.S. RTE	SECTION	COUNTY	TOTAL SHEETS	SHEET NO.
371	13-00093-00-RS	MARSHALL	6	4
FED. ROAD DIST. NO. _____		ILLINOIS	CONTRACT NO. 89703	

STATE OF ILLINOIS
DEPARTMENT OF TRANSPORTATION

PLAN	BY	DATE
NO. _____		
NO. _____		
NO. _____		
NO. _____		

PROFILE	BY	DATE
NO. _____		
NO. _____		
NO. _____		
NO. _____		

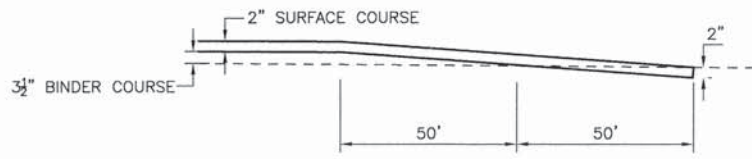

BUTT JOINT AND TAPER DETAIL
NORTH OR SOUTH END

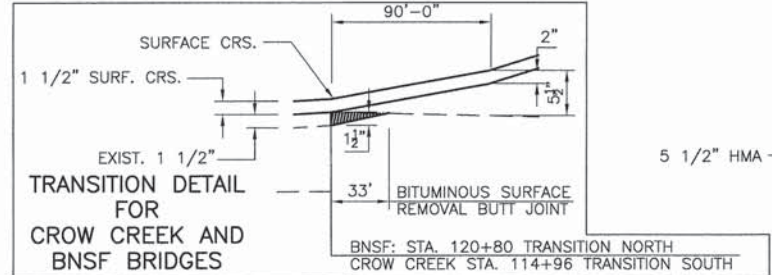

TRANSITION DETAIL
FOR
CROW CREEK AND
BNSF BRIDGES

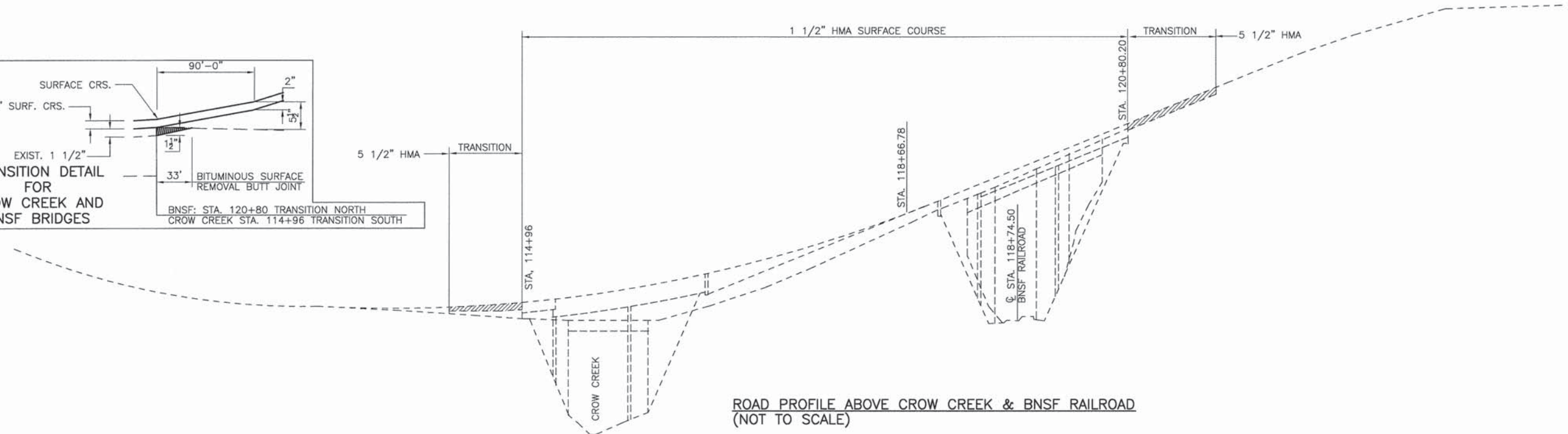

ROAD PROFILE ABOVE CROW CREEK & BNSF RAILROAD
(NOT TO SCALE)

DESIGNED — PGS	EXAMINED _____	DATE _____
CHECKED — PGS	ACTING ENGINEER OF BRIDGE DESIGN	
DRAWN — JLP	PASSED _____	REVISED _____
CHECKED — PGS	ACTING ENGINEER OF BRIDGES AND STRUCTURES	REVISED _____

STATE OF ILLINOIS
DEPARTMENT OF TRANSPORTATION

MISCELLANEOUS DETAILS

F.A.S. RTE.	SECTION	COUNTY	TOTAL SHEETS	SHEET NO.
371	16-00093-01-RS	MARSHALL	6	5
FED. ROAD DIST. NO. _____	ILLINOIS	CONTRACT NO. 89703		

STATE OF ILLINOIS
DEPARTMENT OF TRANSPORTATION

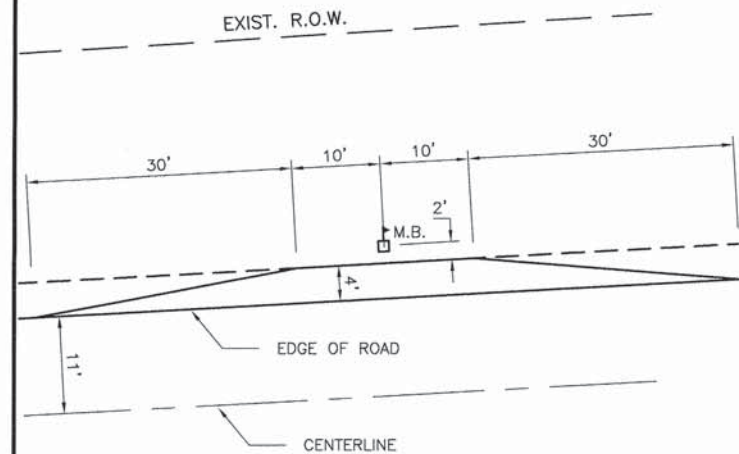

MAILBOX TURNOUT DETAIL

NOTE:

1. EXISTING HMA ENTRANCE TAPERS AND MAILBOX TURNOUTS SHALL BE OVERLAIN TO THE SAME DEPTH AS THE MAINLINE.
2. NEW ENTRANCES AND TURNOUTS OR ENTRANCES AND TURNOUTS NOT MEETING THE REQUIRED DIMENSIONS SHALL BE CORED OUT TO RECEIVE A MINIMUM OF 6" AGGREGATE BASE COURSE, TYPE B AND 3" HOT-MIX ASPHALT (HMA).

TOTAL AREA 590.7 SQ.YD
THICKNESS REQUIRED 2" COMP
BITUMINOUS MIXTURE COMPL. MOD 132.3 TON
AGGREGATE SHOULDER, TYPE B 32.8 TON

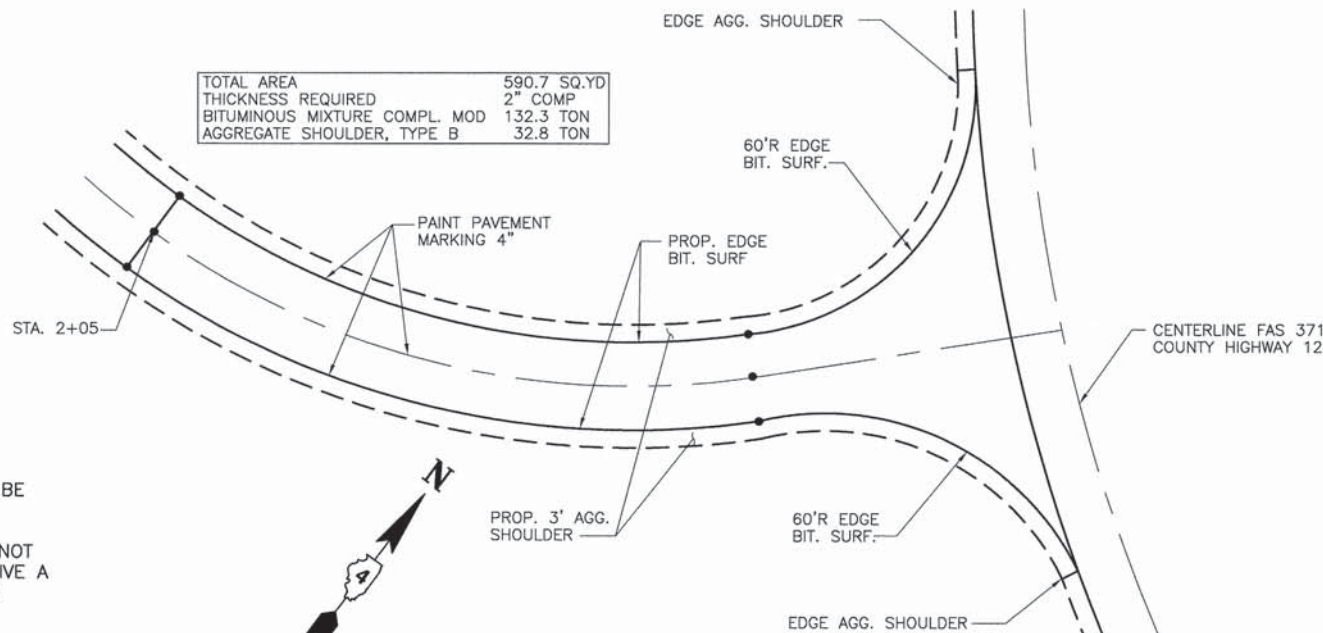

WILBERN ROAD DETAIL
LT. STA. 63+16

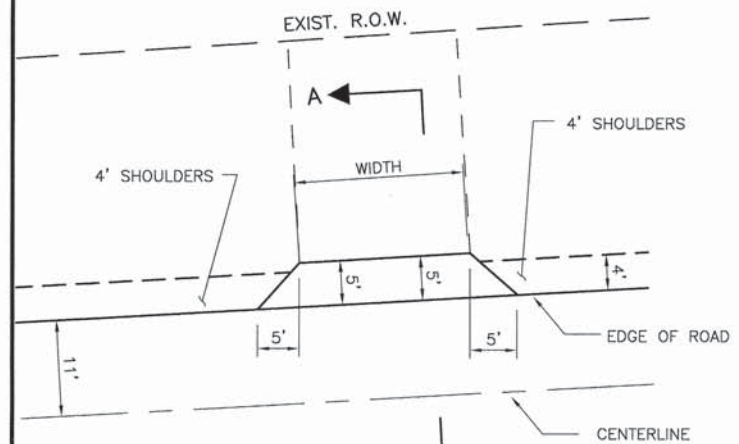

ENTRANCE DETAIL

RESURFACE SECTION STA. 57+38 TO STA. 169+75

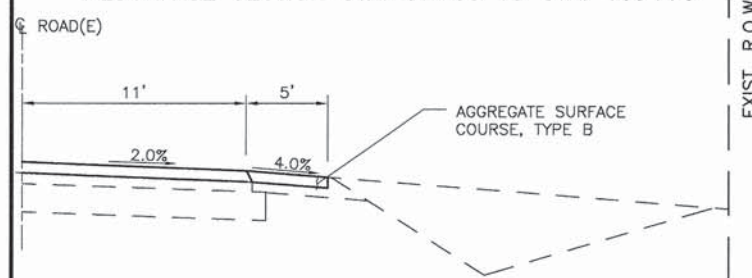

SECTION A-A
ENTRANCE DETAIL

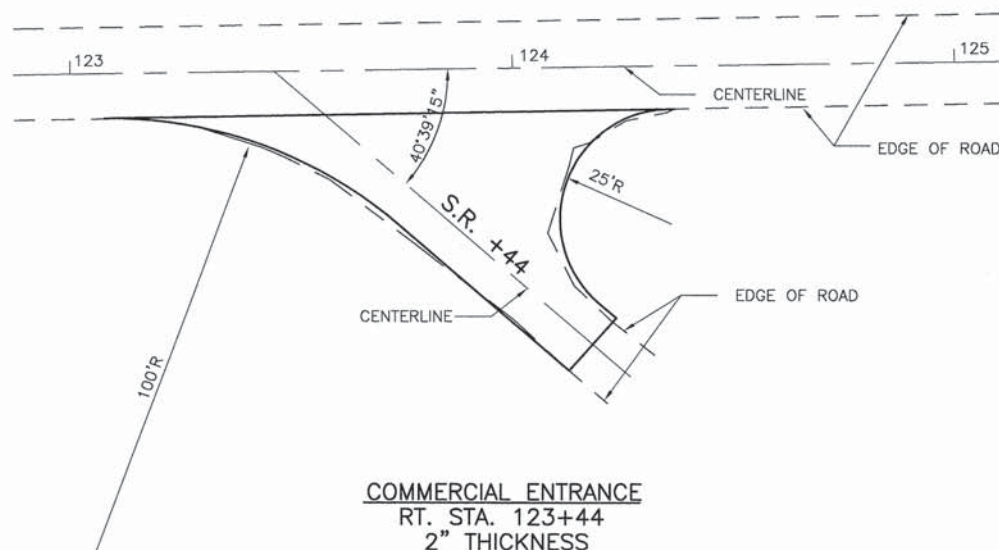

COMMERCIAL ENTRANCE
RT. STA. 123+44
2" THICKNESS

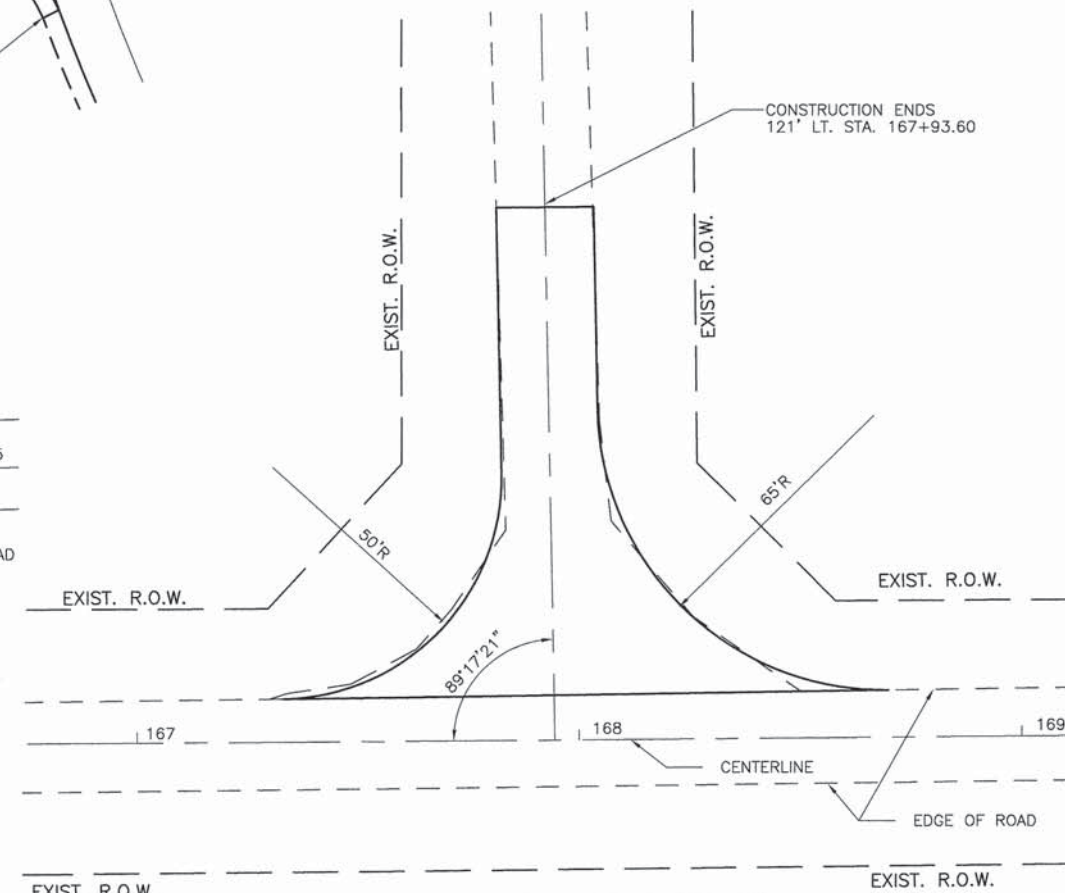

WASHBURN ROAD (CH 16)
INTERSECTION LT. STA.
167+93.60



DESIGNED -- PGS	EXAMINED	DATE
CHECKED -- PGS	ACTING ENGINEER OF BRIDGE DESIGN	
DRAWN -- JLP	PASSED	REVISED
CHECKED -- PGS	ACTING ENGINEER OF BRIDGES AND STRUCTURES	REVISED

STATE OF ILLINOIS
DEPARTMENT OF TRANSPORTATION

MISCELLANEOUS DETAILS

F.A.S. RTE.	SECTION	COUNTY	TOTAL SHEETS	SHEET NO.
371	16-00093-01-RS	MARSHALL	6	6
FED. ROAD DIST. NO.		ILLINOIS CONTRACT NO. 89703		