

INDEX OF SHEETS

- 1 COVER SHEET
- 2 TYPICAL SECTIONS

- STANDARDS:
- 701006-05 TRAFFIC CONTROL
 - 701306-03 TRAFFIC CONTROL
 - 701301-04 TRAFFIC CONTROL
 - 701311-03 TRAFFIC CONTROL
 - 701901-05 TRAFFIC CONTROL DEVICES
 - 780001-05 PAVEMENT MARKINGS

STATE OF ILLINOIS
DEPARTMENT OF TRANSPORTATION
DIVISION OF HIGHWAYS
PLANS FOR PROPOSED
SURFACE TRANSPORTATION PROGRAM
CRAWFORD COUNTY
SECTION 11-00098-00-RS
FAS 694 (CH 1)
PROJECT RS-0694(114)
JOB NO. C-97-045-15

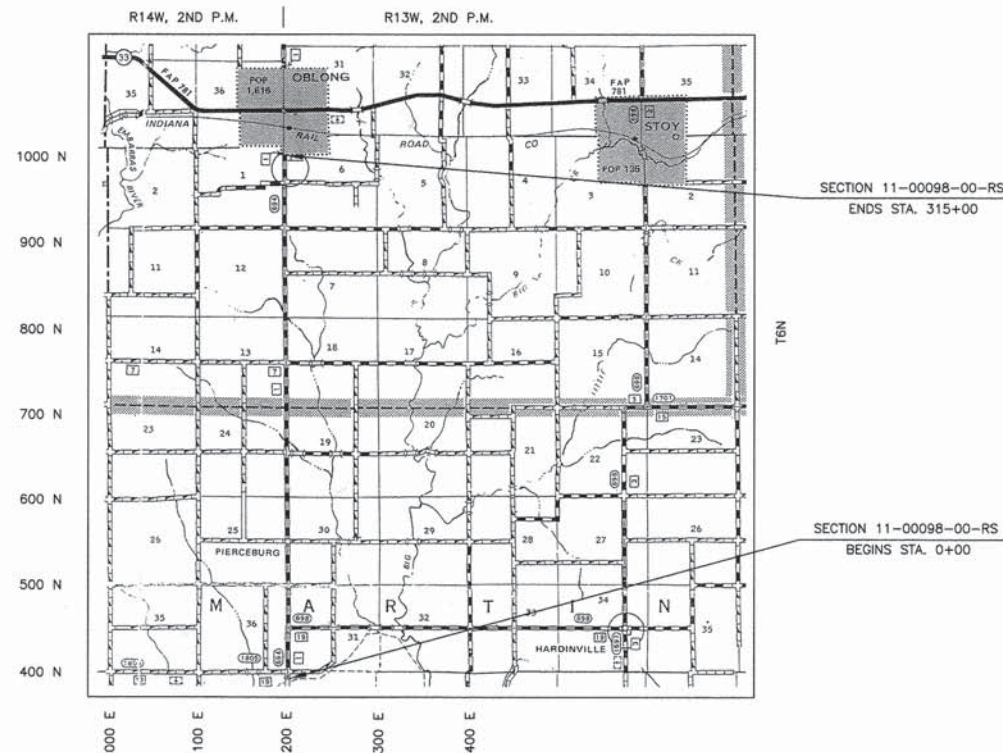

LOCATION MAP
APPROXIMATE SCALE: 1 INCH = 1 MILE
NET LENGTH = 31,500 FEET = 5.97 MILES

FUNCTIONAL CLASS - RURAL MAJOR COLLECTOR
ADT = 1750
DESIGN SPEED = 60 MPH

TOLL FREE JOINT UTILITY LOCATING
INFORMATION FOR EXCAVATORS (J.U.L.I.E.)
TELEPHONE NO. 1-800-892-0123

John A. Stone
 ILLINOIS REGISTERED PROFESSIONAL ENGINEER # 55012
 LICENSE EXPIRES NOVEMBER 30, 2017
 CONNOR & CONNOR, INC.
 PROFESSIONAL DESIGN FIRM #184-000832
 03/24/2016

ILLINOIS DEPARTMENT OF TRANSPORTATION
APPROVED: <u>3/24/2016</u> <i>Justin R. Child</i> CRAWFORD COUNTY ENGINEER
PASSED: <u>3/28/16</u> <i>M. Smith</i> DISTRICT SEVEN ENGINEER OF LOCAL ROADS & STREETS
RELEASING FOR BID BASED ON LIMITED REVIEW <u>3/28/16</u> <i>Richard M. Smith</i> REGION FOUR ENGINEER

SECTION	11-00098-00-RS	TOTAL SHEETS	2	SHEET NO.	2
COUNTY	CRAWFORD				
STA.	TO STA.				
CONTRACT NO. 95791					

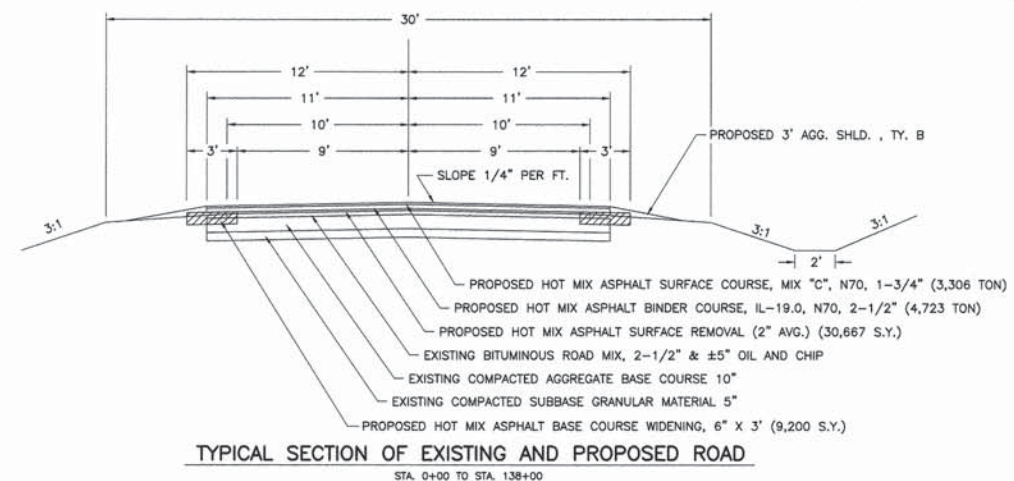

PAVEMENT DESIGN DATA
 2025 ADT = 1900, P = 1770, SU = 100, MU = 30, CLASS III ROAD (80,000 LB. DESIGN) IFR = 3.0, SNF = 3.3
 PAVEMENT STRUCTURE MATERIALS: EXISTING COMPACTED GRAVEL BASE 10" = 10 X 0.08 = 0.80
 COMPACTED SUBBASE 5" = 5 X 0.09 = 0.45
 BITUMINOUS ROAD MIX 2.5" = 2.5 X 0.15 = 0.38
 PROPOSED HMA SURFACE COURSE 1.75" = 1.75 X 0.40 = 0.70
 HMA BINDER COURSE 2.50" = 2.50 X 0.40 = 1.00
 TOTAL = 3.33

SUMMARY OF QUANTITIES

2,868	FOOT	SHORT-TERM PAVEMENT MARKING REMOVAL	XX003140
1	L SUM	TRAFFIC CONTROL AND PROTECTION, (SPECIAL)	X7010216
1,533	CU YD	EARTH EXCAVATION (WIDENING)	20200500
9,200	SQ YD	HOT-MIX ASPHALT BASE COURSE WIDENING, 6"	35600700
138	TON	AGGREGATE SURFACE COURSE, TYPE B	40200800
58,776	POUND	BITUMINOUS MATERIALS (TACK COAT)	40600290
32	SQ YD	TEMPORARY RAMP	40600990
13,542	TON	HOT-MIX ASPHALT BINDER COURSE, IL-19.0, N70	40603085
6,856	TON	HOT-MIX ASPHALT SURFACE COURSE, MIX "C", N70	40603315
60,734	SQ YD	HOT-MIX ASPHALT SURFACE REMOVAL, 2"	44000157
3,059	TON	AGGREGATE SHOULDERS, TYPE B	48101200
1	L SUM	MOBILIZATION	67100100
1	L SUM	TRAFFIC CONTROL AND PROTECTION, STANDARD 701306	70100460
6,848	FOOT	SHORT TERM PAVEMENT MARKING	70300100
70,875	FOOT	PAINT PAVEMENT MARKING-LINE 4"	78001110 *

* SPECIALTY ITEMS

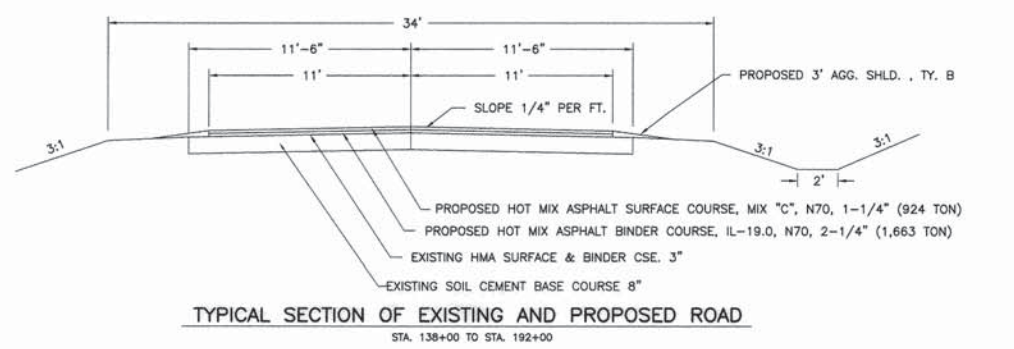

PAVEMENT DESIGN DATA
 2025 ADT = 1900, P = 1770, SU = 100, MU = 30, CLASS III ROAD (80,000 LB. DESIGN) IFR = 3.0, SNF = 3.3
 PAVEMENT STRUCTURE MATERIALS: EXISTING SOIL-CEMENT BASE 8" = 8 X 0.17 = 1.36
 HMA SURFACE & BINDER COURSE 3" = 3 X 0.23 = 0.69
 PROPOSED HMA SURFACE COURSE 1.25" & HMA BINDER COURSE 2.25" = 3.50 X 0.40 = 1.40
 TOTAL = 3.45

PAINT PAVEMENT MARKING LINE 4" (TOTAL = 70,875 FT.)

CENTERLINE STRIPE
 STA. 0+00 TO STA. 315+00 = 7,875 FT.

EDGE LINE
 STA. 0+00 TO STA. 315+00 = 63,000 FT.

NOTE: SIDEROADS TO BE RESURFACED TO END OF RADIUS AS DIRECTED BY THE ENGINEER (MATCH EXISTING RADIUS).

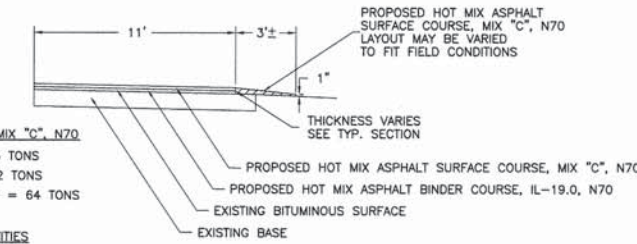

HOT MIX ASPHALT SURFACE COURSE, MIX "C", N70
 17 SIDEROADS @ 15 TONS EACH = 255 TONS
 101 ENTRANCES @ 2 TONS EACH = 202 TONS
 32 MAILBOX TURNOUTS @ 2 TONS EACH = 64 TONS

AGGREGATE SURFACE COURSE QUANTITIES
 69 ENTRANCES @ 2 TONS EACH = 138 TONS

DETAIL OF RESURFACING ENTRANCES, SIDEROADS & MAILBOX TURNOUTS

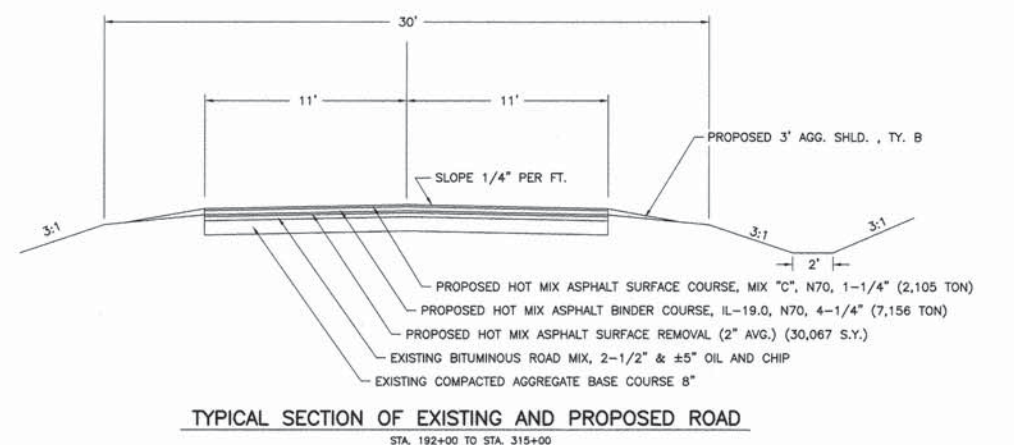

PAVEMENT DESIGN DATA
 2025 ADT = 1900, P = 1770, SU = 100, MU = 30, CLASS III ROAD (80,000 LB. DESIGN) IFR = 3.0, SNF = 3.3
 PAVEMENT STRUCTURE MATERIALS: EXISTING COMPACTED CRUSHED STONE BASE 8" = 8 X 0.10 = 0.80
 BITUMINOUS ROAD MIX 2.50" = 2.50 X 0.15 = 0.38
 PROPOSED HMA SURFACE COURSE 1.25" & HMA BINDER COURSE 4.25" = 5.50 X 0.40 = 2.20
 TOTAL = 3.38

DATE 12/15/2014
 DRAWN BY: DAC
 PROJECT P-1020



CONNOR & CONNOR, Inc.
CONSULTING ENGINEERS
 210 East Locust Street
 ROBINSON, ILLINOIS 62454
 Phone 618-544-8623 Fax 618-544-3012
 Licensed Engineers Licensed Surveyors

TYPICAL SECTIONS & SUMMARY OF QUANTITIES
SEC. 11-00098-00-RS
CRAWFORD COUNTY